

# anko

**Blender  
XJ-12412  
User Manual**



**PLEASE READ AND SAVE THESE  
INSTRUCTIONS FOR FUTURE REFERENCE**

## **IMPORTANT SAFEGUARDS**

When using electrical appliances, basic safety precautions should always be followed including the following :

1. Read all instructions before using this Blender.
2. If the supply cord is damaged, it must be replaced by qualified electrical person in order to avoid a hazard or the product must be disposed.
3. Unplug from outlet when not in use, before putting on or taking off parts, and before cleaning.
4. Switch off the appliance and disconnected from mains power supply if it is left unattended, before changing accessories or approaching parts that move in use.
5. Avoid contact with moving parts.
6. Keep hands and utensils out of container while blending to reduce the risk of severe injury to persons or damage to the blender. A scraper may be used but it must be used only when the motor is not running.
7. To protect against electrical shock, do not immerse cord, plug or appliance in water or other liquids.
8. Use only attachments that are included in the packaging of the blender. The use of other attachments may cause fire, electric shock or injury.
9. Do not leave blender unattended while it is operating.
10. Do not let cord hang over edge of table or counter or touch hot surface including stove.
11. To protect against the risk of electrical shock, do not put motor body, plug or cord in water or other liquid. This may cause personal injury or damage to the product.
12. Care is needed when handling cutting blades, especially when

removing the blade from the jug, emptying the jug and during cleaning.

13. Close supervision is necessary when your appliance is being used near children or infirm persons.

14. This appliance is not intended for used by persons (including children) with reduced physical, sensory or mental capabilities, or lack of experience and knowledge, unless they have been given supervision or instruction concerning use of the appliances by a person responsible for their safety.

15. Children should be supervised to ensure that they do not play with the appliance.

16. Ensure to switch off the appliance after each use. Make sure the motor stops completely before disassembling and the power plug is removed from outlet.

17. Do not place an appliance on or near a hot gas or on a heated oven.

18. Never put any objects into the openings on the outer case.

19. Do not operate the appliance for other than its intended use.

20. Operate the blender with cover in place.

21. Do not blend any hot liquids.

22. Be careful if hot liquid is poured into the food processor or blender as it can be ejected out of the appliance due to a sudden steaming.

23. This appliance is intended to be used in household use only.

24. Never remove parts from the appliance such as screws.

25. Never operate the blender when the jug or grinding cup is empty and DO NOT remove the jug lid before the blades come to a complete stop.

26. Warning: Do not touch the cutting blades or insert any object,

such as knives, forks, spoon etc. into the jug while the blender is in operation.

**27. DO NOT pour boiling liquids into the bowl.**

28. Misuse may cause injury.

**Warning: The maximum operating time is 1 minute. Allow it to rest for at least 1 minute before using it again. After 5 cycles of operation, cool down the motor to room temperature for approx. 30 minutes before using it again.**

**SAVE THESE INSTRUCTIONS  
FOR HOUSEHOLD USE ONLY**

## KNOW YOUR FUNCTION BLENDER

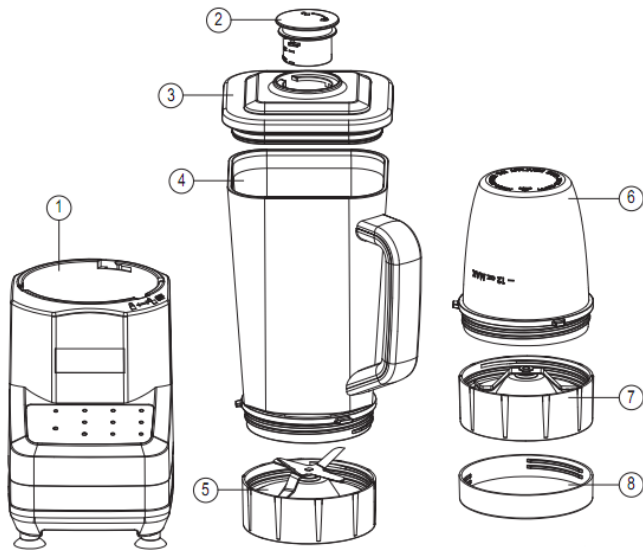

### **Part A:**

1. Motor body
2. Stopper
3. Lid
4. Blending jug
5. Blending blade holder
6. Grinding cup
7. Grinding blade holder
8. Cup lid

### **Part B:**

Control panel

The electronic touch buttons take all the guesswork out of food preparation.

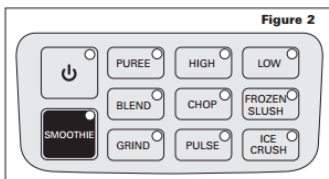

## **BEFORE USING THE BLENDER**

Remove all packaging and check for signs of damage such as, misaligned or damaged parts, damaged jug or cup or base, damage to the blade or power cord or plug. If you find any damage, do not use the blender. Please return the product to Kmart for replacement.

## **ASSEMBLY**

**IMPORTANT! Please note that both the blending blade holder and grinding blade holder have a white plastic sealing ring on the inside of the collar, this creates an airtight seal during blending/processing. Always check to ensure that the sealing ring is correctly fitted before use to prevent liquid leakage.**

1. Place the motor base on a flat, dry and clean counter or table.
2. With the control panel facing you, plug the unit into the mains socket.
3. Depending on the food to be processed, use the blending jug or the grinding cup.
4. You can use the blending jug with crossed blending blade, and the grinding cup with flat grinding blade.
5. To use the blending jug, ensure the blade is fitted to the base of the jug and turn clockwise to tighten the blade until snug before adding any ingredients.

**IMPORTANT! Check the white sealing ring is in place before fitting the blade.**

6. Add ingredients to the blending jug, taking care not to overfill beyond the MAX line. Ingredients rise and expand during processing which is why there is space above the MAX line and the lid to prevent the jug from leaking. Place the blending jug onto the motor body and then rotate clockwise to lock it.
7. To use the grinding cup, add the ingredients before assembling the blade holder, again taking care not to exceed maximum line.
8. Hold the grinding cup firmly in one hand and screw the blade holder onto the top of the cup. Ensure the blade collar has a snug fit.
9. Invert the grinding cup, place it on the motor body and then rotate clockwise to lock it.

**CAUTION: The stainless steel blades are very sharp.**

Handle these components with caution. Ensure you keep your fingers clear of the cutting edges when handling these items. Take care when washing the blades. Never leave them in a sink or washing bowl with other items. Always wash separately.

Wash all items apart from the base in warm soapy water before use.

## **USING THE BLENDER**

**IMPORTANT! The maximum operating time is 1 minute. Allow it to rest for at least 1 minute before using it again. After 5 cycles of operation, allow the electric motor (body) to cool down to room temperature for approx. 30 minutes before using it again.**

**WARNING: DO NOT process boiling liquids or hot ingredients. Allow hot ingredients to cool before placing them in the blending jug/grinding cup.**

You should get familiar with the functions below.

All the buttons have a white indicator light when pressed, they will start the automatic function setting when pressed and stop automatically when finished. If at any time you want to stop the automatic function setting, press the button again to stop the blending/grinding process.

|   | Button   | Food ingredients   | Attachment for use | Quantity and size of food ingredients                         | Operation time (On: operated automatically ) |
|---|----------|--|--------------------|---|--|
| 1 | SMOOTHIE | Fruits , vegetables, e.g. carrot   | Blending Jug       | Don't exceed the "MAX" mark ;<br>Smaller than 10mmx10mmx10mm  | ON : 1min                                    |
| 2 | PUREE    | Fruits, vegetables. e.g. carrot  | Blending Jug       | Don't exceed the "MAX" mark;<br>Smaller than 10mmx10mmx10mm   | ON : 1min                                    |
| 3 | BLEND    | fruits , vegetables e.g. carrot  | Blending Jug       | Don't exceed the "MAX" mark ;<br>Smaller than 10mmx10mmx10mm; | ON : 1min                                    |
| 4 | GRIND    | Grinding harder, single ingredient item e.g. coffee beans, nuts, cinnamon sticks.                                      | Grinding Cup       | Don't exceed the "MAX" mark ;<br>Smaller than 10mmx10mmx10mm  | ON : 20 sec                                  |
| 5 | HIGH     | Thick fruits and vegetables e.g. carrot  | Blending Jug       | Don't exceed the "MAX" mark ;<br>Smaller than 10mmx10mmx10mm  | ON : 1 min                                   |
| 6 | CHOP     | Coarse or finely chop fruits, vegetables e.g. carrot, cereals or cheese. Ideal for preparing fresh salsa and guacamole | Blending Jug       | Don't exceed the "MAX" mark;<br>Smaller than 10mmx10mmx10mm;  | ON : 8 sec                                   |

|    |                 |  |  |   |  |
|----|-----------------|--|--|---|--|
| 7  | PULSE           | Blender: fruits ,<br>vegetables<br>e.g. carrot,<br>Grinder : coffee<br>bean      | Blending<br>Jug<br><br>Grinding<br>Cup | Don't exceed the<br>"MAX" mark;<br>Smaller than<br>10mmx10mmx10mm;  | ON : 1 min<br>(Keep pressing<br>the button by<br>hand) |
| 8  | LOW             | Lighter mixtures<br>and creamy<br>toppings. Ideal for<br>mayonnaise or<br>sauces | Blending<br>Jug                        | Don't exceed the<br>"MAX" mark;<br>Smaller than<br>10mmx10mmx10mm;  | ON : 1 min   |
| 9  | FROZEN<br>SLUSH | Create frozen<br>drinks or slushes   | Blending<br>Jug                        | Don't exceed the<br>"MAX" mark;<br>Smaller than<br>10mmx10mmx10mm;  | ON : 1 min   |
| 10 | ICE<br>CRUSH    | To crush ice.  | Blending<br>Jug                        | Don't exceed the<br>"MAX" mark ;<br>Quality of ice cube<br>less than 0.26Kg;<br>Smaller than<br>10mmx10mmx10mm; | ON : 45 sec  |

## **IMPORTANT!**

Blending Jug shall be operated with the crossed blending blade ONLY.

Grinding cup shall be operated with the flat grinding blade ONLY.

The appliance shall be cooled down for at least 1 minute after each cycle of operation.

## **USEFUL TIPS**

This product must not be disposed together with the domestic waste. This product has to be disposed at an authorized place for recycling of electrical and electronic appliances. By collecting and recycling waste, you help save natural resources, and make sure the product is disposed in an environmental friendly and healthy way.

## **HOW TO CLEAN YOUR FUNCTION BLENDER**

**Caution: The stainless steel blades are very sharp.**

Handle these components with caution. Ensure you keep your fingers clear of the cutting edges when handling these items. Take care when washing the blades. Never leave them in a sink or washing bowl with other items. Always wash separately

1. Remove the plug from the wall socket before cleaning.



2. To clean the jar and lid, use hot soapy water and soft cloth. Do not use abrasive products. The cut blades, jar, and lid are dishwasher-safe.
3. To clean the base, remove any liquid still in the reservoir by tipping up the base over a sink. Clean the inside with a damp cloth and allow to dry. This process can be repeated for the outside of the base.
4. Clean the appliance with a damp cloth and never put it into water or flush it with water.

## **HOW TO SOLVE COMMON PROBLEMS**

| <b>Problem</b>  | <b>Possible reason</b>  | <b>Solution</b>   |
|---|---|---|
| You have plugged the unit in, switched an electrical socket power on, selected a cutting speed, but the unit does not work. | The safety lock on the bowl lid is not fully locked (aligned).<br>The bowl is not fully locked on the base. | Check the safety lock on the bowl lid, ensure it is aligned correctly.<br>Check the bowl is locked onto the base, ensure it is aligned correctly. |
| The blade or cutters are not working normally.  | There is too much food inside the jug/cup.  | Reduce the quantity of food inside the jug/cup.   |

## **STORAGE**

1. Unplug and clean unit.
2. Store in original box or in a clean, dry place.
3. Never store the blender while it is hot or plugged in.
4. Never wrap the cord tightly around the appliance. Never place any stress on cord, especially where the cord enters the unit, as this could cause the cord to fray and break.

## **TECHNICAL SPECIFICATION**

Voltage: 220-240Va.c. 50-60Hz

Power: 700W

Blending Jug: MAX Capacity 1500 ML

## **12 MONTH WARRANTY**

Thank you for your purchase from Kmart.

Kmart Australia Ltd warrants your new product to be free from defects in materials and workmanship for the period stated above, from the date of purchase, provided that the product is used in accordance with accompanying recommendations or instructions where provided. This warranty is in addition to your rights under the Australian Consumer Law.

Kmart will provide you with your choice of a refund, repair or exchange (where possible) for this product if it becomes defective within the warranty period. Kmart will bear the reasonable expense of claiming the warranty. This warranty will no longer apply where the defect is a result of alteration, accident, misuse, abuse or neglect.

Please retain your receipt as proof of purchase and contact our Customer Service Centre on 1800 124 125(Australia) or 0800 945 995 (New Zealand) or alternatively, via Customer Help at [Kmart.com.au](http://Kmart.com.au) for any difficulties with your product. Warranty claims and claims for expense incurred in returning this product can be addressed to our Customer Service Centre at 690 Springvale Rd, Mulgrave Vic 3170.

Our goods come with guarantees that cannot be excluded under the Australian Consumer Law. You are entitled to a replacement or refund for a major failure and compensation for any other reasonably foreseeable loss or damage. You are also entitled to have the goods repaired or replaced if the goods fail to be of acceptable quality and the failure does not amount to a major failure.

For New Zealand customers, this warranty is in addition to statutory rights observed under New Zealand legislation.