

# anko

## A3 Laminator Instruction Manual

Keycode: 42735908



Please read the following instructions carefully before use, and keep for future reference. Thank you for purchasing the Kmart Laminator A3, under normal use and maintenance your Laminator will provide years of satisfactory performance. Please read the instruction manual carefully and retain for future reference.

## Safety Instructions:

When using electrical appliances, basic precautions should always be followed to reduce risk of injury or electric shock, including the following:

- Always unplug the appliance when not in use.
- This appliance is not intended for use by persons, (including Children), with reduced physical, sensory or mental capabilities or lack of experience or knowledge. They should be given supervision and instruction in the use of the appliance, by a person responsible for their safety.
- The laminator will become very hot in use and care should be taken when handling the machine.
- Protect against the risk of electrical hazards. Do not immerse the power cord, plug or appliance in water or other liquids, or use near water.
- Do not insert any metal objects or other foreign objects such as jewellery, hair, fingers or clothing into the appliance.
- Remove paper clips and staples before laminating.
- Do not operate the appliance with a damaged plug or power cord or after the appliance has malfunctioned or become damaged in some manner.
- If the Power Cord is damaged, it must be replaced by a qualified Engineer in order to avoid a hazard.
- The appliance should be installed near the outlet socket and the socket should be easily accessible.
- Only laminate paper or board. Do not laminate unusual objects.
- Do not use aerosol dusters or cleaners.
- Do not spray anything into or lubricate the appliance.

## Setup:

- Operate the machine on a flat and stable surface.
- Ensure there is enough clear space at the rear of the machine for the laminated pouch to exit the machine.
- The Laminator operates with laminating pouches 80 microns - 100 microns –125 microns thick, (Credit card size to A3 size)

## Operating the Laminator:

- The Laminator is operated by a rocker switch, located at the right-hand side of the appliance. There are 3 positions COLD (I), OFF (O) and HOT (II), cold setting is for self-adhesive pouches where no heat required.
- Plug the machines cable into a domestic supply outlet
- To Laminate select the setting, laminating can begin when the Red “Ready” light on, which indicates the Laminator is hot enough to laminate, (Allow approx 3-5 minutes for the Laminator to warm up).
- Prepare the laminating pouch for inserting into the machine. See How to load a laminating pouch below. Do not use pouches thicker than 250 microns (2 x 125microns per side)
- When the machine has reached operating temperature, you may insert the pouch, (sealed edge first), squarely into the machine until it engages with the rollers. Never insert a pouch open edge first into the machine.
- The pouch will move through the machine and exit at the rear.
- During the process the READY light may go out as heat is absorbed by the laminating pouch, this is normal.
- Operating time: Continue laminating 5pcs 80mic pouches, need to rest 2mins until the Laminator temperature raise up. For 125mic, laminating 2pcs, need to rest 2-3mins.
- There may be a slight smell from the laminating Pouch, this again is normal.
- Turn the laminator to OFF (O) after use and remove the plug from the mains socket
- DO NOT laminate thermal printed paper, such as concert tickets, they will turn black.
- Pull the release button to left can release the laminating pouch.

## How to load a Laminating Pouch:

- The laminating pouch is sealed along one side. Open the pouch and place the paper to be laminated centrally inside the pouch as close to the sealed edge as possible.
- Ensure there is an equal border all around the paper (e.g.: A3 paper should have a 3mm border). The sealed edge (not the open edges) is placed into the entry slot to start the lamination process.
- Always watch the pouch during the laminating process to ensure it comes out the other side of the Laminator.
- It may wrap around the rollers if not placed squarely and centrally in the entry slot, see below images.
- In the unlikely event the pouch becomes jammed in the Laminator, please switch off, do not open the appliance. Only a qualified service engineer should repair the appliance.

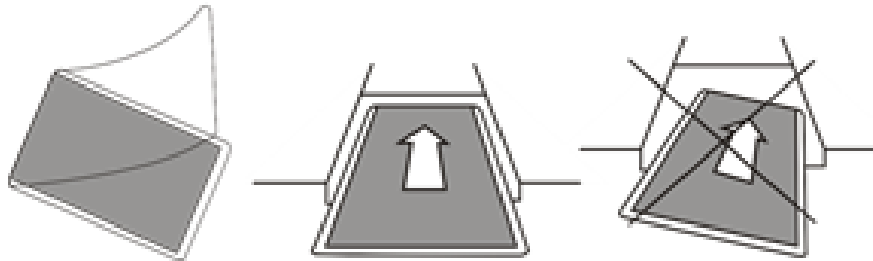

## Pouch Thickness:

Laminating Pouches come in various thicknesses which are measured in microns. We recommend that for this Laminator you use pouches that are between 80-125microns, (0.08-0.125mm thick), for the best laminating results.

## IMPORTANT!



Do not touch the top of the machine during use, as it will get very hot and take approx. 3-4 hours to cool down. Do not place items on top of the machine at any time.

## Laminator A3 Specification:

Rollers:	2 Roller (hot shoe)
Entry width:	330mm
Min lamination thickness:	80 microns
Max lamination thickness:	125microns
Max pouch size:	A3 size (426 x 303mm)
Max lamination Thickness:	0.5mm, including the Pouch.
Lamination speed:	25cm/ min
Jam Release:	Yes
Warm-up:	3-5 minutes
Power consumption:	227Watts
Input:	AC 220-240V, 1.0amp
Dimensions:	430 X 155 X 65 mm (L x D x H)

## Laminating Pouch Sizes:

A3 – 426 x 303mm    A4 – 303 x 216mm    A5 – 216 x 154mm    A6 – 154 x 110mm  
A7 – 80 x 111mm    ID Card – 90 x 60mm    Credit Card – 86 x 54mm

# 12 Month Warranty

Thank you for your purchase from Kmart.

Kmart Australia Ltd warrants your new product to be free from defects in materials and workmanship for the period stated above, from the date of purchase, provided that the product is used in accordance with accompanying recommendations or instructions where provided. This warranty is in addition to your rights under the Australian Consumer Law.

Kmart will provide you with your choice of a refund, repair or exchange (where possible) for this product if it becomes defective within the warranty period. Kmart will bear the reasonable expense of claiming the warranty. This warranty will no longer apply where the defect is a result of alteration, accident, misuse, abuse or neglect.

Please retain your receipt as proof of purchase and contact our Customer Service Centre on 1800 124 125 (Australia) or 0800 945 995 (New Zealand) or alternatively, via Customer Help at [Kmart.com.au](https://www.kmart.com.au) for any difficulties with your product. Warranty claims and claims for expense incurred in returning this product can be addressed to our Customer Service Centre at 690 Springvale Rd, Mulgrave Vic 3170.

Our goods come with guarantees that cannot be excluded under the Australian Consumer Law. You are entitled to a replacement or refund for a major failure and compensation for any other reasonably foreseeable loss or damage. You are also entitled to have the goods repaired or replaced if the goods fail to be of acceptable quality and the failure does not amount to a major failure.

For New Zealand customers, this warranty is in addition to statutory rights observed under New Zealand legislation.