

anko



Vacuum Cleaner
ST01
User Manual



**PLEASE READ AND SAVE THESE
INSTRUCTIONS FOR FUTURE REFERENCE**

IMPORTANT SAFEGUARDS

When using your vacuum cleaner basic safety precautions should always be observed.

Read all below instructions before using.

WARNING: to reduce the risk of fire, electric shock, or injury:

1. Use the Vacuum Cleaner only for its intended use.
2. To protect against a risk of electric shock, do not immerse power plug, cord, motor unit in water or other liquids. If the product falls into water, immediately unplug it from the electrical outlet. **Do not touch or reach into water.**
3. Never yank cord to disconnect from outlet; instead, grasp plug and pull it to disconnect.
4. Do not allow cord to touch hot surfaces.
5. Do not run appliance over cord.
6. Never operate this product if it has a damaged power cord or plug, is not working properly, has been dropped or damaged, or if the motor unit has been exposed to water or other liquids. Do not attempt to examine or repair this product yourself. Only qualified service personnel should perform servicing. Take the product to an appliance repair shop of your choice for inspection and repair.
7. This appliance is not intended for used by persons (including children) with reduced physical, sensory or mental capabilities, or lack of experience and knowledge, unless they have been given supervision or instruction concerning use of the appliances by a person responsible for their safety.
8. Children should be supervised to ensure that they do not play with the appliance.
9. Keep hair, loose clothing, fingers and all parts of body away from opening and moving parts.
10. Do not use to pick up flammable or combustible liquids such as gasoline or use in areas where they may be present.
11. Do not pick up anything that is burning or smoking such as cigarettes, matches or hot ashes.
12. Use extra care when cleaning on stairs.
13. Do not use the vacuum cleaner without the dust cup filter in place.

14. This appliance is intended only for household use. Follow all user instructions in this manual.
15. Do not leave the stick plugged in when un-attended. Unplug the electrical cord when not in use and before servicing.
16. Do not allow to be used as a toy. Close attention is necessary when used by or near children, pets or plants.
17. Use only as described in this manual. Use only manufacturer's recommended accessories.
18. Do not pull cord, use cord as a handle, close a door on cord, or pull cord around sharp edges or corners. Do not run vacuum cleaner over cord. Keep cord away from heated surfaces.
19. Turn off all switches on appliance before unplugging from electrical outlet.
20. Do not unplug by pulling on cord. To unplug, grasp the plug, not the cord.
21. Do not handle plug or vacuum with wet hands or operate without shoes.
22. Do not put any objects into openings. Do not use with any opening blocked.
Keep free of dust, lint, hair and anything else that may reduce air flow.
23. Store your appliance indoors in a cool, dry area.
24. Keep end of hose, wands and openings away from your face & body.
25. Use only on dry surfaces.
26. If the supply cord is damaged, it must be replaced by a qualified electrical person in order to avoid a hazard or the product must be disposed of.
27. Use only attachments that are included in the packaging of the vacuum cleaner.
The use of other attachments may cause fire, electrical shock or injury.
- 28. IMPORTANT! The maximum operating time is 15 minutes. Allow it to rest for at least 30 seconds before using it again.**

SAVE THESE INSTRUCTION

FOR HOUSEHOLD USE ONLY

GETTING TO KNOW YOUR VACUUM CLEANER

1. Extension tube handle
2. Release cord hook
3. Handle assembly
4. Extension metal tube
5. Motor unit
6. Handle On/Off power switch
7. Dust cup lock button
8. Dust cup
9. Floor brush assembly
10. Crevice tool
11. Air exhaust
12. Main body On/Off power switch
13. Power cord

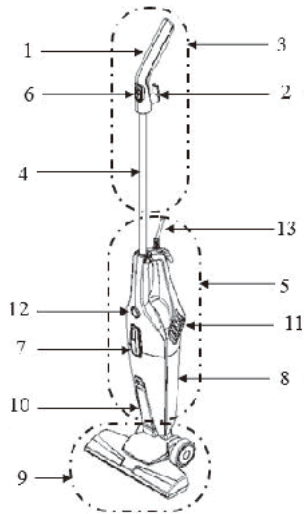

PRECAUTIONARY MEASURES

IMPORTANT! If the suction opening in the unit or the hose is blocked, switch off the vacuum cleaner and remove the blocking substance before you start the unit again.

1. Do not operate the vacuum cleaner too close to heaters, radiators or cigarette butts.
2. Before inserting the power plug into the wall outlet, make sure that your hands are dry.
3. Before you start vacuuming, make sure to remove large or sharp objects that might damage the dust cup filter.
4. When pulling out the power plug from the wall outlet, pull the plug not the power cord.
5. Do not pick up anything that is burning or smoking such as cigarettes, matches or hot ashes.
6. Do not use without dust cup filter in place.

OPERATING INSTRUCTIONS

Note: Always remove the power plug from the wall outlet before assembling or removing accessories

Inserting the metal handle into the main body

Hold the hand vacuum and the extension tube. Make the plastic bulge part (No.1) on the extension tube to be in line with the hole (No.2) on the handheld vacuum. Make sure the assembly direction is correct. (See Fig. 1 and Fig .2)

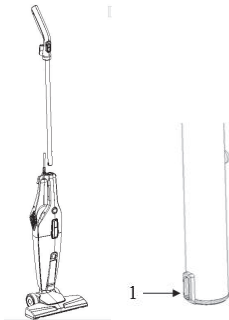

Fig. 1

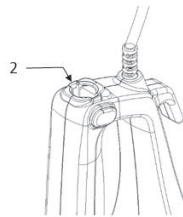

Fig. 2

Push the tube into the vacuum cleaner (No. 3) until you heard a 'Click' sound, then the tube will be locked into place. Pull the handle upwards (No.4) to make sure the tube is locked into the hole. (See Fig.3)

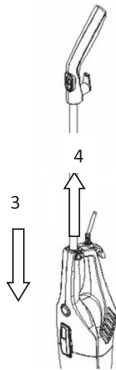

Fig. 3

To detach the extension tube, press the metal tube release button (No.5) on the side of vacuum cleaner and pull out (See Fig. 4)

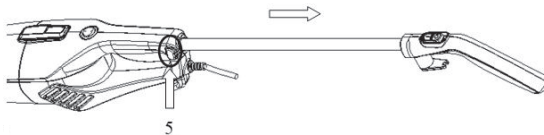

Fig. 4

Attaching the floor brush to the main body

Push the floor brush into the suction hole, and make sure the floor brush connected tightly (See Fig. 5)

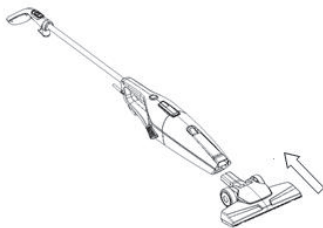

Fig. 5

Using the crevice tool

Pull back the tab (No. 6) to release the crevice tool and rotate it 180 degrees (No.7). Then push the crevice tool end into the suction hole (No. 8) (See Fig 6).

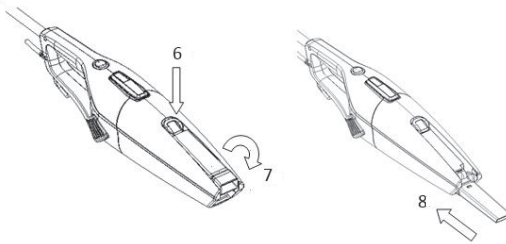

Fig. 6

RECOMMENDATIONS FOR ACCESSORY USAGE

Crevice tool: for radiators, crevices, corners, base-boards and between cushions.

Floor brush: for all kinds of flooring, including carpeted and tiled floors.

WINDING & UNWINDING THE POWER CORD

This vacuum cleaner is equipped with a convenient cord storage feature.

This unit also has a quick release cord hook.

- Wind power cord around the quick release cord hook (No.10) and the cord winding hook. (No.9) (See Fig. 7)
- To unwind the power cord, simply twist the quick release cord hook to the left or right. (See Fig. 7)

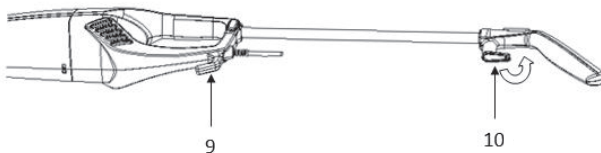

Fig. 7

IMPORTANT! The suction hole opening must be open and free of any obstructions at all times. Otherwise, the motor will overheat and could become damaged.

POWER SWITCH

- There are On/Off power switches on the motor unit (No.11) and on the handle assembly (No. 12) (See Fig 8)
- Push to the “I” side to turn the vacuum ON.
- Push to the “O” side to turn the vacuum OFF.

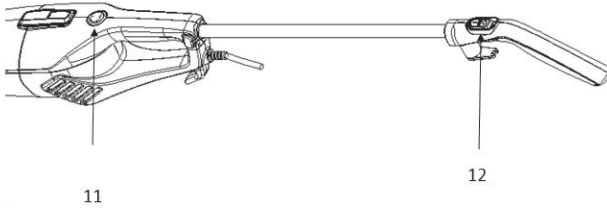

Fig. 8

PLEASE NOTE:

If the power on/off switch on the main body is used to operate the unit, the on/off switch on the handle cannot be used to turn off the unit.

If the power on/off switch on the handle is used to operate the unit, the on/off switch on the main body cannot be used to turn off the unit.

IMPORTANT! To prevent overheating and damage to the electric motor, the maximum operating time is 15 minutes. Allow it to rest for at least 30 seconds before using it again.

USING THE UNIT AS AN UPRIGHT

- Insert the extension tube into the hand vacuum.
- Choose the appropriate accessory (crevice tool or floor brush) and attach it to suction hole on the hand vac.

Note: You may choose not to attach the crevice tool or floor brush when operating as an upright.

- Press “I” on the On/Off power switch turn the unit on.

When finished using the unit, press “O” on the On/Off power switch to turn the unit off.

- When finished using the unit, wind the power cord around the cord winding hooks for easy storage.
- The upright position is not for storage.

USING THE UNIT AS A HANDHELD VACUUM

- Disconnect the extension tube from the hand vacuum by pressing the metal tube release button, and remove the extension tube from the hand vacuum handle.
- Note: You may choose to leave the crevice tool or floor brush attached to the hand vacuum when operating.

Press “I” on the On/Off power switch to turn the unit on. When finished using the unit, press “O” on the On/Off power switch to turn the unit off.

CHANGING & CLEANING THE DUST CUP FILTER

Changing and cleaning the dust cup filter

In order to achieve the best performance, empty the dust cup container and clean the dust cup filter after each use.

1. To remove the dust cup container, press down on the dust cup container release button (No. 13) and separate the dust cup container from the main unit. (No. 14) (See Fig. 9)

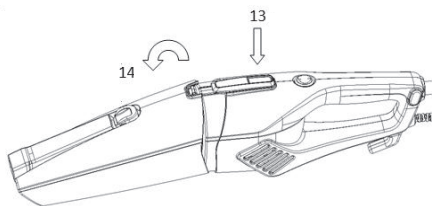

Fig. 9

2. Pull out the dust cup filter assembly (No. 15), then twist the HEPA filter frame counter-clockwise to take out HEPA filter as direction (No.16). (See Fig. 10)

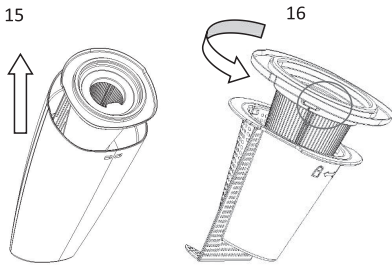

Fig. 10

3. Empty the dust from the dust cup container.
4. Rinse the dust cup filter in cold water, and then let it air dry for 24 hours before placing it back in the dust cup container.

Important Notes: DO NOT use in a washing machine to clean the dust cup filter.

DO NOT use a hair dryer to dry it.

AIR DRY ONLY.

5. Place the dust cup filter carefully into the dust cup compartment.

To avoid damage to the product NEVER operate the vacuum cleaner without the dust cup filter in place.

6. Attach the dust cup container to the main body of the unit.

Note: It is recommended that the dust cup filter be cleaned every week (depending on usage) to ensure peak performance of the unit.

TROUBLE SHOOTING

PROBLEM	POSSIBLE REASONS	POSSIBLE SOLUTIONS
VACUUM WILL NOT OPERATE	No power. Check the mains electrical power outlet supplying power to the vacuum cleaner.	Check the household fuse or circuit breaker. Replace fuse/reset circuit breaker.
VACUUM WILL NOT PICK-UP DEBRIS OR SUCTION POWER IS WEAK	<ol style="list-style-type: none">1. Dust cup container full.2. Dust cup filter needs cleaning or replacement.	<ol style="list-style-type: none">1. Empty dust cup container.2. Remove dust filter and check for object(s) in the air duct and remove. Clean or replace filter.
DUST ESCAPING FROM VACUUM	<ol style="list-style-type: none">1. Dust cup container is full.2. Dust cup filter is not installed correctly.3. Puncture/hole in the dust cup filter.	<ol style="list-style-type: none">1. Empty dust cup container.2. Review dust cup filter installation instructions.3. Replace dust cup filter.

TECHNICAL SPECIFICATION

Voltage: 220-240V~ 50-60Hz

Power : 600W

12 Month Warranty

Thank you for your purchase.

Your new product is warranted to be free from defects in materials and workmanship for the period stated above, from the date of purchase, provided that the product is used in accordance with accompanying recommendations or instructions where provided. This warranty is in addition to your rights under the Australian Consumer Law.

For New Zealand customers, this warranty is in addition to statutory rights observed under New Zealand legislation.

We will provide you with your choice of a refund, repair (where possible) or exchange (availability dependent) for this product if it becomes defective within the warranty period. The business will bear the reasonable expense of claiming the warranty.

This warranty will no longer apply where the defect is a result of alteration, accident, misuse, abuse or neglect.

Please retain your receipt as proof of purchase and contact our Customer Service Centre as listed below, for the entity you purchased this product from, for any difficulties with your product. Warranty claims and claims for expense incurred in returning this product can be addressed to the respective Customer Service Centre.

Our goods come with guarantees that cannot be excluded under the Australian Consumer Law. You are entitled to a replacement or refund for a major failure and compensation for any other reasonably foreseeable loss or damage. You are also entitled to have the goods repaired or replaced if the goods fail to be of acceptable quality and the failure does not amount to a major failure.

Contact for Kmart purchases	Contact for Target purchases
Kmart Australia Ltd. C/- Customer Service Centre 690 Springvale Road, Mulgrave Vic 3170 Customer Service: 1800 124 125 (Australia) or 0800 945 995 (New Zealand) or via Customer Help at kmart.com.au	Target Australia Pty Ltd C/- Customer Service Centre 2 Kendall Street, Williams Landing, Vic, 3027 Customer Service: 1300 753 567 or via Customer Help at target.com.au/help/contact-us