

anko

**Spiralizer
VM9015B-SA
User Manual**



**PLEASE READ AND SAVE THESE
INSTRUCTIONS FOR FUTURE REFERENCE**

IMPORTANT SAFEGUARDS

When using the electrical appliance, the below basic safety precautions should be always followed:

1. For your safety and others carefully read the instructions before using the appliance.
2. Children should be supervised to ensure they do not play with the appliance.
3. Before connecting to mains power ensure the mains voltage corresponds to that indicated on the rating plate of the unit.
4. Do not place or use this product on a hot plate or near a flame (gas stove).
5. To prevent accidents and damage to the equipment, always keep hands and utensils away from blades and moving parts.

IMPORTANT! Do not operate the unit for more than 1 minute continuously.

6. This appliance is not intended for use by persons (including children) with reduced physical, sensory or mental capabilities, or lack of experience and knowledge, unless

they have been given supervision or instructions concerning use of the appliance by a person responsible for their safety.

7. Children should be supervised to ensure that they do not play with the appliance.
8. Do not chop meat.
9. Never remove the cones before it stops.
10. Never feed food by hand, always uses the pusher.
11. Only use accessories supplied with the appliance.
12. The appliance must be disconnected from mains power immediately:
 - If there is an abnormality in operation,
 - Before cleaning or maintenance,
 - After each use.
13. Do not unplug by pulling on the cord.
14. An appliance should not be used:
 - If it is dropped,
 - If the cones are damaged or incomplete.
15. Always disconnect the unit from mains power supply if it is left unattended and before the introduction or removal of blade cone.
16. If the power cord is damaged, it must be replaced by a qualified electrician in order to avoid a hazard, or the product must be disposed.
17. The product has been designed for home use only. Warranty and product liability does not apply in the case of professional use, inappropriate use or failure to observe the instruction manual.
18. This appliance is intended to be used in household and similar applications such as:
 - Staff kitchen areas in shops, offices and other working environments;

- Farm houses;
- By clients in hotels, motels and other residential type environments;
- Bed and breakfast type environments.

19. Switch off the appliance and disconnect from mains power before changing accessories or approaching parts that move in use.
20. Be careful when handling the sharp cutting blades, emptying the bowl and during cleaning.

WARNING: To prevent electrical motor burnout, the maximum continuous operating time is 1 minute. Allow it to rest for 45 seconds before using it again. After 3 cycles of operation, allow the electric motor to cool down to room temperature for approximate 30 minutes before using it again.

CAUTION! DO NOT use hot liquid in the food processor. Hot liquid can be ejected out of the appliance due to a sudden steaming and cause burns.

KNOWING YOUR VEGETABLE MACHINE

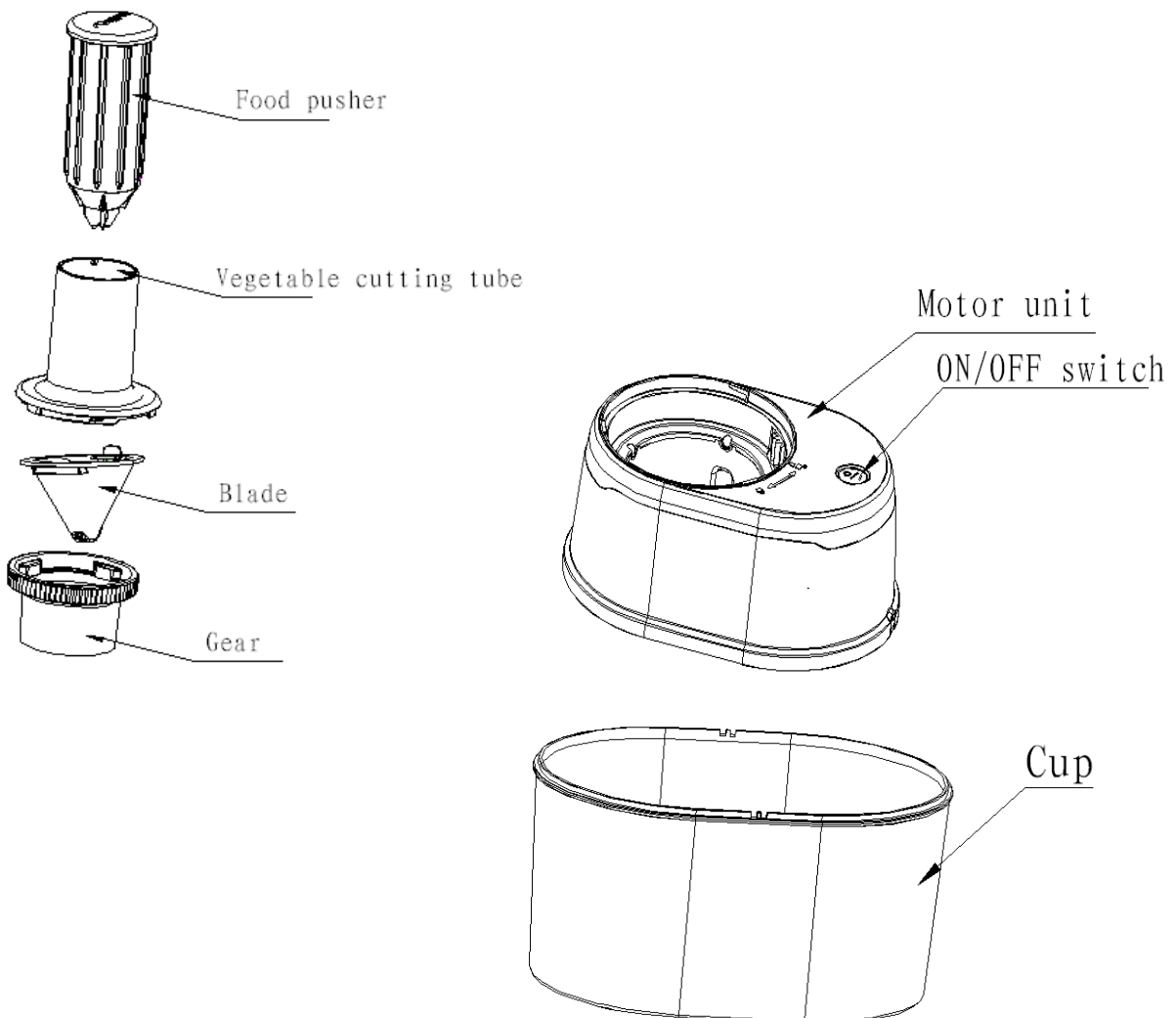

WARNING: To prevent electrical motor burnout, the maximum continuous operating time is 1 minute. Allow it to rest for 45 seconds before using it again. After 3 cycles of operation, allow the electric motor to cool down to room temperature for approximate 30 minutes before using it again.

Product Assembly

1. Before use, make sure the unit is on a clean, flat, dry surface near a power outlet.
2. Securely position the motor unit on the cup (See Fig. 1).
3. With the power cord disconnected from mains power, select your desired blade and place it inside the large gear housing, making sure the top of the blade is level to the top of the large gear (See Fig. 2).
4. Position and align the feeder on top of the blade and gear, then twist clockwise to engage and lock in place.
5. Wash and dry vegetables or fruit to be used.
6. If necessary, cut the food to fit through the feeder.
7. Cut the ends on the food and gently push the food pusher into the flat end, submerging across the blade on the pusher (See Fig. 3).
8. Make sure feeder is free of any debris. Plug the unit into mains power and press on the power switch to operate the product (See Fig. 4).
9. Slowly push the unit press with fruit or vegetable into rotating blade (See Fig. 5).

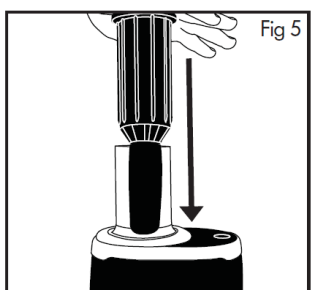
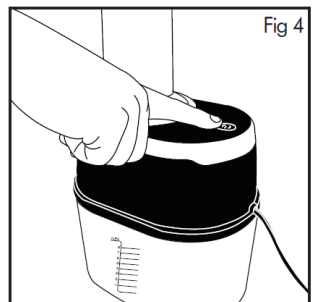
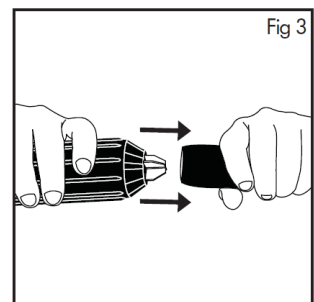
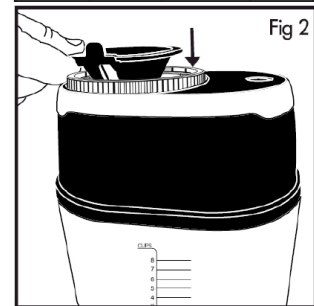
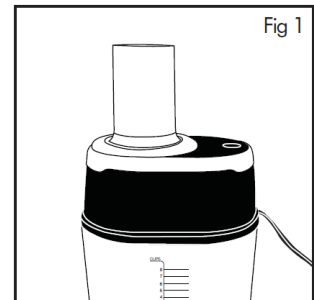

NOTE: When you reach the end of the fruit or vegetable and the pusher cannot push any further, press the power switch to turn the unit OFF, then carefully pull the pusher out. Remove and discard the remaining fruit or vegetable.

If the fruit or vegetable gets stuck inside the feeder, turn the unit OFF, unplug the machine from mains power, rotate the feeder counter-clockwise to unlock and remove it to have easier access to remove the remaining fruit or vegetable stuck in the machine.

OPERATION

1. Cut off the head of the food (e.g. Carrot, potato, squash, cucumber);
NOTE: the food should be in long strips approximately 30mm-60mm in diameter.
2. Fix the carrot to the bottom of the food pusher. Ensure that it is not loose.
3. Put the carrot and food pusher together into the vegetable cutting tube;
4. Plug in the appliance, and then press the power switch to turn ON the spiralizer.
5. Press down on the food pusher with an even force.

Note: The unit has three kinds of blades (Thin Spiral Blade, Thick Spiral Blade, Ribbon Blade) to make different shapes of food.



Thin Spiral Blade



Thick Spiral Blade



Ribbon Blade

6. The processed carrot will fall into the cup.
7. After the operation has completed, press the power switch to turn OFF the spiralizer, and unplug from mains power.

CLEANING AND MAINTENANCE

1. Disconnect from mains power before cleaning.
2. Disassemble all the accessories, such as the vegetable cutting tube, blade cones, food pusher and gear. Please clean all the accessories after each use. Immerse them in warm water and clean them with a soft brush.

Caution:

- ① Ensure that the motor unit is unplugged when disassembling.
 - ② The blade is sharp. Please handle carefully when cleaning.
 - ③ Please rotate the vegetable cutting tube anti-clockwise to take it out.
3. Wipe the outside surface of the motor unit with a damp cloth, and then dry thoroughly.

Note: Never immerse the motor unit in the water for cleaning.

4. All the accessories except for the motor unit are dishwasher-safe.

TECHNICAL DATA

Voltage: 220-240V~ 50-60Hz

Power: 90W

12 Month Warranty

Thank you for your purchase from Kmart.

Kmart Australia Ltd warrants your new product to be free from defects in materials and workmanship for the period stated above, from the date of purchase, provided that the product is used in accordance with accompanying recommendations or instructions where provided. This warranty is in addition to your rights under the Australian Consumer Law.

Kmart will provide you with your choice of a refund, repair or exchange (where possible) for this product if it becomes defective within the warranty period. Kmart will bear the reasonable expense of claiming the warranty. This warranty will no longer apply where the defect is a result of alteration, accident, misuse, abuse or neglect.

Please retain your receipt as proof of purchase and contact our Customer Service Centre on 1800 124 125 (Australia) or 0800 945 995 (New Zealand) or alternatively, via Customer Help at Kmart.com.au for any difficulties with your product. Warranty claims and claims for expense incurred in returning this product can be addressed to our Customer Service Centre at 690 Springvale Rd, Mulgrave Vic 3170.

Our goods come with guarantees that cannot be excluded under the Australian Consumer Law. You are entitled to a replacement or refund for a major failure and compensation for any other reasonably foreseeable loss or damage. You are also entitled to have the goods repaired or replaced if the goods fail to be of acceptable quality and the failure does not amount to a major failure.

For New Zealand customers, this warranty is in addition to statutory rights observed under New Zealand legislation.