

# anko

Blender  
BL9706-CB  
User Manual



PLEASE READ AND SAVE THESE  
INSTRUCTIONS FOR FUTURE REFERENCE

## IMPORTANT SAFEGUARDS

When using the electrical appliance, the below basic safety precautions should be followed:

1. Read all instructions.
2. Before using check that the voltage power corresponds to the one shown on the appliance nameplate.
3. Do not let cord hang over edge of table or counter.
4. **Do not leave the product unattended while it is in use**, especially when children are present.
5. Do not immerse power cord, plug, or product in water or other liquids. If the product falls into water, immediately unplug it from the electrical outlet. **Do not touch or reach into the water.**
6. Do not place on or near a hot gas or electric burner, or in a heated oven.
7. Never operate this product if it has a damaged Power Cord or plug, is not working properly, has been dropped or damaged, or if the Base has been exposed to water or other liquids. Do not attempt to examine or repair this product yourself. Any repairs to the product should be carried out by a qualified electrical person only or the product must be disposed.
8. Do not operate any appliance with a damage cord or plug or after the appliance malfunction or has been damaged in any manner.
9. If the supply cord is damaged, it must be replaced by qualified electrical person in order to avoid a hazard or the product must be disposed.
10. This appliance is not intended for used by persons (including children) with reduced physical, sensory or mental capabilities, or lack of experience and knowledge, unless they have been given supervision or instructions concerning use of the appliances by a person responsible for their safety.
11. Children should be supervised to ensure that they do not play with the appliance.
12. Avoid contacting moving parts.
13. Blades are sharp, so handle carefully.
14. The use of attachment, including jar, jar lid, not recommended or sold by manufacturer may cause fire, electric shock or injury.
15. The appliance should not be used for blending hard and dry substance, otherwise the blade could be blunted.
16. Unplug from mains power outlet when not in use, before putting on or taking off parts, and before cleaning.

17. To protect against risk of electrical shock do not put motor unit or power cord in water or other liquid.
18. Do not use outdoors.
19. Keep hands and utensils out of container while blending to reduce the risk of severe injury to persons or damage to the blender. A scraper may be used but must be used only when the blender is not running.
20. To reduce the risk of injury, never place cutter-assembly blades on base without jar properly attached.
21. Always operate blender with cover in place.
22. **Warning: never use hot liquids or run the appliance empty.**
23. Be care of potential injury from misuse.
24. Care shall be taken when handling the sharp cutting blades, emptying the bowl and during cleaning.
25. Always disconnect the appliance from the supply if it is left unattended and before assembling, disassembling or cleaning.
26. Switch off the appliance and disconnect from mains power before changing accessories or approaching parts that move in use.
27. This appliance is intended to be used in household and similar applications such as:
  - Staff kitchen areas in shops, offices and other working environments;
  - Farmhouses;
  - By clients in hotels, motels and other residential type environments;
  - Bed and breakfast type environments.

## **IMPORTANT!**

**Do not blend hot liquids.**

**Be careful if hot liquid is poured into the blender, it can be ejected out of the appliance due to sudden steaming.**

**To prevent damage to the electric motor, the maximum operating time is 1 minute. Allow it to rest for at least 2 minutes before using it again. After 5 cycles of operation, allow the blender (electric motor) to cool down to room temperature. Allow it to cool down for approx. 30 minutes before using it again.**

**SAVE THESE INSTRUCTIONS**

## KNOW YOUR BLENDER

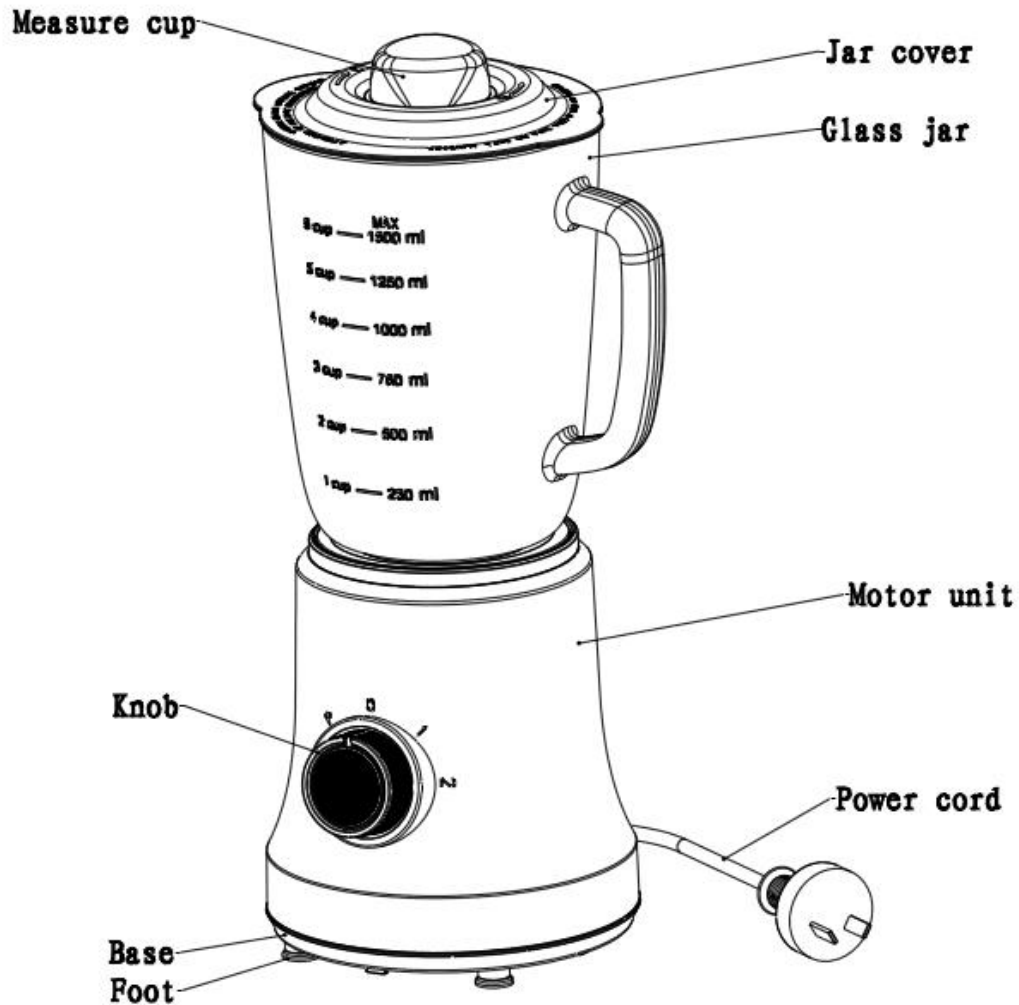

## BEFORE YOUR FIRST USE

1. Unpack the appliance and place all parts on a horizontal surface.
2. Immerse jar and jar cover in warm soapy water and rinse them and dry. Never immerse motor unit in water for cleaning to prevent the risk of electric shock.

**Caution:** The blade is very sharp. Handle with care.

3. The correct assembly way will be described in detail in below sections.

Before assembling the jar, be sure the power cord is unplugged from the power outlet and the Switch button is in the 0 position.

The jar is suitable for making mixture which the juice and pulp are mixed.

4. Place the Jar on the Motor Unit. Turn the jar clockwise until a click will be heard when locked into position properly.

Note: Make sure the Jar is assembled into the motor unit properly. There is an interlock switch in the locked position. If the Jar is not assembled properly, the blender will not operate.

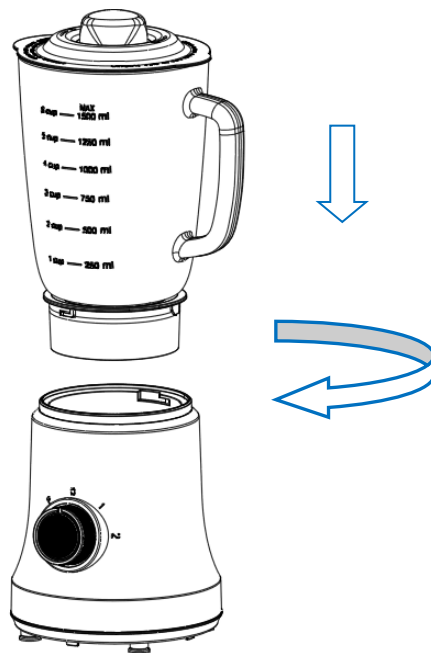

## OPERATION INSTRUCTION

**WARNING! DO NOT process boiling liquids or hot ingredients. Allow hot ingredients to cool before placing them in the glass jar.**

**IMPORTANT! DO NOT** fill the glass jar above the maximum level as indicated on the jar. Some mixtures increase in volume during blending and create pressure in the jar.

**CAUTION:** Do not operate the product until it is properly assembled.

Ensure the product is unplugged from the electrical outlet.

Pour liquid ingredients into the glass jug.

Wash all solid ingredients and cut them into pieces small enough to fit into the measuring cup.

**CAUTION:** The glass jar has a six cup (1.5 liter) capacity. Do not over-fill it.

**CAUTION:** Do not use the product for mashing or grinding heavy foods (e.g., potatoes or meats) or to stir thick mixtures (e.g., dough).

After filling the glass jar with ingredients, place the lid with measuring cup securely onto the glass jar.

Plug the product into a standard 220-240Va.c. electrical outlet.

Turn the Dial to “1” or “2” setting or hold the dial switch in “P” position.

**CAUTION:** Never operate the product empty.

**WARNING!** The maximum operating time is 1 minute. Allow it to rest for at least 2 minutes before using it again. After 5 cycles of operation, cool down the motor to room temperature. Allow to cool down for approx. 30 minutes before using it again.

**NOTE:** If the blades are not operating smoothly, stop the product and add some liquid, or reduce the contents in the glass jar.

To blend food for a short time, pulse operation can be selected by turning the dial switch to “P” setting. Hold the dial switch at “P” setting for this function. To stop blending, release the dial switch.

To use the ice crush function, hold the dial switch at “P” setting. Release the dial switch to stop crushing.

**IMPORTANT!** Use ice cubes only approximately 2cm<sup>3</sup> in size.

Turn off the product by turning the dial to “0” position, and then unplug the product from the mains power outlet.

**WARNING:** Always unplug the product from mains power when it is not in use or when left unattended.

When the Blades have stopped turning, the glass jar can be removed from the motor housing.

**IMPORANT!** To prevent premature wearing on the fly-wheel, remove the glass jar from the motor housing only when the blades have come to a complete stop.

## **CLEANING AND MAINTENANCE**

**WARNING:** Always ensure the product is unplugged from the electrical power outlet before relocating, assembling, disassembling, or when cleaning.

**CAUTION:** Before disassembling the product for cleaning, ensure the blades have completely stopped and use caution when attaching or detaching them, as they are extremely sharp.

Always clean the product immediately after each use. Wash all parts except the Motor Housing in warm, soapy water and then rinse and dry thoroughly. Never immerse the motor housing in water or other liquids. Never use abrasive cleaners on any part of the product. **DO NOT** place any parts into a dishwasher or extremely hot water.

To disassemble the glass jar for thorough cleaning, turn the blade base clockwise and remove it. Take out the gasket from the blade assembly carefully. Use a small brush (not included) to remove particles of food lodged underneath the blades. To reassemble, replace the gasket in the blade assembly, put the blade assembly on the glass jug, and then turn the blade base counterclockwise until it is tightened onto the glass jug (refer to the Parts illustration on page 4).

## **STORAGE**

1. Disconnect from mains power and clean the unit.
2. Ensure all parts are properly dried.
3. Store in original box or in a clean, dry place.
4. Never store the blender while it is hot or while connected to mains power.
5. Never wrap the cord tightly around the product. Never place any stress on the cord, especially where the cord enters the unit, as this could cause the cord to fray and break.

## **TECHNICAL SPECIFICATION**

Voltage: 220-240Va.c. 50-60Hz

Power: 500W

Jar Max. Capacity: 1500ml

## 12 MONTH WARRANTY

Thank you for your purchase from Kmart.

Kmart Australia Ltd warrants your new product to be free from defects in materials and workmanship for the period stated above, from the date of purchase, provided that the product is used in accordance with accompanying recommendations or instructions where provided. This warranty is in addition to your rights under the Australian Consumer Law.

Kmart will provide you with your choice of a refund, repair or exchange (where possible) for this product if it becomes defective within the warranty period. Kmart will bear the reasonable expense of claiming the warranty. This warranty will no longer apply where the defect is a result of alteration, accident, misuse, abuse or neglect.

Please retain your receipt as proof of purchase and contact our Customer Service Centre on 1800 124 125 (Australia) or 0800 945 995 (New Zealand) or alternatively, via Customer Help at [Kmart.com.au](http://Kmart.com.au) for any difficulties with your product. Warranty claims and claims for expense incurred in returning this product can be addressed to our Customer Service Centre at 690 Springvale Rd, Mulgrave Vic 3170.

Our goods come with guarantees that cannot be excluded under the Australian Consumer Law. You are entitled to a replacement or refund for a major failure and compensation for any other reasonably foreseeable loss or damage. You are also entitled to have the goods repaired or replaced if the goods fail to be of acceptable quality and the failure does not amount to a major failure.

For New Zealand customers, this warranty is in addition to statutory rights observed under New Zealand legislation.