

INSTRUCTION MANUAL



SAVE THESE INSTRUCTIONS.
READ COMPLETE INSTRUCTIONS BEFORE USE.

1. How to pair

1. Turn on the vehicle first, then turn on the transmitter.
2. Keep pulling the trigger of the transmitter to match the vehicle.
3. When the vehicle is functioning, that means they are matched.
4. If pairing is not complete within 8 seconds, please turn off both the vehicle and transmitter and re-start the pairing process.
5. When the pairing process is complete, whenever you switch the vehicle and transmitter on and off, it searches for the memorised code and will only lock onto the transmitter signal containing that code.
6. If you have more than two vehicles, please pair them one by one. When the second vehicle is pairing, always keep the first vehicle and transmitter on.
7. Please turn off both the vehicle and transmitter and re-start the pairing process if you are changing to another 2.4GHZ transmitter.

2. How to play

1. Switch ON the vehicle and transmitter. 3. Use the accelerator trigger to drive the vehicle forwards, stop, or backwards

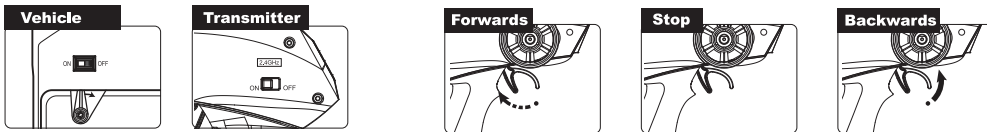

2. Use the steering wheel to control the vehicle turning left or right

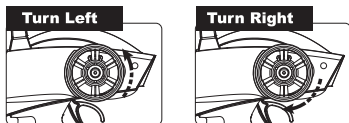

4. Play on a smooth surface for optimum performance
5. Remember to switch OFF the power of the Vehicle and Transmitter after playing
6. The optimum control range is up to 30 metres outdoors

Disposal of batteries



Batteries should not be disposed of in the household waste. As the consumer you are legally obliged to return batteries containing harmful substances and all other used batteries. You can hand in your old batteries at public collection points in your area or wherever batteries are sold. You will find these chemical abbreviations along with a crossed-out refuse bin on batteries containing harmful substances:
Pb=Battery contains lead
Cd=Battery contains cadmium
Hg=Battery contains mercury

3. Battery installation

Battery included (For NI-CD Battery)

Contents

- RC Vehicle x 1
- RC Transmitter x 1
- Instruction Manual x 1
- 6V rechargeable Battery Pack x 1
- USB Charger cable x 1

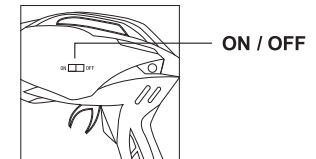
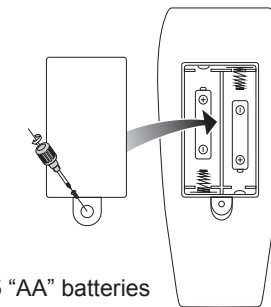
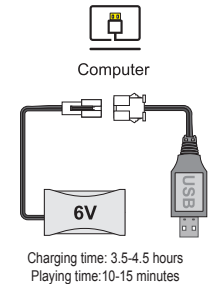
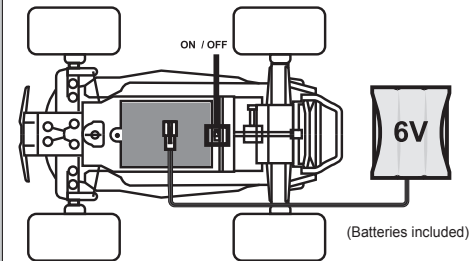

BATTERY WARNING:

Do not mix old and new batteries.
Do not mix alkaline, standard (carbon-zinc), or rechargeable (nickel—cadmium) batteries.
Insert batteries using the correct polarity. Do not short-circuit the supply terminal.
Remove batteries when not in use. Recycle or dispose of exhausted batteries according to federal, state, and local laws.
Do not dispose of batteries in a fire—they may leak or explode.
Only use manufacturer specified battery(ies), charger(s) and/or adapter.
Always use, replace, and recharge (if applicable) batteries under adult supervision.
Non-rechargeable batteries are not to be recharged.
Rechargeable batteries are to be removed from the toy before being charged;
Rechargeable batteries are only to be charged under adult supervision;
Exhausted batteries are to be removed from the toy;
The supply terminals are not to be short-circuited.
Packaging has to be kept since it contains important information.
Product may vary slightly from image shown.

SAFETY PRECAUTIONS

Do not operate during thunderstorms or rain.
Avoid water, sand and snow when operating the car.
Do not submerge car or controller in water.
Never operate your car on the street or highway.
Never operate your car in a confined or crowded area and do not use people or animals as obstacles.
Do not run your car into furniture, objects or hard surfaces, as this will cause damage to both the objects and the car.
Keep fingers, hair and loose clothing away from the tires, gears and motor while the car is switched to "ON".
Do not leave the car or transmitter near sources of heat or under direct sunlight for long periods of time.
Do not leave the car or transmitter outside overnight. Dampness is harmful to interior components.
Remove all batteries when not in use to avoid accidental operation.
Adult supervision is recommended when operating this car.

Performance tips

1. Do not drive on grass, dirt, sand, dust, carpet or through water.
2. Do not drive in windy or rainy weather.
3. Avoid the vehicle directly impacting with obstacles.
4. Switch OFF the power when not in use to prevent damage to the vehicle or transmitter due to leakage of electrolytes from batteries.
5. Remove all batteries from the vehicle and transmitter when not in use for a long period of time.
6. Keep fingers, hair and loose clothing away from the wheels.
7. The operating range can be affected by a variety of factors.
 - a) Low Voltage of batteries in the transmitter or vehicle.
 - b) Interference from other items that emit radio frequency signals.
8. Outdoor usage is recommended in order to get optimum control range.
9. It is recommended to play with the vehicle on a clean and smooth surface
10. Clean the battery compartment to make sure it is free from dust to prevent poor contact of batteries.

Cautions

1. The charger to be used with the toy should be regularly examined for potential hazard, such as damage to the cable or cord, plug, enclosure of other parts and that in the event of such damage, the toy must not be used until that damage had been properly removed.
2. Do not attempt to disassemble the vehicle or transmitter.
3. Do not operate the vehicle with the same frequency as other player(s) in the same location as this will interfere and make the vehicle lose control.
4. Make sure the batteries are installed with correct polarities (+/-) as shown inside the battery compartment.
5. Remove the package and take out all accessories before giving the Vehicle and Transmitter to a child to play with.
The packaging and instruction manual contains important information. Please keep them for future reference.
Warning! Choking Hazard. Not suitable for children under the age of 3 years due to small parts.
We reserve the right to improve/amend specifications and colours without notice.
Warning! The Antenna of the vehicle is not to be inserted into socket outlets.