

Warnings:

Read and understand all instructions before using this product and follow all warnings and cautions in the manual.

- To protect against risk of electrical hazards, do not immerse the appliance, power cord, or plug in water or any other liquid.
- For electrical safety, if the supply cord is damaged, it must be replaced by a qualified electrician only or the product must be disposed of.
- Place the cord in such a way that pulling or tripping over it is not possible.
- Always place and operate the appliance on a flat, solid, clean, dry, and heat-resistant surface.
- The power socket must be readily accessible so that the appliance can be unplugged in an emergency.
- The appliance is intended for household use only. Do not use outdoors or for commercial purpose. Any other use will void the warranty.
- This appliance is not intended for use by persons (including children) with reduced physical, sensory, or mental capabilities, or lack of experience and knowledge, unless they have been given supervision or instructions concerning use of the appliance by a person responsible for their safety.
- Children should be supervised to ensure that they do not play with the appliance.
- Always unplug from the mains supply when not in use.
- Do not operate the appliance if damaged or malfunctions.
- Do not place on or near a hot gas or electric burner.
- Do not use an extension cord with this appliance.
- Do not dismantle and repair the appliance by yourself. **DANGER OF AN ELECTRIC SHOCK AND/OR FIRE!**
- **IMPORTANT! Do not leave the appliance unattended when in use or when connected to mains power.**
- This is a high-volume pump. Use this pump continuously no more than 10 minutes, otherwise it can get overheat and damage the pump.
- Do not obstruct the inflation port or air inlet.
- Do not keep/use the pump in wet condition.
- Never allow sands, small rocks etc. get into the inflation port or air inlet.
- Never look inside or point into the inflation port when the pump is working.

PLEASE READ AND SAVE THESE INSTRUCTIONS FOR FUTURE REFERENCE

Electric Balloon Pump



Contents:

- a. On/Off switch
- b. Small inflate port
- c. Handle
- d. Air inlet
- e. Push-On inflate port
- f. Inflate port
- g. Power plug and cord storage

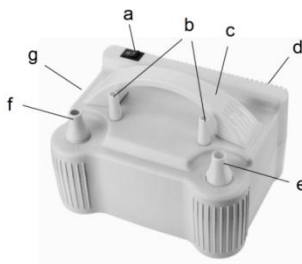

Instructions:

Step 1. Choose the right size of the inflate port.

If you need to inflate a small size balloon, take the small inflate port vertically off and screw it on the inflate port or Push-On inflate port.



Step 2. Plug the appliance into a mains power outlet socket.

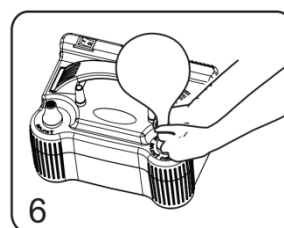
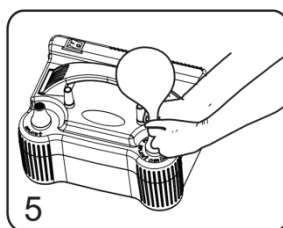
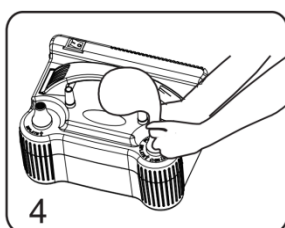
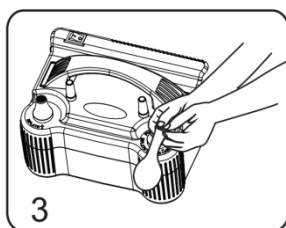

Step 3. Spread the opening of the balloon with fingers.

Step 4. Cover on the inflation port.

Step 5. Push the push-on inflate port down to start inflating.

Step 6. Release the push-on inflate port when the balloon reaches the suitable size.

Step 7. After using the electric balloon pump, disconnect the power plug from the mains power outlet socket.

Step 8. Store the appliance in a clean dry location and out of the reach of children.

Tips: to inflating balloons continuously, use the inflation port and On/Off switch.

