

Kids Slide Instruction Manual

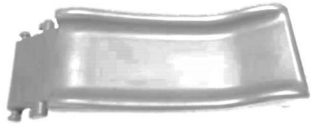

Parts List



Slide chute (A x 1pc)



Right side panel (B x 1pc)



Left side panel (C x 1pc)



Upper step (D x 1pc)



Lower Step (E x 1pc)

Assembly Instructions

Step 1. Put the Slide chute (A) and Left side panel (C) together, ensure the side panel can rotate around the Groove. Fig (1).

Step 2. Insert the Upper step (D) into the middle hole position, and the Lower step (E) to the lower hole of the Left side panel. Fig (2).

Step 3. Insert the Right side panel (B) into the part of step 2, ensure they are connected together properly. Fig(3).



Fig (1)

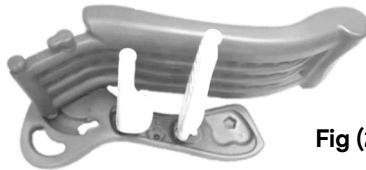

Fig (2)



Fig (3)

Step 4. Spread the two side panels, and let it stand up. Fig (4).

Step 5. Press down on two sides until you hear a “click”, then your kids slide is successfully assembled. Fig (5).

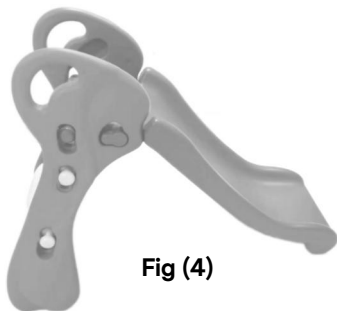

Fig (4)

Click !

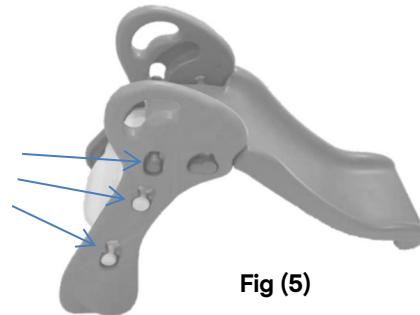
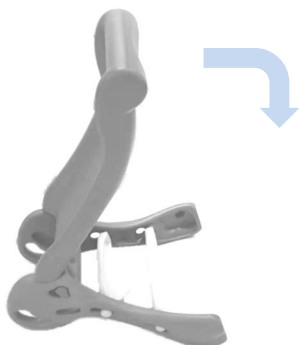

Fig (5)

Folding Instructions

Let the two side panels touch to the floor, hold the end of the slide chute and press down with force until you hear a “click”, then the item can be folded and stored on the floor.



Safety and Maintenance

1. Make sure all parts are securely snapped together before use.
2. This item should be used on a flat surface only.
3. Place this product on level ground and at least 2m away from a fence, building, overhead branches, laundry line or electrical wires.
4. Do not allow children to climb on the product when the surface is wet.
5. Do not allow children to wear loose-fitting clothing including ponchos, scarves and garments with drawstrings. Well fitting shoes must be worn at all times.
6. Please check the unit twice a month for tightness, and tighten as required. It is particularly important that this procedure be followed at the beginning of each season. If you find any signs of wear or damage on the parts by periodically checking, stop use immediately, make sure all problems are solved prior to use.
7. When temperature falls below 0°C, outdoor use of this product is not recommended. In extreme cold conditions, material may become brittle and crack upon impact. Store product in a warm protected place.
8. Maximum weight limit: 25kg. Limit one child.
9. Clean the slide regularly with soapy water in order to avoid a build up of static electricity.
10. Do not leave this item exposed to strong wind and inclement weather.
11. It is recommended that the item be placed under the shade.

Warning

1. Adult assembly required. No tools required.
2. Suitable for indoor and outdoor use. For family and domestic use only.
3. Don't leave child unattended. Adult supervision required when using.
4. Keep instruction manual for further reference.

KEY CODE: 43-271-528

MADE IN CHINA

©KMART AUSTRALIA LIMITED

FOR AU/NZ: IMPORTED FOR KMART STORES IN AUSTRALIA AND NEW ZEALAND

KMART AUSTRALIA - 690 SPRINGVALE ROAD, MULGRAVE, VIC 3170 AUSTRALIA.
KMART NEW ZEALAND - REGIONAL OFFICE C/O KMART PAPATOETOE STORE,
HUNTERS PLAZA, GREAT SOUTH ROAD, PAPATOETOE, AUCKLAND, NEW ZEALAND

KMART CUSTOMER SERVICE

AU: 1800 124 125 NZ: 0800 945 995