

anko

## PET MESH BARRIER

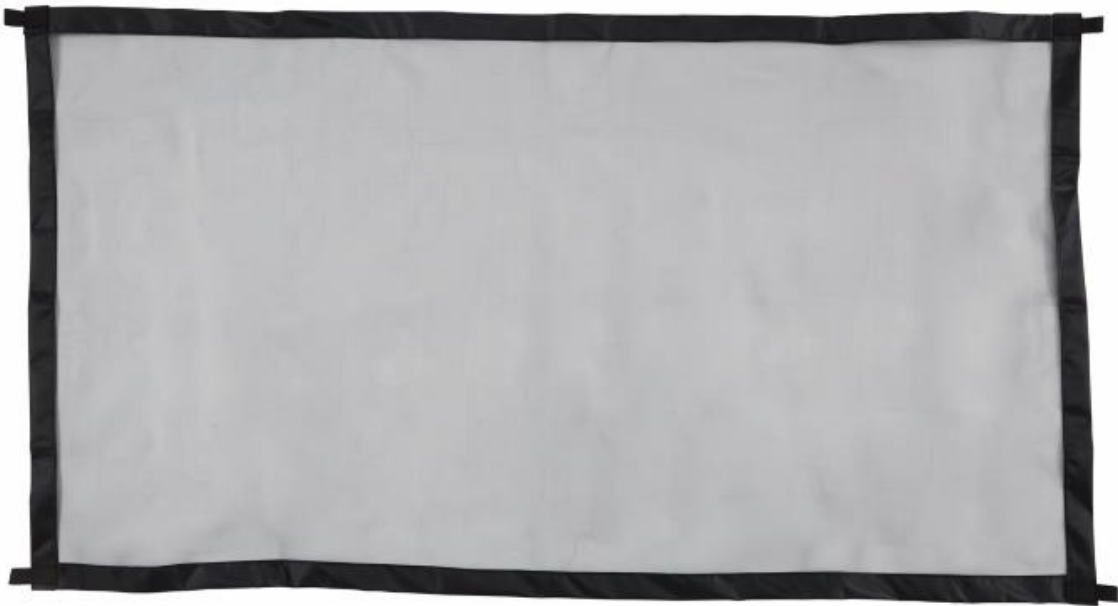

## Instructions



**Step 1.**

Extend the poles and insert them into the short sides of the barrier. Refer to the image below:



**Step 2.**

Unfold the mesh barrier and place it on the wall where you wish to install and mark the spots. Remove the back liner of the hooks and press them firmly for a few seconds onto the wall where you marked.



The hooks direction on the bottom should be stick horizontally. Refer to the image below:



**Step 3.**

Take the corner loops of the barrier and place them around the hook.



**Step 4.**

If you want to remove the hook and sticker, slide the hook up and off and then press the back base while pulling the strip straight. It will come off leaving no holes, marks, sticky residue or stains.

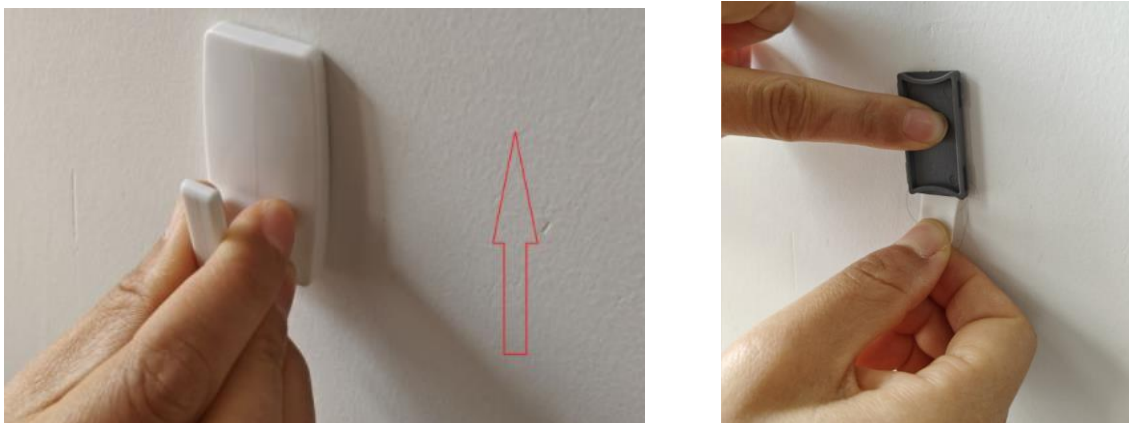

**WARNING:**

PLEASE TEST THE SURFACE OF YOUR WALLS PRIOR TO USE. SOME OLD PAINT SURFACE AREN'T DESIGNED FOR STICK ON PRODUCTS.

INSPECT REGULARLY AND REMOVE IF DAMAGED.

ALWAYS SUPERVISE YOUR PET DURING USE.