

# UNICORN TRI SCOOTER INSTRUCTIONS

**K: 43344529 | T: 68722777**

**WARNING!** Assembly by an adult.

**WARNING!** Not suitable for children younger than 3 years old, due to danger of falling.

**WARNING!** Protective equipment should be worn.

**WARNING!** Not suitable for children with a body mass of more than 20kg.

**WARNING!** Do not use on public roads.

Remove the scooter and all the parts from the box. Set out all the parts and read the assembly instructions prior to use. Keep the packaging until assembly is complete.

## General instructions

- This scooter must be assembled by a responsible adult. Prior to use, make sure that the scooter has been assembled properly. Remove all the parts which are not necessary for play before giving the scooter to your child. Due to the skill it requires, the scooter must be used with care in order to avoid falls or collisions likely to injure the user or others.
- To be used with suitable protective equipment, including a helmet, shoes, elbow, wrist and knee protection. Teach the child how to use it safely and responsibly.
- The scooter is not a toy for children under the age of 3 years.
- Check all screws, bolts and fittings are secure before giving to a child.

## Directions

- a) The scooter can be dangerous and can lead to traffic accident when used on public highways. Do not use on the public roads.
- b) For use on smooth, paved surfaces only.
- c) Avoid bumps and drainage grates that may cause an accident.
- d) Avoid streets and surfaces with water, sand, gravel, dirt, leaves and other debris. Wet weather impairs traction, braking and visibility.
- e) This product has no brake. Please put feet on floor to stop.
- f) The scooter does not include any headlights or lights. It is therefore not suitable for use at night or during periods when visibility is limited.
- g) Use protective equipment such as a helmet, gloves, knee-pads and elbow-pads.
- h) Always use under adult supervision.
- i) Do not allow more than one child to ride the scooter at the same time.
- j) Avoid excessive speed associated with downhill rides.

- k) Check and secure all locking devices are engaged before every ride.
- l) Replace all worn and broken parts immediately.
- m) A parent's decision to allow his or her child to ride this product should be based on the child's skill, maturity and ability.

## During use

- Place one foot on the deck and push forward with the other foot. Steer with both hands on the handgrips. Turn handlebar left or right in the direction you wish to travel.
- Braking: This product has no brake. Step-off to stop.
- Shoes are mandatory and we strongly advise you to wear pants and long sleeve shirts to avoid injury if you fall.
- Children should be reminded that the scooter should be used with caution, since it requires skill, so as to avoid falls or collisions causing injury to the user or third parties.

## Assembly Instructions:

### 1. ASSEMBLE THE HANDLE BAR

Step 1: Align the holes on the handlebar with those on the T-bar. Insert bolts into top of the handlebar and through the T-bar base(Fig.2).

Step 2: Install one lock washer and nut onto each of the two bolts. Tighten with wrench (Fig.3).

Step 3: Install handlebar pad over handlebar and secure with Velcro(Fig.4).

Step 4: Install streamers on two sides, ensure the streamers cannot be pulled out.

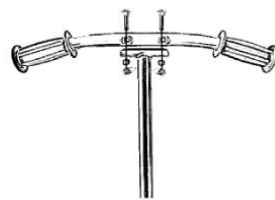

Fig. 2

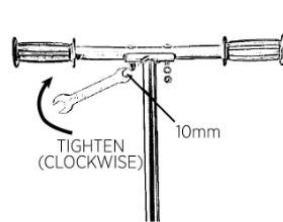

Fig. 3

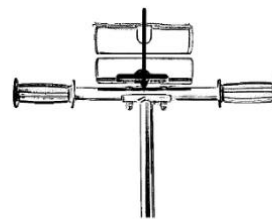

Fig. 4

## 2. ASSEMBLE THE REAR WHEELS

Step 1: Make sure both plastic covers are installed.

Step 2: Remove the nut from one side of the rear axle.

A. Insert the rear axle through one rear wheel, through the metal cover, through the plastic cover, and through the rear tube.

B. Slide the other wheel onto the axle, then insert the nut.

Step 3: Tighten securely using the hex wrenches.

Step 4: Insert the outer wheel cover on two sides.

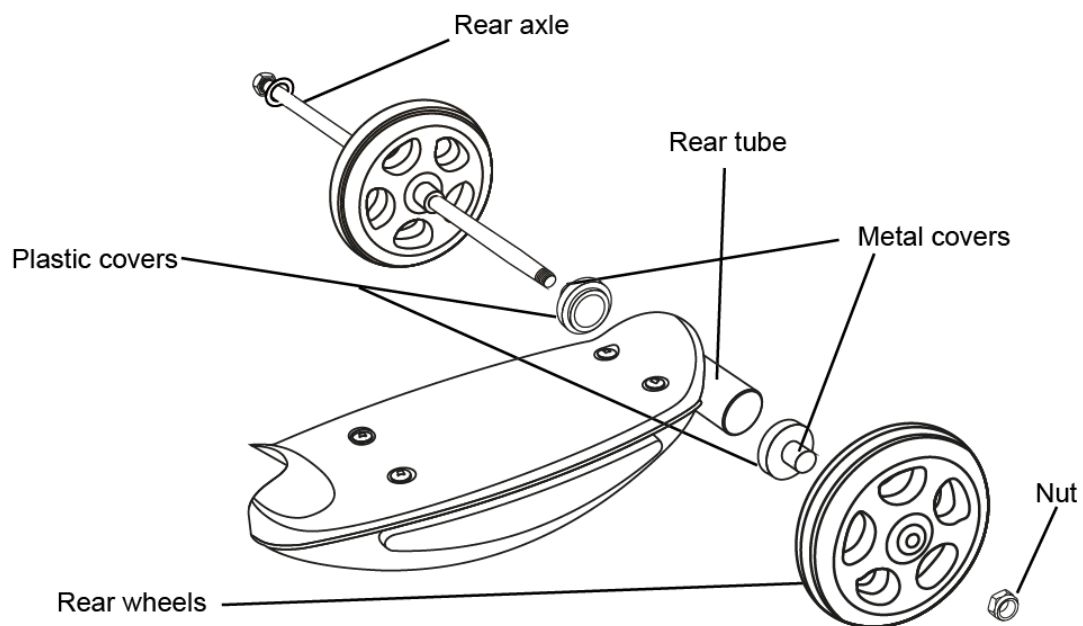

## 3. ASSEMBLE THE FRONT FORK & WHEEL

Step 1: Make sure both plastic covers are installed on the frame steering tube before assembling. Insert the white soft washers on the two sides of frame steering tube. Then insert front fork assembly into frame steering tube from the bottom-up.

Step 2: Slide collar clamp onto front fork.

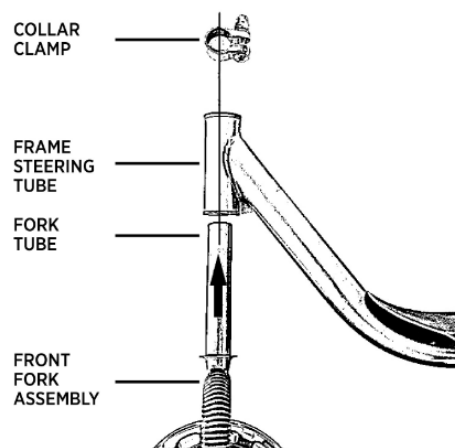

#### 4. ASSEMBLE THE HANDLEBAR/T-BAR

Step 1: Slide collar clamp cover up the T-bar. Insert T-bar all the way into the front fork tube until it stops at the marking of MAXIMUM. **Make sure the gap of fork tube is the same direction as below image showed. It is very important for tightening the clamp.**

Step 2: Align handlebar with front wheel. Handlebar curves toward rider.

Step 3: Tighten collar clamp with wrench. **Make sure the clamp is tightened firmly before use.**

Step 4: Slide collar clamp cover down over collar clamp.

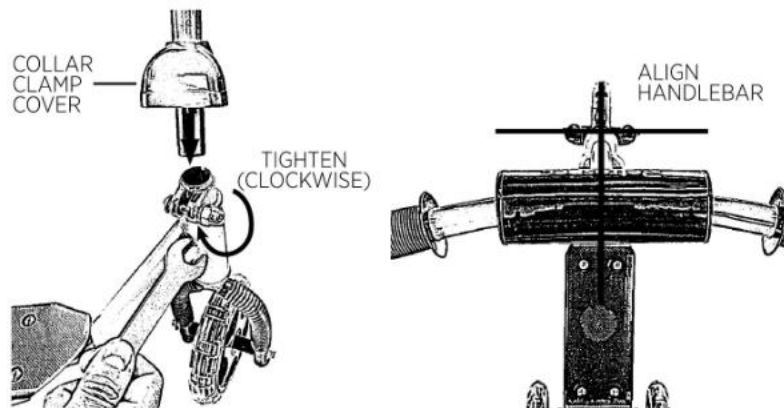

#### Care Instructions

Clean, wipe with a damp cloth. Do not use industrial cleaners, solvents, alcohol or ammonia-based cleaners, they may damage surfaces and plastic parts. Get in the habit of inspecting your scooter on a regular basis and before every ride.

**MADE IN CHINA**

**CUSTOMER SERVICE:**

**KMART AU:** 1800 124 125

**KMART NZ:** 0800 945 995

**TARGET AU:** 1300 753 567