

43351930- 2PK PARTY GRAZING BOX WITH LID

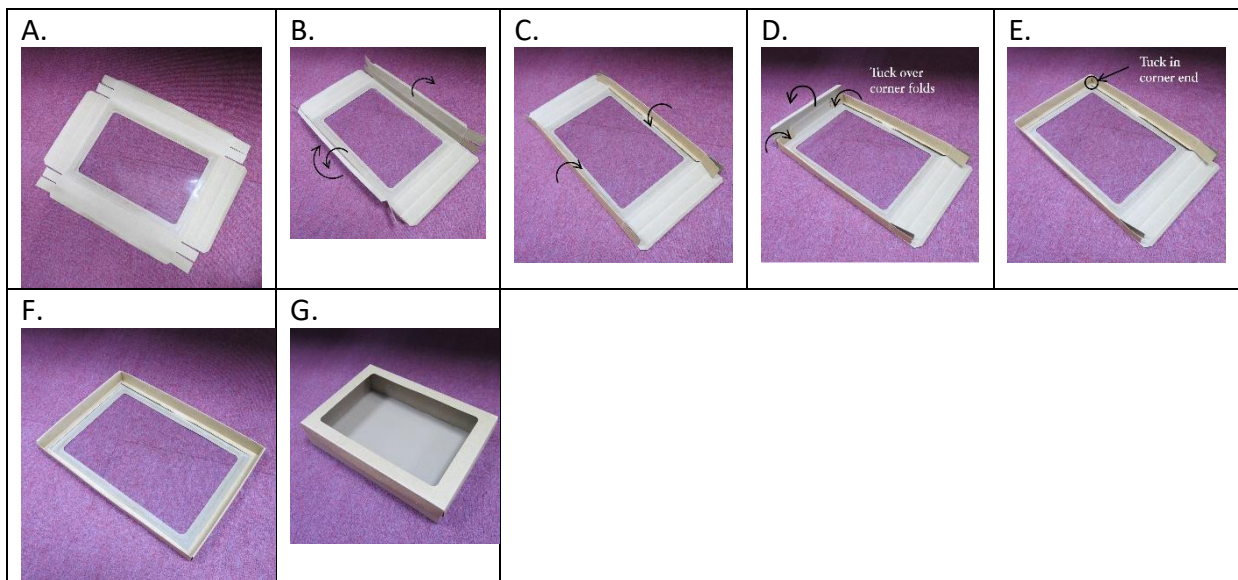

Instructions – Lid Assembly



Step A. Lay lid out flat

Step B. Lift side panels and fold back end flaps.

Step C. Always fold the long side first. Fold side panels inwards so end flaps sit flat against base.

Step D. Repeat action for short side panels, and tuck in the two corner tabs from long side.

Step E. Lift the end flaps from long side panels to cover on top of short end flaps. This will ensure the side panels are secured in position.

Step 6. Repeat for opposite short side panel

Step 7. Lid Complete