

INSTRUCTIONS

AIR-DRY CLAY - CAKE STAND

SUPPLIES INCLUDED

- Flat pack cake stand
- Flat pack mini cake stand
- Flat pack cake box
- Flat cake decorations
- 2 x sculpting tools
- 5 x bags of air-dry clay

BEFORE YOU BEGIN.

Adult supervision and assistance may be required.
Cover working surface with a cloth.
Carefully pop out die cut pieces from flat pack sheets.

HOW TO ASSEMBLE THE CAKE STAND

STEP 1

Interlock pieces A and B together. Follow the images below.

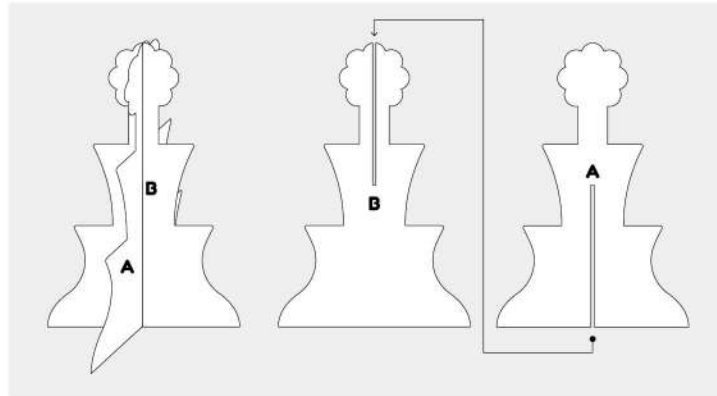

STEP 2

Slide piece C over pieces A and B to lock into place.

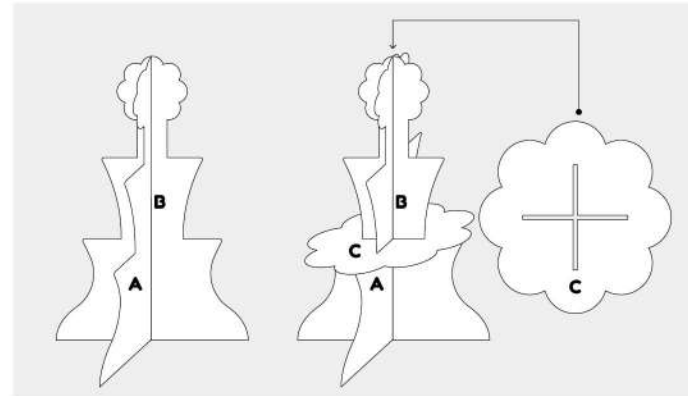

STEP 3

Slide piece D over pieces A and B to lock into place.

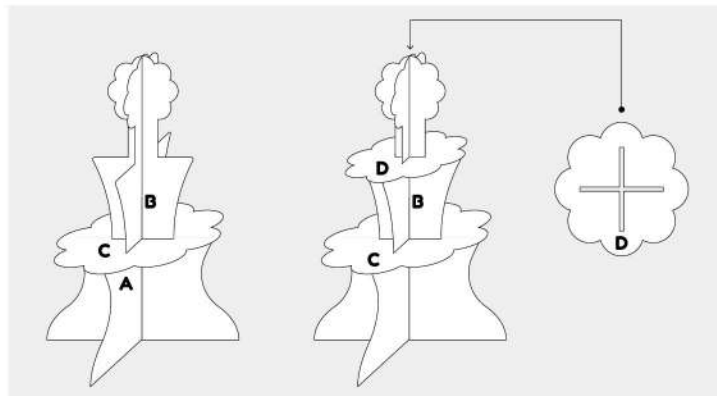

TIPS FOR USING AIR DRY CLAY

KNEAD: Before you start modeling, knead the clay using the palm of your hands. This will make the clay more pliable and easier to shape. To knead a larger amount of clay, use the palm of your hands and for smaller amounts, knead with your thumb and index finger.

TO CREATE LONG CYLINDRICAL SHAPES: Knead the clay into a round ball, then place it between your hands. Rub it back and forth to make the clay grow into a cylindrical sausage shape. To create thinner strips, place the clay on the palm of your left hand and rub it with the index and middle finger of your right hand.

COMBINE: To sticker 2 pieces of clay together, simply press one piece onto another piece of clay. This could be assisted with a tiny amount of water or tools provided in the kit. Avoid using too much water as tiny cracks may form as the clay dries.

MIX: Combine two different colours together and knead to create new colours. Try different combinations to make different colours and shades.

STRENGTHEN: Your clay project can be strengthened with match sticks, eg. for connecting a tiered cake.

CUT: Use the provided sculpting knife to cut the clay into shapes, such as sprinkles and icing.

DRY: Most clay projects will dry within 24-48 hours.

SEAL BAGS AFTER USE: After use, seal the bags securely with some tape and store in a cool place away from sunlight.

MIXING GUIDE

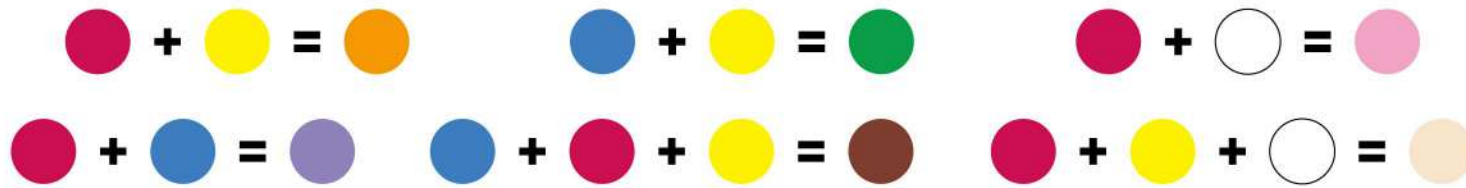

*ADD A LITTLE BIT OF WHITE TO LIGHTEN COLOURS.

INSTRUCTIONS - AIR DRY CLAY DOUGHNUT

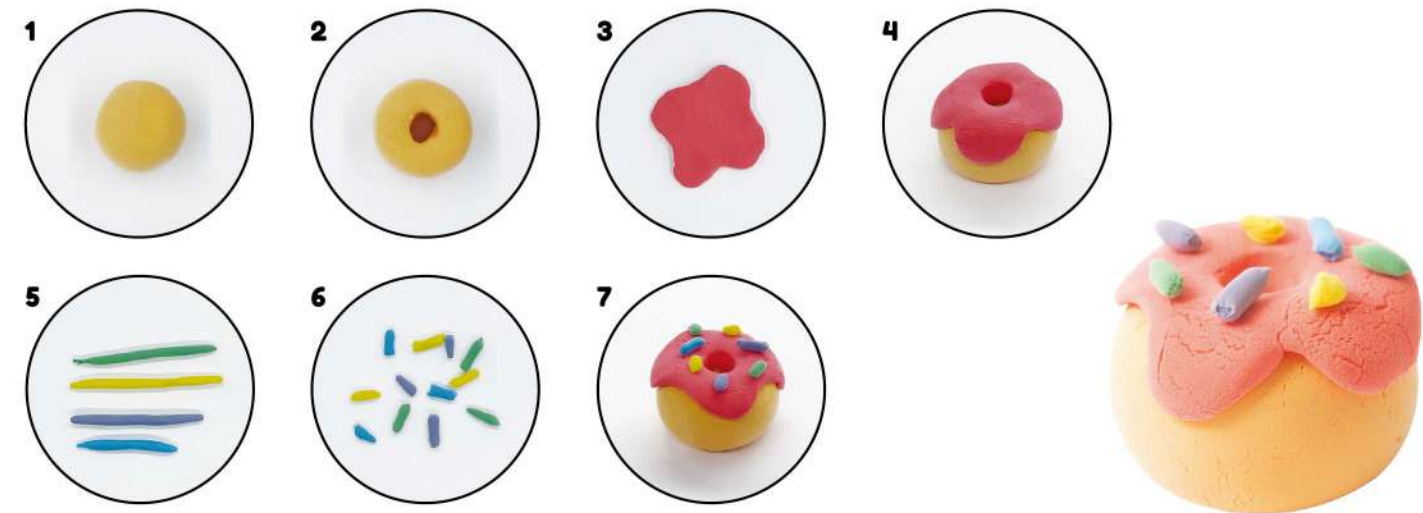

INSTRUCTIONS - AIR DRY CLAY CAKE

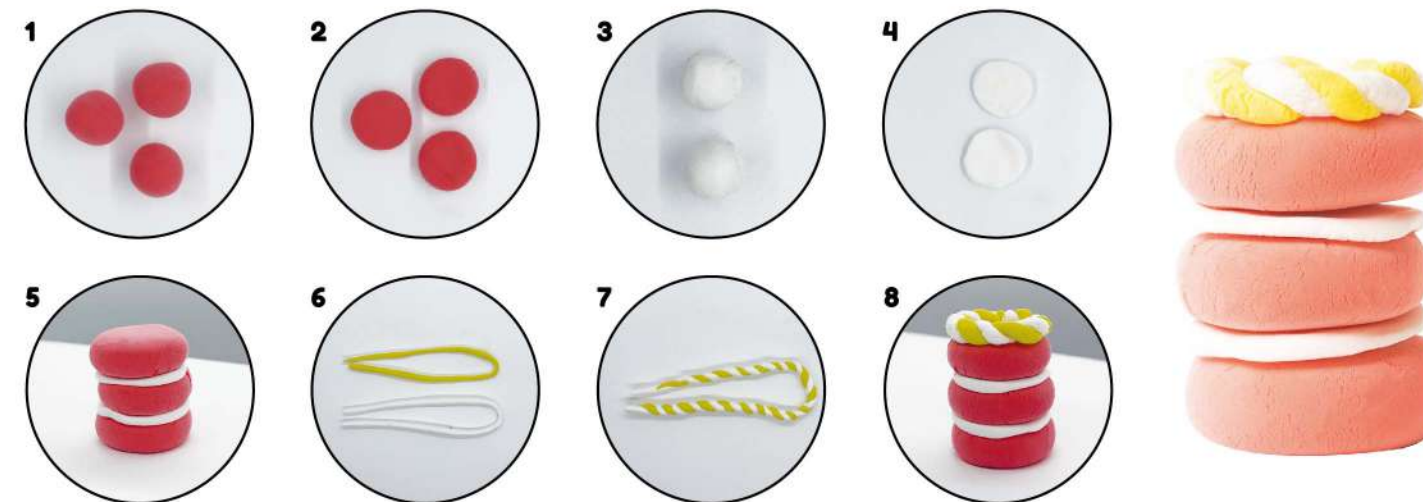

INSTRUCTIONS - AIR DRY CLAY COOKIE

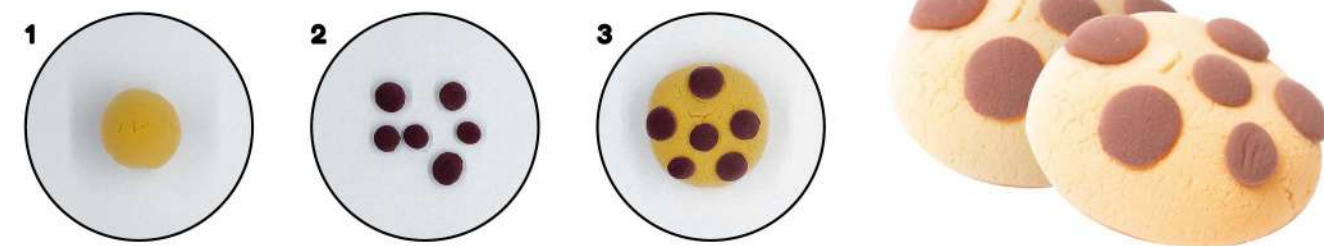

*USE THE REMAINING AIR DRY CLAY TO CREATE YOUR OWN CAKES!



DO NOT INGEST OR SWALLOW.

WARNING:
CHOKING HAZARD - Not suitable for children under 3 years due to small parts

WARNING:
This product contains functional sharp point. Please use as intended.

WARNING:
USE UNDER DIRECT ADULT SUPERVISION. WASH HANDS AFTER USE. AIR DRY CLAY MAY STAIN PERMANENTLY. DO NOT PLACE DIRECTLY ON FURNISHINGS OR OTHER SURFACES TO DRY.