

Boxing Tumbler Instruction Manual

6+
years

Parts List

Boxing tumbler x 1pc
Repair patches x 2pcs

User Guideline

1. This product is suitable for indoor/outdoor use. Before using the product, please make sure it is set up on a floor covering that is clean, dry and free of any sharp objects.
2. Base needs to be filled with water first and inflated with air later. Fill base with water first. Base should be filled with full water through the water valve, then inflate the rest with air through the air valve.

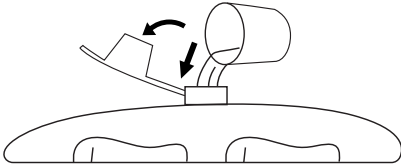

3. To inflate: Open the air valve then use an air pump (not included) to inflate and close the valve quickly. Make sure you do not over-inflate the item. Do not use a high pressure pump to inflate.
4. After inflation, remove the pump nozzle from the hole and fully insert the plastic plug. Make sure the plug is secured tightly before use.

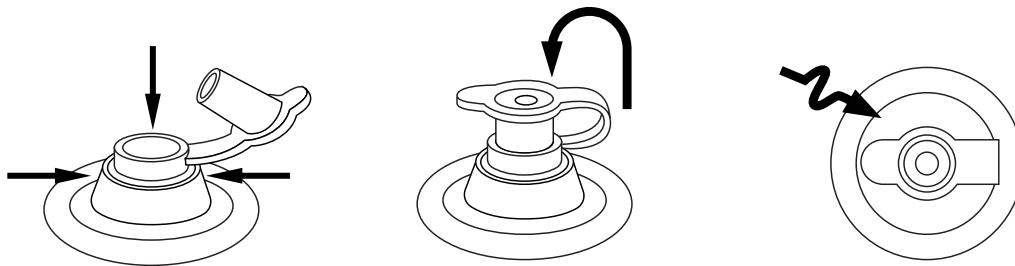

5. To deflate: Pull out the stopper then squeeze the valve direction.

Repairing Guideline

If there is a hole or damage to the outer surface, please use the repair patch provided.

1. Completely deflate and drain the product.
2. Clean and dry the damaged area.
3. Carefully peel patch. Press patch over the area to be repaired.
4. Wait 20 minutes before inflation.

Warning

Do not use as a flotation device.

Suitable user age: 6 years old and above.

Place the product on a level surface at least 2 meters from any structure or obstruction such as a fence, garage, house, overhanging branches, laundry lines or electrical wires.

Do not place on stones, sticks or any sharp objects that may puncture the product.

Do not climb or sit on the product.

Adult assembly required.

Keep away from open flames and heat sources.

K: 43-385-096 | T: 69-555-077

MADE IN VIETNAM

CUSTOMER SERVICE:

KMART AU: 1800 124 125

KMART NZ: 0800 945 995

TARGET AU: 1300 753 567