

Wooden Doll House

Assembly Instruction

K: 43388196 | T: 69555886

<p>HARDWARE</p>	<p>PARTS LIST</p>
<p>WARNING: CHOKING HAZARD – SMALL PARTS, NOT SUITABLE FOR CHILDREN UNDER 3 YEARS.</p> <p>WARNING: ASSEMBLY AND DISASSEMBLY MUST BE CARRIED OUT BY ADULTS ONLY. PLEASE CHECK CONDITION OF ITEM REGULARLY, DISCONTINUE USE OF THE ITEM IF EXCESSIVE WEAR & TEAR IS FOUND.</p> <p>ADULT SUPERVISION RECOMMENDED. THIS IS A TOY, INTENDED FOR ROLE PLAY ONLY. PRODUCT MAY VARY SLIGHTLY FROM IMAGE SHOWN.</p>	<p>Diagram showing parts: i (x1), h (x1), g (x1), j (x1), a (x1), f (x1), c (x1), d (x1), k (x2), e (x1), b (x1).</p>
<p>3D perspective view of the assembled wooden doll house, showing the main structure, a staircase on the left side, and a roof.</p>	<p>ASSEMBLY</p> <p>Step 1</p> <p>Diagram showing part a being attached to part b.</p> <p>Step 2</p> <p>Diagram showing part c being attached to part b.</p> <p>Step 3</p> <p>Diagram showing part d being attached to the structure.</p> <p>Step 4</p> <p>Diagram showing part e being pulled up to complete the assembly. Text: "Pull up gently" with an upward arrow.</p>

ASSEMBLY

Step 5

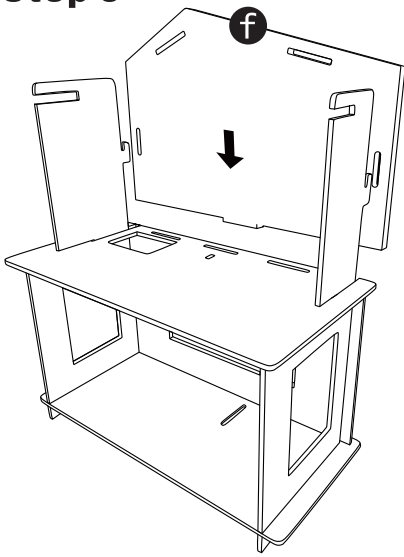

Step 6

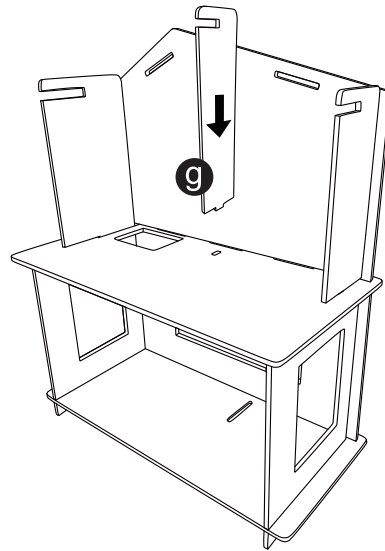

Step 7

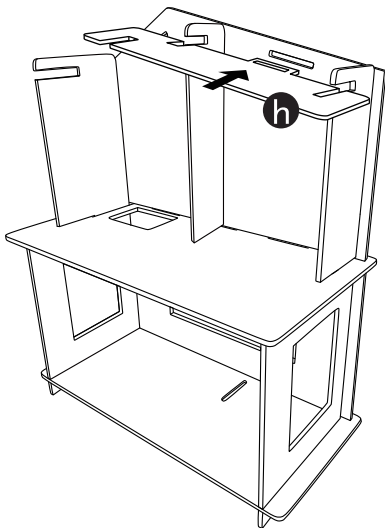

Step 8

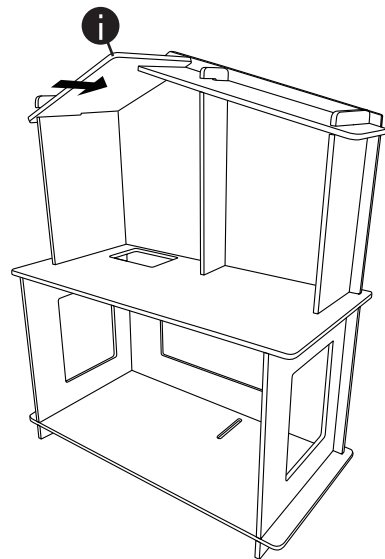

Step 9

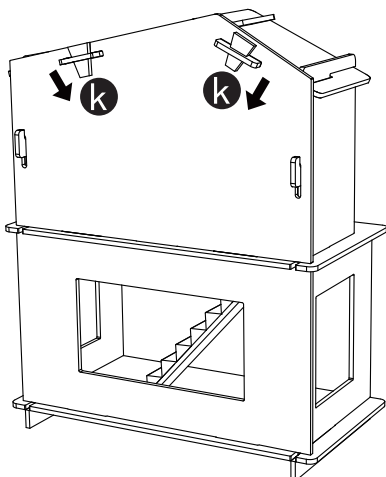

Step 10

