

Back Cover
14.85cm

Front Cover
14.85cm

anko

Baby Bottle Steam Steriliser

Instruction Manual



21cm

KEYCODE: K: 43-389-148 | T: 69-303-692

MADE IN CHINA

CUSTOMER SERVICE:

KMART AU: 1800 124 125

KMART NZ: 0800 945 995

TARGET AU: 1300 753 567

The photos and illustrations shown in this instruction manual are generic.
The manufacturer reserves the right to change any specification or feature without prior notice.

IMPORTANT: KEEP FOR FUTURE REFERENCE. READ CAREFULLY.

IMPORTANT SAFEGUARDS

When using this electrical appliance, basic safety precautions should always be followed including:

1. Before connecting the appliance to the mains supply, check that the voltage indicated on the base matches the mains voltage in your home. If this is not the case, do not use the appliance.
2. Ensure that the steriliser is used on a stable flat surface. This will prevent it from overturning and avoid damage or injury.
3. The use of additional accessories or parts produced by other manufacturers are not recommended. This may result in fire, electric shock or personal injury.
4. Keep the appliance and its cord out of reach of children.
5. For Domestic Use only. Do not use outdoors.
6. This appliance is intended to be used in household and similar applications such as:
 - Staff kitchen areas in shops, offices and other working environments;
 - Farm houses;
 - By clients in hotels, motels and other residential type environments;
 - Bed and breakfast type environments.
7. The base unit and outer surface is subject to residual heat after use.
8. Misuse may cause injury or property damage.
9. Do not operate this appliance if it has a damaged cord or plug, or after the appliance has malfunctioned. This item includes a 12 month warranty. Contact the customer service department of the retailer from where you made the purchase if within this period.
10. Do not allow the cord to hang over the edge of the table or counter or where it can be pulled on by children or unintentionally tripped over.
11. Do not move the appliance or pull on the cord during operation.
12. Do not allow the cord to touch hot surfaces.
13. Do not place the appliance on or near a hot stove, burner or in a heated oven.
14. Never turn on the appliance without filling the chamber with water.
15. The appliance is not intended to be operated by means of an external timer or separate remote-control system.
16. If the supply cord is damaged, it must be replaced by the manufacturer, its service agent or similarly qualified persons in order to avoid a hazard.
17. This appliance is not intended for use by person (including children) with reduced physical, sensory or mental capabilities, or lack of experience and knowledge, unless supervised.
18. Children should be supervised to ensure that they do not play with the appliance.
19. Do Not immerse the base unit in water for cleaning.

20. Danger of scalding! Steam escapes from the top of the appliance during operation. DO NOT directly face the steam steriliser during heating or when removing the top cover.
21. Always use mitts or tongs when handling hot parts. Avoid the hot steam which escapes the appliance immediately after the completed cycle when the appliance is no longer in use.
22. CAUTION: To prevent damage to the appliance, do not use alkaline cleaning agents when cleaning. Use a soft cloth and a mild detergent.
23. For details on how to clean the surfaces in contact with food, please refer to section "CLEANING AND MAINTENANCE".
24. The following marking is the symbol for Hot Surfaces, and alerts danger of a potential scalding hazard.



CAUTION: Hot Surface!
The surface is hot and should not be touched.

25. After use and when the base unit has cooled down, pour out the excess water.

Product specifications:

Product name	Voltage	Power
Baby Bottle Steam Steriliser	220-240V~, 50-60Hz	500W

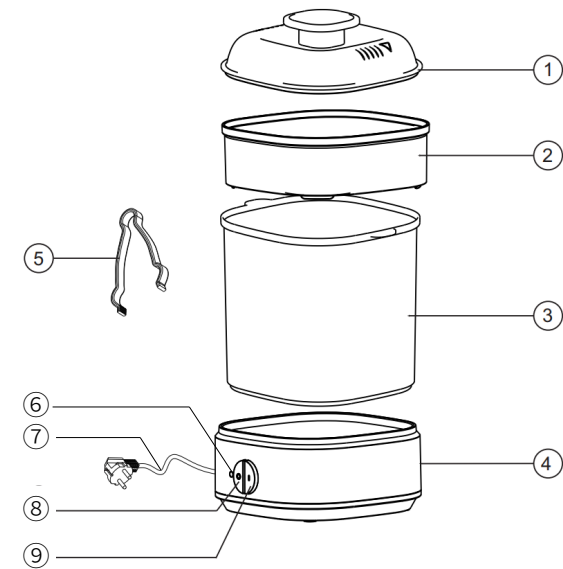

① Lid with grip	⑥ Power indicator light
② Accessories tray	⑦ Power cord
③ Sterilising basket with bottle locator	⑧ OFF button
④ Base unit	⑨ ON button
⑤ Tongs	

How to use:



Step 1:
Pour 75ml water into the base unit.



Step 2:
Place the sterilising basket onto the base.



Step 3:
Place the milk bottles upside down in the sterilising basket.

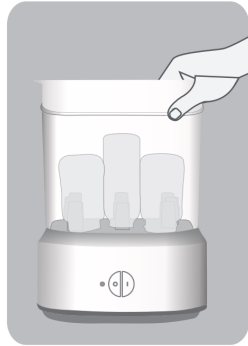

Step 4:
Place the accessories tray onto the sterilising basket.



Step 5:
Place the bottle accessories such as teats, covers and lids into the accessories tray.



Step 6:
Place the lid on top. Connect the power cord into mains power outlet. Press the ON button to start sterilising.

Caution: The base, basket, accessories tray and lid become hot during operation.

Step 7.

The power indicator light is ON showing the appliance is sterilising. When the sterilisation process is completed (approximately 8 minutes), the light switches off and the appliance automatically shuts off.

Step 8.

After the cycle has finished, allow to cool for at least 5 minutes before opening the steriliser to avoid scalding.

Step 9.

To turn off the unit during a cycle, press the OFF button.

Step 10.

Unplug and allow to cool before cleaning.

Note:

- › It is highly recommended to use distilled water to prevent scale.
- › After each use, pour out remaining water and wipe the steriliser

clean with a damp cloth only. DO NOT immerse the base unit into water.

- › Do not clean with abrasive cleaners or allow to come into contact with solvents or harsh chemicals. Damage could result.
- › The steriliser has been designed with the purpose of sterilising maternal and infant products. Do not use for any other purpose.

Tips:

- › When removing the sterilising basket from the base, be aware of the remaining water on the base drip tray.
- › Allow the appliance to cool down completely (approximately 10 minutes) and ensure that the water level is filled to 75ml before reusing the steriliser.
- › Auto shut-off function: the steriliser will auto shut-off if the water dries out. Wait for the heating plate to cool down before starting another cycle. Once the steriliser has cooled down, refill with water and press the ON button to commence new cycle.

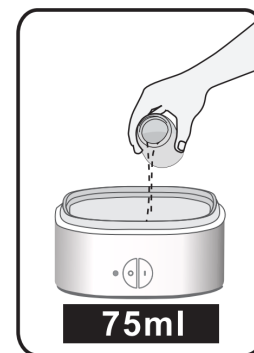

1. 75ml of water requires approximately 8 minute sterilisation cycle.

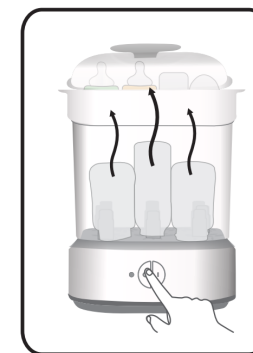

2. Device will shut down automatically when the water has dried out or can be manually turned off by pressing the OFF button if required.



3. ENSURE that the heating plate/steriliser has completely cooled down and water level is filled to 75ml before commencing a new cycle.

CLEANING AND MAINTENANCE

1. Unplug the power before cleaning.
2. Pour out the water after use and wipe with a soft cloth.
3. Clean the top lid, sterilising basket and accessories tray with mild detergent.

Descaling instructions:

It is recommended to descale the bottle steriliser every 4 weeks to ensure it continues to work efficiently.

Mix 100ml of white vinegar with 200ml of cold water to descale the bottle steriliser and pour 75ml into the base unit. Press the ON button and allow the water to boil for 3 minutes, then turn off by pressing the OFF button. Leave the descaling solution in the bottle steriliser until all scale has dissolved.

Rinse with clear water. If traces of scale remain, repeat the descaling process. Ensure that the water does not dry out.

12 Month Warranty

Thank you for your purchase.

Your new product is warranted to be free from defects in materials and workmanship for the period stated above, from the date of purchase, provided that the product is used in accordance with accompanying recommendations or instructions where provided.

This warranty is in addition to your rights under the Australian Consumer Law.

For New Zealand customers, this warranty is in addition to statutory rights observed under New Zealand legislation.

We will provide you with your choice of a refund, repair (where possible) or exchange (availability dependent) for this product if it becomes defective within the warranty period. The business will bear the reasonable expense of claiming the warranty.

This warranty will no longer apply where the defect is a result of alteration, accident, misuse, abuse or neglect.

Please retain your receipt as proof of purchase and contact our respective Customer Service Centre as listed below, for any difficulties with your product. Warranty claims and claims for expenses incurred in returning this product can be addressed with the respective Customer Service Centre.

Our goods come with guarantees that cannot be excluded under the Australian Consumer Law. You are entitled to a replacement or refund for a major failure and compensation for any other reasonably foreseeable loss or damage. You are also entitled to have the goods repaired or replaced if the goods fail to be of acceptable quality and the failure does not amount to a major failure.

Contact for Kmart purchases	Contact for Target purchases
Kmart Australia Ltd. C/- Customer Service Centre 690 Springvale Road, Mulgrave Vic 3170 Customer Service: 1800 124 125 (Australia) or 0800 945 995 (New Zealand) or via Customer Help at kmart.com.au	Target Australia Pty Ltd C/- Customer Service Centre 2 Kendall Street, Williams Landing, Vic, 3027 Customer Service: 1300 753 567 or via Customer Help at target.com.au/help/contact-us