

anko

PET FOLDING CAR STAIRS



Instructions

Step 1.

Extend the stairs and adjust the height and angle to fit the height of your car. Tighten the belts provided for the back of the stairs. Refer to the image below:



Step 2.

Firmly attach the stairs to your car with the carabiner.

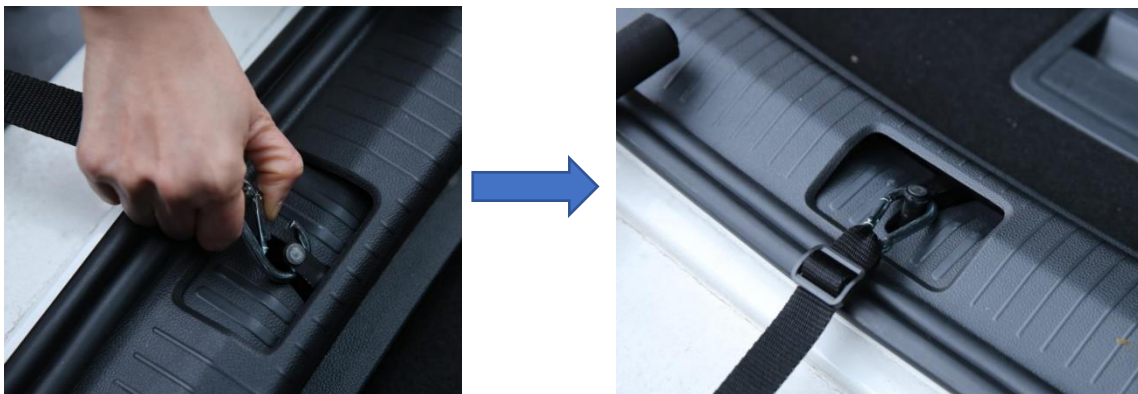

WARNING:

INTENDED FOR PETS ONLY

PLACE THE STAIR ON THE FIRM GROUND

CHECK THE STABILITY OF THE STAIR BEFORE ALLOWING YOUR DOG TO USE IT.

FOR YOUR PET'S SAFETY, INSPECT REGULARLY AND REMOVE IF DAMAGED.

ALWAYS SUPERVISE YOUR PET DURING USE.

MAXIMUM LOADING: 30KGS