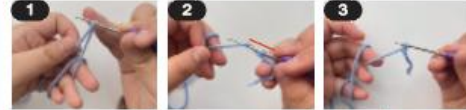

BASIC CROCHET STITCH DIAGRAM**1. Stitch (Abbreviated 'st')****Slip knot**

Every piece of crochet chain starts with a slip knot. Loop the yarn around two fingers (leaving a tail) and pull the tail halfway through the loop. Insert the crochet hook into the second loop and gently pull the loop taut onto the crochet hook.

**2. Chain Stitch (Abbreviated 'ch')**

The chain stitch is the basis for all crochet which is also called a foundation chain.

**3. Slip Stitch (Abbreviated 'sl st')**

The slip stitch is the flattest or smallest of all crochet stitches. You can use this stitch by slip-stitching the ends of a foundation chain to form a ring.

**13. Magic ring**

When crocheting round shape, make 1 magic ring first and then crochet from the center. Crochet through the circle loop in the hand to pull back the taut yarn, make 1 sc to form the first knot. After some sc, pull the bottom yarn tight until all knots form a ring. Make 1 ch in the first knot to close the magic ring.

**14. Weaving in/invisible close**

Cut the yarn, leaving a long yarn end. Draw the end through the final loop on the hook and thread it onto a yarn needle. Weave your needle through the front loops only on the last round and pull tight. Weave remaining yarn into your piece.



Please noted that all yarns needs to be hidden behind the stitch.

4. Single Crochet (Abbreviated 'sc')

The single crochet is the most fundamental of all stitches. Gather the yarn with your crochet hook and draw up the loop through the stitch. Wrap the yarn around the hook and pull it through two loops, leaving one loop on the hook.

**5. Increase (Abbreviated 'inc')**

You can increase stitches by adding a stitch at the beginning of the row. Make 2 sc in the same knot.

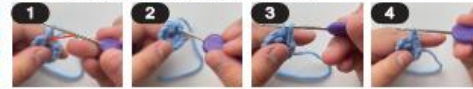
**6. Decrease (Abbreviated 'dec')**

You can decrease stitches, which is really just subtracting a stitch, in a row. Make a half sc, at which point there are 2 loops in the hook, then crochet a half sc in the next knot, at which point there are 3 loops in the hook, and finally wind the yarn through all 3 loops to finish a dec.

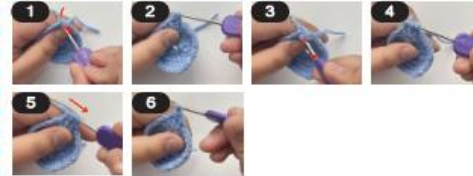
**7. Double Crochet (Abbreviated 'Dc')**

The double crochet is one of the most common crochet stitches and is about twice as tall as a single crochet. Wrap the yarn around the crochet hook. Then insert the crochet hook into the next stitch loop. Wrap the yarn with your crochet hook and pull the loop through the stitch (three loops now on the hook). Wrap the yarn around the hook again and pull it through the first two loops, leaving two loops on the hook. Then, wrap the yarn around the hook again and bring it through the remaining two loops to leave only one loop on the hook. Complete the row.

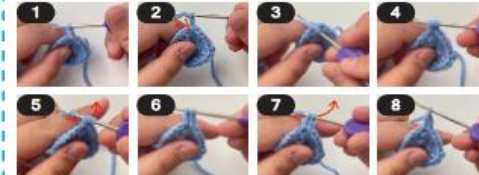
**8. Half double crochet (Abbreviated 'hdc')**

Wrap the yarn around the hook then insert the hook into the next stitch. Wrap the yarn around the hook and pull through all loops.

**9. Round (Abbreviated 'Rd')**

This continues the chain stitches into a circle. Each round starts with ch and ends with sl st.

10. Fasten off (Abbreviated 'F/O')

Fasten off by pulling the yarn through the end stitch and pulling it taut. Cut off.

**11. Insert your hook into 2nd back hoop****12. Sewing**

Generally used for the connection of 2 parts. The plastic needle strap yarns are threaded in turn through the knots where the two parts need to be connected.



If details need to be stitched onto the finished product (such as mouth, eyes, etc.), you can use a plastic needle strap yarns up and down the finished product along the hooked grain.



Stitches used

ch chain
sl slip stitch
sc single crochet
inc increase crochet
dec decrease crochet

dc

hdc

()

x

F/o

double crochet

Half double crochet

the brackets

repeat steps x times

fasten off

MAKE A CROCHET CHERRY**1. Cherry x 2**

R1: (Please use the red yarns) 6 sc [6 sts]

R2: 6 inc [12 sts]

R3: (sc, inc) x 6 times [18 sts]

R4: (sc, inc, sc) x 6 times [24 sts]

R5-9: 24 sc [24 sts]

R10: (sc, dec, sc) x 6 times [18 sts]

R11: (sc, dec) x 6 times [12 sts]

Fill with the fiberfill.

R12: 6 dec [6 sts]

Please follow the above steps to make 2 cherries.

**2. Leaf**

(Please use the green yarns) 16 ch, 2nd ch form hook, sc, hdc, 3 dc, hdc, (sc, ch, sc), hdc, 3 dc, hdc, sc, sl, sc, hdc, 3 dc, hdc, sc

**3. Stem**

(Please use the green yarn) 45 ch

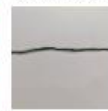
**4. Sewing All the Parts**

anko

**Mini Crochet Kit Cherry
Instruction Manual**

8+

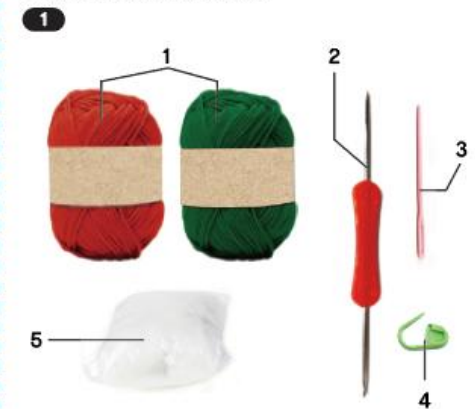
**WHAT'S IN THE BOX**

1. Crochet yarns x 2
2. Crochet hook x 1
3. Plastic needle x 1
4. Ring stich marker x 1
5. 10g fiberfill x 1

MADE IN CHINA
CUSTOMER SERVICE:
KIMART AL: 1811 124 125
KIMART NZ: 0800 345 995
TARGET AU: 1300 753 567

K: 43-430-659
T: 69-728-990