

BASIC CROCHET STITCH DIAGRAM

1. Stitch (Abbreviated 'st')

Slip knot
Every piece of crochet chain starts with a slip knot. Loop the yarn around two fingers (leaving a tail) and pull the tail halfway through the loop. Insert the crochet hook into the second loop and gently pull the loop taut onto the crochet hook.



2. Chain Stitch (Abbreviated 'ch')

The chain stitch is the basis for all crochet which is also called a foundation chain.



3. Slip Stitch (Abbreviated 'sl st')

The slip stitch is the flattest or smallest of all crochet stitches. You can use this stitch by slip-stitching the ends of a foundation chain to form a ring.



4. Single Crochet (Abbreviated 'sc')

The single crochet is the most fundamental of all stitches. Gather the yarn with your crochet hook and draw up the loop through the stitch. Wrap the yarn around the hook and pull it through two loops, leaving one loop on the hook.



5. Increase (Abbreviated 'inc')

You can increase stitches by adding a stitch at the beginning of the row. Make 2 sc in the same knot.



6. Decrease (Abbreviated 'dec')

You can decrease stitches, which is really just subtracting a stitch, in a row. Make a half sc, at which point there are 2 loops in the hook, then crochet a half sc in the next knot, at which point there are 3 loops in the hook, and finally wind the yarn through all 3 loops to finish a dec.

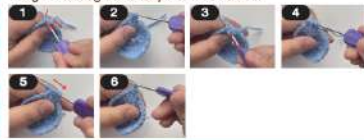

7. Half double crochet (Abbreviated 'hdc')

Wrap the yarn around the hook then insert the hook into the next stitch. Wrap the yarn around the hook and pull through all loops.

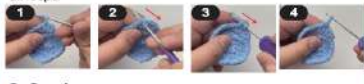

8. Sewing

Generally used for the connection of 2 parts. The plastic needle strap yarns are threaded in turn through the knots where the two parts need to be connected.



If details need to be stitched onto the finished product (such as mouth, eyes, etc.), you can use a plastic needle strap yarns up and down the finished product along the hooked grain.

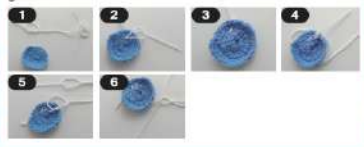

9. Fasten off (Abbreviated 'F/O')

Fasten off by pulling the yarn through the end stitch and pulling it taut. Cut off.



10. Magic ring

When crocheting round artwork, make 1 magic ring first and then crochet from the center. Crochet through the circle loop in the hand to pull back the taut yarn, make 1 sc to form the first knot. After some sc, pull the bottom yarn tight until all knots form a ring. Make 1 ch in the first knot to close the magic ring.



11. Weaving in/invisible close

Cut the yarn, leaving a long yarn end. Draw the end through the final loop on the hook and thread it onto a yarn needle. Weave your needle through the front loops only on the last round and pull tight. Weave remaining yarn into your piece.



Please noted that all yarns needs to be hidden behind the stitch.

12. Round (Abbreviated 'Rd')

This continues the chain stitches into a circle. Each round starts with ch and ends with sl st.

- Stitches used**
ch chain hdc half double crochet
sl slip stitch (..) repeat the step between the brackets
sc single crochet
inc increase crochet x repeat steps x times
dec decrease crochet F/o fasten off

MAKE A CHRISTMAS PUDDING

1. PUDDING BODY

- Rt: (Please use the brown yarn) 6 sc [6 sts]
R2: 6 inc [12 sts]
R3: (sc, inc) x 6 times [18 sts]
R4: (sc, inc, sc) x 6 times [24 sts]
R5: (3 sc, inc) x 6 times [30 sts]
R6: (2 sc, inc, 2 sc) x 6 times [36 sts]
R7: (5 sc, inc) x 6 times [42 sts]
R8-14: 42 sc [42 sts]
R15: (5 sc, dec) x 6 times [36 sts]
R16: (2 sc, dec, 2 sc) x 6 times [30 sts]
R17: (3 sc, dec) x 6 times [24 sts]
R18: (sc, dec, sc) x 6 times [18 sts]
R19: (sc, dec) x 6 times [12 sts] Add fiberfill.
R20: 6 dec [6 sts]



- R8: 42 sc [42 sts]
5 ch, 2nd ch from hook, sc, 2 hdc, sl
7ch, 2nd ch from hook, sc, 2 hdc, 2 dc, sl
(4 ch, 2nd ch from hook, sc, hdc, sl, sl, 2 sc, sl) x 2 times
7 ch, 2nd ch from hook, sc, 2 hdc, 2 dc, sl
(4 ch, 2nd ch from hook, sc, hdc, sl, sl, 2 sc, sl)
3. LEAF
R1: (Please use the green yarn) 6 sc [6 sts]
R2: (5 ch, 2nd ch from hook, sc, hdc, dc, sl) x 4 times
4. Sewing all the parts on the ice cream body.



MAKE A REINDEER

1. BODY

- R1: 6 sc [6 sts] R2: 6 inc [12 sts]
R3: (sc, inc) x 6 times [18 sts]
R4: (sc, inc, sc) x 6 times [24 sts]
R5: (3 sc, inc) x 6 times [30 sts]
R6: 30 sc [30 sts]
R7: (2 sc, inc, 2 sc) x 6 times [36 sts]
R8-10: 36 sc [36 sts]
R11: 9 sc, (sc, inc) x 3, 6 sc, (sc, inc) x 3 times, 9 sc [42 sts]
R12-13: 42 sc [42 sts]
R14: 9 sc, (sc, dec) x 3 times, 6 sc, (dec, sc) x 3 times, 9 sc [36 sts]
R15: (2 sc, dec, 2 sc) x 6 times [30 sts]
R16: (3 sc, dec) x 6 times [24 sts]
R17: (sc, dec, sc) x 6 times [18 sts]
R18: (sc, dec) x 6 times [12 sts] Add fiberfill.
R20: dec [6 sts]



2. MOUTH

- Rt: 6 sc [6 sts]
R2: 6 inc [12 sts]
R3: (sc, inc) x 6 times [18 sts]
R4-5: 18 sc [18 sts]
4. ANTLER X 2
Rt: 5 sc [5 sts]
(Bigger) R1-4: 5 sc [5 sts]
(Smaller) R1-2: 4 sc [4 sts]
Please connect the two antlers.
R1: 9 sc [9 sts]
R2: (sc, dec) x 3 times [6 sts]
R3: 6 sc [6 sts]



Please follow the above steps to make another antler.

5. EAR X 2

- Rt: 6 sc [6 sts]
R2: (sc, inc) x 3 times [9 sts]
R3: (2 sc, inc) x 3 times [12 sts]
6. Sew the mouth on first to determine the front of the reindeer's face. Then sew on the ears to the top, leaving space in between for the antlers. Sew on the antlers. Then sew the nose at the top of the mouth. Finally sew the eyes and forehead details.



MADE IN CHINA
CUSTOMER SERVICE:
EMAIL: A21-890-98-95
PHONE: 44-1200-98-95
TARGET AU: 1300-750-987

E: 43-436-804
T: 67-66-208

anko

DIY Crochet Kit Instruction Manual

8+

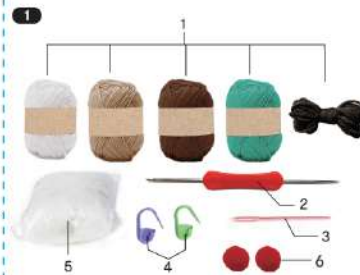

WHAT'S IN THE BOX

1. Coloured yarns x 5
2. Crochet hook x 1
3. Plastic needle x 1
4. Ring stitch marker x 2
5. 15g fiberfill x 1
6. Red pom poms x 2