

anko

**Mini Blender With Bottles
HL-2170B
User Manual**



**PLEASE READ AND SAVE THESE
INSTRUCTIONS FOR FUTURE REFERENCE**

IMPORTANT SAFEGUARDS

When using any electrical appliance, always follow these basic safety precautions:



READ ALL INSTRUCTIONS BEFORE USE.



WARNING-- To reduce the risk of fire, electric shock, or serious personal injury:

- Always ensure the product is unplugged from the electrical outlet before relocating, assembling, disassembling, or cleaning it. Always unplug the product from the electrical outlet when it is not in use.
- This appliance is not intended for use by persons (including children) with reduced physical, sensory or mental capabilities, or lack of experience and knowledge, unless they have been given supervision or instruction concerning use of the appliances by a person responsible for their safety.
- Children should be supervised to ensure that they do not play with the appliance.
- Keep the product out of the reach of children and pets. This product is not intended for use by children. Close supervision is necessary when using this appliance near children.
- Do not leave the product unattended while it is in use, especially when children are present.
- Do not let cord hang over edge of table or counter or touch hot surface including stove.
- Do not immerse power cord, plug, or product in water or other liquids. If the product falls into water, immediately unplug it from the electrical outlet. **Do not touch or reach into the water.**
- Never operate this product if it has a damaged Power Cord or plug, is not working properly, has been dropped or damaged, or if the Base has been exposed to water or other liquids. Do not attempt to examine or repair this product yourself. Any repairs to the product should be carried out by a qualified electrical person only or the product must be disposed.
- Keep the Power Cord and product away from heated surfaces.
- The use of attachments not recommended or sold by the product manufacturer may cause a risk of injury to persons.
- Handle the blades with care as they are extremely sharp. Use caution when attaching or detaching the Blades.
- Care is needed when handling cutting blades, especially when removing the blade from the jug or cups, emptying the jug or cups and during cleaning.
- Do not touch moving parts (e.g., the blades) while the product is in use.

IMPORTANT! Do not blend hot liquids.

Be careful if hot liquid is poured into the food processor or blender as it can be ejected out of the appliance due to a sudden steaming.

WARNING: Do not touch the cutting blades or insert any object, such as knives, forks, spoon etc. into the jug while the blender is in operation.

- Keep hands and utensils away from the moving blades while operating the product. A scraper may be used but only when the product is not operating.

- Do not plug/unplug the product into/from the electrical outlet with a wet hand.
- To disconnect the product from an electrical outlet, pull from the plug do not pull on the power cord.
- Never place the blade assembly on the base unless attached to the jug or cups.
- Do not put any stress on the power cord where it connects to the product, as the power cord could fray and break.
- Never operate the blender when the jug or cups is empty and DO NOT remove the jug lid before the blades come to a complete stop.
- Switch OFF the appliance and disconnect from mains power supply before changing accessories or approaching parts that move in use.
- If the supply cord is damaged, it must be replaced by qualified electrical person in order to avoid a hazard or the product must be disposed.

WARNING: Misuse may cause injury.

- This appliance is for household use only.



CAUTION-- To reduce the risk of personal injury or product/property damage:

- This product is intended for indoor, non-commercial, non-industrial use in processing foods for human consumption. Do not use the product outdoors or for any other purpose.
- Always operate the product on a flat, stable surface.
- Do not attempt to open any part of the Motor Housing.
- Do not let cord hang over edge of table or counter where it may be tripped over or pulled.

**SAVE THESE INSTRUCTIONS
FOR HOUSEHOLD USE ONLY**

Features of Mini Blender With Drink Bottles

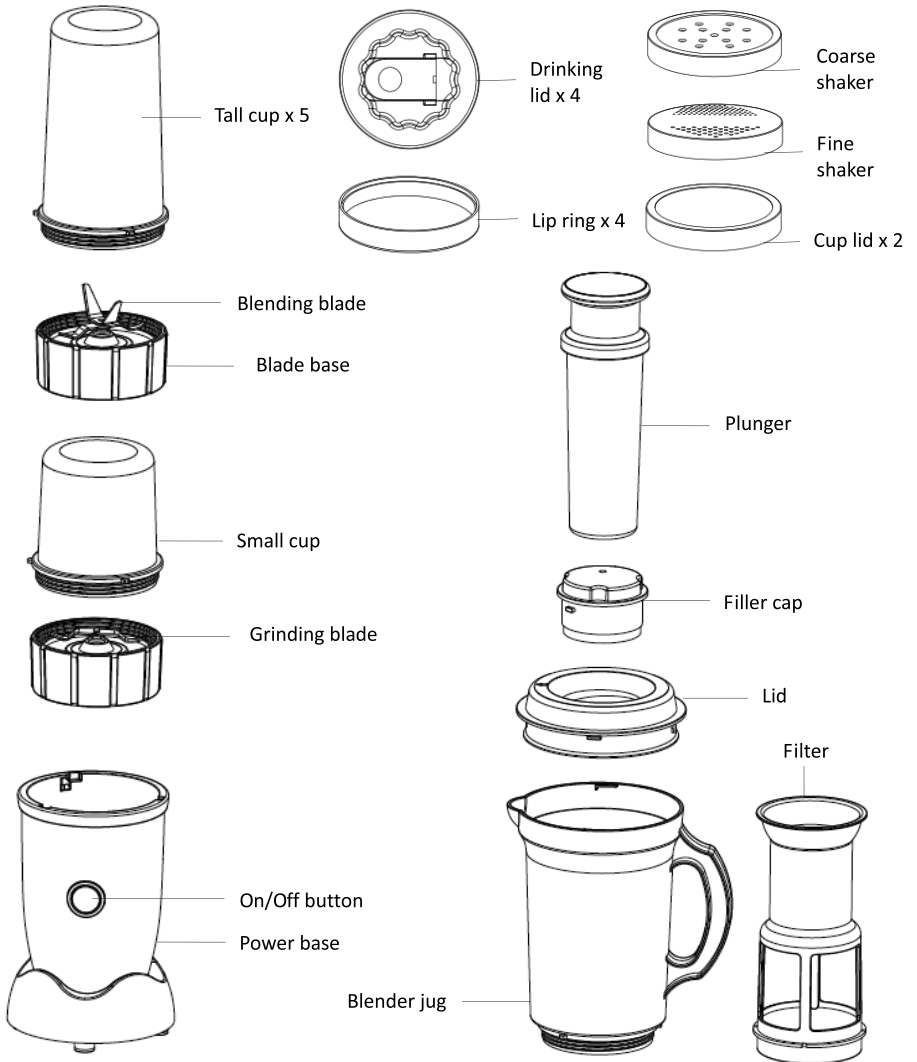

Before First Use

Before using your Mini Blender for the first time it is important that you read and follow the instructions in this use and care booklet, even if you feel you are familiar with this type of appliance.

Your attention is drawn in particular to the section dealing with IMPORTANT SAFEGUARDS. Find a safe and convenient place to keep this booklet handy for future reference. This appliance has been designed to operate from a standard domestic power outlet. It is not intended for industrial or commercial use. Carefully unpack the Mini Blender. Remove all packaging materials and either discard or retain for future use.

Before using the product for the first time, disassemble and thoroughly wash and dry all parts (cups, jug, lids, filter, plunger, blades, rubber gaskets, lip rings) except the power base.

Ensure that the voltage of your electricity supply is the same as that indicated on the rating label on the appliance (220-240V~). Remove the plastic components and wash in warm soapy water. Dry thoroughly and replace. Wipe over the exterior of the casing with a damp sponge or cloth. Do not use abrasive cleaners.

IMPORTANT! Ensure the product is unplugged from the electrical outlet before assembling it.

IMPORTANT! To prevent damage to the electric motor, the maximum operating time is 1 minute for blending function and 30 seconds for grinding function. Allow it to rest for 2 minutes before using it again. After 5 cycles of operation, allow the blender to cool down to room temperature for approximate 30 minutes before using it again.

IMPORTANT! Do not blend hot liquids. Allow hot liquids to cool down before using it in the blender.

How to Use Your Mini Blender

IMPORTANT! Handle the blades with care as they are extremely sharp.

Choosing the Right Blade

Blending Blade (Cross Blade)

The Mini Blender Cross Blade is used for

Blending - The Cross Blade pulverizes ice for smoothies, frozen cocktails and milkshakes.

Mixing - Batters for pancakes, muffins and quick breads are mixed in seconds.

Pureeing - Dishes such as hummus, all-natural soups, and baby food are creamy smooth in seconds.

Shaving ice and Frozen Fruits - For tasty treats such as snow cones or fruit sorbets.

Grinding Blade (Flat Blade)

The straight Flat Blade is used for Grinding harder, single ingredient items such as: coffee beans, nuts, cinnamon sticks, dried fruit.

Mini Blender With Drink Bottles

Because the Blender's motor is so powerful, if you aren't careful you can quickly over process food and turn it into mush. That is why when you want to make foods such as chunky salsa, or coarse chopped onions, the Pulse technique is key. Pulsing takes a tiny bit of getting used to, but once you get a feel for it, you will be an expert in no time.

To Pulse, press the ON/OFF button once to switch on the blender first. Then press down and twist the cup very quickly in an anti-clockwise direction and then release. For foods that you want coarsely chopped, twist the cup in an anti-clockwise direction until the cup is locked in. Then let the blades come to a complete stop and repeat again until you get the consistency you desire.

Using the Mini Blender

1. Ensure the product is unplugged from the electrical outlet.
2. Place the power base on a flat and stable surface.
3. Place the food ingredients to be blended, ground or chopped into the cup with water or other liquid you want to add. If you are not sure how much liquid to add, hold some back as you can always stop the blending process and add more. Ensure that the level of your ingredients does not exceed the MAX mark on the cup at any time.
4. Twist the Blade assembly onto the bottom of the cup/jug. Ensure that the gasket located on the inside bottom edge of the blade assembly.
5. Place assembled blade with cup/jug onto the Power Base. Attach the assembled chopper by aligning the three tabs on the edge of the cup/jug with the three notches on the top inner edge of the power base.
6. Push down on the Blender and twist anticlockwise
7. Put on the Lid if you used the jug.
8. Connect the power cord to an electrical outlet, press the switch on and begin processing food.
9. Unplug the product from the electrical outlet when it is not in use.

Assembling the Mini Blender Juicer

1. Ensure the product is unplugged from the electrical outlet.
2. Place the power base on a flat and stable surface.
3. Twist the Cross Blade onto the bottom of jug.
4. Insert the filter down the center of the jug, make sure to line the four notches up with four ribs on the inside of the jug.
5. Place the lid onto the jug and turn the lid anticlockwise until it locks into place. Make sure the lid is locked on, as it holds the filter in place during operating.
6. Place the assembled jug on the power base. Ensure that the gasket located on the inside bottom edge of the blade assembly.

CAUTION: when using the filter, DO NOT use the flat blade, use the cross blade only.

Using the Mini Blender Juicer

1. Select your juice ingredients. Make sure they are sized in fill into the filter.
2. Remove the filler cap from the lid of the jug.
3. Connect the power cord to an electrical outlet, to avoid jamming the blade, which can cause serious motor damage, make sure the motor is running before you add any ingredients into the juicer.
4. Switch on and put in the ingredients, use the plunger to push down the ingredients.
5. Unplug the product from the electrical outlet when it is not in use.

IMPORTANT! The blender jug with the lid is not suitable for crushing ice. Use the Tall cup provided for crushing ice first and then put the crushed ice in the jug. Failing to follow these instructions may cause damage to the blender jug.

This product is not an ice crusher. Always make sure to add at least one cup liquid to the processing cup before adding ice or foods that are frozen solid. Do not overfill. Failure to add enough liquid before processing may cause the processing cup to break or chip.

Never run the Mini Blender for more than one minute at a time, as it can cause permanent damage to the motor. If the motor stops working, unplug the Power Base and let it cool for a few hours before attempting to use it again.

Ensure the cup/jug is twisted tight to the blade assembly to avoid leaking.

If this appliance begins to malfunction during use, immediately release pressure on either cup (small grinding or tall blending) and unplug the cord. Do not use or attempt to repair the malfunctioning appliance.

To reduce the risk of injury to persons or property, never use this appliance in an unstable surface.

Do not use this appliance for other than its intended use.

Do not use if the jug/cup is cracked or chipped.

How to Care for Your Mini Blender

Caution: Always unplug the Mini Blender when cleaning or assembling. Always clean the product immediately after each use.

Washing Mini Blender Attachments

The Mini blender attachments are not dishwasher safe. Hand washed with warm soapy water and then rinse. Always make sure the rubber sealing ring is still inside after cleaning. If you need to remove the rubber seal ring for cleaning purpose, make sure not to use any sharp or pointed objects to remove the rubber sealing ring. Always use a flat, blunt object or tool to avoid damage to the sealing ring. Make sure to re-install the rubber sealing ring properly in the blade base.

Cleaning the Power Base

1. The most important thing is to UNPLUG the Power Base before cleaning.
2. Use a damp cloth to wipe inside and outside of the Power Base.

NEVER SUBMERGE THE POWER BASE IN WATER OR PLACE IT IN THE DISHWASHER.

Storage

1. Unplug and clean the unit.
2. Store in original box or in a clean, dry place.
3. Never store the blender while it is hot or while connected to mains power.
4. Never wrap the cord tightly around the appliance. Never place any stress on the power cord, especially where the cord enters the unit, as this could cause the cord to fray and break.

Electrical Specifications

Voltage: 220-240V~ 50/60Hz

Power: 300W

12 Month Warranty

Thank you for your purchase from Kmart.

Kmart Australia Ltd warrants your new product to be free from defects in materials and workmanship for the period stated above, from the date of purchase, provided that the product is used in accordance with accompanying recommendations or instructions where provided. This warranty is in addition to your rights under the Australian Consumer Law.

Kmart will provide you with your choice of a refund, repair or exchange (where possible) for this product if it becomes defective within the warranty period. Kmart will bear the reasonable expense of claiming the warranty. This warranty will no longer apply where the defect is a result of alteration, accident, misuse, abuse or neglect.

Please retain your receipt as proof of purchase and contact our Customer Service Centre on 1800 124 125 (Australia) or 0800 945 995 (New Zealand) or alternatively, via Customer Help at Kmart.com.au for any difficulties with your product. Warranty claims and claims for expense incurred in returning this product can be addressed to our Customer Service Centre at 690 Springvale Rd, Mulgrave Vic 3170.

Our goods come with guarantees that cannot be excluded under the Australian Consumer Law. You are entitled to a replacement or refund for a major failure and compensation for any other reasonably foreseeable loss or damage. You are also entitled to have the goods repaired or replaced if the goods fail to be of acceptable quality and the failure does not amount to a major failure.

For New Zealand customers, this warranty is in addition to statutory rights observed under New Zealand legislation.