

active  
& CO

**WARNING:**

Prior to first use, please charge the scooter for 14 hours. This step is critical for your scooter to operate correctly.  
Once the battery has been fully charged it is ready for use.  
For all other recharges, the battery should be charged for up to 6 hours or until LED light changes to green. The scooter should be recharged after each use.  
The scooter should be switched off using the on/off power switch after each use.  
The battery must be recharged at least once a month even when the scooter is not in use.

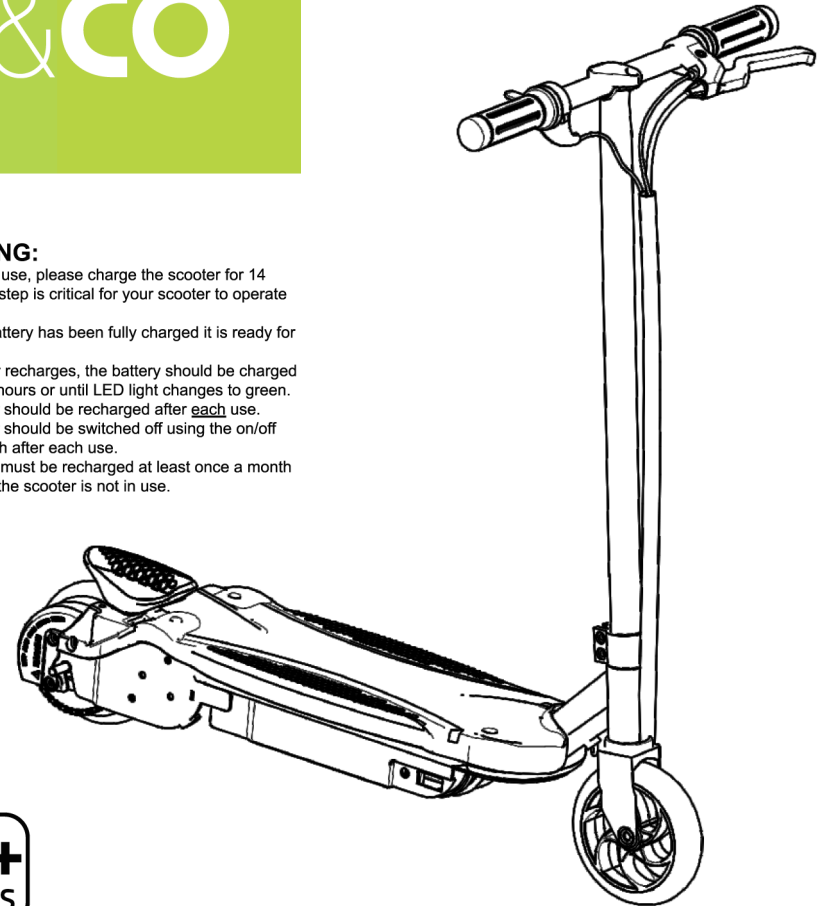

**8+**  
YEARS

**KEYCODE: 42504849**  
**ELECTRIC SCOOTER**  
**OWNER'S MANUAL**

**NOTE:** Manual illustrations are for reference purposes only. Illustrations may not reflect the exact appearance of the actual product. Specifications are subject to change without notice.



## 12 Month Warranty

Thank you for your purchase from Kmart.

Kmart Australia Ltd warrants your new product to be free from defects in materials and workmanship for the period stated above, from the date of purchase, provided that the product is used in accordance with accompanying recommendations or instructions where provided. This warranty is in addition to your rights under the Australian Consumer Law.

Kmart will provide you with your choice of a refund, repair or exchange (where possible) for this product if it becomes defective within the warranty period. Kmart will bear the reasonable expense of claiming the warranty. This warranty will no longer apply where the defect is a result of alteration, accident, misuse, abuse or neglect.

Please retain your receipt as proof of purchase and contact our Customer Service Centre on **1800 124 125** (Australia) or **0800 945 995** (New Zealand) or alternatively, via email at [customer.satisfaction@kmart.com.au](mailto:customer.satisfaction@kmart.com.au) for any difficulties with your product. Warranty claims and claims for expense incurred in returning this product can be addressed to our Customer Service Centre at 690 Springvale Rd, Mulgrave Vic 3170.

Our goods come with guarantees that cannot be excluded under the Australian Consumer Law. You are entitled to a replacement or refund for a major failure and compensation for any other reasonably foreseeable loss or damage. You are also entitled to have the goods repaired or replaced if the goods fail to be of acceptable quality and the failure does not amount to a major failure.

For New Zealand customers, this warranty is in addition to statutory rights observed under New Zealand legislation.

## Table of Contents

Safety and Warnings	Page 3-4
Before Assembly	Page 5
Assembly	Page 6-7
Before You Ride	Page 8
Hardware Maintenance	Page 8
Repair and Maintenance	Page 9-13
Scooter Parts	Page 14
Cleaning and Storage	Page 15
Troubleshooting Guide	Page 16
Warranty	Page 17

## Safety and Warnings

**WARNING:** Riding an electric scooter can be a dangerous activity. Certain conditions may cause components to fail without fault of the manufacturer. Scooter can and is intended to move and it is therefore possible to lose control, fall off and/or get into dangerous situations . **RIDE AT YOUR OWN RISK AND ALWAYS USE COMMON SENSE.**

This manual contains many warnings and cautions concerning the consequences of failing to inspect or maintain your electric scooter. **If these warnings and cautions are ignored incidents may occur which can result in serious injury or even death.**

### APPROPRIATE RIDING ATTIRE

- Always wear proper protective gear such as:
- Approved safety helmet.(Helmet may be legally required by local law or regulation in your area.)
- Elbow pads and knees pads
- Long sleeved shirt, long pants
- Gloves
- Lace up shoes with rubber soles, never ride barefooted or in sandals, and insure that shoelaces are tied and kept out of the way of the wheels and drive system

### RIDER USE AND PARENTAL SUPERVISION

**RIDER MUST NOT EXCEED THE WEIGHT LIMIT OF 55 KG..** Rider weight does not always mean a person's size is appropriate to fit or maintain control of the scooter.

This manual contains extremely important safety information. It is your responsibility to completely review this information and make sure that all riders understand all warnings, cautions, instructions and safety topics and assure that all riders are responsible to use the electric scooters safely. It is advised that you periodically review and reinforce all information in this manual with all riders, and that you inspect and maintain your scooter to insure their safety. Any rider that is unable to fit comfortably on the scooter should never attempt to ride it. A parent's decision to allow their child to use scooter should be based on the child's maturity, skill and their ability to follow rules.

Do not touch the motor or brakes on the scooter when in use or directly after use as these parts can become extremely hot.

Keep this scooter away from small children and remember that it is intended for use only by persons who are, at a minimum, completely competent and comfortable while operating this product.

### RIDING PRACTICES AND CONDITIONS

Check and obey any local laws or regulations which may affect the locations where the electric scooter may be used. Always ride defensively. Watch out for obstacles that could catch your wheel or force you to turn suddenly or lose control. Be careful to avoid pedestrians, other wheeled products (such as skaters, skateboards, scooters, bikes etc.), children or animals who may enter your path. Always respect the rights and property of others. Do not activate the speed control on the hand grip unless you are on the scooter and in a safe, outdoor environment that is suitable for riding.

Do not attempt or perform stunts or tricks on this electric scooter. This product is not made to withstand abuse from jumping, curb grinding or any other type of misuse or stunts.

Maintain a hold with both hands on the handlebars at all times.

## Warning

The scooter shall not be modified from the manufacturer's original design and configuration. The scooter shall not be operated to perform racing, stunt riding, or other maneuvers, which may cause loss of control, or may cause uncontrolled operator/passenger actions or reactions.

Owners shall be encouraged to highlight (for conspicuity) using lighting, reflectors, and for low-riding units, signal flags on flexible poles.

Persons with the following conditions shall be cautioned not to operate:  
 Those with heart conditions; Pregnant women; Persons with head, back, or neck ailments, or prior surgeries to those areas of the body; and Persons with any mental or physical conditions that may make them susceptible to injury or impair their physical dexterity or mental capabilities to recognize, understand, and perform all of the safety instructions and to be able to assume the hazards inherent in unit use.

Maximum operating speeds: 12KM/Hour

## Troubleshooting

Problem	Possible Cause	Solution
Scooter will not run	<ol style="list-style-type: none"> <li>1. Battery is not charged</li> <li>2. Wires or connectors are loose or unplugged</li> </ol>	<ol style="list-style-type: none"> <li>1. Fully charge the battery. First charge should be <b>14 hours</b> and up to 6 hours for recharges.</li> <li>2. Check to ensure that charger is tightly plugged into both the wall and the scooter.</li> </ol>
Scooter run time is short	<ol style="list-style-type: none"> <li>1. Battery requires charging</li> <li>2. Battery will not accept full charge</li> <li>3. Brakes are not adjusted correctly</li> </ol>	<ol style="list-style-type: none"> <li>1. Fully charge the battery. First charge should be <b>14 hours</b> and up to 6 hours for recharges.</li> <li>2. Check to ensure that charger is tightly plugged into both the wall and the scooter.</li> <li>3. Make sure power flow to the wall outlet is on.</li> </ol> <p>Battery may need to be replaced. Even with proper care, rechargeable batteries do not last forever. The average rechargeable battery life is 1 to 2 years depending on scooter conditions and use.</p> <p>Refer to the instructions on adjusting the brakes on page 9.</p>
Scooter suddenly stops working	Circuit breaker has tripped	<p>The reset button (on the left side of the battery box) will automatically trip and turn off the power if the motor is overloaded.</p> <p>An excessive overload (steep incline or too heavy of a rider) could have caused the motor to overheat and tripped the breaker. If this occurs (scooter suddenly stops running) wait a few seconds and then push the reset button in to reset the circuit. Avoid repeatedly tripping the breaker.</p> <p>Check all wires and connectors to make sure they are connected and tight.</p>
Scooter runs sluggishly	<ol style="list-style-type: none"> <li>1. Brakes are not adjusted correctly</li> <li>2. Scooter is overloaded</li> <li>3. Unsuitable riding conditions</li> </ol>	<ol style="list-style-type: none"> <li>1. Refer to the instructions on adjusting the brakes on page 9</li> <li>2. Make sure you do not overload the scooter by exceeding the <b>55kg</b> maximum weight limit, going up to steep inclines or towing objects behind the scooter. Avoid overloading the scooter as this will prematurely wear out the batteries and components.</li> <li>3. Ride only on solid, flat, clean and dry surfaces such as pavement or level ground.</li> </ol>

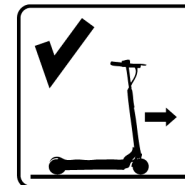
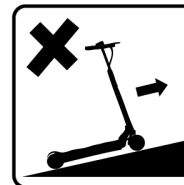

## Repair and Maintenance

### Front Wheel Replacement

Tools required: **Two 5 mm hex wrench (Excluded)**

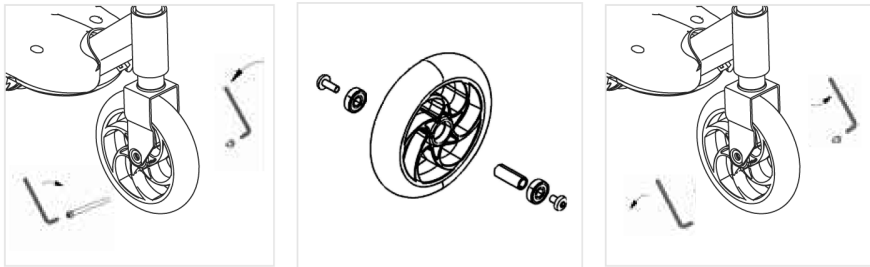

1. Using two **5 mm hex wrench** loosen and remove the front axle by turning the wrenches counter clockwise.

2. Reinstall new replacement wheel ensuring to note the order and location of all components.

3. Reinstall hardware and tighten clockwise with a **5 mm hex wrench**.

### Battery Care and Disposal

Do not store the battery in temperatures above 70 F (21 c) or below 32 F (0 c)

**Disposal:** This product contains sealed lead acid batteries which must be disposed or recycled in an environmentally safe manner. Do not dispose of the batteries in your household trash. Do not dispose of the batteries in a fire, this would cause the batteries to leak or explode. The incineration disposal in landfill and or placing sealed lead acid batteries with household trash is prohibited by law in most areas. Return exhausted batteries to a state or federal approved lead acid battery recycle or check with your local retailer of vehicle batteries.

**WARNING:** Do not mix old and new batteries. Do not mix alkaline standard (carbon-zinc), or rechargeable (nickel-cadmium) batteries.  
Do not store the battery in temperatures above 70F (21 c) or below 32F (0 c).

### Charger

Only use the supplied battery charger. If charger is damaged, discontinue using it.

### Wheels

Wheels and drive system components are subjected to normal wear and tear. It is the responsibility of the user to regularly inspect wheels for excess wear and adjust and replace drive train components as required.

## Cleaning and Storage

1. If product gets dirty, use a clean damp cloth and wipe gently on the plastic surface. Only use dry and clean cloth to clean surface on or near battery, electronic wires, plugs or any component related to electric parts.
2. Store after product is dried. Store the product in cool and dry place.

## Safety and Warnings

Never allow more than one person ride the scooter at the same time.

Never use near steps, water or swimming pools.

Keep your fingers and other body parts away from the chain, motor, steering system, wheels and all other moving components.

Never ride while using a cell phone or wearing headphones.

Never hitch on to another vehicle or pull anyone or anything.

Never immerse the scooter in water, electric and drive components could be damaged by water or create other possible unsafe conditions.

Ride only on flat, dry surfaces such as pavement or level ground without loose debris, such as sand, leaves, rocks or gravel. Water, mud, ice, bumpy, uneven, slick, or rough surface could impair traction and contribute to possible loss of control. Avoid excessive speed that can occur from downhill rides which could cause loss of control.

Do not ride at night or in areas of limited visibility.

Do not ride indoors or on surfaces that could become damaged such as carpet or flooring.

Before each ride the following checks will need to be performed to the **scooter:**

Ensure that the brake system is functioning properly.

All components are properly secured and are functioning according to manufacturers' specifications.

Components shall be maintained and repaired in accordance with the manufacturers' authorized replacement parts with installation performed by dealers or other skilled individuals.

### USING THE CHARGER

The charger should be regularly examined for damaged to the cord, plug, enclosure and other parts. In the event of such damage, if any is found, the scooter should not be charged until the charger has been repaired or replaced.

Use only with the supplied recommended charger:MODEL NO: LKC-144100-S

Charge only the 12V 8AH sealed lead acid battery for opp Electric Scooter 42504849

**WARNING:** Never install non-rechargeable battery inside the Scooter. Never use provided battery charger ( LKC-144100-S ) to charge non-rechargeable battery.

During charging, the battery must be placed in a well ventilated area.

This appliance is not intended for use by young children under 8 years old or infirm persons unless they have been adequately supervised by a responsible person to ensure that they can use the appliance safely

Young children should be supervised to ensure that they don't play with the appliance  
Always use caution when charging.

The charger is not a toy and should be operated by an adult.

Never operate charger near flammable materials or liquids.

Disconnect the charger and unplug from scooter when not in use.

Do not exceed recommended charging time.

Always disconnect the charger from the scooter prior to wiping down and cleaning with any liquid.

Examine the battery charger regularly for damage, especially the cord, plug and enclosure.

If the battery charger is damaged, it must not be used until it has been repaired.

The supply cord cannot be replaced if the cord is damaged the appliance should be scrapped.

**FAILURE TO HEED TO THE WARINGS LISTED ABOVE INCREASE RISK OF POTENTIAL SERIOUS INJURY. USE THE APPROPRIATE CAUTION WHEN RIDING AND ALWAYS WEAR PROTECTIVE GEAR.**

WARNING: Item to be assembled by adult only.

## Before assembly

**WARNING:** Make sure you remove all components from the box prior to assembly. Make sure that the power switch is turned "OFF" before assembling the scooter.

## Estimated Assembly Time

Allow up to 25 minutes for assembly, not including initial charge time.  
Allow up to 14 hours for the initial charge (see page 7 for charging information)

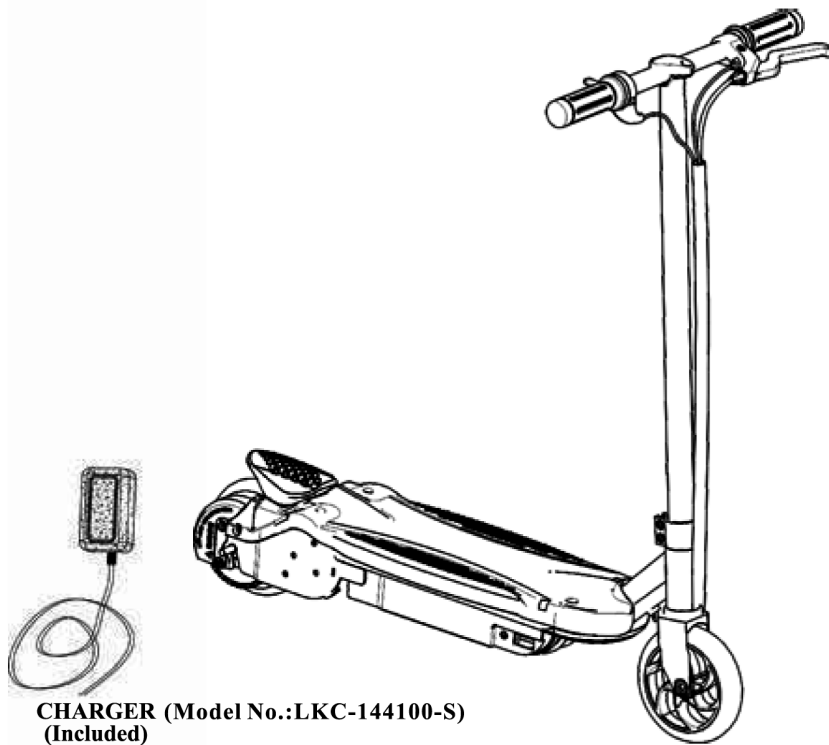

## Repair and Maintenance

### Adjusting the Chain

Tools required: **5mm hex wrench with phillips screw head, 10mm/14mm wrench. (Excluded)**  
**4mm hex wrench (Excluded)**

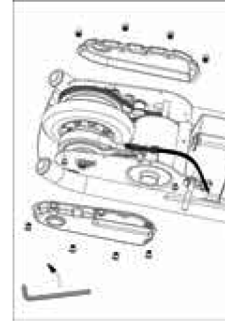

1. Using a **5mm hex wrench** remove the 4 protective cover bolts on both sides of the scooter.

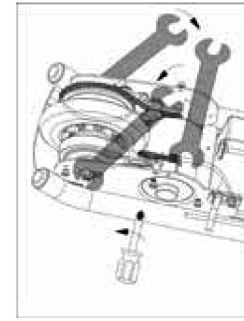

2. Loosen the brake arm bolt with a **Phillips screwdriver & 10mm wrench**. Using **two 14mm wrenches** loosen the rear wheel axle nuts.

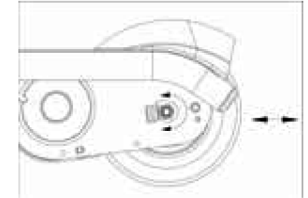

3. Rotate the adjustment washers against the frame tab to increase or decrease the chain tension. The recommended chain tension is based on of being able to twist the chain approximately 90 degrees.

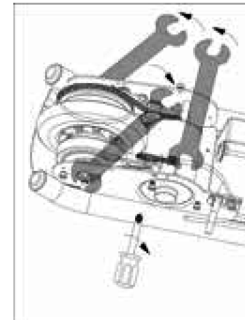

4. Ensure wheel is aligned in the frame and tighten the two axle bolts with a **14mm wrench**. Retighten the brake arm bolt with a **Phillips screwdriver and 10mm wrench**.

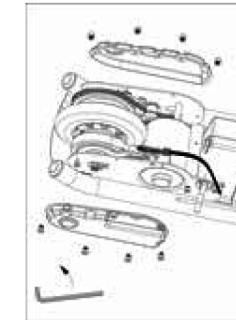

5. Reinstall side covers with a **4mm hex wrench**. Do not over tighten bolts.

## Repair and Maintenance

### Chain and Rear Wheel Replacement (Continued)

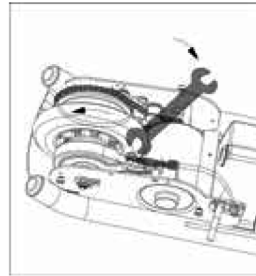
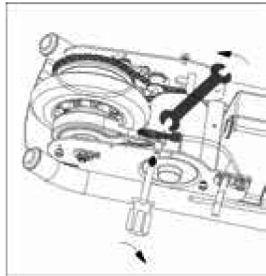
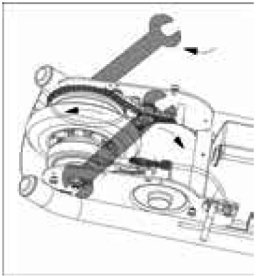

7. Ensure adjustment washers are seated correctly against the frame. After tightening axle nuts with a **14mm wrench** check wheel alignment and the tracking of the chain by rotating the wheel counter clockwise with your hand. Adjustment washers may need to be readjusted to align chain. Refer to the instructions on page 12 for proper chain tensioning.

8. Retighten the brake arm bolt with a Phillips screwdriver & **10mm wrench**.

9. Retighten brake cable pinch nut with **14 mm wrench**. Refer to the instructions on page 9 for proper adjustment.

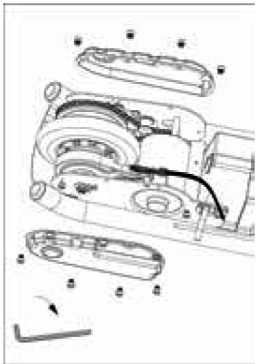

10. Reinstall side covers with a **5mm hex wrench**. Do not over tighten bolts.

## Required Tools for assembly(included)



8mm/10mm wrench (included) x1

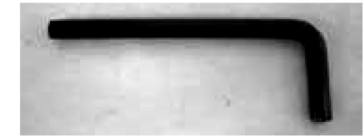

5mm hex wrench (included) x1

## Assembly

### Handlebar Steer Tube Assembly

Tools required: **5mm hex wrench** and **10mm wrench**

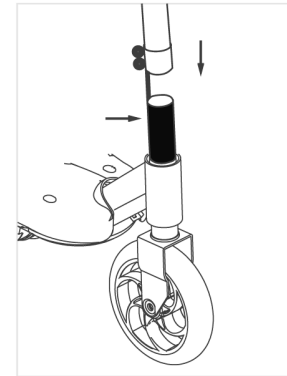

1. Depress the push button located on the rear of the fork and insert the handlebar steer tube onto the fork. The push button should align with the locator hole in the handlebar steer tube and lock the steer tube securely in place with 5mm hex wrench and 10mm wrench.

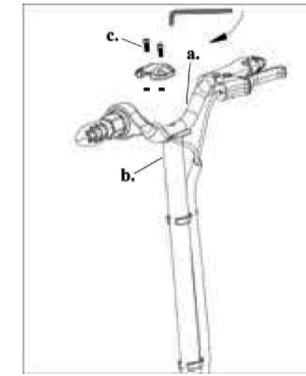

2. Align handlebars both vertically and horizontally (a) onto handlebar steer tube clamp (b) install handlebar clamp (c) and tighten evenly and securely with the **5mm hex wrench** and 10mm wrench.

## Assembly

### Charge the Battery

Required components: Charger

Initial battery charge time: **14 hours**

Recharges after initial charge- up to **6 hours**

When scooter is not in regular use batteries need to be charged on a monthly basis to maximize performance.

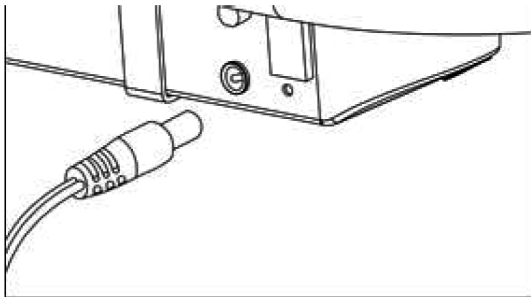

1. Make sure power switch is in the OFF position before plugging in the charger. Insert charger into charging port on the right side of the battery box.

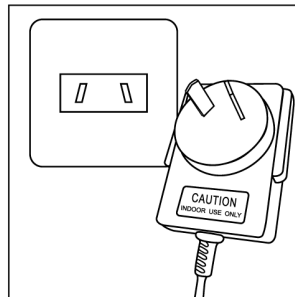

2. Plug the charger into a wall power outlet. The light on the charger housing should illuminate. **Green LED light** indicates battery is fully charged.

**WARNING:** When you first use your scooter you have charged the battery for at least **14 hours**. Failure to follow these instructions may damage your product and void your warranty.

Note: The charger has a small window with one LED light that indicates the charge status. Refer to the illustration on the charger unit for the actual “charging” and “charged” status indication. Your charger may get warm during use; this is normal and has no cause for concern.

For all other recharges, the battery should be charged for up to 6 hours or until LED light changes to green. The scooter should be recharged after each use. The scooter should be switched off using the on/off power switch after each use.

Note: Batteries must be recharged at least once a month even when the scooter is not in use. Failure to do so may result in batteries that will no longer charge.

## Repair and Maintenance

### Chain and Rear Wheel Replacement

Tools required: **5mm hex wrench with phillips screw head, 10mm/14mm wrench. (Excluded)**

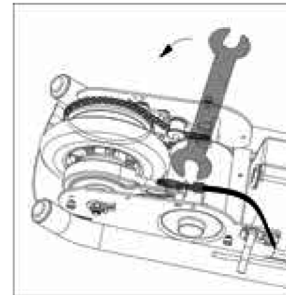

1. Loosen brake cable pinch nut with **10 mm wrench**.

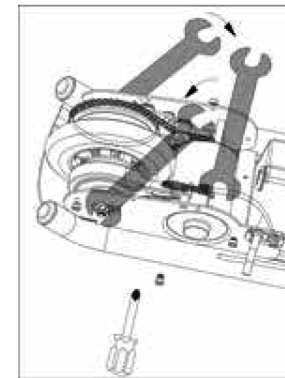

2. Remove the brake arm bolt with a Phillips screwdriver and **10mm wrench**. Using two **14mm wrenches** loosen the rear wheel axle nuts and adjustment washers and slide the chain off of the rear wheel pulley. Pull the wheel towards the rear of the frame.



3. Note the location of all rear wheel hardware and ensure to properly reinstall all items.

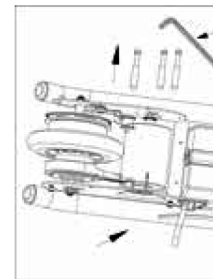

4. If replacing the chain remove the motor bolts with a **5mm hex wrench**. Slide motor out of the frame slightly so that there is enough room to remove/replace the chain onto the motor gear. Replace spacers and retighten bolts.

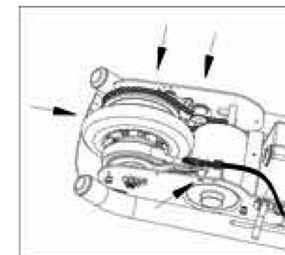

5. Install replacement wheel into the frame and slide chain back onto the pulley. Do not tighten axle nuts yet. Install brake arm hardware, do not tighten yet.



## Repair and Maintenance

**WARNING:** Turn the power switch “OFF” before conducting any maintenance procedures.

### Adjusting the Brakes

Tools required: **10mm wrench**

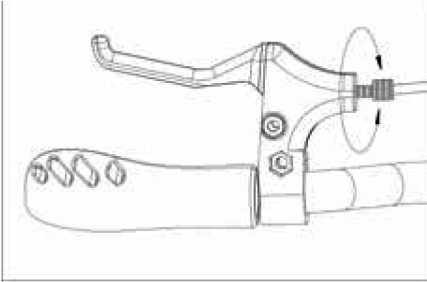

1. To adjust the brake cable thread clockwise (loosen) or counter clockwise (tighten) the adjuster barrel on the brake lever. Only turn the barrel in small increments until the desired adjustment is reached. If brake continues to need further adjustment proceed to the next step.

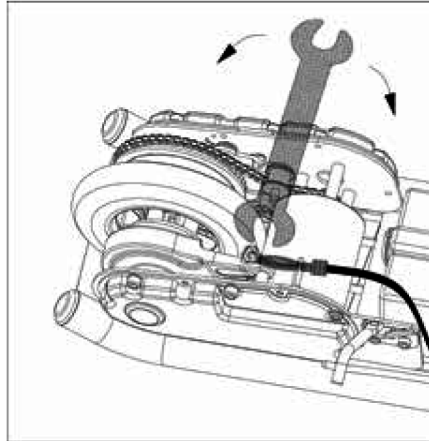

2. If the brake cable is still either too tight or too loose use a **10 mm wrench** to loosen the brake cable pinch bolt for further adjustment on the cable. Ensure that the 10mm nut is securely tightened after the adjustment is made.

## Before You Ride

**Before you ride always check and for the following:**

### Safety Gear

Always wear proper protective gear such as:

Approved safety helmet. (Helmet may be legally required by local law or regulation in your area).

Elbow pads and knees pads

Long sleeved shirt, long pants

Gloves

Lace up shoes with rubber soles.

### Brake

Check the brakes for proper function. When lever is squeezed it should slow/stop the rear wheel without excessive effort. When you apply the brake with the throttle on, the brake cut off switch should stop the motor. Make sure that the brakes are not rubbing when the lever is not being squeezed. Do not ride the scooter if the brakes are not functioning properly.

### Throttle

Turn the power switch to "ON" position, then kick the scooter to 3kph for motor to engage, the scooter will move when the throttle is twisted.

Make sure that before throttle is twisted that you are in an open and safe area to ride, you are balanced on the scooter and have both hands on the handlebar controls.

### Tyres

Inspect the wheels for excess wear and replace if necessary.

## Hardware Maintenance

### Brake:

Check the brakes for proper function. When you squeeze the lever, the brake should provide positive braking action. When you apply the brake with the speed control on, the brake cut off switch should stop the motor. Make sure that the brakes are not rubbing when the lever is not being squeezed.

### Frame, Fork and Handlebars

Check for cracks or broken connections. Although broken frames are rare, it is possible for aggressive rider to run into a curb or wall and bend or break the frame. Get in the habit of inspecting your scooter on a regular basis.

### Tyres

Periodically inspect the wheels for excess wear.

### Safety Gear

Always wear proper protective gear such as an approved safety helmet. Elbow pads and knee pads are recommended. Always wear athletic shoes (lace up shoes with rubber soles), never ride barefooted or in sandals, and keep shoelaces tied and out of the way of the wheels, motor and drive system.

### Battery

Make sure the power switch is turned off whenever the scooter is not in use. Never store the product in freezing or below freezing temperatures! Freezing will permanently damage the battery.

## Scooter Parts

1. Brake & handle grip
2. Thumb Throttle
3. Handle grip
4. Handle bar
5. Tube clamp
6. Front tube
7. Clamp
8. Seal bearing
9. Frame
10. Fork
11. 140mm front wheel
12. Bearing
13. On/off Switch
14. Charging Port
15. Reset Button
16. Battery
17. Controller
18. Deck
19. Plastic Deck
20. Kick stand
21. Motor
22. Brake set
23. Brake set
24. 145Rear wheel
25. Chain
26. Chain plate
27. Chain set cover
28. Chain ajustor
29. Battery box

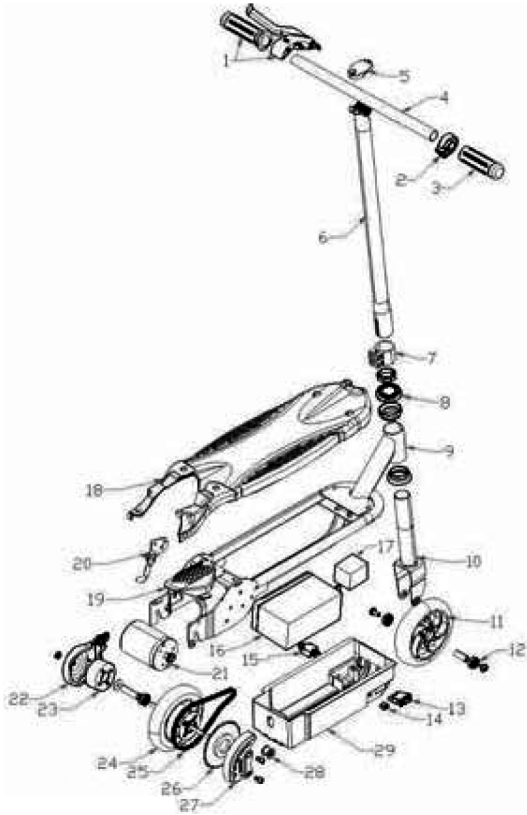

Power source: 12V Rechargeable, sealed lead acid battery

Charging time: Always charge the battery for 6 hours after first use and when recharging is needed, never charge for more than 20 hours

CHARGER ( LKC-144100-S )	INPUT:100-240VAC 50/60HZ 0.36A OUT PUT:14.4 V DC 1000mA
The first charging time	>14hours

## Frame, Fork and Components

Always carefully inspect your scooter before you ride. Check for cracks, broken worn or loose components which should be repaired or replaced before you ride.

## Battery

Always make sure the power switch is in the "OFF" position whenever the scooter is not in use. Never store the product in freezing or below freezing temperatures. These low temperatures will permanently damage the battery.

**WARNING:** Always ensure that you are in a safe open area to ride before you engage the throttle. Never twist the throttle without being on the scooter in a balanced, ready to ride position with both hands on the handlebar controls. Failure to follow these instructions may damage your scooter and void your warranty.

## USAGE

### Starting the Scooter

To start unit, turn on power switch; place both hands on handlebars and kick start the unit using one foot to push scooter forward while applying the throttle with right hand. The scooter must accelerate to 3kph for motor to engage.

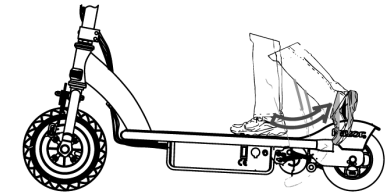
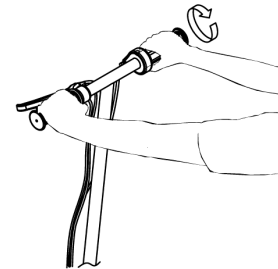

Note: Electric scooter must be moving at 3kph while engaging throttle to engage motor.

### Stopping the Scooter

To stop unit, release the throttle and apply the brake until the unit comes to a **complete stop**.

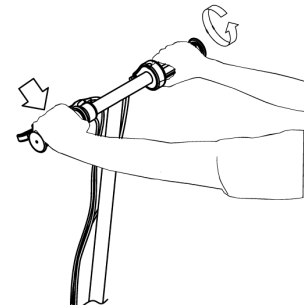

Note: As an additional safety feature, the scooter is designed to cut power to the motor when the hand brake is applied.