

# **anko**

**Chopper**  
**Model: CH1117AS**

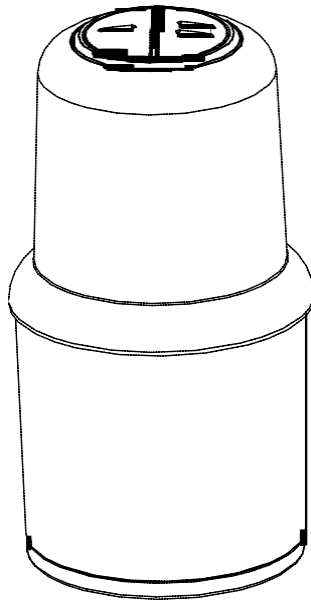

**PLEASE READ AND SAVE THESE INSTRUCTIONS FOR  
FUTURE REFERENCE.**

## 1. Important Safeguards

When using electrical appliances, basic safety precautions should always be followed including the following:

- Read all instructions carefully before you use the appliance.
- Always disconnect the appliance from the mains power outlet if it is left unattended, before cleaning and attaching or removing any accessories supplied with the product.
- This appliance is not intended for use by persons (including children) with reduced physical, sensory or mental capabilities, or lack of experience and knowledge, unless they have been given supervision or instruction concerning use of the appliance by a person responsible for their safety.
- Children should be supervised to ensure that they do not play with the appliance.
- If the supply cord is damaged, DO NOT use. For electrical safety, any repairs to the product should only be carried out by a qualified electrical person only or the product must be disposed of.
- Care must be taken when handling the sharp cutting blades, emptying the bowl and during cleaning.
- Switch OFF the appliance and disconnect from mains power before approaching parts that move in use.
- This appliance is intended to be used in household and similar applications such as:
  - staff kitchen areas in shops, offices and other working environments;
  - farm houses;
  - by clients in hotels, motels and other residential type environments;
  - bed and breakfast type environments.
- Be careful when chopping hot liquids, it can eject out of the appliance due to sudden steaming.
- Make sure your electricity supply is the same as the one shown on the product rating label before connecting to mains power.

- DO NOT operate the appliance with a damaged cord or plug or after the appliance malfunctions, or is dropped or damaged in any manner.
- Make sure the chopper blade is in place and that the power cord is not damaged before using the appliance every time.
- **IMPORTANT! Never put the power handle in water or other liquid or let the power switch, cord or plug get wet, you could get an electric shock.**
- Do not operate the chopper with wet hands. Always ensure your hands are dry before connecting the appliance to mains power.
- **WARNING: Risk of injuries if you don't use this appliance correctly.**
- Take special care when preparing food for babies, the elderly and infirm.
- Always ensure that the chopper blade is thoroughly sterilized by washing it with hot water.
- Never chop or mix hot oil or fat. Please follow the processing guide in this manual.
- For care and cleaning always follow instructions under the heading "Care and Cleaning" in this manual.
- Never let anybody trip over the power cord.
- Do not let the power cord touch hot surfaces or hang down where a child could grab and pull on the power cord.
- Disconnect from mains power outlet when it is not in use, before moving the appliance or when adding food for chopping.
- Do not use outdoors.
- Blades are sharp. Handle carefully.

**IMPORTANT! Never add ingredients to the chopper bowl while the machine is operating.**

**IMPORTANT! The continuous operating time must not exceed 30 seconds when using the chopper.**

**Allow the appliance to cool down at least 2 minutes between 2 running cycles. After operating 3 cycles continuously, allow the appliance to cool down for 30 minutes to before using it again. Failing to follow these instructions may cause electric motor failure.**

- The capacity of the ingredients must not exceed the maximum capacity (500ml) of the chopper bowl.
- Do not use the appliance to chop hard ingredients.
- Do not exceed the quantities and maximum time indicated in the operation guidelines or processing guide.
- Take the blade unit off before cleaning.
- The use of attachments not supplied with the product may cause a risk of injury to persons.
- Avoid coming in contact with moving parts.
- Keep fingers, hair, clothing and utensils away from moving parts.

**IMPORTANT! Keep hands and utensils out of the chopping bowl while chopping or mixing to avoid the risk of severe injury to persons or damage to the chopper.**

## 2. Description of Parts

- 1). Button I
- 2). Button II
- 3). Main body (motor unit)
- 4). Blade support
- 5). Blade
- 6). Chopping bowl

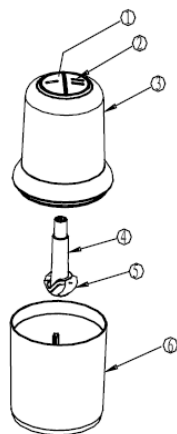

## 3. Specification:

- Model: CH1117AS
- Rating: 220-240V 50-60Hz 260W

## 4. Operation Guidelines

**Caution:** Blades are sharp. Handle carefully.

### Before using for the first time

Remove all packaging.

### To use the chopper

- Wash the blade unit and the chopping bowl in warm water. Wipe it dry.
- Fix the blade unit in the chopping bowl.
- Fill the bowl with food (not more than the maximum indicated level 500ml).
- Fit the main body (motor unit) onto the chopping bowl.
- Ensure the power cord is not damaged and the main body is in place.
- Connect the appliance into a mains power outlet. Turn ON the appliance by pressing and holding down the power switch button (the marking of "I" is for the lower speed, "II" for the higher speed.).
- Hold the outside of the chopping bowl with the other hand while operating.
- After you have completed chopping, release the power switch button, then disconnect it from mains power outlet.

**WARNING: To prevent damage to the electric motor, the continuous operating time must be less than 30 seconds. Allow the appliance to rest at least 2 minutes between 2 running cycles. After operating 3 continuous cycles, allow the appliance to cool down for 30 minutes before using it again.**

**Never chop hot oil or fat.**

- If your chopper gets blocked, first stop and disconnect the appliance from mains power before clearing.
- After use, disconnect from mains power.

- Remove the main body and then remove the blade unit out of the bowl by holding the plastic shaft, then pour out the food.
- The edge of the blade is very sharp, do not touch.
- Always switch OFF and unplug from mains power before cleaning. Please refer to “care and cleaning” instructions section in this manual.

## 5. Purpose

Chopping beef (less than 200g), nuts, breads, onions etc.

## 6. Processing guide

### The chopper

Food	Max. time	Max. quantity
beef pieces (size 20mm x 20mm x 20mm), nuts.	30 seconds	200g

## 7. Care and cleaning

- Always switch OFF and disconnect the appliance from the mains outlet before cleaning.
- Remove the main body.

**Caution: Take care when cleaning the blades as they are extremely sharp.**

**IMPORTANT! Do not use any part of the chopper in a dishwasher for cleaning.**

### The chopper main body

- The main body can only be wiped with a damp cloth, then dry
- **Never immerse in water or other liquid or use abrasives.**

### Other accessories

- The chopper bowl and the blade unit can be washed in warm water with dish washing liquid. Do not use hot water.
- Wash and rinse thoroughly with water, then allow it to dry.

## Storage

- Store in a cool, dry and ventilating place.

## 8. WARNING

1. Any other servicing should be performed by a qualified electrical person only.
2. **WARNING: To prevent damage to the electric motor, the continuous operating time must be less than 30 seconds. Allow the appliance to rest at least 2 minutes between 2 running cycles. After operating 3 continuous cycles, allow the appliance to cool down for 30 minutes before using it again.**
3. Never misuse this appliance. Care is needed when handling cutting blades, especially when removing the blade unit from the bowl and during cleaning.

## **12 Month Warranty**

Thank you for your purchase from Kmart.

Kmart Australia Ltd warrants your new product to be free from defects in materials and workmanship for the period stated above, from the date of purchase, provided that the product is used in accordance with accompanying recommendations or instructions where provided. This warranty is in addition to your rights under the Australian Consumer Law.

Kmart will provide you with your choice of a refund, repair or exchange (where possible) for this product if it becomes defective within the warranty period. Kmart will bear the reasonable expense of claiming the warranty. This warranty will no longer apply where the defect is a result of alteration, accident, misuse, abuse or neglect.

Please retain your receipt as proof of purchase and contact our Customer Service Centre on 1800 124 125 (Australia) or 0800 945 995 (New Zealand) or alternatively, via Customer Help at [Kmart.com.au](http://Kmart.com.au) for any difficulties with your product. Warranty claims and claims for expense incurred in returning this product can be addressed to our Customer Service Centre at 690 Springvale Rd, Mulgrave Vic 3170.

Our goods come with guarantees that cannot be excluded under the Australian Consumer Law. You are entitled to a replacement or refund for a major failure and compensation for any other reasonably foreseeable loss or damage. You are also entitled to have the goods repaired or replaced if the goods fail to be of acceptable quality and the failure does not amount to a major failure.

For New Zealand customers, this warranty is in addition to statutory rights observed under New Zealand legislation.