

anko

Hand-held Blender

Model: HB956SH6PA

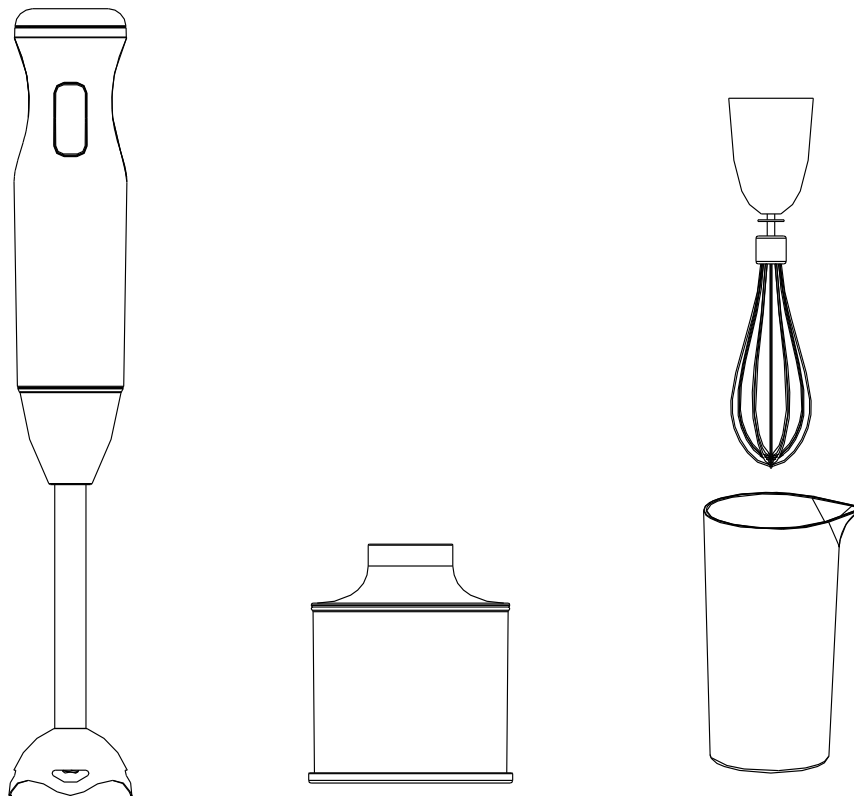

**PLEASE READ AND SAVE THESE
INSTRCTIONS FOR FUTURE REFERENCE**

1. Important Safety Instructions

When using electrical appliances, basic safety precautions should always be followed including the following:

- . Read all instructions carefully before you use the appliance.
- . Always disconnect the appliance from mains power supply if it is left Unattended and before assembling, disassembling or during cleaning.
- . This appliance is not intended for use by persons (including children) with reduced physical, sensory or mental capabilities, or lack of experience and knowledge, unless they have been given supervision or instructions concerning use of the appliance by a person responsible for their safety.
- . Children should be supervised to ensure that they do not play with the appliance.
- . For electrical safety, if the supply cord is damaged, it must be replaced by a qualified electrical person only or the product must be disposed.
- . Care shall be taken when handling the sharp cutting blades, emptying the bowl and during cleaning.
- . Switch OFF the appliance and disconnect from mains power before changing accessories or approaching parts that move in use.
- . This appliance is intended to be used in household and similar applications such as:
 - staff kitchen areas in shops, offices and other working environments;
 - farm houses;
 - by clients in hotels, motels and other residential type environments;
 - bed and breakfast type environments.

CAUTION: Be careful when blending hot liquid, it can eject out of the appliance due to sudden steaming.

- . Make sure your electricity supply is the same as the one shown on the product rating label before connecting to mains power.
- . Do not allow children to use the appliance without supervision.
- . Do not operate the appliance with a damaged cord or plug or after the appliance malfunctions, or is dropped or damaged in any manner.

IMPORTANT! Never put the power handle in water or other liquid or let the power switch, cord or plug get wet, you could get an electric shock.

CAUTION: Electric shock hazard. Do not operate the blender with wet hands. Make sure the hands are completely dry before connecting the appliance to mains power.

- . Make sure the blender shaft, whisk or chopper in place, the power cord is not damaged before using the appliance every time.
- . Never let the blades face towards anybody while operating the appliance.
- . Take special care when preparing food for babies, the elderly and infirm.
- . Always ensure that the hand blender shaft, whisk or chopper is thoroughly sterilized by washing it with hot water.
- . Never blend or mix hot oil, fat. Please follow the processing guide in the manual.
- . Do not let the power cord hang over edge of the table or counter.
- . Never let anybody trip over the power cord.
- . Do not let the power cord touch hot surfaces or hang down where a child could grab and pull on the power cord.
- . Unplug from mains power outlet when it is not in use, before moving the appliance or when adding the food for blending or chopping and before cleaning.
- . Do not use outdoors.
- . Blades are sharp. Handle carefully.
- . Never touch the blades or whisk while the machine is connected to mains power.
- . Never add ingredients while the hand blender is operating.
- . The ingredients used should does not exceed the maximum capacity of the chopper bowl.
- . Do not continuously operate the blender for too long. The motor may overheat. If the surface of the hand blender becomes very hot, allow it to cool down to room temperature before using it again.

IMPORTANT! The continuous operating time without the load must be less than 15 seconds.

- . Do not exceed the quantities and maximum time indicated in the operation guidelines or processing guide.
- . Take the attachments off before cleaning.
- . The use of attachments not supplied with the product may cause injury.
- . Avoid contacting moving parts.
- . Keep fingers, hair, clothing and utensils away from moving parts.

IMPORTANT! Keep hands and utensils out of the container which holds the food while blending or cutting to reduce the risk of severe injury to persons or damage to the blender.

WARNING:

- . Any repairs to the product should only be carried out by a qualified electrical person only or the product must be disposed.
- . Never misuse this appliance. Care is needed when handling the cutting blades, especially when cleaning.
- . Always reattach the protective cover to the blades after cleaning.

2. Description of Parts

- 1). Speed adjuster
- 2). Switch button
- 3). Power handle
- 4). Blender shaft (removable)
- 5). Blender blade protective cover
- 6). Chopper (including lid, blade unit and bowl)
- 7). Beaker
- 8). Whisk and whisk head

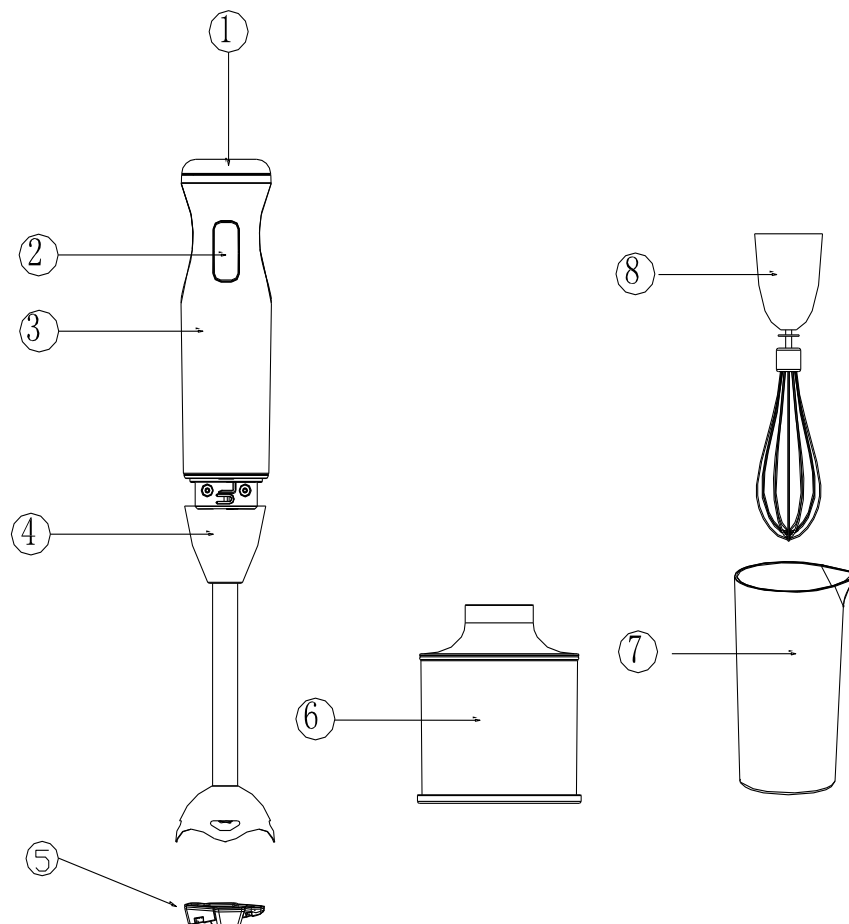

3. Specifications

- . Speed adjusting settings.
- . Rating: 220-240V 50-60Hz 600W

4. Operation Guidelines

Caution: Blades are sharp. Handle carefully.

Before using the blender for the first time

- . Remove all packaging carefully and inspect the product for any damages.
- . Check the blender and power cord for any damages.
- . If the product is damaged or any parts are missing, DO NOT USE.

How to use the hand blender

- . Remove the protective cover from the blade on the blender shaft.
- . Clean the blender shaft and beaker.
- . Fit the power handle inside the blender shaft, turn it clockwise and lock until you hear a slight click.
NOTE: The marks on the power handle and blender shaft should be aligned with each other. If it is aligned, the blender shaft is locked correctly.
- . Make sure your electricity supply is the same as the one shown on the product rating label.
- . Fill the food /ingredients to the beaker (not more than the maximum indicated level) to hold the food for blending.
- . Connect the appliance into a mains power outlet and hold the power handle steady. Switch the appliance on by pressing the switch button.
- . Gently immerse the blade guard completely in the ingredients.
- . Blend the ingredients by moving the appliance slowly up and down and in circles.
- . After you have completed blending, release the switch button, then disconnect from mains power outlet.

WARNING: To prevent damage to the electric motor, the continuous operating time is 30 seconds for lower speed and 10 seconds for higher speed. Allow the appliance to reset at least 2 minutes between each cycle. After operating 5 continuous cycles, allow the appliance to cool down for 30 minutes before using it again.

Never blend hot oil, fat or meat.

- . If your blender/chopper gets blocked, first stop and disconnect from mains power before clearing.
- . After use, always disconnect from mains power.
- . Always switch OFF and unplug from mains power before cleaning. Please refer to “care and cleaning” instructions section in this manual.

How to use the chopper

- . Remove the protective cover from the blade on the chopper.
- . Clean the lid, blade unit and the chopper bowl.
- . Fix the blade unit in the chopper bowl.
- . Fill the food/ingredients to the bowl (not more than the maximum indicated level).
- . Fit the power handle inside the chopper, turn it clockwise and lock it until you hear a slight click.

NOTE: The marks on the power handle and blender shaft should be aligned with each other. If it is aligned, the blender shaft is locked correctly.

- . Check the chopper and power cord for any damages.
- . Make sure your electricity supply is the same as the one shown on the product rating label.
- . Connect the appliance into a mains power outlet, adjust the desired speed setting, hold the power handle steady. Switch the appliance ON by pressing on the switch button.
- . After blending, release the switch button then disconnect the blender from mains power outlet.

WARNING: To prevent damage to the electric motor, the continuous operating time must be less than 30 seconds. Allow the appliance to rest at least 2 minutes between 2 running cycles. After operating 3 continuous cycles, allow the appliance to cool down for 30 minutes before using it again.

Never chop hot oil, fat.

- . If the blender gets blocked, first stop and disconnect the blender from mains power before clearing.
- . After use, always disconnect from mains power outlet and remove power handle and the lid unit in sequence, take the blade out of the bowl by holding the plastic shaft, then pour out the food.
- . The edges of the blade is very sharp, do not touch them.
- . Always switch OFF and unplug from mains power before cleaning. Please refer to “care and cleaning” instructions section in this manual

To use the whisk

- . Clean the whisk and beaker.
- . Insert the whisk into the whisk head until you hear a slight click.
- . Fit the power handle inside the whisk, turn and lock until you hear a slight click. The marks on the power handle and the whisk head should now be aligned with each other. If this is the case, the whisk is locked correctly.
- . Check the whisk and power cord for any damages. DO NOT use if damaged.
- . Make sure your electricity supply is the same as the one shown on the product rating label.
- . Fill the food/ingredients to the beaker (not more than the maximum indicated level) to hold the food for whisking.
- . Connect the appliance into a mains power outlet socket, adjust the desired speed setting, hold the power handle steady. Switch the appliance ON by pressing the switch button.

- . To prevent splashing, use the Low speed to mix when starting.
- . Gently immerse the whisk completely in the ingredients.
- . Whisk the ingredients by moving the appliance slowly up and down and in circles.
- . After you have completed mixing, release the switch button, then disconnect from mains power outlet.

WARNING: To prevent damage to the electric motor, the continuous operating time is 3 minutes. Allow the appliance to reset at least 2 minutes between each cycle. After operating 5 continuous cycles, allow the appliance to cool down for 30 minutes before using it again. Never whisk hot oil, fat or meat.

- . If your whisk gets blocked, first stop and disconnect from mains power before clearing.
- . After use, always disconnect from mains power.
- . Always switch OFF and unplug from mains power before cleaning. Please refer to “care and cleaning” instructions section in this manual.

5. Purpose

The hand blender

- . Blending fluids e.g. dairy products, sauces, fruit juices, soups, mixed drinks and shakes.
- . Mixing soft ingredients, e.g. pancake batter or mayonnaise
- . Pureeing cooked ingredients, e.g. for making baby food

The chopper

- .Chopping beef (less than 200g), nuts, breads, vanilla, onions

The whisk

Whisking egg whites and cream.

6. Processing guide

The hand blender

Food	Speed	Max. time	Max. quantity
soups, milk vegetables, mayonnaise sauces, strawberry	lower speed	30 seconds	200g
carrot pieces	higher speed		500g

(size 15mm x 15mmx15mm)		10 seconds	Note: use 200g of carrot pieces per 300g water.
-------------------------	--	------------	---

The chopper

Food	Speed	Max. time	Max. Quantity
beef pieces (size 20mm x 20mm x 20mm), almonds	higher speed	30 seconds	200g

The whisk

Food	Speed	Max. time	Max. Quantity
cream, egg whites	higher speed	3 minutes	200g

7. Care and cleaning

- . Always switch off and disconnect the appliance from mains power outlet before cleaning.
- . Remove the attachments.
- . Don't touch the sharp blades.

CAUTION: Take care when cleaning the blades as they are extremely sharp.

NOTE: Do not put any part of the product in a dishwasher for cleaning.

The power handle and power cord

- . Wipe with a damp cloth, then dry.
- . **Never immerse in water or other liquid or use abrasives for cleaning.**

The beaker

- . The beaker can be washed in water with cleaning agent.
- . Wash and rinse thoroughly with water, then allow to dry.

The blender shaft

- . The shaft can be washed in warm water with cleaning agent.
- . Wash and rinse thoroughly with water, then allow to dry.
- . Reattach the protective cover to the blade.

The chopper

- . The lid unit of the chopper can only be wiped with a damp cloth, then allow to dry.
- . **Never immerse in water or other liquid or use abrasives for cleaning.**
- . The bowl and the blade can be washed in warm water with cleaning agent.

- . Wash and rinse thoroughly with water, then allow to dry.
- . Reattach the protective cover to the blade.

The whisk

- . The head of whisk can only be wiped with a damp cloth, then allow to dry.
- . **Never wash and rinse in water or use abrasives for cleaning.**
- . The other part of whisk can be washed in warm water with cleaning agent.
- . Wash and rinse thoroughly with water, then allow to dry.

Storage

- . Store in a cool, dry and ventilating place.

12 Month Warranty

Thank you for your purchase from Kmart.

Kmart Australia Ltd warrants your new product to be free from defects in materials and workmanship for the period stated above, from the date of purchase, provided that the product is used in accordance with accompanying recommendations or instructions where provided. This warranty is in addition to your rights under the Australian Consumer Law.

Kmart will provide you with your choice of a refund, repair or exchange (where possible) for this product if it becomes defective within the warranty period. Kmart will bear the reasonable expense of claiming the warranty. This warranty will no longer apply where the defect is a result of alteration, accident, misuse, abuse or neglect.

Please retain your receipt as proof of purchase and contact our Customer Service Centre on 1800 124 125 (Australia) or 0800 945 995 (New Zealand) or alternatively, via Customer Help at Kmart.com.au for any difficulties with your product. Warranty claims and claims for expense incurred in returning this product can be addressed to our Customer Service Centre at 690 Springvale Rd, Mulgrave Vic 3170.

Our goods come with guarantees that cannot be excluded under the Australian Consumer Law. You are entitled to a replacement or refund for a major failure and compensation for any other reasonably foreseeable loss or damage. You are also entitled to have the goods repaired or replaced if the goods fail to be of acceptable quality and the failure does not amount to a major failure.

For New Zealand customers, this warranty is in addition to statutory rights observed under New Zealand legislation.