

anko

**Blender
207414
User Manual**



**PLEASE READ AND SAVE THESE
INSTRUCTIONS FOR FUTURE REFERENCE**

IMPORTANT SAFEGUARDS

When using any electrical product, always follow these basic safety precautions:



READ ALL INSTRUCTIONS BEFORE USE.



WARNING-- To reduce the risk of fire, electric shock, or serious personal injury:

- Always ensure the product is unplugged from the electrical power outlet socket before relocating, assembling, disassembling, or cleaning it. Always unplug the product from the electrical outlet when it is not in use.
 - This product is not intended for used by persons (including children) with reduced physical, sensory or mental capabilities, or lack of experience and knowledge, unless they have been given supervision or instructions concerning use of the products by a person responsible for their safety.
 - Children should be supervised to ensure that they do not play with the product.
 - Keep the product out of the reach of children and pets. This product is not intended for use by children. Close supervision is necessary when using this product near children.
 - Do not leave the product unattended while it is in use, especially when children are present.
 - Do not let cord hang over edge of table or counter or touch hot surface including stove.
 - Do not immerse power cord, plug, or product in water or other liquids. If the product falls into water, immediately disconnect it from mains power outlet socket. **DO NOT touch or reach into the water.**
 - Keep the Power Cord and product away from heated surfaces.
 - The use of attachments not supplied with the product may cause injury to persons or damage to property.
 - Handle the blades with care as they are **extremely sharp**. Use caution when attaching or detaching the Blades.
 - Care is needed when handling cutting blades, especially when removing the blade from the jug emptying the jug and during cleaning.
 - Do not touch the moving parts (e.g., the blades) while the product is in use.
- WARNING: Do not touch the cutting blades or insert any object, such as knives, forks, spoon etc. into the jug while the blender is in operation.**
- **Keep hands and utensils away from the moving blades while operating the product.** A scraper may be used but only when the product is not operating.

IMPORTANT! For electrical safety, do not plug/unplug the product into/from the electrical power outlet with a wet hand.

- To disconnect the product from an electrical power outlet, pull directly on the plug; do not pull on the power cord.
- Always operate the product with the jug lid in place.

- **WARNING: DO NOT process boiling liquids or hot ingredients. Hot liquids/ingredients can eject out of the appliance due to a sudden steaming and cause severe scalding. Allow hot ingredients to cool before placing them in the jug.**
- Never place the blade assembly on the base unless it is attached to the Jar.
- Do not put any stress on the power cord where it connects to the product, as the power cord could fray and break.

IMPORTANT! Never operate the blender when the jug is empty and DO NOT remove the jug lid before the blades come have to a complete stop.

- Switch OFF the product and disconnect from mains power supply before changing accessories or approaching parts that move in use.
- If the supply cord is damaged, it must be replaced by qualified electrical person in order to avoid a hazard or the product must be disposed of.
- Misuse may cause injury.
- This product is for **household use only**, not designed for commercial use.

WARNING: The maximum operating time is 1 minute. Allow it to rest for at least 3 minutes before using it again. After 5 cycles of operation, allow the blender (electric motor) to cool down to room temperature by allowing it to cool down for approx. 30 minutes before using it again. Failing to follow these instructions may cause electric motor burnout.



CAUTION-- To reduce the risk of personal injury or product/property damage:

- This product is intended for indoor, non-commercial, non-industrial use in processing foods for human consumption. Do not use the product outdoors or for any other purpose.
- Always operate the product on a flat, stable surface.
- Do not attempt to open any part of the Motor Housing.
- Do not let cord hang over edge of table or counter where it may be tripped over or pulled.

CAUTION: Ensure that the blender is switched OFF before removing it from the stand.

SPECIAL INSTRUCTIONS:

A short power supply cord is provided to reduce the risk of becoming entangled in or tripping over a longer cord. Extension cord may be used if care is exercised in their use:

- The marked electrical rating must be at least as great as that of the product;
- If the product is of the grounding type, the extension cord must be a grounding-type 3-wire cord;
- Place the longer cord in a way that it will not drape over a countertop or tabletop where it can be tripped over, snagged, or pulled on unintentionally (especially by children).

**SAVE THESE INSTRUCTIONS
FOR HOUSEHOLD USE ONLY**

PARTS AND FEATURES

Fig. 1

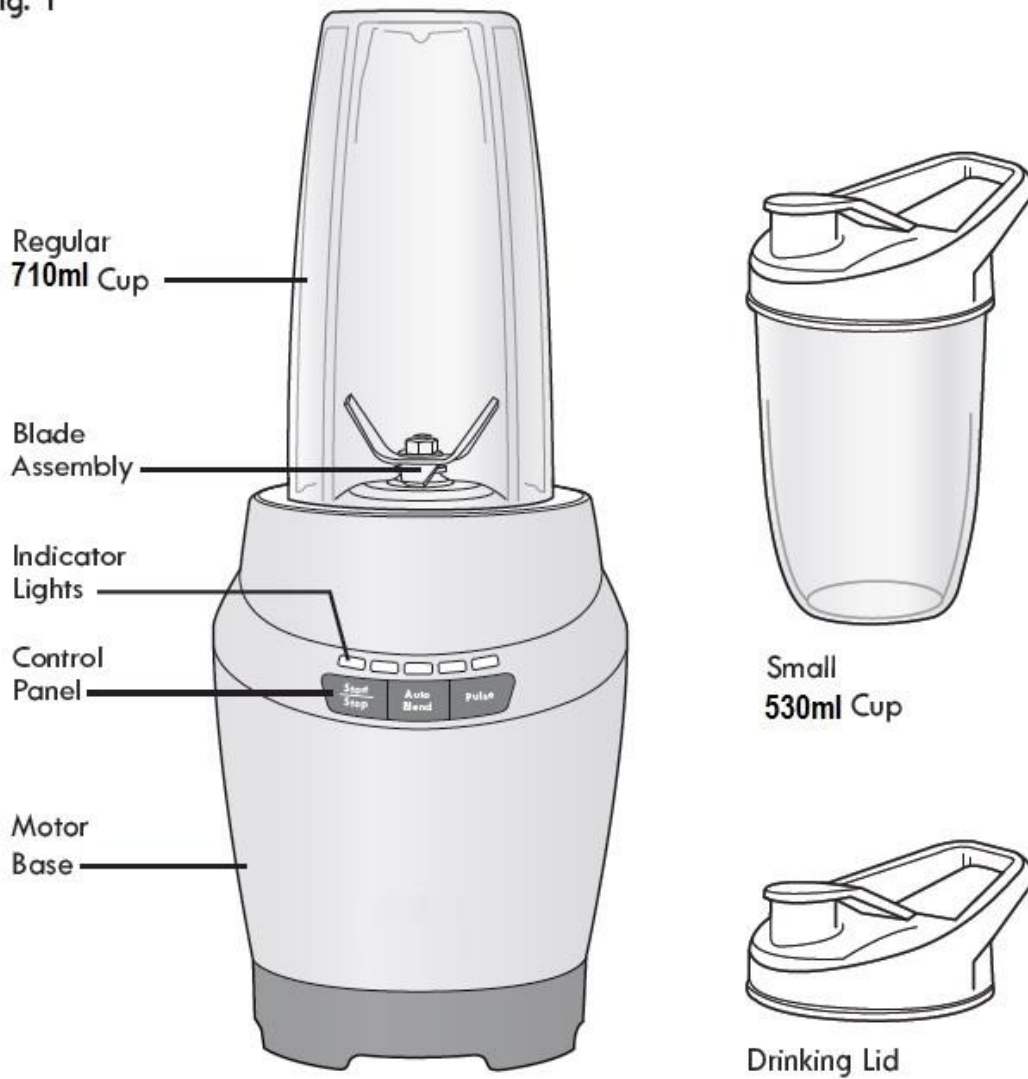

DRINKING LID

The Drinking Lid will screw onto the top of either cup to keep blended contents contained and available for drinking directly from the cup.

NOTE: the drinking lid is not drip proof. To avoid spillage always place the cup with drinking lid facing up.

BEFORE FIRST USE

1. Remove all packaging material and labels from the appliance.
2. Wash the lids, cups and blade assembly in warm soapy water with a soft cloth. Use caution when washing the blade assembly as the blades are very sharp.
3. Rinse and dry thoroughly.
4. Wipe the motor base clean with a damp cloth.



CAUTION: NEVER place blender motor base in water or other liquid.



CAUTION: Blades are sharp. Handle carefully.

FUNCTIONS

When the blender cup is inserted correctly onto the motor base, the first operation indicator light will flash to show that the blender is in standby mode.

Your blender has been designed with 3 blend functions: Start/Stop, Auto Blend and Pulse.

Start/Stop

Press the **Start/Stop button** to run the blender. All five of the control panel operation indicator lights will illuminate. The unit will keep running for 60 seconds, and then stop. To stop the blender at any time during operation, press **Start/Stop Button**. The blender will return to standby mode with only the first indicator light flashing.

Auto Blend

Press the **Auto Blend button**, the unit will begin and run for 60 seconds. During operation, the motor will start and stop 8 times, this is normal. The first operation indicator light will remain illuminated and the remaining 2-5 indicator lights will illuminate in sequence as the motor runs. When the Auto Blend function is finished, the blender will return to standby mode with only the first operation indicator light flashing. To stop the Auto Blend function at any time, press the **Start/Stop button** or the **Auto Blend button**.

Pulse

Press and hold the Pulse button to run the blender in Pulse mode. The operation indicator lights will illuminate in sequence as the button is pressed. The blender will keep running until the pulse button is released. The blender will return to standby mode with only the first indicator light flashing.

WARNING: The maximum operating time is 1 minute (60 seconds). Allow it to rest for at least 3 minutes before using it again. After 5 cycles of operation, allow the blender (electric motor) to cool down to room temperature by allowing it to cool down for approx. 30 minutes before using it again. Failing to follow these instructions may cause electric motor burnout.

OPERATION

CONTROL PANEL

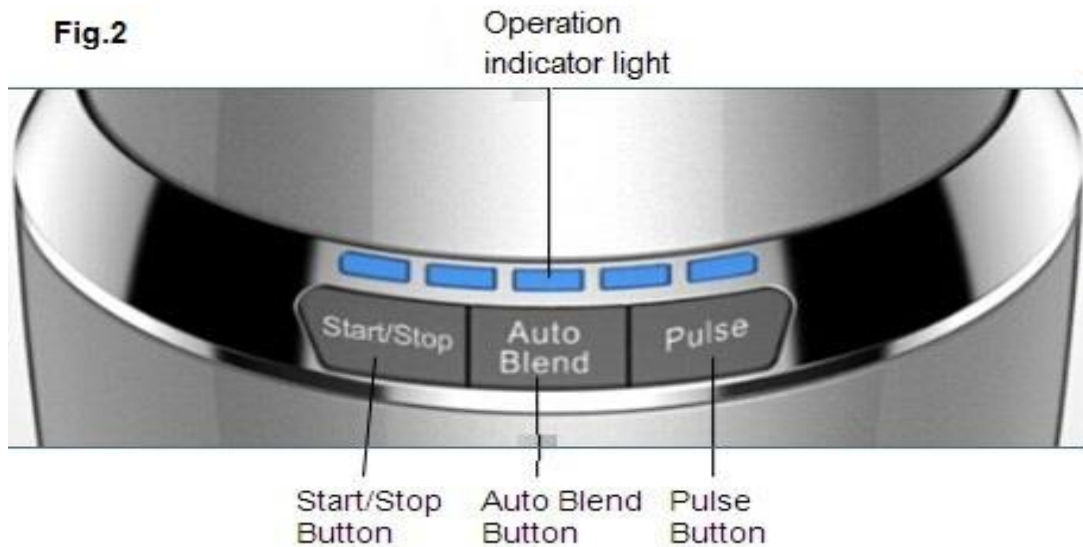

OPERATE THE BLENDER



IMPORTANT: Place the motor base on a clean, dry, level surface such as a counter or table top.

1. Connect the appliance into a main power outlet socket.
2. Add ingredients to the cup. DO NOT overfill. To avoid spilling, do not add ingredients above the "MAX" fill line.
3. Place the blade assembly onto the cup and twist it on tightly until you have a good seal. (Fig.3)
4. Turn the cup upside down and place it onto the motor base, aligning the tabs on the cup with the motor base. Turn it clockwise, until you feel it click into place. The blender is now on standby mode with the first operation indicator light flashing. (Fig.4, Fig.5)
5. Press the Start/Stop, Auto blend or Pulse button to run the blender (Fig.6, Fig.7). In Auto blend mode, the blender will operate in a series of pulses, pauses and continuous runs.

Fig. 3



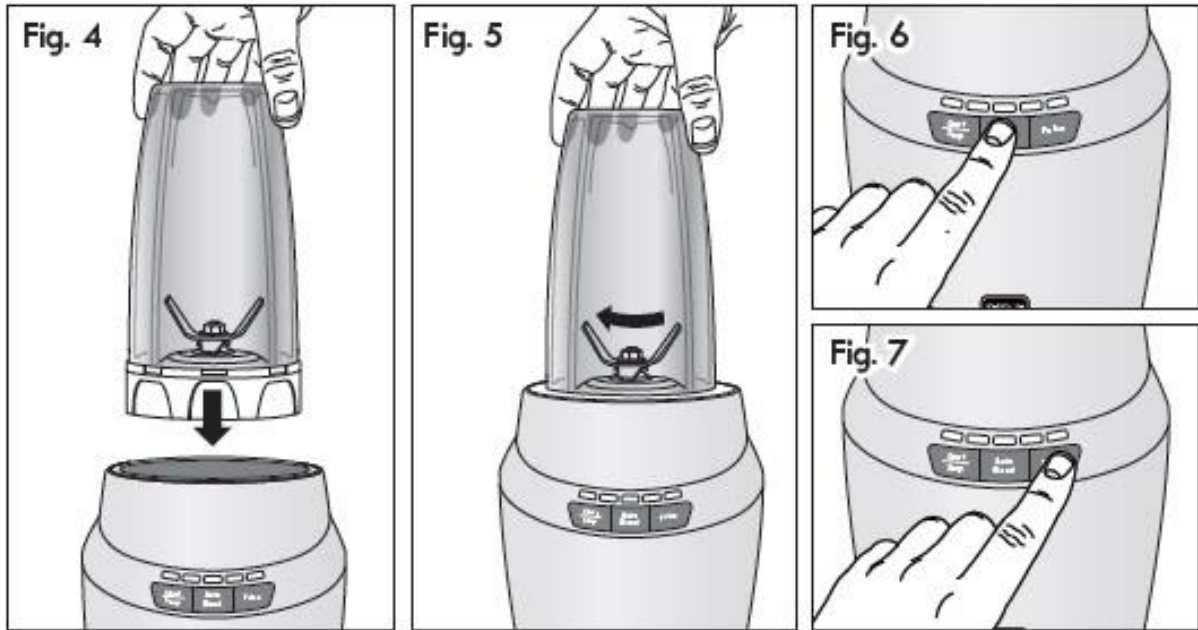

6. To remove the cup, ensure that the motor has stopped running. Then turn the cup counter clockwise and pull straight up to remove. (Fig.8, Fig.9).
 7. Turn the cup upright and remove the blade assembly by twisting the blade assembly counterclockwise. Be sure to store the blade assembly attached to one of the blender cups when not in use.
 8. Twist the Drinking Lid onto the top of either cup. You may enjoy your drink on the go!
- NOTE: the drinking lid is not drip proof. To avoid spillage always place the cup with drinking lid facing up.**

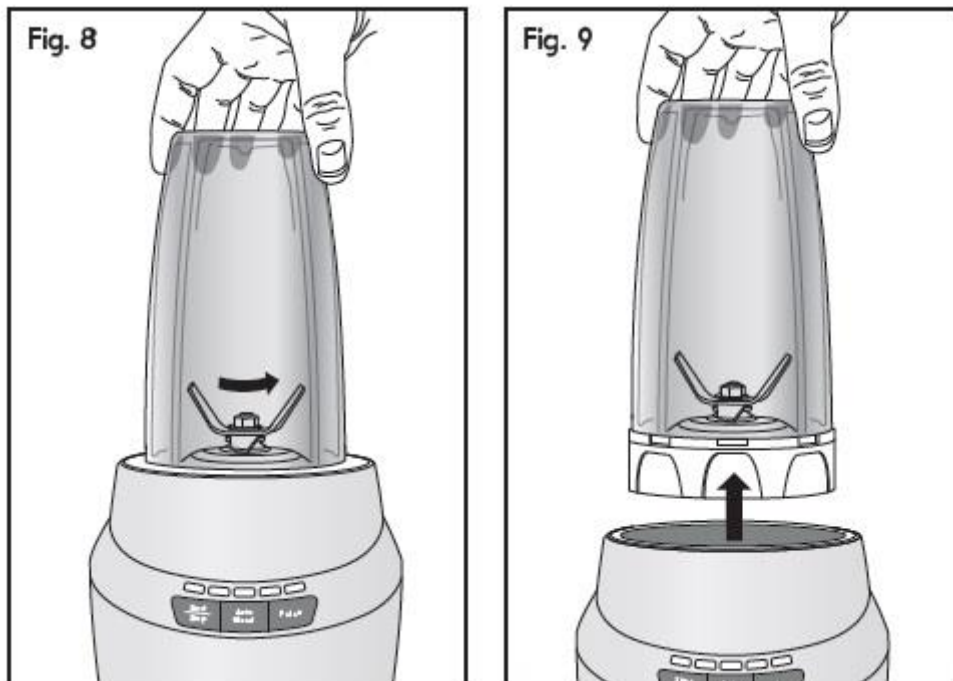

TIPS AND TECHNIQUES

For quicker, easier blending, cut food into 5cm long pieces before adding to blender cup. To chop or grate either fresh or frozen fruit, cut fruit into pieces about 2cm long. To best circulate foods or fruit that are to be blended with liquid, pour the liquid into the cup first, then add the solid foods or fruit.

The following tasks cannot be performed efficiently with a blender: beating egg whites, whipping cream, mashing potatoes, grinding meats, mixing dough, and extracting juices from fruit and vegetables.

IMPORTANT! The following items should never be placed in the blender cup, as they can cause damage: bones, large pieces of solid frozen foods, or dense, tough foods such as turnips.



CAUTION: Failure to follow all of the above directions can result in damage to the blades, cup, blender motor, and possibly result in personal injury.

Suggested Uses`

PURPOSE/FUNCTION	SUGGESTED CUP	TYPE OF FOOD
Chopping / Pulsing	530 ml	Salsa
	710 ml	Leafy Herbs
Mixing	710 ml	Batters
		Dips
Sauces	710ml	Vinaigrettes
		Salad Dressings
		Simple Sauces
Frozen Blending	530 ml	Ice
	710 ml	Frozen Fruit
		Ice Cream
Nutrient Juices/Smoothies	530 ml	Fruits
	710 ml	Vegetables
		Leafy Greens



CAUTION: DO NOT process dry ingredients without adding liquid to the cup. This product is not intended for dry blending.

CARE AND CLEANING

1. Before cleaning, disconnect the blender from mains power outlet socket.
2. Rinse parts (blender cups and blade assembly) immediately after blending, for easier clean up.
3. All removable parts can be washed by hand or in a dishwasher. The blending cups, blade assembly should be placed in the top rack only.

IMPORTANT! To avoid heat damage, never place the cups or other parts into boiling water.



CAUTION: The blender blades are sharp. Be very careful when washing them by hand to avoid being cut.

4. The motor base is NOT designed to be resistant to liquids. If liquids spill into the motor base:
 - Unplug the motor base from mains power.
 - Wipe with a damp cloth and dry it thoroughly.
 - NEVER immerse the motor base in water or other liquid.
5. Do not use abrasive scouring pads or cleaners on motor base or the plastic cups as finish may become scratched or damaged.

TECHNICAL DATA

Model no.: 207414

Voltage: 220-240V~ 50-60Hz

Power: 1000W

12 Month Warranty

Thank you for your purchase from Kmart.

Kmart Australia Ltd warrants your new product to be free from defects in materials and workmanship for the period stated above, from the date of purchase, provided that the product is used in accordance with accompanying recommendations or instructions where provided. This warranty is in addition to your rights under the Australian Consumer Law.

Kmart will provide you with your choice of a refund, repair or exchange (where possible) for this product if it becomes defective within the warranty period. Kmart will bear the reasonable expense of claiming the warranty. This warranty will no longer apply where the defect is a result of alteration, accident, misuse, abuse or neglect.

Please retain your receipt as proof of purchase and contact our Customer Service Centre on 1800 124 125 (Australia) or 0800 945 995 (New Zealand) or alternatively, via Customer Help at Kmart.com.au for any difficulties with your product. Warranty claims and claims for expense incurred in returning this product can be addressed to our Customer Service Centre at 690 Springvale Rd, Mulgrave Vic 3170.

Our goods come with guarantees that cannot be excluded under the Australian Consumer Law. You are entitled to a replacement or refund for a major failure and compensation for any other reasonably foreseeable loss or damage. You are also entitled to have the goods repaired or replaced if the goods fail to be of acceptable quality and the failure does not amount to a major failure.

For New Zealand customers, this warranty is in addition to statutory rights observed under New Zealand legislation.