

anko

**Coffee Grinder
260608
User Manual**



PLEASE READ AND SAVE THESE
INSTRUCTIONS FOR FUTURE REFERENCE

IMPORTANT SAFEGUARDS

When using electrical appliances, basic safety precautions should always be followed to reduce the risk of fire, electric shock, and/or injury to persons, including the following:

1. Read all instructions.
 2. This appliance is not intended for use by persons (including children) with reduced physical, sensory, or mental capabilities, or lack of experience and knowledge, unless they are closely supervised and instructed concerning use of the appliance by a person responsible for their safety.
 3. Close supervision is necessary when any appliance is used by or near children. Children should be supervised to ensure that they do not play with the appliance.
 4. To protect against risk of electrical shock, do not put unit, cord, or plug in water or other liquid.
 5. Unplug from outlet when not in use, before putting on or taking off parts, and before cleaning.
 6. Avoid contacting moving parts.
- IMPORTANT! If the supply cord is damaged, it must be replaced by qualified electrical person in order to avoid a hazard or the product must be disposed.**
7. Do not immerse power cord, plug or product in water or other liquids. If the product falls into water, immediately unplug it from the electrical outlet. Do not touch or reach into the water.
 8. Care is needed when handling cutting blades, especially when removing the blade from the chamber, emptying the chamber and during cleaning.
 9. Misuse may cause injury.
 10. This product is for household use only, not designed for commercial use.

11. The use of attachments not recommended or sold by the manufacturer may cause fire, electric shock, or injury.
 12. Do not use outdoors.
 13. Do not let cord hang over edge of table or counter or touch hot surfaces, including stove.
 14. Do not place on or near a hot gas or electric burner, or in a heated oven.
 15. Check removable grinding chamber for presence of foreign objects before use.
 16. Do not use appliance for other than intended purpose.
- CAUTION: Do not remove grinding cover until blade has completely stopped rotating.**
17. Be certain cover is securely locked in place before operating the appliance.
 18. Do not attempt to defeat the interlock mechanism on the cover.
 19. To disconnect, turn OFF (⓪); then remove plug from mains power outlet.

WARNING: The maximum operating time is 40 second. Allow it to rest for at least 1 minute before using it again. After 3 cycles of operation, allow the coffee grinder (electric motor) to cool down to room temperature for approx. 30 minutes before using it again. Failing to follow the above instructions may cause electric motor burnout.

SAVE THESE INSTRUCTIONS!

Parts and Features

BEFORE FIRST USE: Wash all removable parts in hot, soapy water. Rinse and dry.

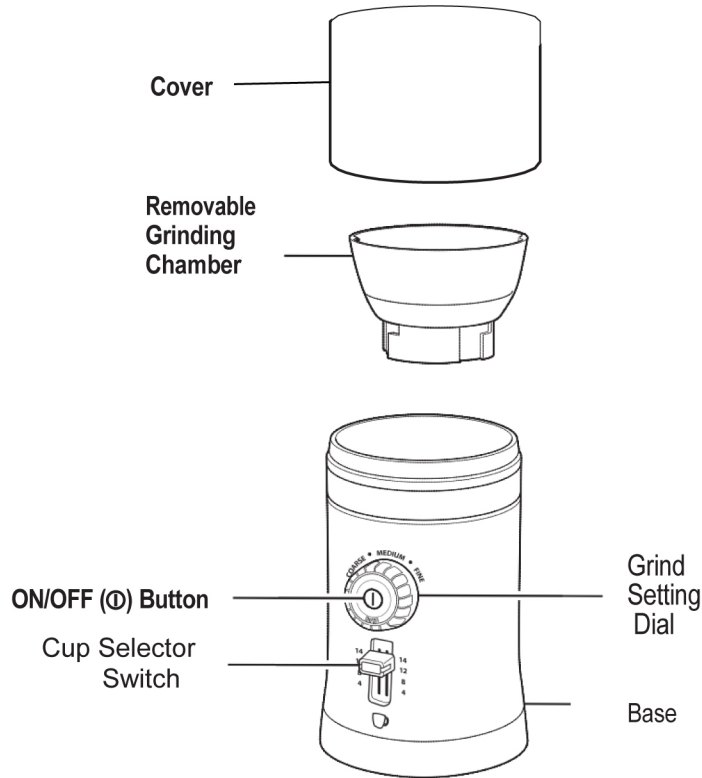

Hidden Cord Storage

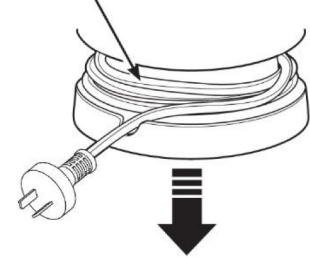

Cleaning Brush and Storage

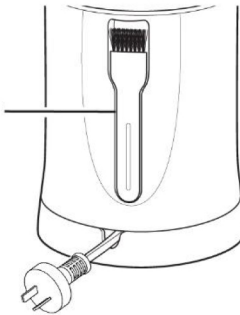

Using the Coffee Grinder



1 Remove grinding cover, if locked in place, by turning counterclockwise to unlock, then lift straight up.

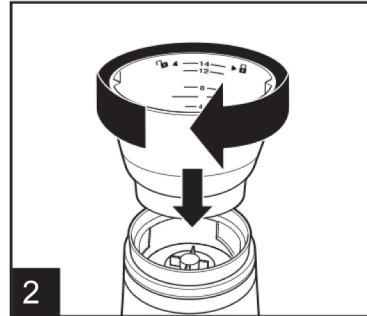

2 Twist grinding chamber clockwise to locked position. Make sure that the grinding chamber is **FIRMLY** locked into position.



3 Pour coffee beans directly into grinding chamber and fill to desired level.

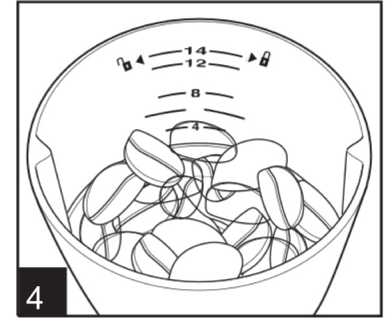

4 Use the convenient cup markings, which correspond to cups of brewed coffee.



5 Place grinding cover onto grinder. Make sure the arrow on cover is aligned with the unlock symbol on back of grinder. Turn lid clockwise to locked position. Grinding cover will “click” when locked into position.

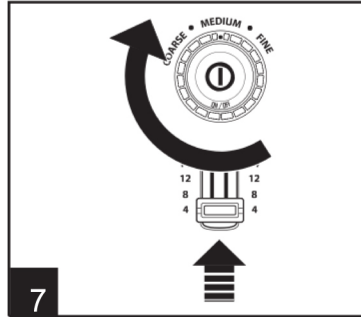
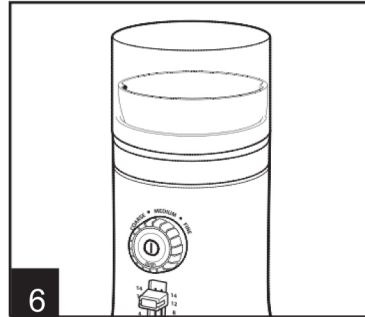

7 Move the cup selector to select the amount of cups to be brewed. Turn grind setting dial clockwise to select **COARSE**, **MEDIUM**, or **FINE** grind. Refer to charts on page 5 for grinding and cup selection. Press the **ON/OFF** (⓪) button to start grinding. It will switch off automatically after grinding.

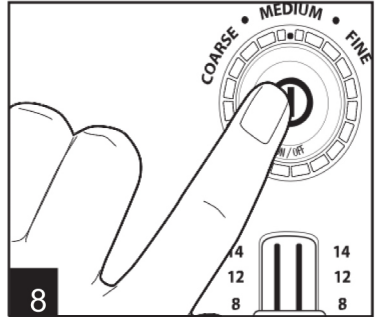

Using the Coffee Grinder (cont.)

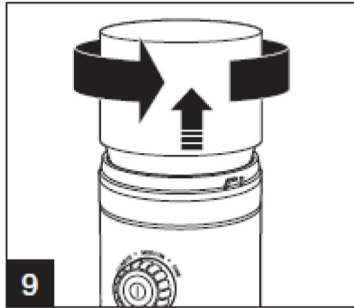

9 Lift cover straight up to remove. If locked in place, turn counterclockwise to unlock; then lift straight up.

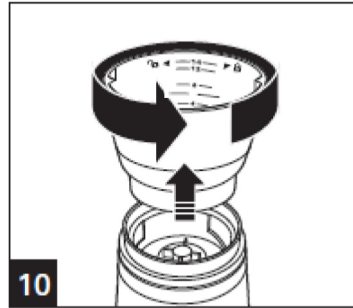

10 Twist grinding chamber counterclockwise to unlock; then lift straight up.



11 Pour grounds from grinding chamber into a paper filter or into an airtight container.

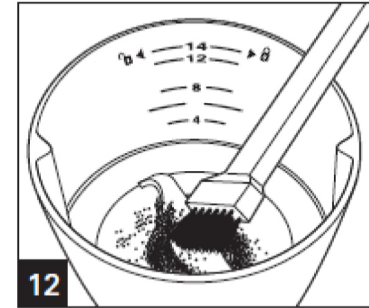

12 Use a small soft-bristle brush to remove grounds at the bottom of the grinding chamber.

TIPS:

- For best flavor, store coffee beans in an airtight container.
- Grind beans immediately before brewing.
- Grinding times will vary by amount and fineness setting.
- To ensure optimal grinding performance, allow coffee grinder to cool for at least 1 minute between uses.
- Coffee flavor and strength are personal preferences. Vary the type of coffee beans, amount of coffee, and fineness of grind to find the flavor you prefer.

CUP SELECTOR SWITCH SETTINGS

SELECT	CUPS
4	1–4
8	5–8
12	9–12
14	13–14

COFFEE GRINDING CHART

IF GRINDING:	GRIND SETTING
Percolator/French Press	Coarse
Drip Coffee Maker	Medium
Steam or Pump Espresso Maker	Fine

Care and Cleaning

WARNING Electrical Shock Hazard.
Disconnect power before cleaning. Do not immerse cord, plug, or base in water or other liquids.

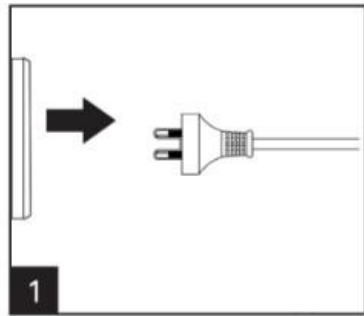

Unplug from power outlet socket.

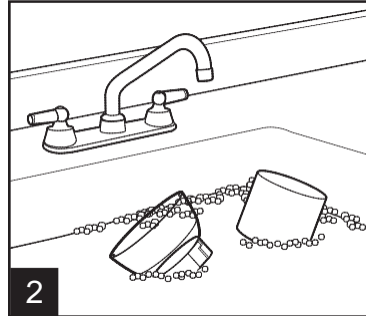

Wash cover and grinding chamber in hot, soapy water. Rinse and dry.



Wipe the outside of coffee grinder with a soft, damp cloth.

NOTE: Cover will become cloudy with use, this is normal.

How to Store Cord

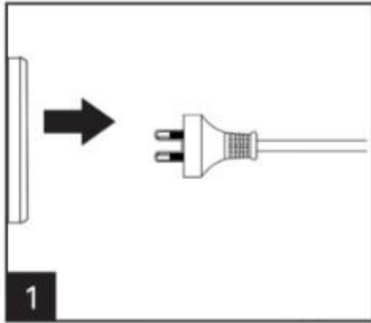

1
Unplug from mains power outlet socket.

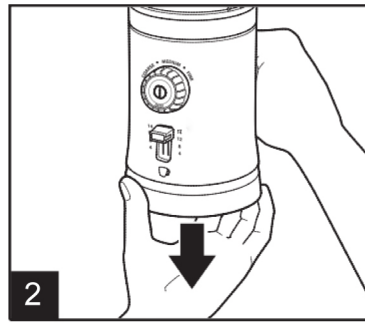

2
Hold coffee grinder in one hand and pull down on the base with your other hand. Wrap cord around hidden area of base. Place cord in cutout of base, leaving the plug hanging outside the base. Push base up to store cord.

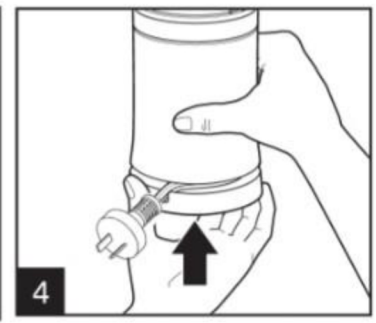
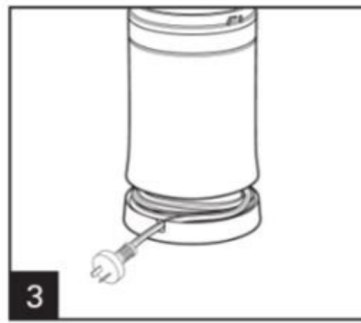

Technical Specification

Voltage: 220-240Va.c. 50-60Hz

Power: 150W

12 Month Warranty

Thank you for your purchase from Kmart.

Kmart Australia Ltd warrants your new product to be free from defects in materials and workmanship for the period stated above, from the date of purchase, provided that the product is used in accordance with accompanying recommendations or instructions where provided. This warranty is in addition to your rights under the Australian Consumer Law.

Kmart will provide you with your choice of a refund, repair or exchange (where possible) for this product if it becomes defective within the warranty period. Kmart will bear the reasonable expense of claiming the warranty. This warranty will no longer apply where the defect is a result of alteration, accident, misuse, abuse or neglect.

Please retain your receipt as proof of purchase and contact our Customer Service Centre on 1800 124 125 (Australia) or 0800 945 995 (New Zealand) or alternatively, via Customer Help at [Kmart.com.au](https://www.kmart.com.au) for any difficulties with your product. Warranty claims and claims for expense incurred in returning this product can be addressed to our Customer Service Centre at 690 Springvale Rd, Mulgrave Vic 3170.

Our goods come with guarantees that cannot be excluded under the Australian Consumer Law. You are entitled to a replacement or refund for a major failure and compensation for any other reasonably foreseeable loss or damage. You are also entitled to have the goods repaired or replaced if the goods fail to be of acceptable quality and the failure does not amount to a major failure.

For New Zealand customers, this warranty is in addition to statutory rights observed under New Zealand legislation.