

# INSTRUCTION MANUAL

**STUNT**  
CAR

SAVE THESE INSTRUCTIONS.  
READ COMPLETE INSTRUCTIONS BEFORE USE.

## 1. HOW TO BIND

1. Turn on the vehicle first, then turn on the controller.
2. When the light on the controller is flashing, it means the vehicle is matching.
3. If the light is on and not flashing, that means they have matched.
4. If it doesn't complete the binding process within 8 seconds, please turn off both the vehicle and controller and re-start the binding process.
5. When the binding process is complete, whenever you switch the vehicle and controller on and off, it searches for the memorised code and will only lock onto the controller signal containing that code.
6. If you have more than two vehicles, please bind them one at a time. When the second vehicle is binding, always keep the first vehicle and controller on.
7. Please turn off both the vehicle and controller and re-start the binding process if you are changing to another 2.4GHZ transmitter.

## 2. HOW TO PLAY

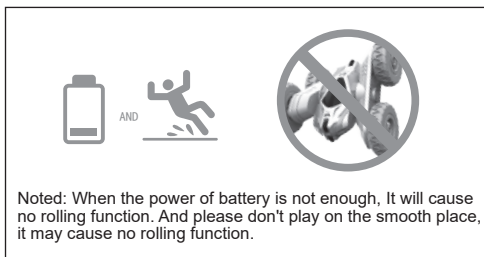
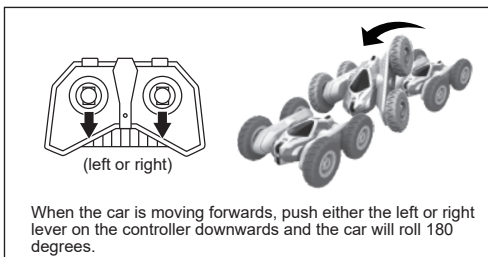
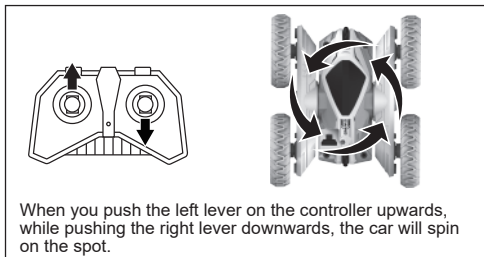
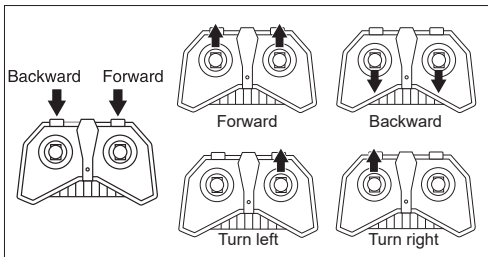

## 3. BATTERY INSTALLATION

Included built-in rechargeable 3.7V battery

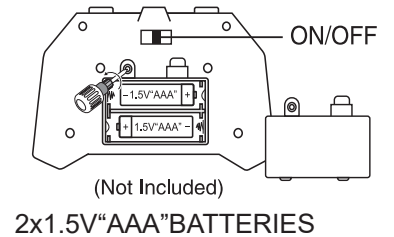
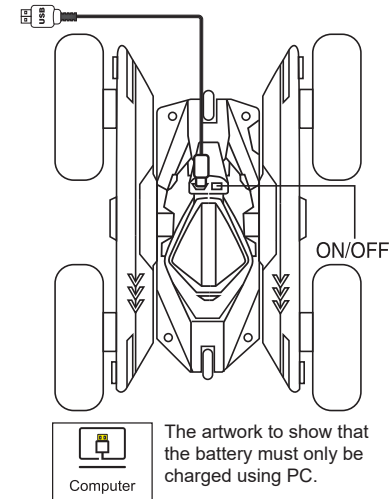

Charging time: approximately 90 mins (the light is red, that means charging now. The light is off, that means the battery is full).

Play time: 10 - 15 mins.

Note: Turn off the car before charging.

## BATTERY WARNING

Do not mix old and new batteries.

Do not mix alkaline, standard ( carbon-zinc ), or rechargeable ( nickel—cadmium ) batteries.

Insert batteries using the correct polarity. Do not short-circuit the supply terminal.

Remove batteries when not in use. Recycle or dispose of exhausted batteries according to federal, state. And local laws.

Do not dispose of batteries in a fire—they may leak or explode.

Only use manufacture specified batteries, chargers and/or adapters, if applicable, specified by the manufacturer.

Always use, replace, and recharge ( if applicable ) batteries under adult supervision.

Non-rechargeable batteries are not to be recharged.

Rechargeable batteries are to be removed from the for before being charged.

Rechargeable batteries are only to be charged under adult supervision.

Exhausted batteries are to be removed from the toy.

The supply terminals are not to be short-circuited.

Packaging has to be kept since it contains important information.

Product may vary slightly from image shown.

Performance Tips: Do not drive the vehicle on grass, sand rocks or go through water.

Do not drive the vehicle into any hard object.

## SAFETY PRECAUTIONS

Do not operate during thunderstorms or rain.

Avoid water, sand and snow when operating the car.

Do not submerge car or controller in water.

Never operate your car on the street or highway.

Never operate your car in a confined or crowded area and do not use people or animals as obstacles.

Do not run your car into furniture, objects or hard surfaces, as this will cause damage to both the objects and the car.

Keep fingers, hair and loose clothing away from the tires, gears and motor while the car is switched to "ON".

Do not leave the car or transmitter near sources of heat or under direct sunlight for long periods of time.

Do not leave the car or transmitter outside overnight. Dampness is harmful to interior components.

Remove all batteries when not in use to avoid accidental operation.

Adult supervision is recommended when operating this car.

The USB power supply cable used with the electric toy shall be regularly examined for damage to the supply cord, plug, enclosure or other parts, and in the event of damage, it shall not be used until the damage has been repaired.

## PERFORMANCE TIPS

- 1 . Do not drive on grass, dirt, sand, dust, carpet or through water.
- 2 . Do not drive in windy or rainy weather.
- 3 . Avoid the vehicle directly impacting with obstacles.
- 4 . Switch OFF the power when not in use to prevent damage to the vehicle or transmitter due to leakage of electrolytes from batteries.
- 5 . Remove all batteries from the vehicle and transmitter when not in use for a long period of time.
- 6 . Keep fingers, hair and loose clothing away from the wheels.
- 7 . The operating range can be affected by a variety of factors:
  - a) Low Voltage of batteries in the transmitter or vehicle.
  - b) Interference from other items that emit radio frequency signals.
- 8 . Outdoor usage is recommended in order to get optimum control range.
- 9 . It is recommended to play with the vehicle on a clean and smooth surface.
10. Clean the battery compartment to make sure it is free from dust to prevent poor contact with the batteries.

## CAUTION

- 1 . Do not attempt to disassemble the vehicle or transmitter.
- 2 . Do not operate the vehicle with the same frequency as other player(s) in the same location as this will interfere and make the vehicle go out of control.
- 3 . Make sure the batteries are installed with correct polarities (+/-) as shown inside the battery compartment.
- 4 . Remove the package and take out all accessories before giving the vehicle and transmitter to a child to play with.

Product may vary slightly from image shown.

Please keep the packaging and instruction manual for future reference.

Warning: Choking hazard. Small parts. Not for children under 3 years.