

6+
YEARS

RC 1:24 MONSTER TRUCK

INSTRUCTIONS



Installing batteries in the transmitter:

- 1 - Unscrew to open the battery compartment.
- 2 - Insert batteries into the correct + and - polarities.
- 3 - Close the cover.

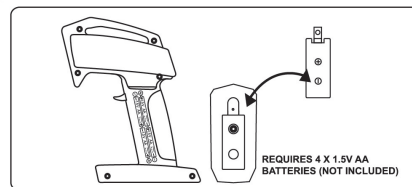

How to use simultaneously:

1. Turn on the vehicle, then turn on the transmitter.
2. Pull the trigger of the transmitter to match the vehicle.
3. When the vehicle is functioning, that means they are matched.
4. If you have more than two vehicles, please proofread one by one. When the second vehicle is proofreading, please always keep the first vehicle and transmitter on.
5. Please turn off both the vehicle and transmitter and re-start all proofreading processes if you are changing to play with another 2.4GHz transmitter.

Note: Do not touch the throttle trigger when turning on the remote control switch. Please restart the switch if you touch the throttle trigger.

Start:

1. How to move forwards or backwards:
Pull the throttle trigger, the car will move forwards.
Push the throttle trigger, the car will move backwards.

Note: The speed of the vehicle is subject to the throttle trigger on the remote control you pull / push.

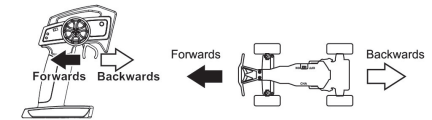

2. Turn left or right:
Turn steering wheel clockwise, the car will turn right.
Turn steering wheel anticlockwise, the car will turn left.

Note: The left / right degree of the front wheels is subject to the steering wheel on the remote control you turn.

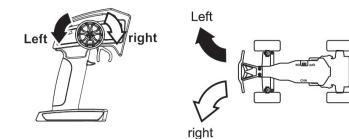

Lithium battery charge information:

Fig 1:

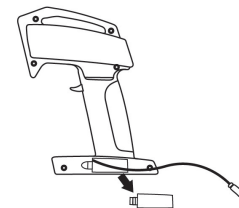

1. Open the charging cable cover.

Fig 2:

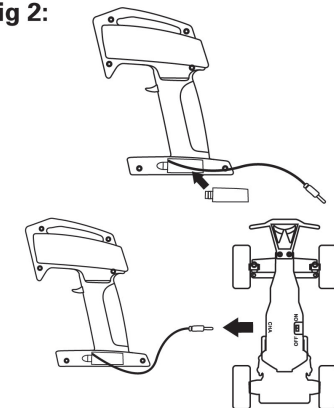

2. Turn on the remote control and turn off the vehicle before charging. As shown in figure, to charge the battery, connect the charging cable with the charging interface on the vehicle. The green charging indicator on the remote control will light up when vehicle is charging. Once the green charging indicator extinguishes, the vehicle is fully charged. After charging, put the charging cable back into the cable slot and close the cover.

Charging should take about 40-60 minutes depending on how much charge is left in the battery. This supports about 20-25 minutes of playing per charge.

NOTE: Do not charge the battery immediately after use. Let the battery cool for at least 10 minutes. If charging is not complete after a long period of time, replace the charger batteries.

WARNING:

Batteries are to be inserted with the correct polarity (+ and -). Do not mix different types of batteries or new and used batteries. Non-rechargeable batteries are not to be recharged. Rechargeable batteries are only to be charged under adult supervision. The supply terminals are not to be short-circuited. Remove batteries from the toy when not in use for extended time or when batteries become exhausted. Battery installation by an adult is required. Dispose of batteries responsibly. Do not dispose of in fire.

2.4GHz



Z516

KEYCODE: 42853558

MADE IN CHINA

FOR AU / NZ: IMPORTED FOR KMART STORES IN AUSTRALIA AND NEW ZEALAND.
FOR USA: IMPORTED BY ANKO RETAIL INC. 19500 ALDERWOOD MALL PARKWAY LYNNWOOD WA 98036 USA.

※ PRODUCT MAY VARY SLIGHTLY FROM IMAGE SHOWN.
※ PLEASE KEEP THE PACKAGING FOR FUTURE REFERENCE.
※ PERFORMANCE TIPS: DO NOT DRIVE THE VEHICLE ON GRASS OR THROUGH WATER. DO NOT DRIVE THE VEHICLE INTO ANY HARD OBJECT.
※ READ THE INSTRUCTIONS BEFORE OPERATING THIS PRODUCT.