

anko

Robotic Vacuum Cleaner User Manual



Model no.: M3C-D

PLEASE READ AND SAVE THESE
INSTRUCTIONS FOR FUTURE REFERENCE

IMPORTANT SAFEGUARDS

FOR HOUSEHOLD USE ONLY.

This appliance should only be used for domestic cleaning, and must only be used indoors, as described in this user guide.

1. Always switch off and remove the charger from the socket before cleaning the appliance or any maintenance task.
2. This appliance is not intended for used by persons (including children) with reduced physical, sensory or mental capabilities, or lack of experience and knowledge, unless they have been given supervision or instruction concerning use of the appliances by a person responsible for their safety.
3. Children should be supervised to ensure that they do not play with the appliance.
4. If the power cord is damaged, it must be replaced by a qualified electrician in order to avoid hazard or the appliance must be disposed of.
5. Keep hands, feet, loose clothing and hair away from rotating brush.
6. Use only the original charger supplied with the appliance.
7. Check that your supply voltage is the same as that stated on the charger.
8. When charging the appliance, the power switch must be off.
9. Never charge the batteries in temperatures above 37°C or below 0°C.
10. It is normal for the charger to become warm to the touch when charging.
11. Use only attachments provided.
12. Static electricity: some carpets can cause a small build up of static electricity. Any static discharge is not hazardous to health.
13. To prevent damage: Do not suck up liquids or ash!
14. Do not use your appliance out of doors or on any wet surface or for wet pick up.
15. Do no spray with or pick up flammable liquids, cleaning fluids, aerosols or their vapors.
16. Do no continue to use your appliance or charger if it appears faulty.
17. Do not leave the appliance unattended when in use.
- 18. Never use the appliance without the filters in place!**
19. Check the filters are inserted correctly!
20. Do empty the Dust Bin regularly for optimal operation of the vacuum.
21. Do not replace the batteries with non-rechargeable batteries.
- 22. The vacuum must use only with provided battery charger:
YLS0241A-A165060.**



WARNING: Do not recharge non-rechargeable batteries.



WARNING: Before charging the product, please make sure your hands are dry.



WARNING: Please don't touch the rolling brush with your hands when the machine is in function.



WARNING: Please use the charger we supplied with the appliance. Other chargers may cause electrical failure and/or fire.

End of Product Life Battery Disposal

If the cleaner is to be disposed of, the batteries should be removed.

The battery is to be disposed safely.

Used batteries should be taken to a recycling station and not disposed of with household waste. To remove the batteries, please proceed according to the following inspections:

IMPORTANT! Always fully discharge the batteries before removal and ensure the charger is unplugged.

1. Run the vacuum cleaner until it stops to fully discharge the batteries.
2. Remove the ergonomic handle and the screw in the main body to open the cleaner.
3. Remove the motor battery housing and disconnect the cables.
4. Remove the batteries from the housing.

Note: Contact your local council waste disposal service for proper disposal facilities available for your area.

IN THE BOX



Main Body

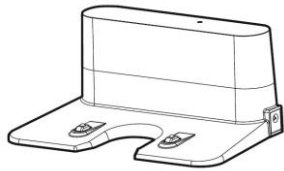

Charging Base

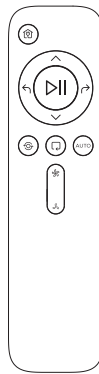

Remote Control
(2*AAA Batteries required
but NOT included)

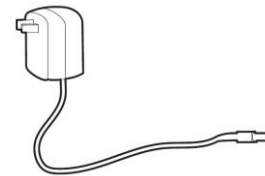

Power Adapter

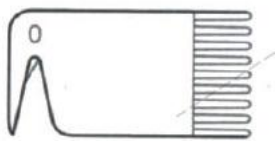

Cleaning Tool

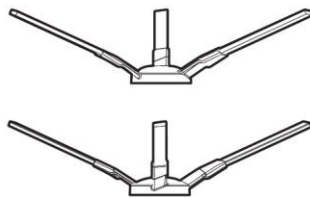

Side Brushes (x2)

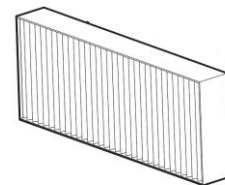

HEPA filter (x2)

IMPORTANT TIPS BEFORE USE

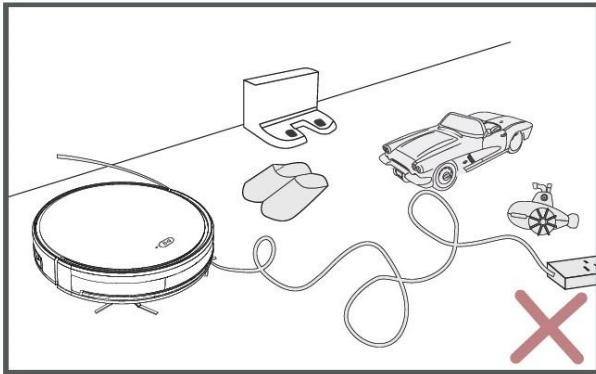

Remove power cords and small objects from the floor that may become entangled with vacuum cleaner

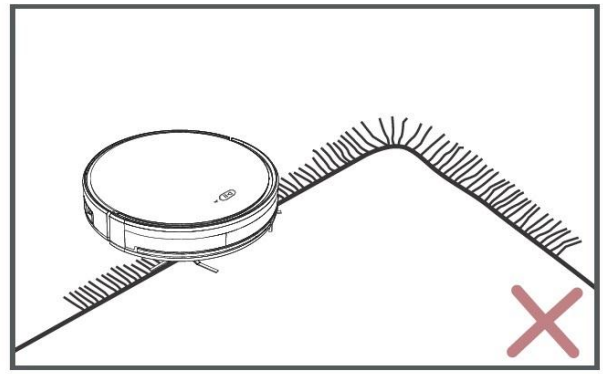

Remove carpet or any floor covering with fringe, they may become entangled with vacuum cleaner.

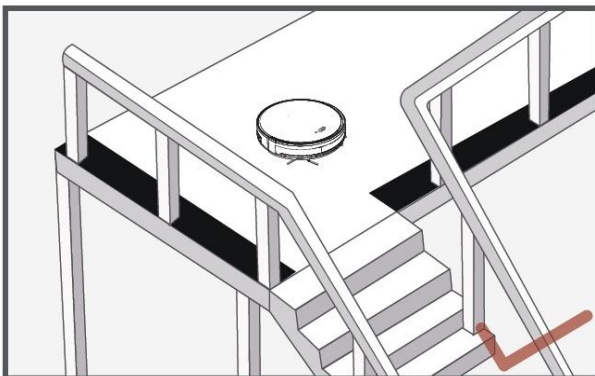

Anti-drop sensors prevent the vacuum cleaner from tumbling down stairs and steep drops. They may work less effectively if they are dirty or used on reflective/ very dark-colored floors. It is recommended that physical barriers are used to block off areas where the vacuum cleaner may fall

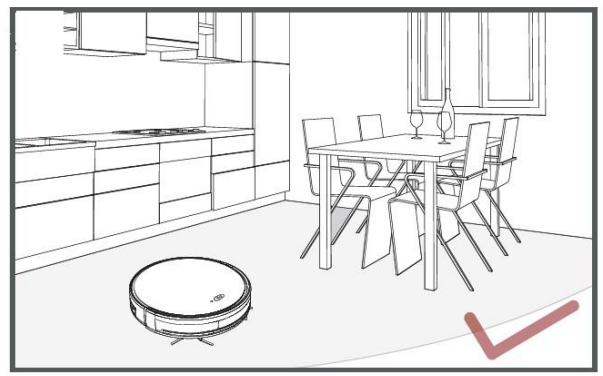

Please make sure all furniture is properly organized so that the vacuum cleaner is able to clean well without becoming stuck.

GET TO KNOW YOUR ROBOTIC VACUUM

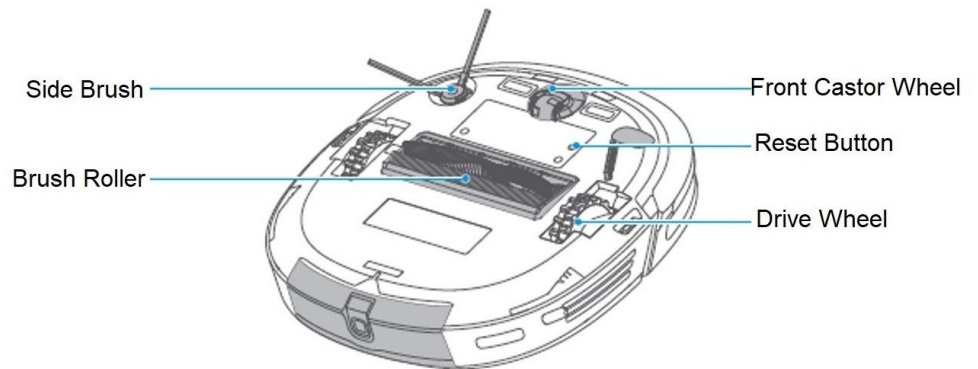
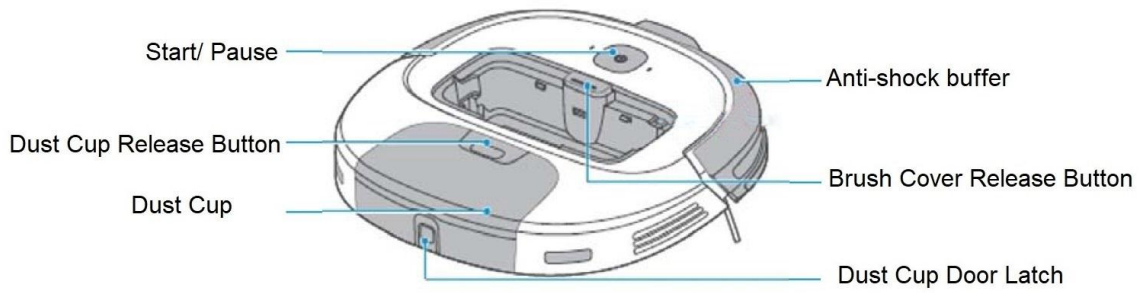

Sensors and Indicators

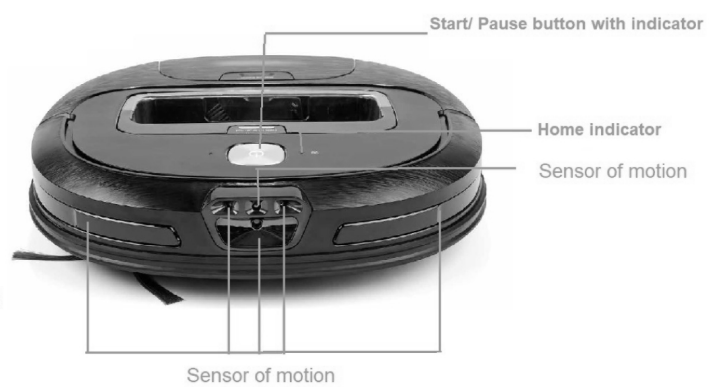
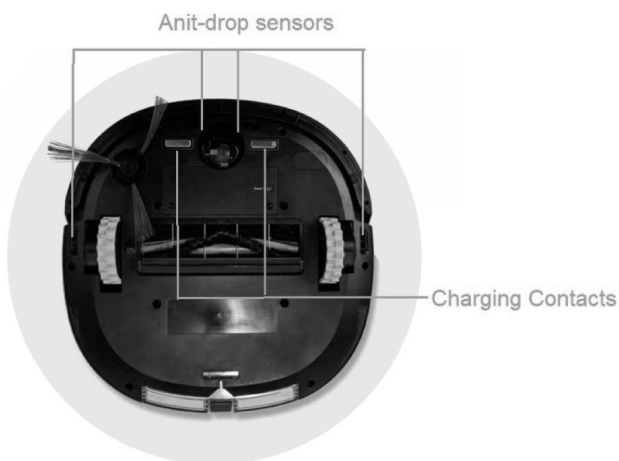

REPARATION

- Install the side brush before use.



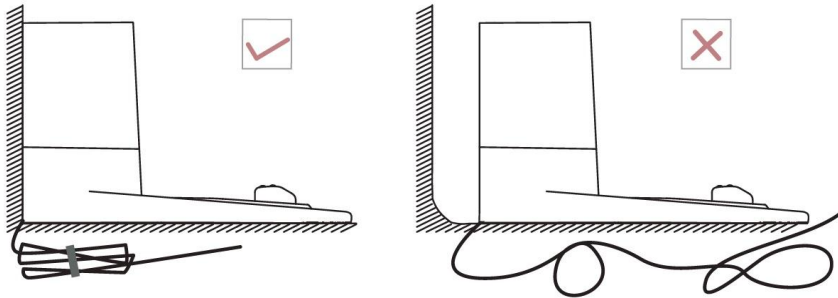

- Place the Charging Base on a hard, level surface and against a wall

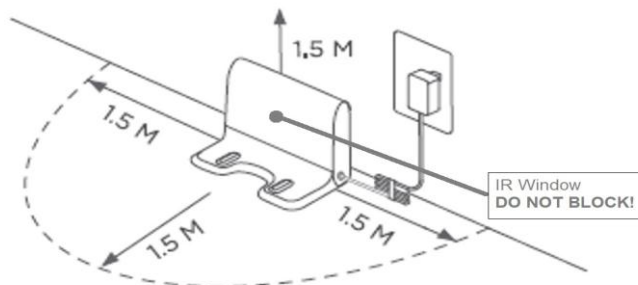

- Do not place any objects within 1.5m of the charging base, and do not place any mirrors or other reflective objects within this range.

NOTE: If the IR signal emission window is blocked, the robot will be unable to locate the charging dock.



- Place the vacuum cleaner on top of the charging base and align the charging contacts. The  indicator flashes, that means the device is under charging. When fully charged the indicator stay steady ON.

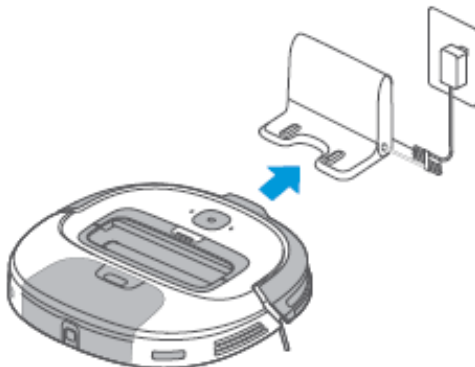

GETTING START

Remote Control

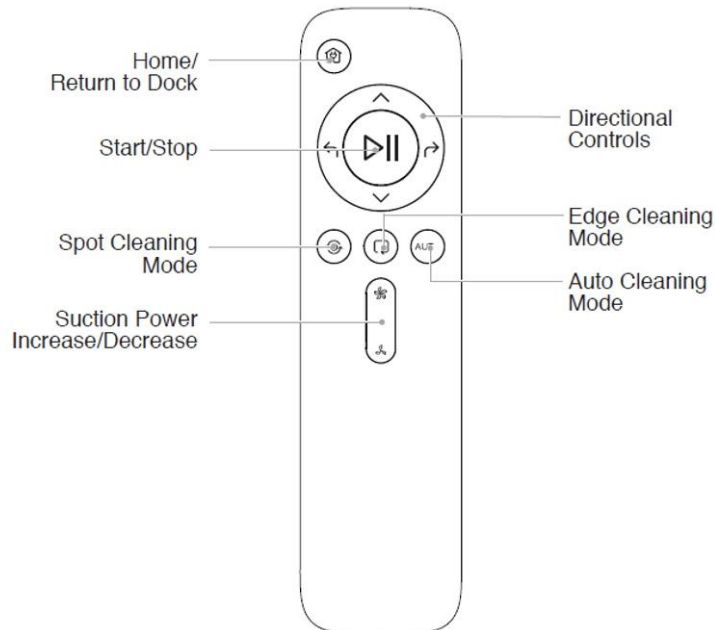

Functions

Home Button

Press  on remote control to return the vacuum cleaner to the Charging Base.

Start/ Pause Button

Press once to start the vacuum cleaner. Press again to pause the operation.

Direction Button

Under the standby mode, press these buttons to turn left or right.

Press backward button, Vacuum will rotate 180 degree. Release button to return to standby mode.

Press forward button, Vacuum continues forward. Release button to standby mode.

Cleaning Mode Button

There a 3-cleaning mode available: **Spot Cleaning**, **Edge Cleaning** and **Auto Cleaning** mode. Before switch mode, press "Pause" button to stop operation temporarily, then select another Cleaning Mode Button.

Suction Increase/ Decrease Button

Under 'Auto Cleaning' mode, you can adjust the suction power by pressing Suction Increase/ Decrease button on the remote control

Note: Remote control require 2x AAA batteries (not included)

To install the batteries, first remove the battery cover on the remote control by sliding the battery cover back. Install the batteries in correct polarity inside the battery compartment matching the polarity shown and then refit the battery compartment cover securely.

Battery type: "1.5V 2x AAA". Alkaline batteries recommended.

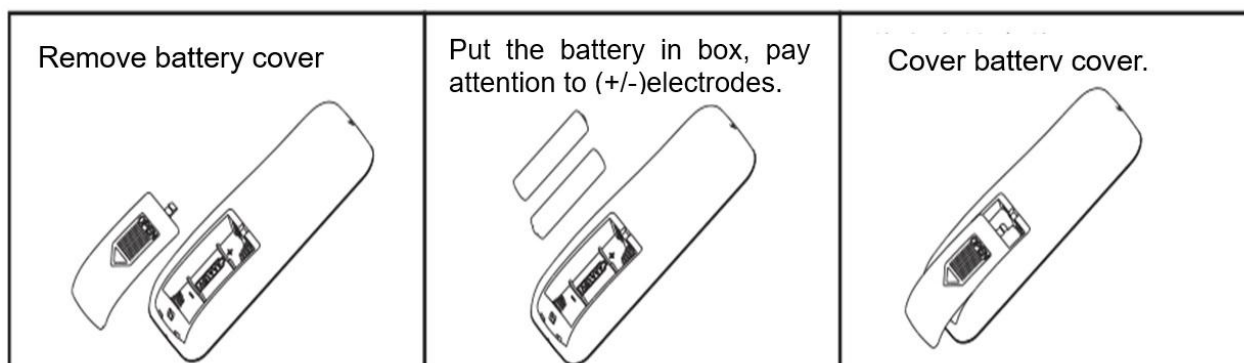

To prevent overheating DO NOT mix new and old batteries in the remote control.
To prevent corrosion, remove the batteries if the remote control is not used for a long period of time.

OPERATION

- Before first use, charge the vacuum cleaner for 12 hours.
- When Start/Pause indicator glows with steady white light, it indicates the device is fully charged. Short press ►|| button on device or press ►|| button on remote control, vacuum will start auto cleaning.
- To change cleaning mode, press ►|| to pause the operation, then press desired cleaning mode button to restart cleaning.
- To turn the vacuum cleaner off, initially pause the cleaning then press and hold the ►|| button on device for 4 seconds. The charge Home indicator will flash red four times and the robot vacuum will shut down.

Cleaning mode

Spot Cleaning

The vacuum intensively cleans a specific area in a spiral pattern, useful if there is a concentrated area of dust or debris. When in the Spot Cleaning mode, the vacuum will stop cleaning after 1 minute.

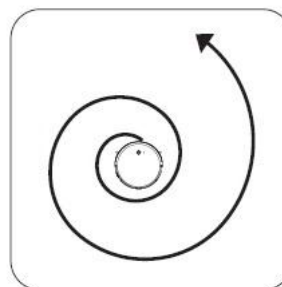

Edge Cleaning

The vacuum cleaner reduces its speed when it detects a wall and then follows the wall to ensure the edge is cleaned thoroughly.

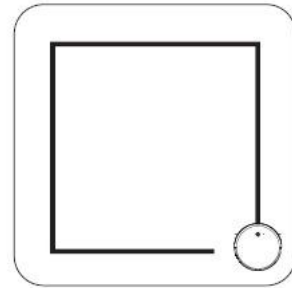

Auto Cleaning

The vacuum cleaning will perform cleaning according to your home environment.

No fixed direction set but will clean the whole room.

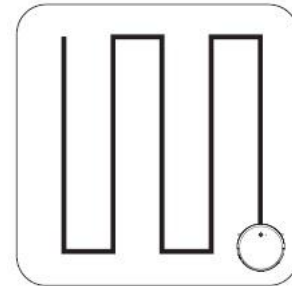

- The vacuum cleaner will automatically end the cleaning session when the battery level is too low. Home indicator flashes RED and the vacuum will begin to manoeuvre back to the charging base.
- You may manually drive the vacuum back to charging base by pressing  button. Home indicator stays RED until the vacuum parks in charging dock successfully.
Note: If the vacuum is unable to find the charging base, please help it back home manually.

CAUTION! Too low a charge is impossible to start cleaning, always put vacuum cleaner on charger base for charging when not in use.

CLEANING AND MAINTENANCE

Cleaning Brush Roller (weekly cleaning recommended)

- Press Brush Cover Release Button and take out the cover, then take out the brush roller
- Clean hair tangled on the brush roller, by using the cleaning tool provided
- Replace the Brush Roller and the cover.

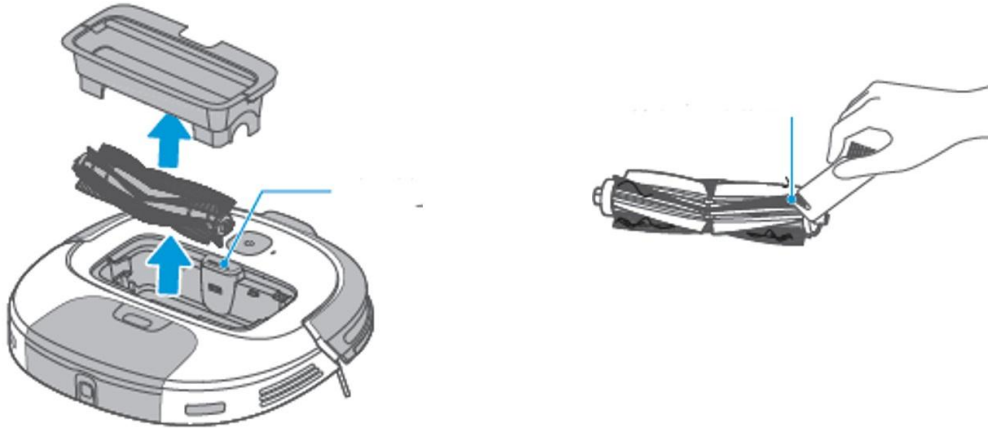

Cleaning Dust Cup (weekly cleaning recommended)

- Press the Dust Cup Release button and take out the dust cup.
- Unclip the dust cup latch and swing the bottom cover open.
- Take the dust cup to the rubbish bin, tip the dirt and debris into the rubbish bin. The small brush provided can be used to help clean the dust cup.
- Close the Dust Cup cover and return it back to vacuum cleaner

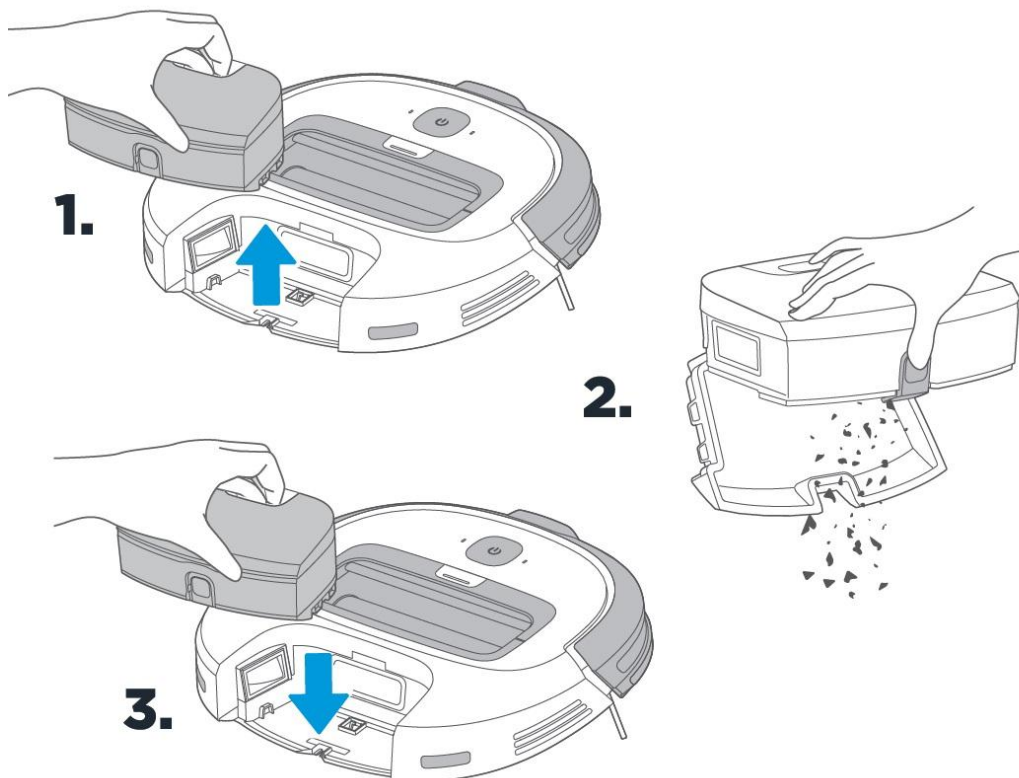

Cleaning HEPA filter (weekly cleaning recommended)

- After taking out the dust cup, pull open the top cover, a HEPA filter can be found on the top cover.
- Remove the HEPA filter, tip the side latch and pull straight out.
- Tap the filter on the side of the rubbish bin to dislodge the dirt and dust. Use the brush provided to remove the small particles or use a normal vacuum cleaner with a hose attachment to suck the dirt and dust out.
- Refit the HEPA filter to the dust cup, the filter can be placed in one way only.
- Close the Dust Cup lid and return it back to vacuum cleaner.

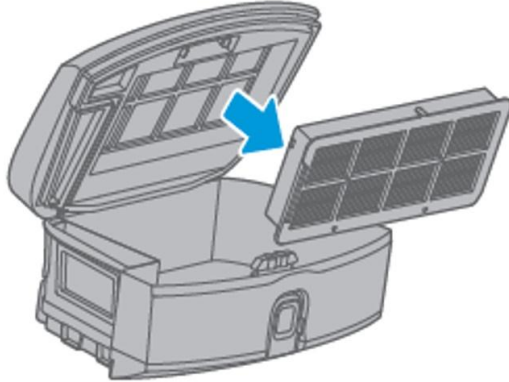

Cleaning side brush (monthly cleaning recommended)

- Pull to remove the side brush.
- Clean hair tangled and remove small particles by using the clean brush provided.
- Place the side brush back to the vacuum cleaner.

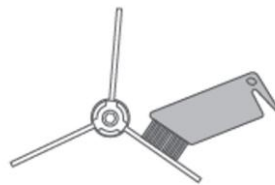
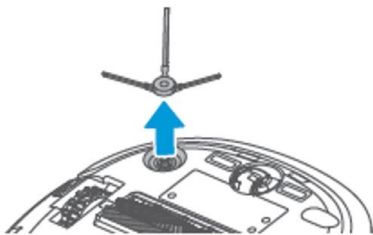

Cleaning Robot Sensors

- Keep the sensors clean by wiping with a dry cloth or brush them using the cleaning tool provided.
- Keep the window on the Shock Buffer clean as there are sensors located behind.
- Wipe the window with a damp cloth and dry with a dry cloth.

Cleaning the Wheels

- Should the driver wheels or front castor wheel become tangled with debris, hair etc., clean away before continuing use.

Cleaning main body and charging base

- The charging contacts on the Robot and Charging Base must be kept clean to ensure proper charger.
- To clean, switch off and unplug the power supply from the wall outlet.
- Use a dry cloth, wipe the contacts until they are clean and shiny.

TROUBLE SHOOTING

Problem	Possible causes	Solutions
Robot makes an abnormal sound	<ol style="list-style-type: none"> 1. The robot might be trapped. 2. Debris stuck in the wheels or brushes. 3. A ticking sound and the start/pause button light on means there is an error 	<ol style="list-style-type: none"> 1. Take the robot out from where it is trapped and block off that area, so it doesn't get trapped again. 2. Clean the wheel with a damp cloth and dry thoroughly. Check all the brushes and clean if necessary, as shown in the "Cleaning and Maintenance" section. 3. Turn off the vacuum, check the brushes, wheels and filters for blockages. Remove if required. Give the sensors a wipe.
The robot has stopped working	<ol style="list-style-type: none"> 1. The power has run out and the robot didn't find its way back to the charging dock to charge. 2. The dust cup is full. 3. The brush roll is clogged. 4. The robot has become suspended off the ground. 	<ol style="list-style-type: none"> 1. Place the robot back on the charging dock manually. 2. Empty the dust cup. Refer to "Cleaning dust cup" section. 3. Check the brush roll. Clean if necessary, following the "Cleaning brush roller" section. 4. Remove the object and replace the robot back on the ground.
Low suction or poor cleaning power	<ol style="list-style-type: none"> 1. Dust cup is full. 2. Filter is blocked. 3. The sensor is dirty. 4. The brush roll is clogged. 	<ol style="list-style-type: none"> 1. Empty the dust cup. Refer to "Cleaning dust cup" section. 2. Check and clean the filter following the guidance in "Cleaning HEPA filter" section. 3. Wipe clean all the sensors. 4. Check the side brush and brush roller. Clean if necessary.
The remote isn't working	The batteries have run out.	Replace the batteries.
The robot is not changing direction very well	<ol style="list-style-type: none"> 1. The sensors are obscured. 2. The bumper is trapped or clogged 	<ol style="list-style-type: none"> 1. Clean the sensors. 2. Detach the bumper from the object it has trapped on. Check the bumper for foreign objects and remove.
The robot isn't charging	<ol style="list-style-type: none"> 1. The charger isn't plugged in to the charging dock. 2. The charging dock isn't switched on at the mains. 3. The robot isn't on the charging dock properly. 	<ol style="list-style-type: none"> 1. Plug in the charger to the charging dock. 2. Ensure the mains power is switched on. 3. Place the robot centrally on the charging dock so the robot has a good connection with the charging contacts.

SPECIFICATION

Model number	M3C-D
Battery	14.4V 2600mAh, 37.44Wh Li-ion (x4 cells)
Working time:	High suction: approx.. 50min Low suction: approx.. 90min
Charging time:	4-5hr
Battery charger	YLS0241A-A165060 Input:100-240V~ 50/60Hz Output 16.5V d.c. 0.6A

12 MONTH WARRANTY

Thank you for your purchase from Kmart.

Kmart Australia Ltd warrants your new product to be free from defects in materials and workmanship for the period stated above, from the date of purchase, provided that the product is used in accordance with accompanying recommendations or instructions where provided. This warranty is in addition to your rights under the Australian Consumer Law.

Kmart will provide you with your choice of a refund, repair or exchange (where possible) for this product if it becomes defective within the warranty period. Kmart will bear the reasonable expense of claiming the warranty. This warranty will no longer apply where the defect is a result of alteration, accident, misuse, abuse or neglect.

Please retain your receipt as proof of purchase and contact our Customer Service Centre on 1800 124 125 (Australia) or 0800 945 995 (New Zealand) or alternatively, via Customer Help at Kmart.com.au for any difficulties with your product. Warranty claims and claims for expense incurred in returning this product can be addressed to our Customer Service Centre at 690 Springvale Rd, Mulgrave Vic 3170.

Our goods come with guarantees that cannot be excluded under the Australian Consumer Law. You are entitled to a replacement or refund for a major failure and compensation for any other reasonably foreseeable loss or damage. You are also entitled to have the goods repaired or replaced if the goods fail to be of acceptable quality and the failure does not amount to a major failure.

For New Zealand customers, this warranty is in addition to statutory rights observed under New Zealand legislation.