

# RAINBOW SHELTER

Key Code: 42911647

## INFLATATION INSTRUCTION

To inflate the shelter, open the air valve (see below image 1). Use an air pump (not included) to inflate and close the valve quickly so no air escapes (see below image 2), then press the valve towards the inside to ensure the valve is located below the surface (see below image 3). Make sure you do not over-inflate the item. Do not use high pressure pump to inflate.

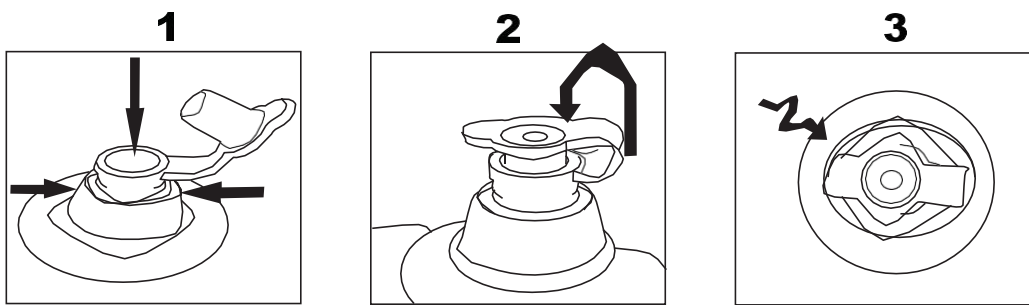

## USE INSTRUCTION

- This item should be fully inflated before use.
- This item will not prevent drowning. Children should be under a constant and competent supervision. The supervisor should be within the arm's reach of children.
- Always check the surface after inflated, if any signs of wear or tear are found on the product and result in air leakage, stop use immediately.

## REPAIRING INSTRUCTION

If the product is damaged, please use the provided repair patch.

1. Completely deflate and drain the product.
2. Clean and dry the damaged area.
3. Carefully peel patch. Press patch over the area to be repaired.
4. Wait 20 minutes before inflation.

## WARNING:

- Before using the product, carefully check if there are any leaks or broken parts.
- Dry product before storage.
- Do not place on stones, sticks or any sharp objects that may puncture the product.
- Keep away from flames and fires.
- Use only in shallow water under adult supervision.
- Adult assembly required.

FOR AU / NZ: IMPORTED FOR KMART  
STORES IN AUSTRALIA AND NEW ZEALAND.

FOR USA: IMPORTED BY ANKO RETAIL INC.  
19500 ALDERWOOD MALL PARKWAY  
LYNNWOOD WA 98036 USA.

Made in China