

Please read this manual before assembly.

**Please save your Receipt for  
Warranty Registration and save this  
Manual for directions on assembly  
and operation.**

6-volt Rechargeable Battery Powered Ride-on Vehicle

**3-5  
Years Old**



**⚠ WARNING:**  
Assembly by an adult.

**⚠ WARNING:**  
CHOKING HAZARD- Small parts.  
Not for children under 36 months.

**easy 1-2-3  
ASSEMBLY**

Adult Assembly Required  
**(All required tools included!)**

For assistance with your assembly call:  
**1-800-861-490** toll-free



### **WARNING:Electrical Hazard**

**RISK OF FIRE , DO NOT BYPASS. REPLACE ONLY WITH SAME 15A FUSE.**

- Only use a 6V lead acid battery.
- Only use a 6V charger.
- Never modify the electrical system. Changes could cause a fire resulting in serious injury or death, and could also ruin the electrical system.
- Always secure that battery and cover. Failure to do this properly result in injury should the vehicle tip over.
- Never lift or carry the battery by the wires or connectors. This can damage the battery and possibly cause a fire resulting in serious injury or death, Always use the battery holder to carry it.
- The battery can be handled by adults only. The battery is heavy and contains sulfuric acid (electrolyte). Dropping the battery could cause serious injury.
- Children should never be allowed to charge the battery. Charging the battery must be done by adults only. The electricity involved in charging the battery could injure a child.
- The motors will get hot, handle carefully.
- Each time you charge the battery check the battery, charger, and their connectors for excessive wear or damage. Do not use the charger or the battery if damage or excessive wear is detected until you have replaced the worn or damaged parts.

### **WARNING:Riding Hazard**

- Prevent Injuries and Deaths
- Direct Adult Supervision Required At All Times
- Keep Children Within Safe Riding Areas.
  - These areas must be:
    - away from swimming pools and other bodies of water to prevent drowning
    - away from steps, driveways, cars, roads and alleys
    - Generally level ground to prevent tip-overs

### **WARNING: Charger**

Changes or modifications to this unit not expressly approved by the party responsible for compliance could void the user's authority to operate the equipment.

**NOTE:** This equipment has been tested and found to comply with the limits for a Class B digital device, pursuant to Part 15 of the FCC Rules. These limits are designed to provide reasonable protection against harmful interference in a residential installation. This equipment generates, uses and can radiate radio frequency energy and, if not installed and used in accordance with the instructions, may cause harmful interference to radio communications.

However, there is no guarantee that interference will not occur in a particular installation. If this equipment does cause harmful interference to radio or television reception, which can be determined by turning the equipment off and on, the user is encouraged to try to correct the interference by one or more of the following measures:

- Reorient or relocate the receiving antenna.
- Increase the separation between the equipment and receiver.
- Connect the equipment into an outlet on a circuit different from that to which the receiver is connected.

Consult the dealer or an experienced radio/TV technician for help.

### **CAUTION:**

- When fully unassembled, this package contains small parts. Adult assembly is required.
- Use the charger in dry areas only.

**For assistance with your assembly call:**

**1-800-861-490** toll-free

### **WARNING: Adult Supervision Required**

- Always Teach Safety First
- While most children can develop the physical skills necessary to operate this vehicle, it is important to remember that they do not yet have mature judgment skills. Children should never be allowed to ride this vehicle without adult supervision. Before any child rides this vehicle an adult must evaluate the child's skill levels and abilities to operate the vehicle safely. Even after instruction hazards are not always anticipated or recognized by children. So before any child operates the vehicle teach them appropriate safety rules.
- THERE IS NO SUBSTITUTE FOR DIRECT ADULT SUPERVISION.

### **WARNING: Safe Riding Rules**

- Not to be used in traffic.
- Always wear your helmet.
- Always wear shoes.
- Only one rider at a time.
- Do not operate on loose dirt, sand or gravel.
- Do not operate near drop-offs, bodies of water, or obstructions
- Do not operate in the street or near moving vehicles.
- Do operate on inclines. Use on generally level ground only.
- Do not operate in the dark as unexpected obstacles could cause an accident
- Do not operate on slopes.
- Do not place anything near moving parts such as motors, gears or wheels. Rotating parts can snag hair, fingers, etc. causing serious injury.
- Do not operate near flammable vapors ( such as gasoline, paint thinner, acetone, liquid wax, etc.).
- Do not sit on the rear end of seat, it could cause tip over, sit on the middle of seat when riding.
- Do not shift gears while the vehicle is in motion. Please come to a full stop before switching from Forward to Reverse or Reverse to Forward.

For assistance with your assembly call:

**1-800-861-490** toll-free

**⚠ CAUTION: The battery and charger are not toys.  
All battery charging must be done by an adult.**

**The battery is located under the seat. Use the provided screwdriver to remove the seat**

- The battery must be charged 18 hours before it's first use. The battery must be in the upright position before charging, and be very careful to avoid any contact to both terminals at the same time.
- To disconnect the battery, squeeze the tabs of the connector and pull. Hold the connectors firmly, and do not pull the wires.
- Connect the battery charging line with the charger connector, then plug the charger into the wall outlet.
- Make sure to only plug the charger into standard 240V wall outlets. Use only the charger supplied. The charger has the rating: Input 100-240V, 50-60Hz Output 8V, 500mA
- You must recharge the battery for 8-12 hours after each time you use the toy. Never charge for more than 16 hours.
- Disconnect the charger from the wall outlet and then the charger from the battery. If you are not going to use the toy for a long period of time, make sure you recharge the battery at least once a month.
- Never lift or carry the battery by the wires or connector, this can cause damage. Lift and carry the battery by the case only.
- Do not charge or store the battery upside down. Charging the battery produces explosive gasses. Make sure to charge the battery away from flames, sparks, and lit cigarettes. Always charge in a well ventilating area.

### CARE:

- Always charge the battery before storing the vehicle for a long period of time. Make sure to charge the battery at least once a month, even if the toy is not being used.
- Never let the battery run down completely before charging.
- Never leave the battery in a discharged condition. It may ruin it.
- Never store the battery in temperatures above 75 °F (28.8 °C) or below 10 °F (12.2 °C)
- Before each charge examine the battery, charger, and their connectors for excessive wear or damage. If you find damage, do not use the battery or charger until you have replaced the worn or damaged part.
- Make sure to return exhausted batteries to an approved lead-acid battery recycler or contact your local authority accordingly.

### DISPOSAL:

- Your vehicle's battery is a sealed lead-acid battery. You must recycle or dispose of it in an environmentally sound manner.
- Never dispose your battery in the regular, household trash. The incineration, land-filling, or mixing of a sealed lead-acid battery with your household trash is prohibited by law in most areas.
- Make sure to return exhausted batteries to an approved lead-acid battery recycler or contact your local authority. Always remove exhausted batteries from your toy. Dispose of dead batteries properly; never burn or bury them.
- To locate a service center, contact your local waste management company.
- Do not mix old and new batteries.
- Do not mix alkaline, standard (carbon-zinc) or rechargeable (nikel-cadmium) batteries.

**For assistance with your assembly call:**

**1-800-861-490** toll-free

# Parts Diagram

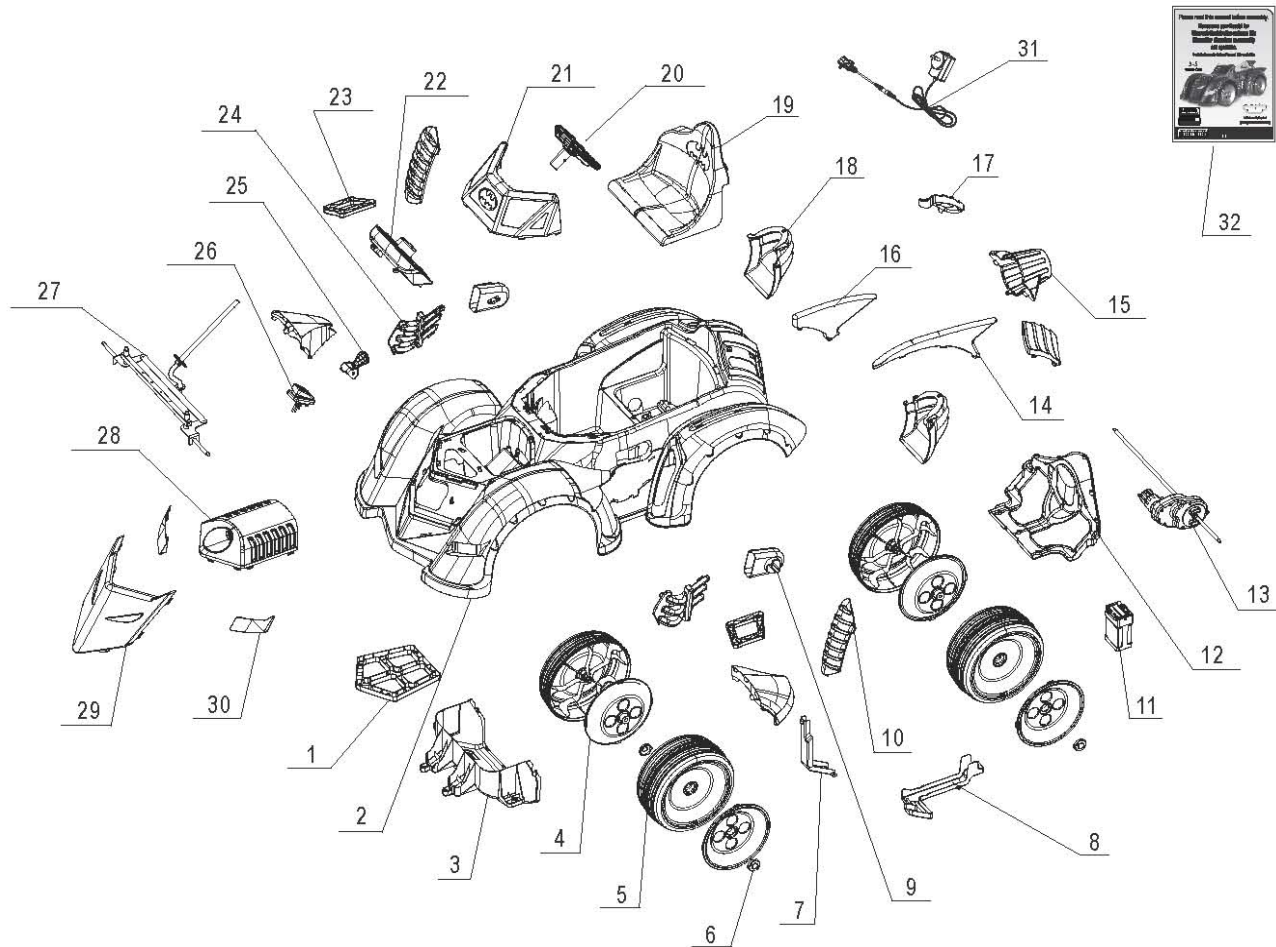

No.	Description	Stock No.
1	Front holder	
2	Body	
3	Pedal bottom cover	
4	Wheel cover	
5	Front wheel	
6	Dome	
7	Wire cover II	
8	Wire cover I	
9	Side decoration II (L/R)	
10	Middle side decoration(L/R)	
11	Battery	
12	Rear holder	
13	Gearbox	
14	Rear wing side (L/R)	
15	Exhaust pipe	
16	Rear wing	
17	Rear decoration cover (L/R)	
18	Rear side decoration (L/R)	
19	Seat	
20	Steering wheel cover	
21	Windshield	
22	Dash board	
23	Side holder	
24	Side decoration I (L/R)	
25	Shifter switch	
26	Pedal switch	
27	Steering	
28	Engine cover	
29	Front face	
30	Eye I (L/R)	
31	Charger	
32	Service manual	

For assistance with your assembly call:

**1-800-861-490** toll-free

# Parts

## INSTALLMENT PARTS

• Body	1PC	• Front Wheel	2PCS
• Product manual	1PC	• Rear Wheel	2PCS
• Charger	1PC	• Left Wing	1PC
• Rear Wing	1PC	• Right Wing	1PC
• Wrench Tool	1PC		

## SPECIFICATION

Battery	6V 4.5AH
Motor	6V 20W
Charger	Input 100-240V, 50-60Hz, Output 8V 500mA
Maxmium load	55lbs(25KG)
Work Time	Recharge 8-12h, Use for 1-2h
Speed	Forward max speed 4kph. Reverse max speed 4kph.
Age	3 to 5 years old.

For assistance with your assembly call:

**1-800-861-490** toll-free

# Assembly

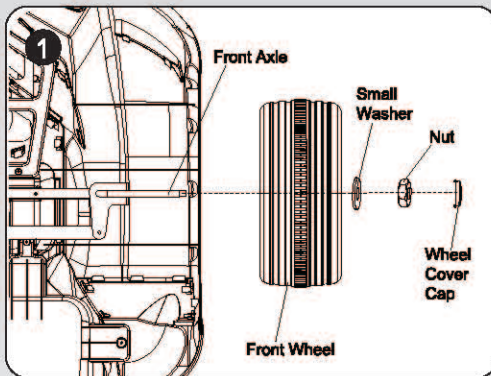

## Install Front Wheel

Remove the nut from the front axle using the wrench provided. Pull off the small washer. Place the front wheel on the axle. Replace the small washer and nut on the wheel and then tighten. Add the wheel cover cap over the nut as shown in Diagram 1. Repeat this on opposite side.

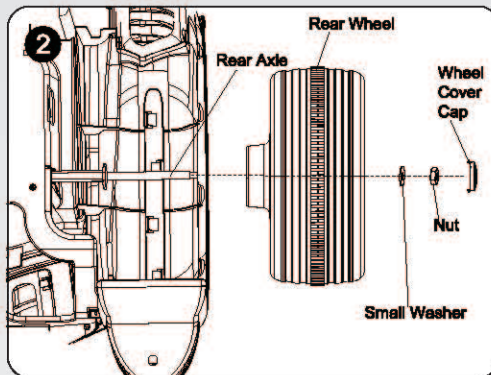

## Install Rear Wheel(Left)

Slide the rear wheel onto the axle. Replace the small washer and nut onto axle and tighten nut securely with the wrench provided. Align the wheel cover cap with wheel cover and apply pressure until snapped into place. Diagram 2.

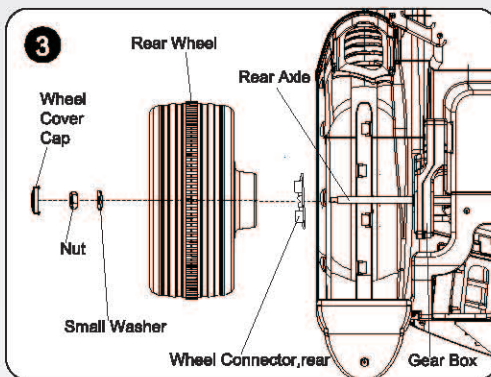

## Install Rear Wheel(Right)

Slide the wheel connector onto the axle first to make the indicated side outward as shown. Then slide the Wheel onto the axle and align Wheel with Gear Box. Replace the Washer and Nut onto axle and tighten Nut securely with the wrench provided. Align the Wheel Cover Cap with Wheel Cover and apply pressure until snapped into place. Diagram 3.

For assistance with your assembly call:

**1-800-861-490** toll-free



# Assembly

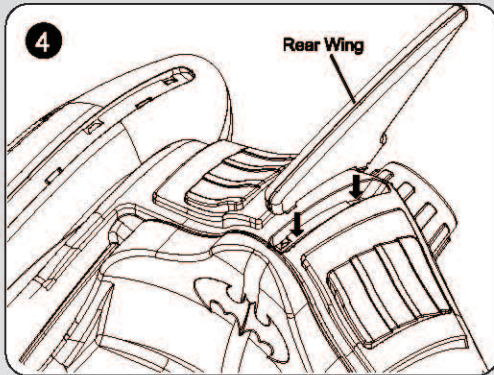

## Install Rear Wing

Make sure the hooks on the Rear Wing plate align with slots on the body and snap into place, you will hear a solid click when the Rear Wing plate is correctly fitted. Diagram 4.

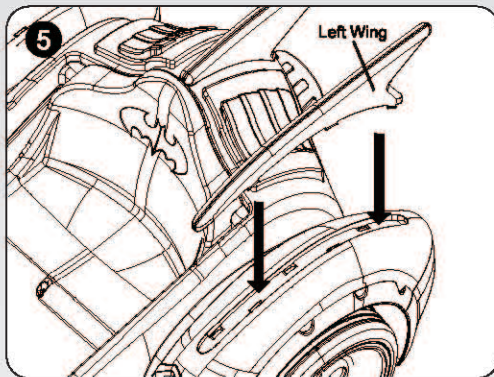

## Install Left Wing

Make sure the hooks on the Left Wing plate align with slots on the body and snap into place, you will hear a solid click when the Left Wing plate is correctly fitted. Diagram 5. Repeat this on right side.

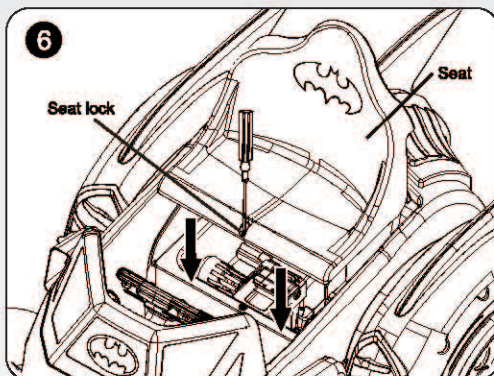

## Seat Cushion Mounting

To take down the seat. Use the equipped screwdriver to unscrew the screw on the seat, then the seat will be taken down.

To install the seat. Put the snap joint of the seat direct to the slot cover on the body, confirm that the seat is firmly in the correct position and tighten the screw with the equipped screwdriver. Diagram 6.

For assistance with your assembly call:

**1-800-861-490** toll-free

# Assembly

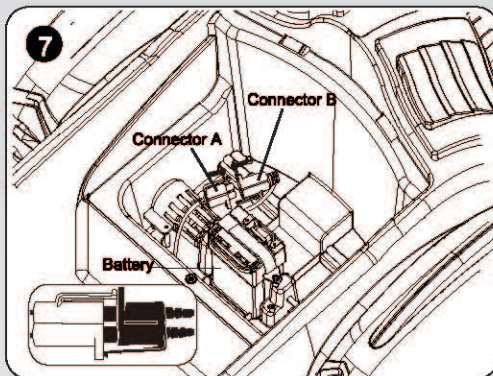

## Install Battery Connector

Identify the battery connector and power cable. Align them correctly so the positive and negative connections are lined up and press the connectors together. Do not force the connection, if they don't go together smoothly check your alignment assuring that positive is connecting to positive and negative is to negative. Diagram 7.

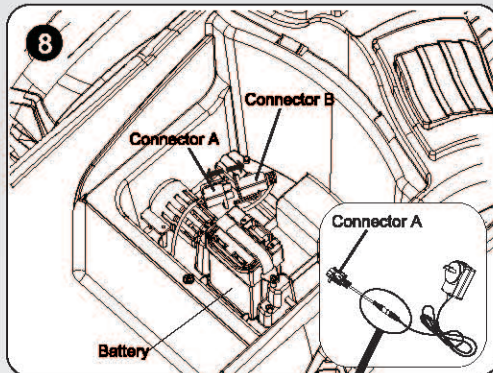

## Recharging the Battery

Remove the seat as shown in Diagram 6. Disconnect the battery connector from the power cable and then connect the battery connector to the charger. Stop recharging after 8-12 hours. After recharging reconnect the battery connector to the cable line connector and reconnect the seat. Diagram 8.

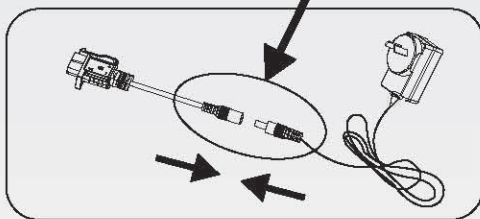

**Note:** Connect the cable to the charger as left diagram.

For assistance with your assembly call:

**1-800-861-490** toll-free

# Battery Instructions

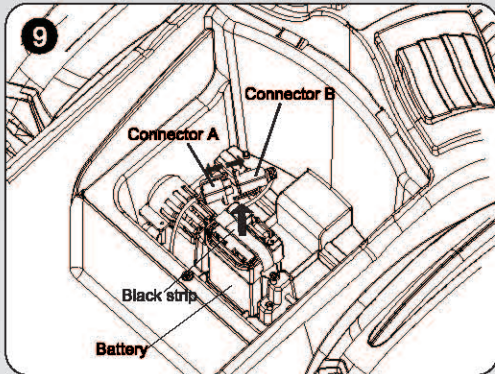

## Changing the Battery

Remove the seat as shown in Diagram 6. Disconnect the battery connections. Never lift the battery using the connectors. Then loosen the black stripe on battery and take out the battery. Place new battery inside and reconnect battery connections. Reinstall the seat as shown in Diagram 6.

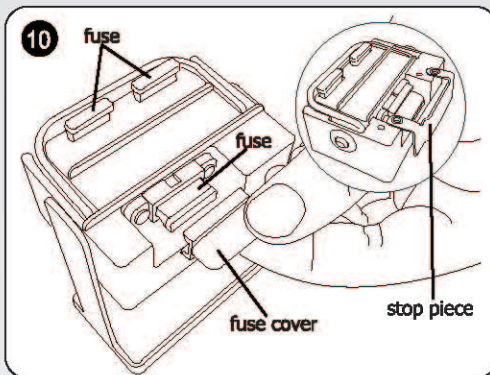

## Changing fuse

To change the fuse disconnect the battery connectors. Remove the fuse stop piece on battery with screwdriver. Then take off the fuse cover. Remove the bad or damaged fuse and replace with provided identical fuse. Finally close the fuse cover and install the stop piece as shown in Diagram 10.

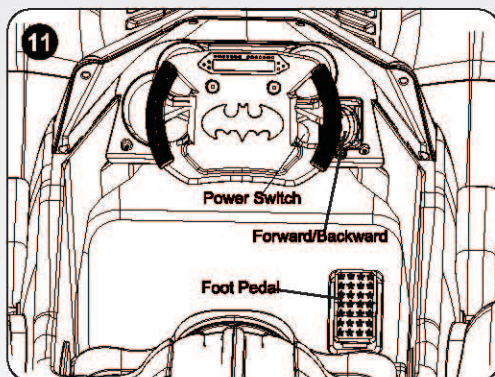

## Operation Controls

Make sure driver is correctly sitting in the seat. Press the power switch. Adjust the shifter into the Forward or reverse position and press the pedal with foot to move vehicle. Diagram 11.

For assistance with your assembly call:

**1-800-861-490** toll-free

Check all screws, cap nuts and protective coverings regularly and tighten as required. Check plastic parts on a regular basis for cracks or broken pieces.



This product should be checked by adult before use and be used only under constant adult supervision.

During snow or rainy weather, the vehicle should be stored inside or under a protective cover. Remember to charge the battery at least once per month while your vehicle is not in regular use.



Avoid operating the vehicle in wet or snowy conditions and do not spray the vehicle with a hose. Do not wash the vehicle with soap and water. Water or moisture in the motors or electrical switches can cause them to corrode and could cause switch or motor failure.



Avoid operating the vehicle on sand, loose dirt or gravel. sand, loose dirt or gravel in the motors or electrical switches can cause them to jam and could cause switch or motor failure.



The vehicle can be wiped down with a soft, dry cloth. For a shiny finish, you can wipe plastic parts with a non-wax furniture polish applied to a soft-cloth. Do not use automotive wax. Do not use soap and water or spray the vehicle with a hose.



The car should have its power switched to off when not in use and it is advised that the battery should be disconnected if the unit will not be used for a long period of time.



For assistance with your assembly call:

**1-800-861-490** toll-free

# Troubleshooting

# Solutions Guide

<b>Problem</b>	<b>Possible Cause</b>	<b>Solution</b>
<b>Car doesn't work</b>	<p>Low power</p> <p>Blown fuse</p> <p>Lost wheel nut</p> <p>Loose battery connection</p> <p>Exhausted and bad battery</p> <p>Damage on electrical parts</p> <p>Damage on motor</p>	<p>Recharge the battery</p> <p>Replace the blown fuse with the same type and value of fuse</p> <p>Replace the nut with the correct size and tighten</p> <p>Refit and tighten the connector, or if damaged, replace the connector</p> <p>Replace with a new battery from Ballard Pacific</p> <p>Contact Australia Active Wheels Pty Ltd at 1-800-861-490.</p> <p>Contact Australia Active Wheels Pty Ltd at 1-800-861-490.</p>
<b>Battery can't be recharged</b>	<p>Loose battery connection</p> <p>No power to charger</p> <p>Loose battery connection</p>	<p>Refit and tighten the connector, or if damaged, replace the connector</p> <p>Check if charger is plugged in and is properly connected to the battery connector</p> <p>Replace the charger with a new unit from Australia Active Wheels.</p>
<b>Short of run time</b>	<p>Battery charge is low</p> <p>Battery is old</p>	<p>Recharge the battery fully</p> <p>Replace with a new battery from Australia Active Wheels.</p>
<b>Noise &amp; heat during recharge</b>	<p>Some heat and noise is normal</p>	<p>No action needed</p>
<b>Low speed</b>	<p>Old battery</p> <p>Low power</p> <p>Overburdened</p> <p>Not used on flat surfaces</p>	<p>Use new battery</p> <p>Recharge the battery fully</p> <p>Do not exceed max. weight of 55 lbs. or 25 kg</p> <p>The car is designed for relatively flat surfaces</p>
<b>Gear box is noisy</b>	<p>Gear box is damaged</p> <p>Motor is damaged</p>	<p>Contact Australia Active Wheels Pty Ltd at 1-800-861-490.</p> <p>Contact Australia Active Wheels Pty Ltd at 1-800-861-490.</p>
<b>Car vibrates or shakes</b>	<p>Problem with motor wire connection</p> <p>Problem with motor</p>	<p>Carefully check connections and tighten as needed</p> <p>Contact Australia Active Wheels Pty Ltd at 1-800-861-490.</p>
<b>No sound or light when running</b>	<p>Loose sound and light wire</p> <p>Light control is damaged</p>	<p>Carefully check connections and tighten as needed</p> <p>Contact Australia Active Wheels Pty Ltd at 1-800-861-490.</p>
<b>Card won't stop while running</b>	<p>Electrical malfunction</p>	<p>Contact Australia Active Wheels Pty Ltd at 1-800-861-490.</p>

For assistance with your assembly call:

**1-800-861-490** toll-free

# Limited Warranty

**Product needs to be returned in original packaging and unused as purchased from your retail store and include the following items to validate your limited warranty.**

1. Two items must be presented:
  - a. YOUR PRODUCT REGISTRATION FORM OR CARD.
  - b. COPY OF YOUR PURCHASE OR SALES RECEIPT.
2. Products must be new and unused.
3. Products must be shipped back with original packing, parts and accessories.

If any part be found missing when returned, each part cost (list on Service Manual) will be deducted from the product purchase amount of money.

Australia Active Wheels Pty Ltd offers the following limitations, terms and conditions to the original owner of the Australia Active Wheels Pty Ltd electric Ride-On Toy. Should this Australia Active Wheels Pty Ltd electric Ride-On Toy or any part be determined defective by Australia Active Wheels Pty Ltd to be covered by this limited warranty, it will be repaired or replaced at Australia Active Wheels Pty Ltd sole option, which will be conclusive and binding. Australia Active Wheels Pty Ltd will pay all labor costs, connected with the repair or replacement of all parts covered under this limited warranty. Under no circumstances does this limited warranty include the cost of travel or shipment to and from any retailer or consumer. Such cost, if any, shall be borne by the original or subsequent owner.

This Australia Active Wheels Pty Ltd electric Ride-On Toy has not been designed or engineered for ramp riding, jumping, aggressive riding, in severe climates or over severe terrain, riding with heavy loads [over 55 lbs. (25 kg)] or any similar activities. Such uses may damage the Australia Active Wheels Pty Ltd electric Ride-On Toy, that can cause serious injury to the rider and in all cases will void this warranty.

### **6 Months from the date of the purchase on vehicle**

Australia Active Wheels Pty Ltd electric Ride-On body, display throttle and throttle assembly, control wiring harness, wiring and wiring harness, motor and associated transmission and all components not directly associated with the 6V battery are warranted from 6 months from date of purchase to THE ORIGINAL PURCHASER against any defects in material, manufacturing, and/or workmanship. If there is any evidence of consumer repair, the warranty is voided. Any claim of damage under this clause cannot be due to owner abuse or neglect and must first be reported to Australia Active Wheels Pty Ltd Customer Service and a Return Merchandise Authorization (RMA) tag to be issued.

### **3 Months from the date of the purchase on battery**

The battery must be charged for a full 14 hours before the unit's first use. The 6V battery and battery charger (AC Adapter) that is included with the original toy is warranted to be free from defects in material, parts and/or workmanship, again not due to owner abuse or neglect. If there is evidence of customer repair or use of another battery or charger, the warranty is voided. This limited warranty is only valid to the original purchaser and must first be reported to Australia Active Wheels Pty Ltd Customer Service and a Return Merchandise Authorization (RMA) tag to be issued.

Wheels are considered a wear and tear item and are only under warranty in the event of manufacturer defect.

### **Items not covered under warranty terms under any conditions:**

1. Damage due to failure to maintain the battery as accurately described on various product warning stickers and the product's owner's manual.
2. Damage due to maintenance or the actual damage caused by the lack of maintenance.
3. Damage due to improperly assembled products.
4. Damage due to climatic or environmental damage, various cleaners and/or chemicals that may result in a damaged finish.

This warranty does not cover and is intended to exclude any liability on the part of Australia Active Wheels Pty Ltd. Whether under this warranty or implied by law or indirect or consequential damages for breach of warranty.

Should you require service or assistance with your toy during the warranty period, contact our trained technical staff at Australia Active Wheels Pty Ltd **1-800-861-490**.

**For assistance with your assembly call:**

**1-800-861-490** toll-free

## Warranty Information

Our goods come with guarantees that cannot be excluded under the Australian Consumer Law. You are entitled to a replacement or refund for a major failure and for compensation for any other reasonably foreseeable loss or damage. You are also entitled to have the goods repaired or replaced if the goods fail to be of acceptable quality and the failure does not amount to a major failure.

Where a failure does not amount to a major failure, we are entitled to choose between providing you with a repair, replacement or refund. To obtain compensation, you would need to provide documentary evidence of the loss or damage suffered, and documentary evidence that such loss or damage was a reasonably foreseeable consequence of a failure by us to comply with a consumer guarantee under the Australian Consumer Law. Such evidence may include photographs, statutory declarations, receipts or reports (e.g. from your doctor), depending on the loss or damage. In addition to all rights and remedies to which you may be entitled under the Competition and Consumer Act 2010 (Commonwealth) and any other relevant legislation, the manufacturer warrants this product to be free from defects in materials or workmanship for a period as stated on the packaging from the date of purchase.

In order to claim under this warranty, you will need to bring the product to the store of purchase, along with proof of purchase (typically this will be a receipt). Any cost incurred by you in bringing the product to the service desk will be borne by you. We will then, at our option, either repair or replace the product, or refund your money and take back the product.

Our liability under this manufacturer's warranty is subject to us being satisfied that a defect was caused by defective workmanship or materials, and was not caused by or substantially contributed to by other factors, or circumstances beyond our control, including (but not limited to) defective installation, maintenance or repair, alteration or modification of the product in any manner not recommended by the manufacturer or any neglect, misuse or excessive use.

The benefits conferred by this manufacturer's warranty are in addition to all rights and remedies conveyed by the Competition and Consumer Act 2010 (Commonwealth), and any other statutory rights to which you may already be entitled, and this warranty does not exclude, restrict or modify any such rights or remedies that are implied by law.



**Australia Active Wheels Pty Ltd**

Unit 38, 45 Mediterranean circuit (74 Indian drive) Keysborough Victoria, 3173, Australia

FOR ANY PRODUCT ENQUIRIES OR PRODUCT ISSUES PLEASE CONTACT ACTIVE WHEELS AUSTRALIA AT [www.ActiveWheels.com.au](http://www.ActiveWheels.com.au) OR TOLL FREE HELP LINE ON 1800 861 490.

For assistance with your assembly call:

**1-800-861-490** toll-free

# Product Registration

## Note:

Activation of your warranty gives you FREE telephone and online technical service help. Please fill out registration below and immediately mail with your sales receipt to:

**Unit 38 ,45 Mediterranean circuit  
( 74 indian drive ) Keysborough  
Victoria, 3173 , Australia**

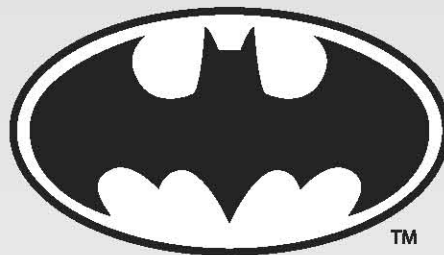

**!** For a record of your purchase fill in immediately and send to:  
Unit 38 ,45 Mediterranean circuit  
( 74 Indian drive ) Keysborough  
Victoria, 3173 , Australia



Owner's Name: \_\_\_\_\_  
(Please Print)

Address: \_\_\_\_\_  
(Please Print)

City: \_\_\_\_\_ State: \_\_\_\_\_ Zip: \_\_\_\_\_

Phone: \_\_\_\_\_ Email: \_\_\_\_\_

Date Purchased: \_\_\_\_\_ Place of Purchase: \_\_\_\_\_

Model Name: \_\_\_\_\_ Serial Number: \_\_\_\_\_

**For assistance with your assembly call:**

**1-800-861-490** toll-free