

Thank you for choosing our Anko Bluetooth® Headset.
We hope you enjoy using it.

Specifications:

- Model No: BSHP651
- Version: V5.0+EDR
- Support Profiles: A2DP, AVRCP, HSP, HFP, GAVDP
- Working Distance: 10 meters
- Play Time(50% Volume): 5 Hours
- Play Time(100% Volume): 4 Hours
- Standby Time: About 300 Hours
- Charging Voltage: DC 5V
- Battery Capacity: 200mAh
- Charge Time: 1.5-2 Hours

Included:

1. Wireless Headphones
2. USB Charging Cable
3. Instruction Card

Overview:

1. [+] Button : Next track, increase volume
2. [>] Button: Power / Phone / Play/Pause
3. [-] Button: Previous track, decrease volume
4. Microphone
5. Charging Port
6. LED Indicator

Battery Charging:

The headphones are powered by rechargeable battery. Please use the included charging cable to recharge the battery.

1. Plug the larger connector into a USB power source.
2. Plug the smaller connector into the charging port (5).
3. The LED indicator will turn RED while charging.
4. The LED indicator will turn OFF when fully charged.

How to use this headset:

A. Powering ON/OFF

Function	Operation	LED Indicator
Power On	Press and hold the [>] button for ~3-5 seconds	Blue LED flashes quickly
Power Off	Press and hold the [>] button for ~3-5 seconds	LED turns OFF

CAUTION

- Danger of explosion if battery is incorrectly replaced.
- Replace only with same or equivalent type.
- Attention should be drawn to the environmental aspect of battery disposal.
- The use of apparatus in moderate climates.
- The batteries shall not be exposed to excessive heat such as sunshine, fire or the like.

WARNING:

- Do not dispose of unit in fire or water.
- Never attempt to disassemble and reassemble. Waste electrical products should not be disposed of with household waste, please recycle where facilities exist. Check with your local authority for recycle advice.
- Keep your device and all accessories out of the reach of children and animals. Small parts may cause choking or serious injury if swallowed.
- Avoid exposing your device to very cold or very hot temperatures (below 0°C or above 45°C).
- Extreme temperatures can cause deforming of the device and reduce the charging capacity and life of your device.
- Do not allow your device to get wet—liquids can cause serious damage. Do not handle your device with wet hands.

B. Bluetooth Pairing

1. Power ON. A voice will be heard, and the LED indicator will quickly flash BLUE.
2. Set your mobile device to search for Bluetooth devices. When it appears, select anko BT headphone from the list of found devices.
3. After a successful pairing, a voice will be heard and the LED indicator will slowly flash BLUE.

C. Phone calls

1. Press [>] button to answer or end a phone call.
2. 2x press the [>] button to dial the last outgoing number.
3. Press + hold the [>] button to reject an incoming call.

D. Playing music

When the headphones are connected to a device via Bluetooth, you can enjoy music through the headphones wirelessly.

Function	Operation
Pause	Short press [>] button
Play	Short press [>] button
Next Track	Short press [+] button
Previous Song	Short press [-] button
Raise Volume	Long press [+] button
Lower Volume	Long press [-] button

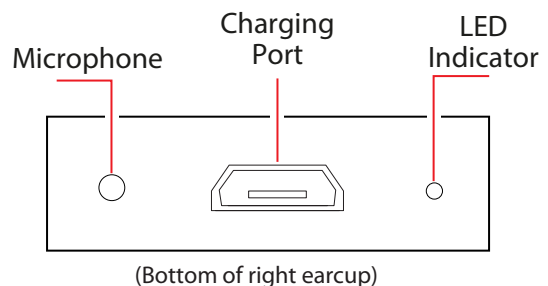
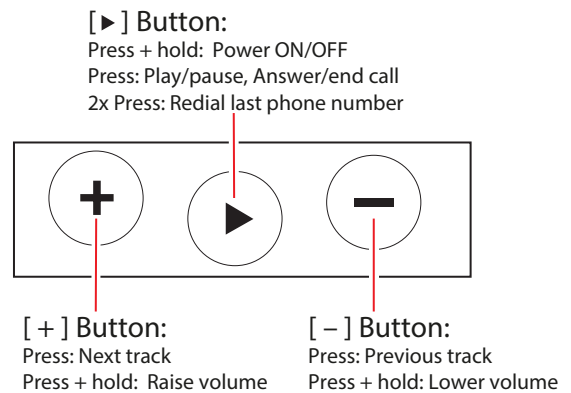

The Bluetooth® word mark and logos are registered trademarks owned by Bluetooth® SIG, Inc, and any use of such marks by KMART AUSTRALIA is under licence.