

AGES 8+ YEARS

2.4GHz SMART TALKING ROBOT

MANUAL



PACKAGE CONTENTS

• Smart Talking Robot • Remote Control • User's Manual

IMPORTANT SAFETY PRECAUTIONS

READ ALL INSTRUCTIONS BEFORE USING YOUR ROBOT.

1. Do not use your robot near water. Clean using a soft cloth or paper towel.
2. Do not place your robot on any wet surfaces.
3. Do not allow children under age eight to play with robot without adult supervision.
4. Do not expose your robot to excessive heat, flames or fire.
5. Always press all buttons or switches carefully.
6. Do not use in extremely dry environments, as this can lead to static discharge during usage.
7. Do not expose your robot to temperatures above 40°C. Keep out of direct sunlight.
8. Do not drop, puncture or expose your robot to excessive trauma.
9. Your robot is not intended for commercial use.

ROBOT



REMOTE CONTROL



-1-

INSERTING BATTERIES

Robot

1. Unscrew to open battery cover, insert 3 X 1.5V AAA batteries.
 2. Replace battery cover.
- Attention: remove batteries after you have finished using your product.

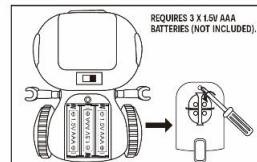

Remote control

1. Unscrew to open battery cover, insert 3 X 1.5V AAA batteries.
 2. Replace battery cover.
- Attention: remove batteries after you have finished using your product.

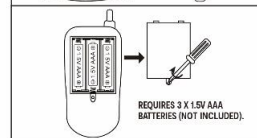

POWERING ON YOUR ROBOT

Once you have inserted batteries into your robot and remote control, you can go ahead and power on your robot first, then press and hold the ON/OFF button a second on the controller. When the indicator light on the controller stops flashing, that means they are matched.

NOTE: When your robot is running low on power, it will emit a warning sound of "di-di-di". Once the batteries are completely depleted, replace the batteries as soon as possible to continue use.

MOVING YOUR ROBOT

You can use your remote control to move your robot around in different directions.

By pressing the up or down arrow buttons your robot will move forwards or backwards.

By pressing the left and right arrow buttons, your robot will turn left or right.



-2-

LISTENING / VOICE TRANSMISSION

Control the robot and move it close to who you want to talk to. Press and hold the listening button to hear in real time.

Control the robot and move it close to who you want it to talk to. Press and hold the call button to talk.

MUSIC

There are 3 kinds of music, press the Music button, the robot will dance with music.

SOUND EFFECT

There are 3 kinds of sound effects, press the sound effect button to play.

PROGRAMMING YOUR ROBOT TO WALK

Press the Program button, then you could press Forward / Backward / Turn left / Turn right button on the controller to program your own. Robot can be programmed with over to 30 actions.

Press the Program play button to make robot perform the programmed actions.

Keycode: 43022045

WARNING: BATTERIES ARE TO BE INSERTED WITH THE CORRECT POLARITY (+ AND -). DO NOT MIX DIFFERENT TYPES OF BATTERIES OR NEW AND USED BATTERIES. NON-RECHARGEABLE BATTERIES ARE NOT TO BE RECHARGED. RECHARGEABLE BATTERIES ARE ONLY TO BE CHARGED UNDER ADULT SUPERVISION. RECHARGEABLE BATTERIES ARE TO BE REMOVED FROM THE TOY BEFORE BEING CHARGED. THE SUPPLY TERMINALS ARE NOT TO BE SHORT-CIRCUITED. REMOVE BATTERIES FROM THE TOY WHEN NOT IN USE FOR EXTENDED TIME OR WHEN BATTERIES BECOME EXHAUSTED. BATTERY INSTALLATION BY AN ADULT IS REQUIRED. DISPOSE OF BATTERIES RESPONSIBLY. DO NOT DISPOSE OF IN FIRE.

PRODUCT MAY VARY SLIGHTLY FROM IMAGE SHOWN. READ THE INSTRUCTIONS BEFORE OPERATING THE PRODUCT. PLEASE KEEP THE PACKAGING AND INSTRUCTION MANUAL FOR FUTURE REFERENCE.

WARNING: CHOKING HAZARD
SMALL PARTS. NOT FOR CHILDREN UNDER 3 YRS.

WARNING: FOR SAFETY REASONS, REMOVE ALL TAGS, LABELS AND PLASTIC FASTENERS BEFORE GIVING THIS TOY TO YOUR CHILD.

WARNING: THIS TOY PRODUCES FLASHES THAT MAY TRIGGER EPILEPSY IN SENSITISED INDIVIDUALS.

-3-