

Bestway®



58381

OWNER'S MANUAL

bestwaycorp.com/support

Visit Bestway YouTube channel 

FILTER PUMP OWNER'S MANUAL

WARNING IMPORTANT SAFETY INSTRUCTIONS

READ AND FOLLOW ALL INSTRUCTIONS

WARNING-RISK OF ELECTRIC SHOCK-The pump is to be supplied by an isolating transformer or supplied through a residual current device (RCD) having a rated residual operating current not exceeding 30 mA. The appliance must be supplied by earthed power source.

Extension cords can't be used.

WARNING- RISK OF ELECTRIC SHOCK- The pump cannot be using while people are inside the pool.

DO NOT BURY CORD. Locate cord to minimize abuse from lawn mowers, hedge trimmers, and other equipment.

WARNING- The supply cord cannot be replaced. If the cord is damaged the appliance should be scrapped.

CAUTION- This pump is for use with storable pools only. Do not use with permanently-installed pools. A storable pool is constructed so that it is capable of being readily disassembled for storage and reassembled to its original integrity. A permanently-installed pool is constructed in or on the ground or in a building such that it cannot be readily disassembled for storage.

IMPORTANT - Using the pump with an unmatched electrical supply is dangerous and will result in catastrophic failure of pump.

RISK OF ELECTRICAL SHOCK- When working with electricity, turn the electrical power off at the circuit breaker and lock breaker door. Failure to do so will result in increased risk of shock, injury and possibly death.

DO NOT REMOVE THE GROUNDING PRONG OR MODIFY THE PLUG IN ANY WAY. DO NOT USE ADAPTOR PLUGS. Consult a qualified electrician for any questions related to the validity of your plugs grounding.

Handle the pump with care. Do not pull or carry the pump by the power cord. Never pull a plug from the outlet by yanking the power cord. Keep cord free from abrasions. Sharp objects, oil, moving parts, and heat should never be exposed to the filter pump.

WARNING- This appliance is not intended for use by persons (including children) with reduced physical, sensory or mental capabilities, or lack of experience and knowledge, unless they have been given supervision or instruction concerning use of the appliance by a person responsible

for their safety. Children should be supervised to ensure that they do not play with this product.

CAUTION: Read the instruction before using the appliance and installation/reassemble each time.

Cleaning and user maintenance must be performed by an adult above 18 years old who is familiar with the risk of electric shock.

NOTE:

Please examine equipment before use. Notify Bestway at the customer service address listed on this manual for any manufacturing defect or missing parts at the time of purchase. Verify that the equipment components represent the filter pump model that you had intended to purchase.

NOTE:

Place pump on a solid and level ground. Pay attention to position of pool and pump so adequate ventilation, drainage, and access for cleaning is available. Never place pump in an area that may accumulate water, or in an area where foot traffic will flow around the pool.

It is necessary to have the plug accessible after installation of the pool.

NOTE:

Atmospheric conditions may affect the performance and life span of your filter pump. Unnecessary wear and tear may occur during periods of cold, heat and exposure to sun. Whenever possible shelter pump from these conditions.

It is important to ensure the factory equipped stopper plugs for the inlet and outlet ports replace the screens before removal or maintenance on the pump is attempted.

NOTE:

Do not add chemicals in the filter pump.

Don't plug or unplug the appliance if hand is wet.

Always unplug the appliance:

- On raining days
- Before cleaning or other maintenance
- Leave it unattended on holidays

When the appliance will be not used for long time, such as in the winter, the pool set should be disassembled and stored indoor.

Safekeeping the instruction. For reconstruction the pool set every time, please always refer to the instructions.

-If instruction is missed, please contact with Bestway or search it in website: www.bestwaycorp.com

NOTE: This product is not intended for commercial use.

SAVE THESE INSTRUCTIONS.

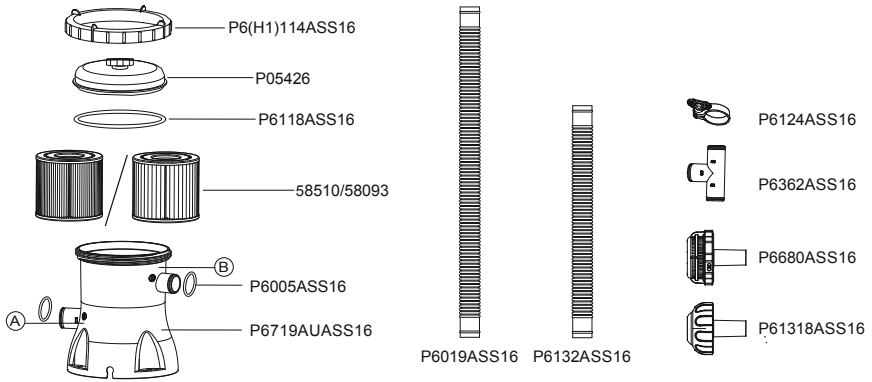

	A	B	C
P05426	1	1	1
P6(H1)114ASS16	1	1	1
P6118ASS16	1	1	1
58510/58093	1	1	1
P6719AUASS16	1	1	1
P6019ASS16	2	2	2
P6132ASS16	2	2	0
P6124ASS16	8	5	2
P6005ASS16	5	5	2
P6362ASS16	1	1	0
P6680ASS16	2	0	0
P61318ASS16	1	0	0

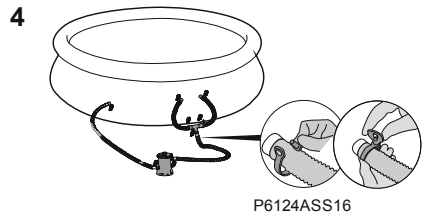
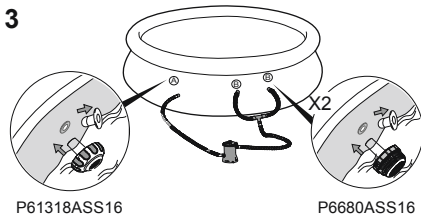
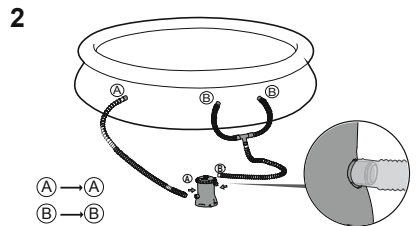
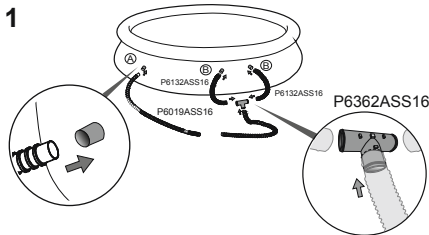
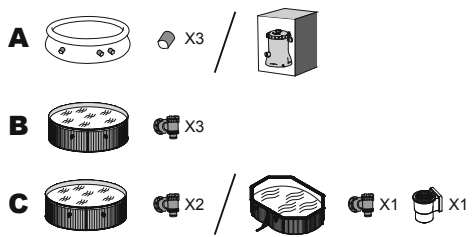

PEDESTAL FIXING

IEC60335-2-41 TEST standard requires the filter pump to be vertically fixed on ground or a certain pedestal made of wood or concrete before use. There should be two holes 9mm in diameter on the pedestal, the space between which should be 127mm. Put filter pump on the pedestal and fix them together by fasten the bolts and nuts. All the pedestal parts should weigh over 18kgs at least to prevent the pump from accidentally falling.

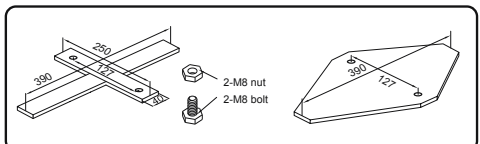

NOTE: It is imperative to check that the hydraulic connectors are not closed.

Operation

- 1) Open/unscrew the Air Purge Valve on the top of the Filter Pump; air is released as water fills the Filter Pump.
- 2) When water comes out of the Air Purge Valve screw it closed and wipe away any water.
- 3) To start the Filter Pump, insert the plug into a residual current device (RCD).

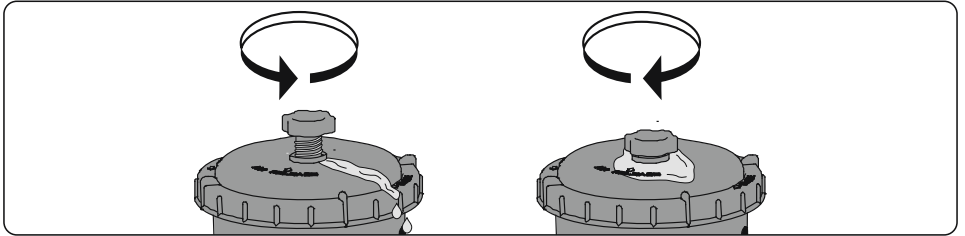

IMPORTANT: DO NOT DRY RUN THE FILTER PUMP - Make sure both the pool's Inlet and Outlet valves are fully covered by water before operating the Filter Pump.

Maintenance

CAUTION: YOU MUST ENSURE THE FILTER PUMP IS UNPLUGGED BEFORE ANY MAINTENANCE OR STORAGE BEGINS OR SEVERE RISK OF INJURY OR DEATH EXISTS.

- 1) Unplug the Filter Pump.
- 2) Loosen the Hose Clamps on the pool's Inlet and Outlet Hoses by unscrewing the fly nut counter-clockwise.
- 3) Remove Debris Screens from inside of pool.
- 4) Replace the Debris Screens with the Stopper Plugs in the pool's Inlet and Outlet Valves.
- 5) Unscrew the Filter Cap Retainer and remove the Filter Cap.
- 6) Clean the Filter Cartridge with a garden hose, if filter cartridge remains soiled or discolored, it is necessary to replace it with a new one.
- 7) Insert the cleaned (or new) Filter Cartridge; ensure it is centered in the Filter Pump.
- 8) Check that the Filter Cap Seal is in place.
- 9) Replace the Filter Cap and screw the Filter Cap Retainer into position.
- 10) Replace the Stopper Plugs with the Debris Screens in the pool's Inlet and Outlet Valves. Tighten the Hose Clamps. Water will now flow to the pump.
- 11) Follow PUMP INSTALLATION DIRECTIONS section to prepare the system for use.

IMPORTANT: For sanitary reasons we suggest replacing the Filter Cartridge with a new one every two weeks.

STORAGE

- 1) Unplug the Filter Pump.
- 2) Follow the instructions as previously outline to stop water flowing to the Filter Pump and to remove the Filter Cartridge.
- 3) Discard the Filter Cartridge.
- 4) Detach all Hoses.
- 5) Dry all components thoroughly.
- 6) Store the filter pump in a dry location out of child's reach. Storage temperature: 4-40°C (39.2-104°F)

Pump Warranty

For information concerning pump warranty please visit our website at: www.bestwaycorp.com



For support please visit us at:
bestwaycorp.com/support

©2020 Bestway Inflatables & Material Corp.

All rights reserved/Tous droits réservés/Todos los derechos reservados/Alle Rechte vorbehalten/Tutti i diritti riservati

®™ Trademarks used in some countries under license to/

Marques ®™ utilisées dans certains pays sous la licence de/

Marcas comerciales ®™ utilizadas en algunos países bajo la licencia de/

®™ Die Warenzeichen werden in einigen Ländern verwendet unter Lizenz der/

®™ Marchi utilizzati in alcuni paesi concessi in licenza a

Bestway Inflatables & Material Corp., No.3065 Cao An Road, Shanghai, 201812, China.

Manufactured, distributed and represented in the European Union by/

Fabriqués, distribués et représentés dans l'Union Européenne par/Fabricado, distribuido y representado en la Unión Europea por/

Hergestellt, vertrieben und in der Europäischen Union vertreten von/Prodotto, distribuito e rappresentato nell'Unione Europea da

Bestway (Europe) S.r.l., Via Resistenza, 5, 20098 San Giuliano Milanese (Milano), Italy

Distributed in North America by/Distribués en Amérique du Nord par/Distribuido en Norteamérica por

Bestway (USA) Inc., 3411 E. Harbour Drive, Phoenix, Arizona 85034, United States of America

Tel: +86 21 69135588 (For U.S. and Canada)

Distributed in Latin America by/Distribués en Amérique latine par/Distribuido en Latinoamérica por/Distribuido en América Latina por

Bestway Central & South America Ltda, Salar Ascotan 1282, Parque Enea, Pudahuel, Santiago, Chile

Distributed in Australia & New Zealand by **Bestway Australia Pty Ltd, Unit 2/98-104 Carnarvon St Silverwater, NSW 2128, Australia**

Tel: Australia: (+61) 29 0371 388; New Zealand: 0800 142 101

Exported by/Exporté par/Exportado por/Exportiert von/Esportato da

Bestway (Hong Kong) International Ltd./Bestway Enterprise Company Limited

Suite 713, 7/Floor, East Wing, Tsim Sha Tsui Centre, 66 Mody Road, Kowloon, Hong Kong

www.bestwaycorp.com

Bestway®

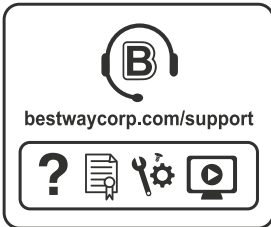

OWNER'S MANUAL

bestwaycorp.com/support

Visit Bestway YouTube channel 

Pre-Installation Checklist

- The pool must be set up on a completely flat and level surface. Please do not install the pool if the surface is inclined or sloped.
- The selected location must be capable of uniformly supporting the weight for the entire time the pool is installed with water, moreover the location must be flat, must be cleared of all objects and debris including stones and twigs.
- The pool must be away from any objects children could use to climb into the pool.
- Position the pool near an adequate drainage system to deal with overflow or to discharge the pool. We recommend picking a location that is at least 20' away from your home.

Incorrect conditions to set up the pool:

- On uneven ground the pool may collapse causing serious personal injury and/or damage to personal property and will void the warranty and prevent any service claims.
- Sand should not be used to create a level base; the ground must be dug out if necessary.
- Directly under overhead power lines or trees. Be sure the location does not contain underground utility pipes, lines or cables of any kind.
- Do not set up the pool on driveways, decks, platforms, gravel or asphalt surfaces. The selected location should be firm enough to withstand the pressure of the water; Mud, sand, soft / loose soil or tar are not suitable.
- Grass or other vegetation under the pool will die and may cause odors and slime to develop, therefore we recommend removing all grass from the selected pool location.
- Avoid areas prone to aggressive plant and weed species that may grow through the ground cloth or liner.

Pre-installation:

Bestway will not be responsible for damage caused to the pool due to mishandling or failure to follow these instructions.

1. Lay out all parts and check that you have the correct quantities as listed in the components list. If you are missing any part do not assemble the pool, contact Bestway Customers Service.
2. Spread out the pool and make sure the pool is right side up, let it sit exposed to direct sunlight for 1 hour or more so that the pool is more flexible during set up.
3. Place the pool near an adequate drainage system to deal with overflow water and ensure the pool's inlet A and outlet B are correctly positioned to allow your filter pump to connect to a power source.

NOTES:

- Do not use extension power cords to power your pump.
- Do not drag the pool on the ground, this can damage the pool.
- Check with your local city council for by-laws relating to fencing, barriers, lighting and safety requirements and ensure you comply with all laws.
- If have a filter pump, refer to the pump's manual for instructions.

The ladder must match the pool size and should to be used only for entering and exiting the pool. It is forbidden to exceed the permitted payload of the ladder. Check regularly if the ladder is properly assembled.



WARNING

smooth out the bottom

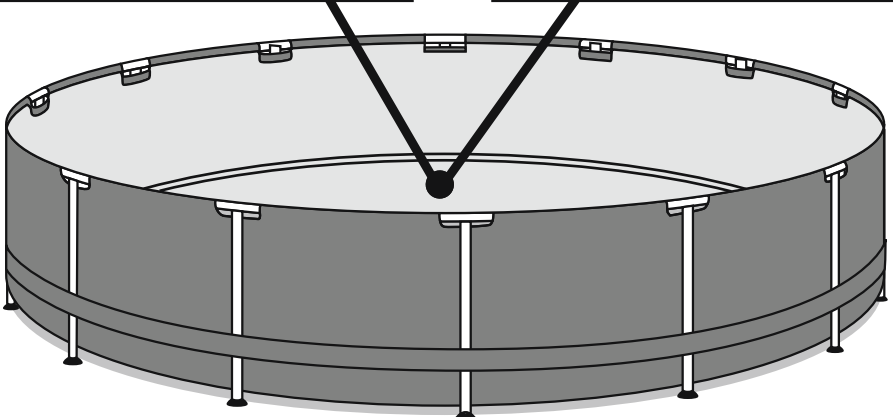
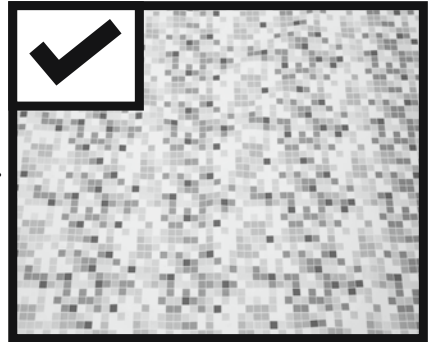
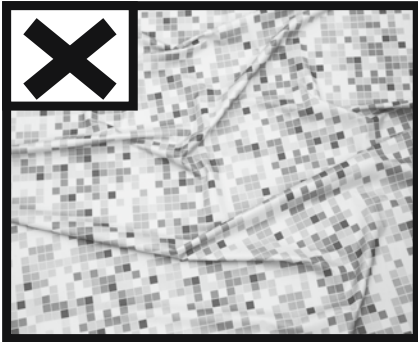

Put 1" to 2" water in the pool to cover the floor. Once pool floor is slightly covered, gently smooth out all wrinkles. Start in the center of the pool and work your way clockwise to the outside.

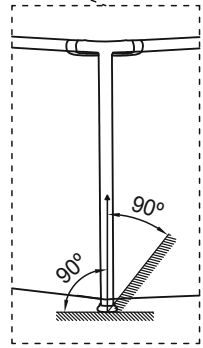
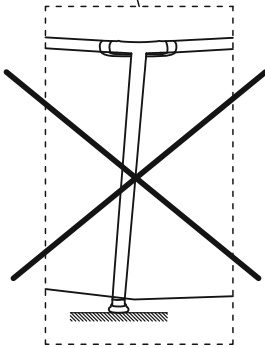
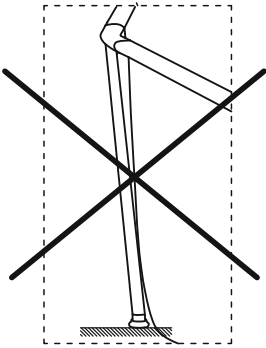
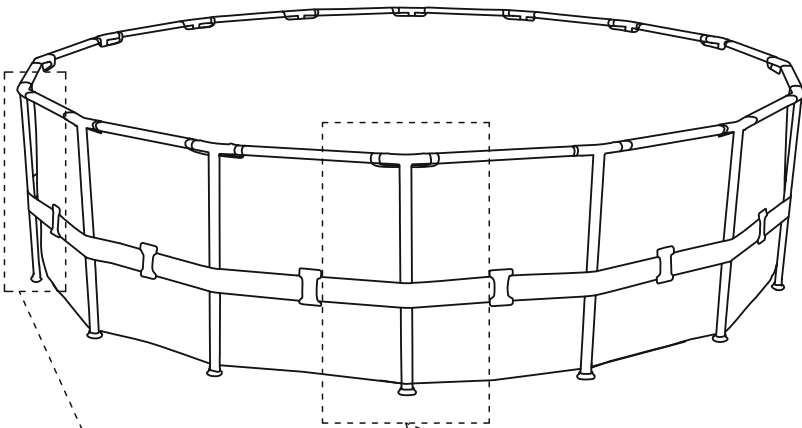

After the installation of the pool's steel frame is completed, ensure that the verticals are perpendicular to the ground. If they aren't, the verticals could be bent or deformed.

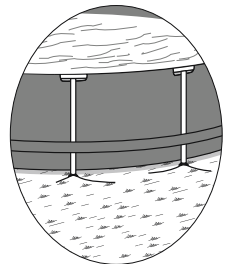
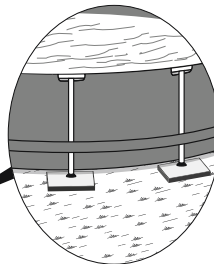
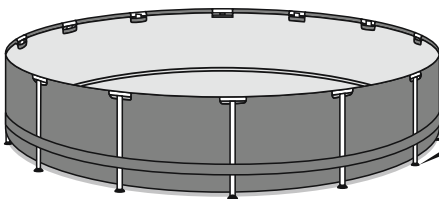

Do not assemble with pool legs on soft lawn. If you must assemble the pool on a soft surface, timber boards (not included) must be placed under the feet of the vertical support rods for even weight distribution.

The timber board must meet two conditions:

- 1). The thickness is less than 1cm.
- 2). The board should not touch the pool liner.

WARNING

Carefully read, understand, and follow all information in this user manual before installing and using the swimming pool. These warnings, instructions, and safety guidelines address some common risks of water recreation, but they cannot cover all risks and dangers in all cases. Always use caution, common sense, and good judgment when enjoying any water activity. Retain this information for future use.

Non Swimmers safety

- Continuous, active, and vigilant supervision of weak swimmers and non-swimmers by a competent adult is required at all times (remembering that children under five are at the highest risk of drowning).
- Designate a competent adult to supervise the pool each time it is being used.
- Weak swimmers or non-swimmers should wear personal protection equipment when using the pool.
- When the pool is not in use, or unsupervised, remove all toys from the swimming pool and its surrounding to avoid attracting children to the pool.

Safety devices

- In order to prevent children from drowning, it is recommended to secure the access to the pool with a protection device. In order to prevent children climbing from the inlet and outlet valve, it is recommended to install a barrier (and secure all doors and windows, where applicable) to prevent unauthorized access to the swimming pool.
- Barriers, pool covers, pool alarms, or similar safety devices are helpful aids, but they are not substitutes for continuous and competent adult supervision.

Safety equipment

- It is recommended to keep rescue equipment (e.g. a ring buoy) by the pool.
- Keep a working phone and a list of emergency phone numbers near the pool.

Safe use of the pool

- Encourage all users especially children to learn how to swim.
- Learn Basic Life Support (Cardiopulmonary Resuscitation - CPR) and refresh this knowledge regularly. This can make a life-saving difference in the event of an emergency.
- Instruct all pool users, including children, what to do in case of an emergency.
- Never dive into any shallow body of water. This can lead to serious injury or death.
- Do not use the swimming pool when using alcohol or medication that may impair your ability to safely use the pool.
- When pool covers are used, remove them completely from the water surface before entering the pool.
- Protect pool occupants from water related illnesses by keeping the pool water treated and practicing good hygiene. Consult the water treatment guidelines in the user's manual.
- Store chemicals (e.g. water treatment, cleaning or disinfection products) out of the reach of children.
- Use the signage as outlined below. Signage is to be displayed in a prominent position within 2m of the pool.



Keep children under supervision in the aquatic environment. No diving.

- Removable ladders shall be placed on a horizontal surface.
- Irrespective of materials used for swimming pool construction, accessible surfaces have to be checked regularly to avoid injuries.
- Regularly monitor bolts and screws. Remove splinters or any sharp edges to avoid injuries.
- **ATTENTION:** Do not leave the drained pool outside. The empty pool is liable to become deformed and/or displaced due to wind.

- If you have a filter pump, refer to the pump's manual for instructions.

WARNING! The pump cannot be used while people are inside the pool!

- If you have a ladder, refer to the ladder's manual for instructions.
- **WARNING!** The use of a swimming pool implies compliance with the safety instructions described in the operating and maintenance guide. In order to prevent drowning or other serious injuries, pay particular attention to the possibility of unexpected access to the swimming pool by children under 5 years by securing the access to it, and, during the bathing period, keep them under constant adult supervision.

Please read carefully and keep for future reference

Installation usually takes approximately 20-30 minutes with 2-3 people excluding earthworks and filling.

Part descriptions.

NOTE: Some parts already have been installed on the pool.

STEEL PRO™

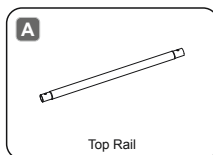

SIZE	ITEM#	PART CODE	QTY
3.05 m x 66 cm (10' x 26")	#56986	P04398	10
3.05 m x 76 cm (10' x 30")	#56678 #56729	P04398	10
3.66 m x 76 cm (12' x 30")	#12487	P04398	12

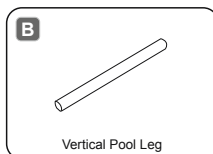

SIZE	ITEM#	PART CODE	QTY
3.05 m x 66 cm (10' x 26")	#56986	P04503	10
3.05 m x 76 cm (10' x 30")	#56678 #56729	P04399	10
3.66 m x 76 cm (12' x 30")	#12487	P04399	12

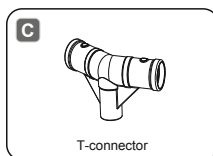

SIZE	ITEM#	PART CODE	QTY
3.05 m x 66 cm (10' x 26")	#56986	P04400	10
3.05 m x 76 cm (10' x 30")	#56678 #56729	P04400	10
3.66 m x 76 cm (12' x 30")	#12487	P04401	12

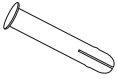
D

Pin

SIZE	ITEM#	PART CODE	QTY
3.05 m x 66 cm (10' x 26")	#56986	P61020ASS16	22
3.05 m x 76 cm (10' x 30")	#56678 #56729	P61020ASS16	22
3.66 m x 76 cm (12' x 30")	#12487	P61020ASS16	26

H

Hose Adaptor

SIZE	ITEM#	PART CODE	QTY
3.05 m x 66 cm (10' x 26")	#56986	P6H1419ASS16	1
3.05 m x 76 cm (10' x 30")	#56678 #56729	P6H1419ASS16	1
3.66 m x 76 cm (12' x 30")	#12487	P6H1419ASS16	1

E

Footing

SIZE	ITEM#	PART CODE	QTY
3.05 m x 66 cm (10' x 26")	#56986	P61010ASS16	10
3.05 m x 76 cm (10' x 30")	#56678 #56729	P61010ASS16	10
3.66 m x 76 cm (12' x 30")	#12487	P61010ASS16	12

I

Stopper

SIZE	ITEM#	PART CODE	QTY
3.05 m x 66 cm (10' x 26")	#56986	P6C1418ASS19	3
3.05 m x 76 cm (10' x 30")	#56678 #56729	P6C1418ASS19	3
3.66 m x 76 cm (12' x 30")	#12487	P6C1418ASS19	3

F

Pin Gasket

SIZE	ITEM#	PART CODE	QTY
3.05 m x 66 cm (10' x 26")	#56986	P04429	22
3.05 m x 76 cm (10' x 30")	#56678 #56729	P04429	22
3.66 m x 76 cm (12' x 30")	#12487	P04429	26

J

Drain Valve Cap

SIZE	ITEM#	PART CODE	QTY
3.05 m x 66 cm (10' x 26")	#56986	P6H1158ASS16	1
3.05 m x 76 cm (10' x 30")	#56678 #56729	P6H1158ASS16	1
3.66 m x 76 cm (12' x 30")	#12487	P6H1158ASS16	1

G

Liner

SIZE	ITEM#	PART CODE	QTY
3.05 m x 66 cm (10' x 26")	#56986	P04505	1
3.05 m x 76 cm (10' x 30")	#56678 #56729	P04455	1
3.66 m x 76 cm (12' x 30")	#12487	P05786	1

STEEL PRO MAX™

A



Top Rail

SIZE	ITEM#	PART CODE	QTY
3.05 m x 76 cm (10' x 30")	#56493 #56407	P04740	10
3.66 m x 76 cm (12' x 30")	#56417	P04740	12
3.66 m x 1.00 m (12' x 39.5")	#56419	P04402	12
3.66 m x 1.00 m (12' x 39.5")	#56731	P04408	12
3.66 m x 1.22 m (12' x 48")	#56421	P04402	12
4.27 m x 84 cm (14' x 33")	#56597	/	0
4.27 m x 1.07 m (14' x 42")	#56949	/	0
4.57 m x 1.07 m (15' x 42")	#56686	/	0
4.57 m x 1.22 m (15' x 48")	#56439	/	0
5.49 m x 1.22 m (18' x 48")	#56463	/	0

B



Top Rail

SIZE	ITEM#	PART CODE	QTY
3.05 m x 76 cm (10' x 30")	#56493 #56407	/	0
3.66 m x 76 cm (12' x 30")	#56417	/	0
3.66 m x 1.00 m (12' x 39.5")	#56419	/	0
3.66 m x 1.00 m (12' x 39.5")	#56731	/	0
3.66 m x 1.22 m (12' x 48")	#56421	/	0
4.27 m x 84 cm (14' x 33")	#56597	P61793ASS18	14
4.27 m x 1.07 m (14' x 42")	#56949	P61793ASS18	14
4.57 m x 1.07 m (15' x 42")	#56686	P61793ASS18	15
4.57 m x 1.22 m (15' x 48")	#56439	P61793ASS18	15
5.49 m x 1.22 m (18' x 48")	#56463	P61798ASS18	18

C

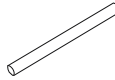

Vertical Pool Leg

SIZE	ITEM#	PART CODE	QTY
3.05 m x 76 cm (10' x 30")	#56493 #56407	P04403	10
3.66 m x 76 cm (12' x 30")	#56417	P04403	12
3.66 m x 1.00 m (12' x 39.5")	#56419	P04406	12
3.66 m x 1.00 m (12' x 39.5")	#56731	P04409	12
3.66 m x 1.22 m (12' x 48")	#56421	P04407	12
4.27 m x 84 cm (14' x 33")	#56597	/	0
4.27 m x 1.07 m (14' x 42")	#56949	/	0
4.57 m x 1.07 m (15' x 42")	#56686	/	0
4.57 m x 1.22 m (15' x 48")	#56439	/	0
5.49 m x 1.22 m (18' x 48")	#56463	/	0

D



Vertical Pool Leg

SIZE	ITEM#	PART CODE	QTY
3.05 m x 76 cm (10' x 30")	#56493 #56407	/	0
3.66 m x 76 cm (12' x 30")	#56417	/	0
3.66 m x 1.00 m (12' x 39.5")	#56419	/	0
3.66 m x 1.00 m (12' x 39.5")	#56731	/	0
3.66 m x 1.22 m (12' x 48")	#56421	/	0
4.27 m x 84 cm (14' x 33")	#56597	P61791ASS18	14
4.27 m x 1.07 m (14' x 42")	#56949	P61792ASS18	14
4.57 m x 1.07 m (15' x 42")	#56686	P61792ASS18	15
4.57 m x 1.22 m (15' x 48")	#56439	P61794ASS18	15
5.49 m x 1.22 m (18' x 48")	#56463	P61799ASS18	18

E

T-connector

SIZE	ITEM#	PART CODE	QTY
3.05 m x 76 cm (10' x 30")	#56493 #56407	P04404	10
3.66 m x 76 cm (12' x 30")	#56417	P04741	12
3.66 m x 1.00 m (12' x 39.5")	#56419	P04405	12
3.66 m x 1.00 m (12' x 39.5")	#56731	P04410	12
3.66 m x 1.22 m (12' x 48")	#56421	P04405	12
4.27 m x 84 cm (14' x 33")	#56597	/	0
4.27 m x 1.07 m (14' x 42")	#56949	/	0
4.57 m x 1.07 m (15' x 42")	#56686	/	0
4.57 m x 1.22 m (15' x 48")	#56439	/	0
5.49 m x 1.22 m (18' x 48")	#56463	/	0

G

Pin

SIZE	ITEM#	PART CODE	QTY
3.05 m x 76 cm (10' x 30")	#56493 #56407	P61783ASS18	22
3.66 m x 76 cm (12' x 30")	#56417	P61783ASS18	26
3.66 m x 1.00 m (12' x 39.5")	#56419	P61783ASS18	26
3.66 m x 1.00 m (12' x 39.5")	#56731	P61783ASS18	26
3.66 m x 1.22 m (12' x 48")	#56421	P61783ASS18	26
4.27 m x 84 cm (14' x 33")	#56597	P61796ASS18	30
4.27 m x 1.07 m (14' x 42")	#56949	P61796ASS18	30
4.57 m x 1.07 m (15' x 42")	#56686	P61796ASS18	32
4.57 m x 1.22 m (15' x 48")	#56439	P61796ASS18	32
5.49 m x 1.22 m (18' x 48")	#56463	P61754ASS18	38

F

T-connector

SIZE	ITEM#	PART CODE	QTY
3.05 m x 76 cm (10' x 30")	#56493 #56407	/	0
3.66 m x 76 cm (12' x 30")	#56417	/	0
3.66 m x 1.00 m (12' x 39.5")	#56419	/	0
3.66 m x 1.00 m (12' x 39.5")	#56731	/	0
3.66 m x 1.22 m (12' x 48")	#56421	/	0
4.27 m x 84 cm (14' x 33")	#56597	P61790ASS18	14
4.27 m x 1.07 m (14' x 42")	#56949	P61790ASS18	14
4.57 m x 1.07 m (15' x 42")	#56686	P61790ASS18	15
4.57 m x 1.22 m (15' x 48")	#56439	P61795ASS18	15
5.49 m x 1.22 m (18' x 48")	#56463	P61800ASS18	18

H

Footing

SIZE	ITEM#	PART CODE	QTY
3.05 m x 76 cm (10' x 30")	#56493 #56407	P61785ASS18	10
3.66 m x 76 cm (12' x 30")	#56417	P61785ASS18	12
3.66 m x 1.00 m (12' x 39.5")	#56419	P61785ASS18	12
3.66 m x 1.00 m (12' x 39.5")	#56731	P61785ASS18	12
3.66 m x 1.22 m (12' x 48")	#56421	P61785ASS18	12
4.27 m x 84 cm (14' x 33")	#56597	P61797ASS18	14
4.27 m x 1.07 m (14' x 42")	#56949	P61797ASS18	14
4.57 m x 1.07 m (15' x 42")	#56686	P61797ASS18	15
4.57 m x 1.22 m (15' x 48")	#56439	P61797ASS18	15
5.49 m x 1.22 m (18' x 48")	#56463	P61756ASS18	18

I

Pin Gasket

SIZE	ITEM#	PART CODE	QTY
3.05 m x 76 cm (10' x 30")	#56493 #56407	P61755ASS18	22
3.66 m x 76 cm (12' x 30")	#56417	P61755ASS18	26
3.66 m x 1.00 m (12' x 39.5")	#56419	P61755ASS18	26
3.66 m x 1.00 m (12' x 39.5")	#56731	P61755ASS18	26
3.66 m x 1.22 m (12' x 48")	#56421	P61755ASS18	26
4.27 m x 84 cm (14' x 33")	#56597	P61755ASS18	30
4.27 m x 1.07 m (14' x 42")	#56949	P61755ASS18	30
4.57 m x 1.07 m (15' x 42")	#56686	P61755ASS18	32
4.57 m x 1.22 m (15' x 48")	#56439	P61755ASS18	32
5.49 m x 1.22 m (18' x 48")	#56463	P61755ASS18	38

K

Hose Adaptor

SIZE	ITEM#	PART CODE	QTY
3.05 m x 76 cm (10' x 30")	#56493 #56407	P6H1419ASS16	1
3.66 m x 76 cm (12' x 30")	#56417	P6H1419ASS16	1
3.66 m x 1.00 m (12' x 39.5")	#56419	P6H1419ASS16	1
3.66 m x 1.00 m (12' x 39.5")	#56731	P6H1419ASS16	1
3.66 m x 1.22 m (12' x 48")	#56421	P6H1419ASS16	1
4.27 m x 84 cm (14' x 33")	#56597	P6H1419ASS16	1
4.27 m x 1.07 m (14' x 42")	#56949	P6H1419ASS16	1
4.57 m x 1.07 m (15' x 42")	#56686	P6H1419ASS16	1
4.57 m x 1.22 m (15' x 48")	#56439	P6H1419ASS16	1
5.49 m x 1.22 m (18' x 48")	#56463	P6H1419ASS16	1

J

Liner

SIZE	ITEM#	PART CODE	QTY
3.05 m x 76 cm (10' x 30")	#56493 #56407	P04463	1
3.66 m x 76 cm (12' x 30")	#56417	P04466	1
3.66 m x 1.00 m (12' x 39.5")	#56419	P00824	1
3.66 m x 1.00 m (12' x 39.5")	#56731	P04494	1
3.66 m x 1.22 m (12' x 48")	#56421	P00828	1
4.27 m x 84 cm (14' x 33")	#56597	P00876	1
4.27 m x 1.07 m (14' x 42")	#56949	P04141	1
4.57 m x 1.07 m (15' x 42")	#56686	P00860	1
4.57 m x 1.22 m (15' x 48")	#56439	P00832	1
5.49 m x 1.22 m (18' x 48")	#56463	P00866	1

L

Cup Holder

SIZE	ITEM#	PART CODE	QTY
3.05 m x 76 cm (10' x 30")	#56493 #56407	P04411	2
3.66 m x 76 cm (12' x 30")	#56417	P04411	2
3.66 m x 1.00 m (12' x 39.5")	#56419	/	0
3.66 m x 1.00 m (12' x 39.5")	#56731	/	0
3.66 m x 1.22 m (12' x 48")	#56421	/	0
4.27 m x 84 cm (14' x 33")	#56597	/	0
4.27 m x 1.07 m (14' x 42")	#56949	/	0
4.57 m x 1.07 m (15' x 42")	#56686	/	0
4.57 m x 1.22 m (15' x 48")	#56439	/	0
5.49 m x 1.22 m (18' x 48")	#56463	/	0

M

Stopper

SIZE	ITEM#	PART CODE	QTY
3.05 m x 76 cm (10' x 30")	#56493 #56407	P6C1418ASS19	3
3.66 m x 76 cm (12' x 30")	#56417	P6C1418ASS19	3
3.66 m x 1.00 m (12' x 39.5")	#56419	P6C1418ASS19	3
3.66 m x 1.00 m (12' x 39.5")	#56731	P6C1418ASS19	3
3.66 m x 1.22 m (12' x 48")	#56421	P6C1418ASS19	3
4.27 m x 84 cm (14' x 33")	#56597	P6C1418ASS19	3
4.27 m x 1.07 m (14' x 42")	#56949	P6C1418ASS19	3
4.57 m x 1.07 m (15' x 42")	#56686	P6C1418ASS19	3
4.57 m x 1.22 m (15' x 48")	#56439	P6C1418ASS19	3
5.49 m x 1.22 m (18' x 48")	#56463	P6C1418ASS19	2

O

Control Valve

SIZE	ITEM#	PART CODE	QTY
3.05 m x 76 cm (10' x 30")	#56493 #56407	/	0
3.66 m x 76 cm (12' x 30")	#56417	/	0
3.66 m x 1.00 m (12' x 39.5")	#56419	/	0
3.66 m x 1.00 m (12' x 39.5")	#56731	/	0
3.66 m x 1.22 m (12' x 48")	#56421	/	0
4.27 m x 84 cm (14' x 33")	#56597	/	0
4.27 m x 1.07 m (14' x 42")	#56949	/	0
4.57 m x 1.07 m (15' x 42")	#56686	/	0
4.57 m x 1.22 m (15' x 48")	#56439	/	0
5.49 m x 1.22 m (18' x 48")	#56463	P6(H1)510ASS16	1

N

Drain Valve Cap

SIZE	ITEM#	PART CODE	QTY
3.05 m x 76 cm (10' x 30")	#56493 #56407	P6H1158ASS16	1
3.66 m x 76 cm (12' x 30")	#56417	P6H1158ASS16	1
3.66 m x 1.00 m (12' x 39.5")	#56419	P6H1158ASS16	1
3.66 m x 1.00 m (12' x 39.5")	#56731	P6H1158ASS16	1
3.66 m x 1.22 m (12' x 48")	#56421	P6H1158ASS16	1
4.27 m x 84 cm (14' x 33")	#56597	P6H1158ASS16	1
4.27 m x 1.07 m (14' x 42")	#56949	P6H1158ASS16	1
4.57 m x 1.07 m (15' x 42")	#56686	P6H1158ASS16	1
4.57 m x 1.22 m (15' x 48")	#56439	P6H1158ASS16	1
5.49 m x 1.22 m (18' x 48")	#56463	P6H1158ASS16	1

P

Pool Inlet Strainer

SIZE	ITEM#	PART CODE	QTY
3.05 m x 76 cm (10' x 30")	#56493 #56407	/	0
3.66 m x 76 cm (12' x 30")	#56417	/	0
3.66 m x 1.00 m (12' x 39.5")	#56419	/	0
3.66 m x 1.00 m (12' x 39.5")	#56731	/	0
3.66 m x 1.22 m (12' x 48")	#56421	/	0
4.27 m x 84 cm (14' x 33")	#56597	/	0
4.27 m x 1.07 m (14' x 42")	#56949	/	0
4.57 m x 1.07 m (15' x 42")	#56686	/	0
4.57 m x 1.22 m (15' x 48")	#56439	/	0
5.49 m x 1.22 m (18' x 48")	#56463	P6H1317ASS16	1

POWER STEEL™

A



Top Rail

SIZE	ITEM#	PART CODE	QTY
4.27 m x 1.07 m (14' x 42")	#56665	P61769ASS18	14
4.88 m x 1.22 m (16' x 48")	#56667	P04737	16
4.88 m x 1.22 m (16' x 48")	#56726	P04737	16
5.49 m x 1.22 m (18' x 48")	#56976	P61775ASS18	18
4.27 m x 1.22 m (14' x 48")	#56443	P05223	14
4.27 m x 1.22 m (14' x 48")	#56994	P05223	14
4.88 m x 1.22 m (16' x 48")	#56453	P04739	16
4.88 m x 1.22 m (16' x 48")	#56965	P04739	16
5.49 m x 1.32 m (18' x 52")	#56884	P05224	18
6.10 m x 1.32 m (20' x 52")	#56881	P05224	20
6.71 m x 1.32 m (22' x 52")	#56887	P05224	22

B



Vertical Pool Leg

SIZE	ITEM#	PART CODE	QTY
4.27 m x 1.07 m (14' x 42")	#56665	P61770ASS18	14
4.88 m x 1.22 m (16' x 48")	#56667	P04736	16
4.88 m x 1.22 m (16' x 48")	#56726	P04736	16
5.49 m x 1.22 m (18' x 48")	#56976	P61776ASS18	18
4.27 m x 1.22 m (14' x 48")	#56443	P61343ASS16	14
4.27 m x 1.22 m (14' x 48")	#56994	P61343ASS16	14
4.88 m x 1.22 m (16' x 48")	#56453	P61343ASS16	16
4.88 m x 1.22 m (16' x 48")	#56965	P61343ASS16	16
5.49 m x 1.32 m (18' x 52")	#56884	P61352ASS16	18
6.10 m x 1.32 m (20' x 52")	#56881	P61352ASS16	20
6.71 m x 1.32 m (22' x 52")	#56887	P61352ASS16	22

C



T-connector

SIZE	ITEM#	PART CODE	QTY
4.27 m x 1.07 m (14' x 42")	#56665	P61771ASS18	14
4.88 m x 1.22 m (16' x 48")	#56667	P04738	16
4.88 m x 1.22 m (16' x 48")	#56726	P04738	16
5.49 m x 1.22 m (18' x 48")	#56976	P61777ASS18	18
4.27 m x 1.22 m (14' x 48")	#56443	P61757ASS18	14
4.27 m x 1.22 m (14' x 48")	#56994	P61757ASS18	14
4.88 m x 1.22 m (16' x 48")	#56453	P61757ASS18	16
4.88 m x 1.22 m (16' x 48")	#56965	P61757ASS18	16
5.49 m x 1.32 m (18' x 52")	#56884	P61761ASS18	18
6.10 m x 1.32 m (20' x 52")	#56881	P61763ASS18	20
6.71 m x 1.32 m (22' x 52")	#56887	P61763ASS18	22

D



Pin

SIZE	ITEM#	PART CODE	QTY
4.27 m x 1.07 m (14' x 42")	#56665	P61754ASS18	30
4.88 m x 1.22 m (16' x 48")	#56667	P61754ASS18	34
4.88 m x 1.22 m (16' x 48")	#56726	P61754ASS18	34
5.49 m x 1.22 m (18' x 48")	#56976	P61759ASS18	38
4.27 m x 1.22 m (14' x 48")	#56443	P61754ASS18	30
4.27 m x 1.22 m (14' x 48")	#56994	P61754ASS18	30
4.88 m x 1.22 m (16' x 48")	#56453	P61754ASS18	34
4.88 m x 1.22 m (16' x 48")	#56965	P61754ASS18	34
5.49 m x 1.32 m (18' x 52")	#56884	P61759ASS18	38
6.10 m x 1.32 m (20' x 52")	#56881	P61759ASS18	42
6.71 m x 1.32 m (22' x 52")	#56887	P61759ASS18	46

E

Footing

SIZE	ITEM#	PART CODE	QTY
4.27 m x 1.07 m (14' x 42")	#56665	P61756ASS18	14
4.88 m x 1.22 m (16' x 48")	#56667	P61756ASS18	16
4.88 m x 1.22 m (16' x 48")	#56726	P61756ASS18	16
5.49 m x 1.22 m (18' x 48")	#56976	P61760ASS18	18
4.27 m x 1.22 m (14' x 48")	#56443	P61756ASS18	14
4.27 m x 1.22 m (14' x 48")	#56994	P61756ASS18	14
4.88 m x 1.22 m (16' x 48")	#56453	P61756ASS18	16
4.88 m x 1.22 m (16' x 48")	#56965	P61756ASS18	16
5.49 m x 1.32 m (18' x 52")	#56884	P61760ASS18	18
6.10 m x 1.32 m (20' x 52")	#56881	P61760ASS18	20
6.71 m x 1.32 m (22' x 52")	#56887	P61760ASS18	22

F

Pin Gasket

SIZE	ITEM#	PART CODE	QTY
4.27 m x 1.07 m (14' x 42")	#56665	P61755ASS18	30
4.88 m x 1.22 m (16' x 48")	#56667	P61755ASS18	34
4.88 m x 1.22 m (16' x 48")	#56726	P61755ASS18	34
5.49 m x 1.22 m (18' x 48")	#56976	P61755ASS18	38
4.27 m x 1.22 m (14' x 48")	#56443	P61755ASS18	30
4.27 m x 1.22 m (14' x 48")	#56994	P61755ASS18	30
4.88 m x 1.22 m (16' x 48")	#56453	P61755ASS18	34
4.88 m x 1.22 m (16' x 48")	#56965	P61755ASS18	34
5.49 m x 1.32 m (18' x 52")	#56884	P61755ASS18	38
6.10 m x 1.32 m (20' x 52")	#56881	P61755ASS18	42
6.71 m x 1.32 m (22' x 52")	#56887	P61755ASS18	46

G

Liner

SIZE	ITEM#	PART CODE	QTY
4.27 m x 1.07 m (14' x 42")	#56665	P00858	1
4.88 m x 1.22 m (16' x 48")	#56667	P04743	1
4.88 m x 1.22 m (16' x 48")	#56726	P04745	1
5.49 m x 1.22 m (18' x 48")	#56976	P04425	1
4.27 m x 1.22 m (14' x 48")	#56443	P04156	1
4.27 m x 1.22 m (14' x 48")	#56994	P04751	1
4.88 m x 1.22 m (16' x 48")	#56453	P04747	1
4.88 m x 1.22 m (16' x 48")	#56965	P04749	1
5.49 m x 1.32 m (18' x 52")	#56884	P04419	1
6.10 m x 1.32 m (20' x 52")	#56881	P04421	1
6.71 m x 1.32 m (22' x 52")	#56887	P04423	1

H

Hose Adaptor

SIZE	ITEM#	PART CODE	QTY
4.27 m x 1.07 m (14' x 42")	#56665	P6H1419ASS16	1
4.88 m x 1.22 m (16' x 48")	#56667	P6H1419ASS16	1
4.88 m x 1.22 m (16' x 48")	#56726	P6H1419ASS16	1
5.49 m x 1.22 m (18' x 48")	#56976	P6H1419ASS16	1
4.27 m x 1.22 m (14' x 48")	#56443	P6H1419ASS16	1
4.27 m x 1.22 m (14' x 48")	#56994	P6H1419ASS16	1
4.88 m x 1.22 m (16' x 48")	#56453	P6H1419ASS16	1
4.88 m x 1.22 m (16' x 48")	#56965	P6H1419ASS16	1
5.49 m x 1.32 m (18' x 52")	#56884	P6H1419ASS16	1
6.10 m x 1.32 m (20' x 52")	#56881	P6H1419ASS16	1
6.71 m x 1.32 m (22' x 52")	#56887	P6H1419ASS16	1

I

Stopper

SIZE	ITEM#	PART CODE	QTY
4.27 m x 1.07 m (14' x 42")	#56665	P6C1418ASS19	3
4.88 m x 1.22 m (16' x 48")	#56667	P6C1418ASS19	2
4.88 m x 1.22 m (16' x 48")	#56726	P6C1418ASS19	2
5.49 m x 1.22 m (18' x 48")	#56976	P6C1418ASS19	2
4.27 m x 1.22 m (14' x 48")	#56443	P6C1418ASS19	3
4.27 m x 1.22 m (14' x 48")	#56994	P6C1418ASS19	3
4.88 m x 1.22 m (16' x 48")	#56453	P6C1418ASS19	2
4.88 m x 1.22 m (16' x 48")	#56965	P6C1418ASS19	2
5.49 m x 1.32 m (18' x 52")	#56884	P6C1418ASS19	2
6.10 m x 1.32 m (20' x 52")	#56881	P6C1418ASS19	2
6.71 m x 1.32 m (22' x 52")	#56887	P6C1418ASS19	2

J

Drain Valve Cap

SIZE	ITEM#	PART CODE	QTY
4.27 m x 1.07 m (14' x 42")	#56665	P6H1158ASS16	1
4.88 m x 1.22 m (16' x 48")	#56667	P6H1158ASS16	1
4.88 m x 1.22 m (16' x 48")	#56726	P6H1158ASS16	1
5.49 m x 1.22 m (18' x 48")	#56976	P6H1158ASS16	1
4.27 m x 1.22 m (14' x 48")	#56443	P6H1158ASS16	1
4.27 m x 1.22 m (14' x 48")	#56994	P6H1158ASS16	1
4.88 m x 1.22 m (16' x 48")	#56453	P6H1158ASS16	1
4.88 m x 1.22 m (16' x 48")	#56965	P6H1158ASS16	1
5.49 m x 1.32 m (18' x 52")	#56884	P6H1158ASS16	1
6.10 m x 1.32 m (20' x 52")	#56881	P6H1158ASS16	1
6.71 m x 1.32 m (22' x 52")	#56887	P6H1158ASS16	1

K

Control Valve

SIZE	ITEM#	PART CODE	QTY
4.27 m x 1.07 m (14' x 42")	#56665	/	0
4.88 m x 1.22 m (16' x 48")	#56667	P6(H1)510ASS16	1
4.88 m x 1.22 m (16' x 48")	#56726	P6(H1)510ASS16	1
5.49 m x 1.22 m (18' x 48")	#56976	P6(H1)510ASS16	1
4.27 m x 1.22 m (14' x 48")	#56443	/	0
4.27 m x 1.22 m (14' x 48")	#56994	/	0
4.88 m x 1.22 m (16' x 48")	#56453	P6(H1)510ASS16	1
4.88 m x 1.22 m (16' x 48")	#56965	P6(H1)510ASS16	1
5.49 m x 1.32 m (18' x 52")	#56884	P6(H1)510ASS16	1
6.10 m x 1.32 m (20' x 52")	#56881	P6(H1)510ASS16	1
6.71 m x 1.32 m (22' x 52")	#56887	P6(H1)510ASS16	1

L

Pool Inlet Strainer

SIZE	ITEM#	PART CODE	QTY
4.27 m x 1.07 m (14' x 42")	#56665	/	0
4.88 m x 1.22 m (16' x 48")	#56667	P6H1317ASS16	1
4.88 m x 1.22 m (16' x 48")	#56726	P6H1317ASS16	1
5.49 m x 1.22 m (18' x 48")	#56976	P6H1317ASS16	1
4.27 m x 1.22 m (14' x 48")	#56443	/	0
4.27 m x 1.22 m (14' x 48")	#56994	/	0
4.88 m x 1.22 m (16' x 48")	#56453	P6H1317ASS16	1
4.88 m x 1.22 m (16' x 48")	#56965	P6H1317ASS16	1
5.49 m x 1.32 m (18' x 52")	#56884	P6H1317ASS16	1
6.10 m x 1.32 m (20' x 52")	#56881	P6H1317ASS16	1
6.71 m x 1.32 m (22' x 52")	#56887	P6H1317ASS16	1

CHOOSE THE CORRECT LOCATION

NOTE: The pool must be set up on a completely flat and level surface. Please do not install the pool if the surface is inclined or sloped.

Correct conditions to set up the pool:

- The selected location has to be capable of uniformly supporting the weight for the entire time the pool is installed, moreover the location must be flat and must be cleared of all objects and debris including stones and twigs.
 - We recommend positioning the pool away from any objects children could use to climb into the pool.
- NOTE:** Position the pool near an adequate drainage system to deal with overflow or to discharge the pool.

Incorrect conditions to set up the pool:

- On uneven ground the pool may collapse causing serious personal injury and/or damage to personal property and will void the warranty and prevent any service claims.
 - Sand should not be used to create a level base; the ground must be dug out if necessary.
 - Directly under overhead power lines or trees. Be sure the location does not contain underground utility pipes, lines or cables of any kind.
 - Do not set up the pool on driveways, decks, platforms, gravel or asphalt surfaces. The selected location should be firm enough to withstand the pressure of the water; Mud, sand, soft / loose soil or tar are not suitable.
 - Grass or other vegetation under the pool will die and may cause odors and slime to develop, therefore we recommend removing all grass from the selected pool location.
 - Avoid areas prone to aggressive plant and weed species that may grow through the ground cloth or liner.
- NOTE:** Check with your local city council for by-laws relating to fencing, barriers, lighting and safety requirements and ensure you comply with all laws.

NOTE: If have a filter pump, refer to the pump's manual for instructions.

NOTE: The ladder must match the pool size and should to be used only for entering and exiting the pool. It is forbidden to exceed the permitted payload of the ladder. Check regularly if the ladder is properly assembled.

Installation

Bestway Inflatables will not be responsible for damage caused to the pool due to mishandling or failure to follow these instructions.

1. Lay out all parts and check that you have the correct quantities as listed in the components list. If you are missing any part do not assemble the pool, contact Bestway Customers Service.
2. Spread out the pool and make sure the pool is right side up, let it sit exposed to direct sunlight for 1 hour or more so that the pool is more flexible during set up.
3. Place the pool near an adequate drainage system to deal with overflow water and ensure the pool's inlet A and outlet B are correctly positioned to allow your filter pump to connect to a power source.

Note: Do not use extension power cords to power your pump. **ATTENTION:** Do not drag the pool on the ground, this can damage the pool.

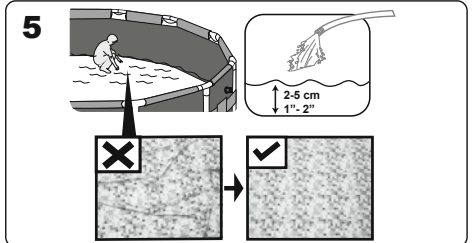
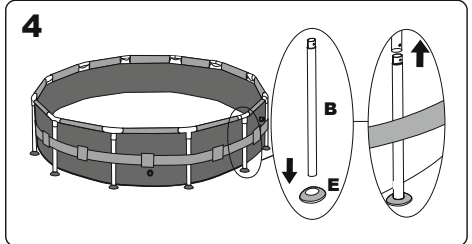
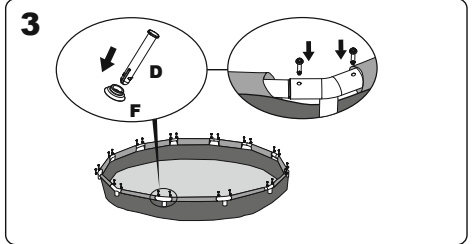
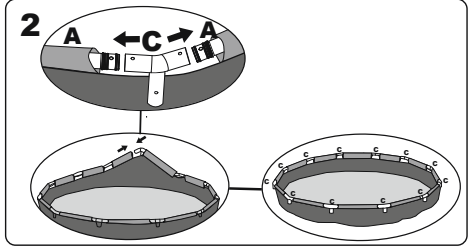
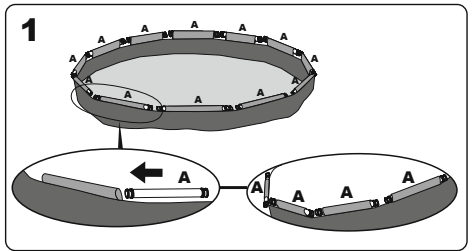

Connection Valve Assembly

For pool with connection valve.

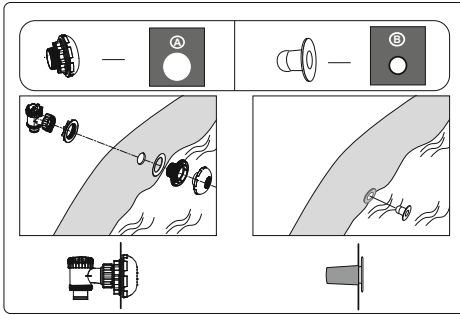

Filling Pool with Water

ATTENTION: Do not leave pool unattended while filling with water.

1. Fill pool until water capacity is 90%, DO NOT OVERFILL as this could cause the pool to collapse. In times of heavy rainfall you may need to empty some of the water to ensure the level is correct.

2. When filling the pool is completed, check that the water is not collecting on any side to ensure the pool is level.

IMPORTANT: If pool is not level, drain water and re-level ground by digging out. Never attempt to move the pool with water in it, serious personal injury or damage to the pool may result.

WARNING: Your pool may contain a great deal of pressure. If your pool has any bulge or uneven side then the pool is not level, the sides may burst and the water may discharge suddenly causing serious personal injury and/or damage to property.

3. Check pool for any leaks at valves or seams, check ground cloth for any evident water loss. Do not add chemicals until this has been done.

NOTE: In the event of a leak, patch your pool using the underwater adhesive repair patch provided. Refer to the FAQ's for further information.

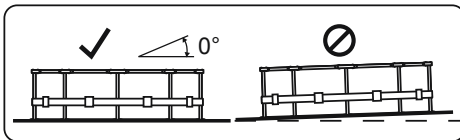
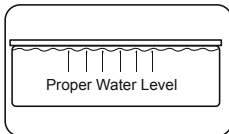
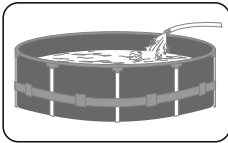

NOTE: Drawings for illustration purpose only. May not reflect actual product. Not to scale.

Pool Maintenance

If you do not adhere to the maintenance guidelines below, your health might be at risk, especially that of your children.

IMPORTANT: If you don't respect the ideal values of the water chemicals the PVC can be damaged and become discolored.

The following table lists the sequence of the tests that should be carried out for the ideal values and possible actions. Regularly check the pH value and chlorine concentration weekly and adjust to the ideal values.

TEST	IDEAL VALUES
pH value	7.4 – 7.6
Cyanuric acid	30 – 50 ppm
Free chlorine	2 – 4 ppm
Chlorine compound	0
Algae	None visible
Calcium hardness	200 – 400 ppm

To keep your pool clean:

- Contact your local pool supply shop for advice and purchase of chemicals and pH kits. One of the most important factors to increase the life of the liner is to keep continuously clean and healthy water. Please strictly follow the instructions from professional technicians for the water treatment through the use of chemicals.
- Locate a bucket of water next to pool to clean users' feet before entering pool.
- Cover the pool when not in use.
- Skim pool regularly to avoid settled dirt.
- Check and wash the filter cartridge regularly.
- Gently clean any scum from below the top ring with a clean cloth.
- Please be careful in case of rain water, kindly check that the water level is not higher than the expected. If so, YOU HAVE TO DISCHARGE THE EXCESS WATER.

Proper maintenance can maximize the life of your pool.

During the season of use of the swimming pool, the filtration system must be necessarily put into service every day, enough time to assure at least a complete renewal of the volume of water.

ATTENTION: Do not use pump when pool is in use.

During the season of use of the swimming pool, the filtration system must be necessarily put into service every day, enough for a long time to assure at least a complete renewal of the volume of water.

Repair

Check pool for any leaks from valves or seams, check the ground cloth for any evident water loss. Do not add chemicals until this has been done.

NOTE: In the event of a leak, patch your pool using the underwater adhesive repair patch provided. Refer to the FAQ's for further information.

Dismantling

- Unscrew the drain valve cap on the outside of the pool counter clockwise and remove.
- Connect the adaptor to the hose and put the other end of the hose in the area where you are going to drain your pool. (Check local regulations for drainage by-laws).
- Screw control ring of the hose adaptor clockwise onto the drain valve. The drain valve will be open and water will start to drain automatically.
- ATTENTION:** Water flow can be controlled with the control ring.
- When draining is finished, unscrew the control ring to close the valve.
- Disconnect the hose.
- Screw the cap back onto the drain valve.

7. Air dry pool.

ATTENTION: Do not leave the drained pool outside.

Storage and Winterization

1. Please remove all the accessories and spare parts of the pool and store them clean and dry.
2. Once pool is completely dry, sprinkle with talcum powder to prevent pool from sticking together, fold pool carefully. If pool is not completely dry, mold may result and will damage the pool liner.
3. Store liner and accessories in a dry place with a moderate temperature between 5°C / 41°F and 38°C / 100°F.
4. During the rainy season, pool and accessories should be stored as per above instructions also.
5. Improper draining of the pool might cause serious personal injury and/or damage to personal property.
6. We strongly recommend the pool is disassembled during the off season (winter months). Store in a dry location out of children's reach.



For support please visit us at:
bestwaycorp.com/support

©2020 Bestway Inflatables & Material Corp.

All rights reserved/Tous droits réservés/Todos los derechos reservados/Alle Rechte vorbehalten/Tutti i diritti riservati

®™ Trademarks used in some countries under license to/

Marques ®™ utilisées dans certains pays sous la licence de/

Marcas comerciales ®™ utilizadas en algunos países bajo la licencia de/

®™ Die Warenzeichen werden in einigen Ländern verwendet unter Lizenz der/

®™ Marchi utilizzati in alcuni paesi concessi in licenza a

Bestway Inflatables & Material Corp., No.3065 Cao An Road, Shanghai, 201812, China.

Manufactured, distributed and represented in the European Union by/

Fabriqué, distribués et représentés dans l'Union Européenne par/Fabricado, distribuido y representado en la Unión Europea por/

Hergestellt, vertrieben und in der Europäischen Union vertreten von/Prodotto, distribuito e rappresentato nell'Unione Europea da

Bestway (Europe) S.r.l., Via Resistenza, 5, 20098 San Giuliano Milanese (Milano), Italy

Distributed in North America by/Distribués en Amérique du Nord par/Distribuido en Norteamérica por

Bestway (USA) Inc., 3411 E. Harbour Drive, Phoenix, Arizona 85034, United States of America

Tel: +86 21 69135588 (For U.S. and Canada)

Distributed in Latin America by/Distribués en Amérique latine par/Distribuido en Latinoamérica por/Distribuido en América Latina por

Bestway Central & South America Ltda, Salar Ascotan 1282, Parque Enea, Pudahuel, Santiago, Chile

Distributed in Australia & New Zealand by **Bestway Australia Pty Ltd, Unit 2/98-104 Carnarvon St Silverwater, NSW 2128, Australia**

Tel: Australia: (+61) 29 0371 388; New Zealand: 0800 142 101

Exported by/Exporté par/Exportado por/Exportiert von/Esportato da

Bestway (Hong Kong) International Ltd./Bestway Enterprise Company Limited

Suite 713, 7/Floor, East Wing, Tsim Sha Tsui Centre, 66 Mody Road, Kowloon, Hong Kong

www.bestwaycorp.com

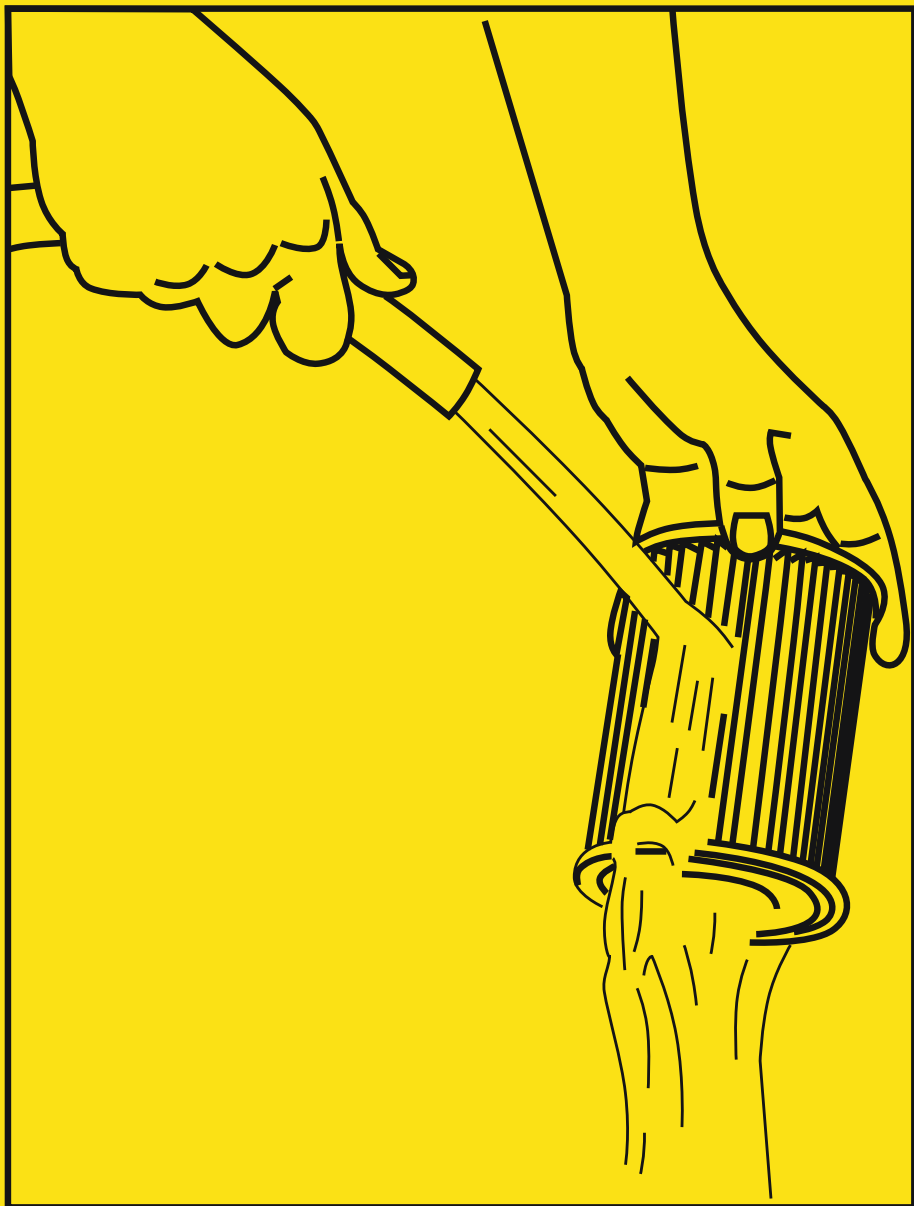

To ensure pool water stays clean, please clean the filter cartridge every day and change when required.

Pour faire en sorte que l'eau de la piscine reste propre, nettoyez la cartouche du filtre tous les jours et changez-la quand c'est nécessaire.

Damit das Wasser rein bleibt, reinigen Sie die Filterkartusche bitte täglich und wechseln Sie diese gegebenenfalls aus.

Affinché l'acqua della piscina rimanga pulita, pulire ogni giorno la cartuccia del filtro e all'occorrenza sostituirla.

Om te garanderen dat het water van het zwembad altijd schoon blijft, reinigt u het filterelement dagelijks en vervangt u het indien nodig.

Para asegurar la limpieza del agua de la piscina, por favor limpie el cartucho del filtro cada día y cambie cuando sea necesario.

Sørg for, at bassin vandet holder sig rent, ved at rense filterpatronen hver dag og skifte den, når det er nødvendigt.

Para garantir que a água da piscina fique limpa, será preciso que limpe o cartucho do filtro a cada dia e o mude quando for necessário.

ΓΙΑ ΝΑ ΔΙΑΣΦΑΛΙΣΤΕΙ ΟΤΙ ΤΟ ΝΕΡΟ ΠΑΡΑΜΕΝΕΙ ΚΑΘΑΡΟ, ΠΑΡΑΚΑΛΟΥΜΕ ΝΑ ΚΑΘΑΡΙΖΕΤΕ ΤΟ ΦΥΣΙΓΓΙΟ ΦΙΛΤΡΟΥ ΚΑΘΗΜΕΡΙΝΑ ΚΑΙ ΝΑ ΤΟ ΑΝΤΙΚΑΘΙΣΤΑΤΕ ΟΤΑΝ ΑΠΑΙΤΕΙΤΑΙ.

Чтобы обеспечить чистоту воды в бассейне, чистите вкладыш фильтра каждый день и, при необходимости, меняйте его.

Abyste udrželi vodu v bazénu čistou, čistíte vložku filtru každý den a dle potřeby ji vyměňte.

For å sikre at vannet i bassenget holder seg rent, må filterenheten rengjøres hver eneste dag og skiftes ut ved behov.

Rengör filterpatronen varje dag och byt ut vid behov för att garantera att poolen alltid är ren.

Jotta altaan vesi pysyy puhtaana, puhdista suodatinkasetti joka päivä ja vaihda se tarpeen mukaan.

Na zaručenie čistoty vody v bazéne každý deň čistíte filtračnú vložku a v určených intervaloch ju vymieňajte.

Aby zapewnić czystość wody w basenie, wkładkę filtra należy czyścić codziennie, i wymienić ją w razie potrzeby.

A medencében lévő víz tisztaságának a biztonság érdekében és szűrőbetétet naponta kell tisztítani, szükség esetén pedig azt ki kell cserélni.

Lai nodrošinātu, ka baseina ūdens ir tīrs, lūdzu, tīriet filtra kasetni katru dienu un nomainiet, kad nepieciešams.

Norėdami užtikrinti baseino vandens švarą, filtro kasetę valykite kiekvieną dieną ir keiskite ją, kai reikia.

Da bi zagotovili, da voda v bazenu ostane čista, očistite filtrsko kartušo vsak dan in jo po potrebi zamenjajte.

Havuz suyunun temiz kalmasını sağlamak için filter kartuşunu her gün temizleyin ve gerektiğinde değiştirin.

Pentru a vă asigura că apa din piscină rămâne curată, vă rugăm să curățați cartușul filtrului în fiecare zi și îl schimbați când este cazul.

За да гарантирате, че водата на басейна ще се запази чиста, моля почиствайте пълнителя на филтъра всеки ден и го заменяйте, когато е необходимо.

Kako biste održali vodu u bazenu čistom, svaki dan očistite uložak filtera i zamijenite ga kada je to potrebno.

Selleks, et tagada vee puhtus, puhastage filterpadrunit iga päev ja vahetage vajaduse korral.

Da osigurate da voda u bazenu ostane čista, molimo čistite filter uloške svaki dan i promenite ih kad je to potrebno.

لضمان بقاء مياه حمام السباحة نظيفة، يرجى تنظيف خرطوشة المرشح كل يوم وتغييرها كلما تطلب الأمر ذلك.