

44.1DGF02.342.B

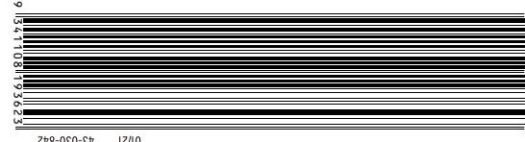

WARNING: CHOKING HAZARD
SMALL PARTS. NOT FOR CHILDREN UNDER 3 YEARS.

Rolife
Designed by ROBOTIME
www.robotime.com
MADE IN CHINA

Manufacturer: Robotime C&C (Jiangsu) Co., Ltd.
Address: No. 18 Changxing Road, Shuyang,
Su qian City, Jiangsu Province, China.



Scan the QR code to become a member of us
and discover more iFree collection here.



Rolife Official Website

Scan the QR code to join our VIP Fans Group for more news.
Share your ideas with us and have more fun here.



Rolife VIP Fans Group



**FREELY EXPAND YOUR
HOUSE AS YOUR WISH.**
More than meet your eyes.

Recommended age: 14+
Main material: Wood, Fabric, Paper
Maintenance: Keep the product away from sources of ignition and water in
case of damage.



iFree

**PARIS
MIDNIGHT
DGF02**

Rolife

DIY (DGF02) HOUSE PARIS MIDNIGHT



WARNING:
CHOKING HAZARD-SMALL PARTS.
NOT FOR CHILDREN UNDER 3 YEARS.

**DIY
14+**

300 X 150 X 165mm

iFree

**PARIS
MIDNIGHT
DGF02**

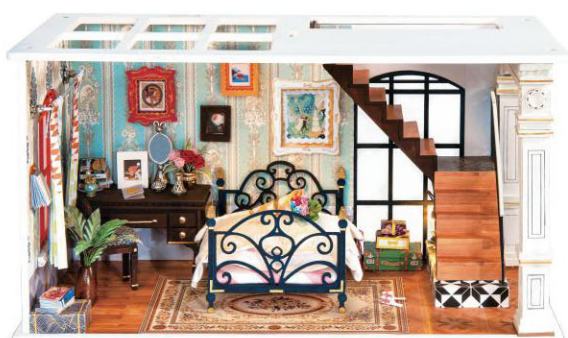

221, 5

65, 5

221, 5

65, 5

Rolife

iFree

DGF02-Paris Midnight



DIY



Brief Introduction

Tips of glue (The picture is only for reference.)

1. Liquid glue is used to glue large wood parts and other materials.
2. Do not use too much glue in case it's hard to dry. It may also affect the appearance of the completed products.



Liquid Glue

Tips of assembling

1. Small parts are included, children must assemble under the guidance of adults in case of eating by mistake.
2. Put the remains back to original bags after taking enough dosage in each step till completed. (In case of missing materials.)
3. All the dimension in the instruction is shown in millimeter. According to the [Part number explanation] at the end of this page, find the real part based on the part illustration paper and check the size carefully. Start to assemble after verification. (Only for wooden parts.)
4. Note which bags the parts kept in based on the material list when assembling and taking them out to use.

Tips of light bead

1. Take the picture on the right: Note the anode and cathode of the light bead. Connect the yellow wire to the anode and the white wire to the cathode.
2. The red wire in the cell box is anode and the black wire is cathode.
3. Test if the light works again after assembling the lampshade and the cell box.



Tools included

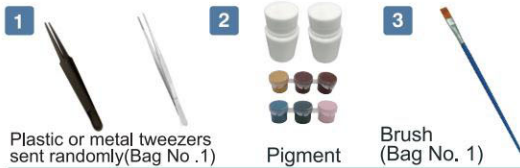

Plastic or metal tweezers sent randomly (Bag No. 1)

Pigment

Brush (Bag No. 1)

Tools excluded



Ruler

Scissors

Utility knife

Needle-nose pliers

Screwdriver

Make a proper use of part number graph



1. Find the part illustration paper which is placed separately in the box.
2. Compare the part with the illustration paper to help to find the part number.

Make a proper remove of the wood part



- Remove the wood part with the utility knife.
(Cutting the both sides of the wood piece will make it easier to get the part.)

! Part number explanation

- A1 is in Bag No. GH001, the number of the part is A1. (Only note the part number in the steps.)
Some spare parts are included, subject to parts needed in practical steps.

Paint the part

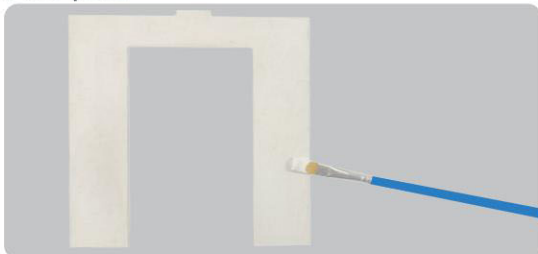

Paint B23, B24, D10, D12, E1, E2, E3, E4 white in advance and dry for preparation. (Paint again after dry for better effect.)

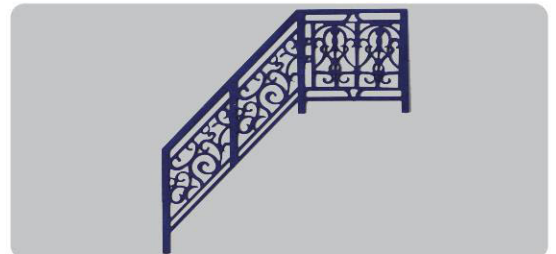

Paint A2 dark blue in advance.

Decoration A



Material List (Take parts from Bag No. DGF02)

- ① Champagne golden wire L9mm(as shown) 1 pc (Bag No. 2)
- ② Golden flower-shaped receptacle (as shown) 1 pc (Bag No. 2)
- ③ Golden round receptacle (as shown) 1 pc (Bag No. 2)
- ④ Crystal bead (as shown) 1 pc (Bag No. 2)
- ⑤ White bead (as shown) 1 pc (Bag No. 2)
- ⑥ Blue bead (as shown) 1 pc (Bag No. 2)
- ⑦ Small golden bead (as shown) 1 pc (Bag No. 2)

1

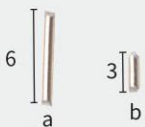

Cut as shown.

2



Crystal bead

Glue as shown.

3

Golden flower-shaped receptacle

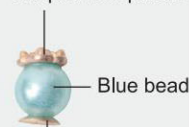

Blue bead

Golden round receptacle

Glue as shown.

4



Glue as shown.

5



Glue as shown, completed.

Decoration B



Material List (Take parts from Bag No. DGF02)

- ① Gloss paper (as shown) 1 pc (Bag No. 1)
- ② Silver thin wire L100mm (as shown) 1 pc (Bag No. 1)
- ③ Silver bead (as shown) 2pcs (Bag No. 2)
- ④ Silver teardrop bead (as shown) 1 pc (Bag No. 2)

1

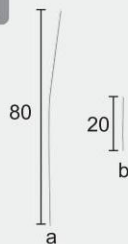

Cut as shown.

2

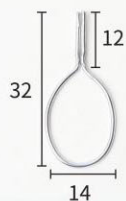

Bend a as shown.

3



Insert the silver bead and bend as shown.

4



Cut as shown.

5

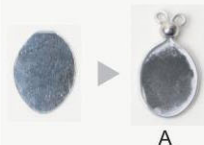

Glue as shown.(Tear off the film on the gloss paper.)

6



Bend b as shown and insert the silver bead.

7



Glue B onto the back side of A.

8



Silver teardrop bead
Glue as shown, completed.

Decoration C



Material List (Take parts from Bag No. DGF02)

- ① Silver eyelet (as shown) 1 pc (Bag No. 2)
- ② Silver receptacle (as shown) 1 pc (Bag No. 2)
- ③ Silver round receptacle(as shown) 1 pc (Bag No. 2)

1

Silver receptacle



Silver round receptacle

Glue as shown.

2

Silver eyelet



Glue as shown, completed.

Decoration D



Material List (Take parts from Bag No. DGF02)

- ① Small golden bead (as shown) 1 pc (Bag No. 2)
- ② Silver round receptacle (as shown) 2 pcs (Bag No. 2)

1

Silver round receptacle



Silver round receptacle

Glue as shown.

2

Small golden bead



Glue as shown, completed.

Curtain

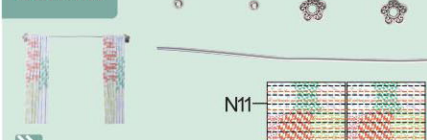

Material List (Take parts from Bag No. DGF02)

- ① Silver bead (as shown) 2 pcs (Bag No. 2)
- ② Silver flower-shaped receptacle (as shown) 2 pcs (Bag No. 2)
- ③ Silver thick wire (as shown) 1 pc (Bag No. 1)
- ④ Paper-cut N11

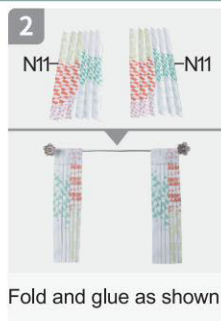
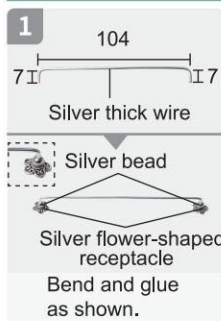

Book

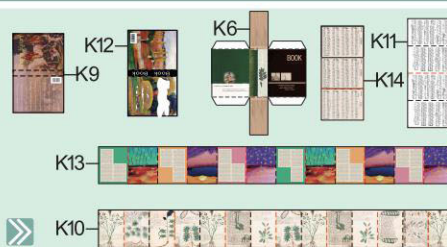

Material List

- ① Paper-cut K6, K9-K14 (as shown)

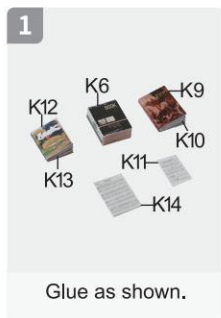

Plant A



Material List (Take parts from Bag No. DGF02)

- | | |
|-------------------------------|------------------|
| ① Light pink paper (as shown) | 1 pc (Bag No. 1) |
| ② Red paper (as shown) | 1 pc (Bag No. 1) |
| ③ Brown clay (as shown) | some (Bag No. 1) |
| ④ Stem L110mm (as shown) | 1 pc (Bag No. 2) |
| ⑤ Golden flowerpot (as shown) | 1 pc (Bag No. 2) |
| ⑥ Paper-cut N7 (as shown) | |

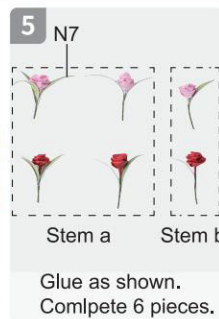
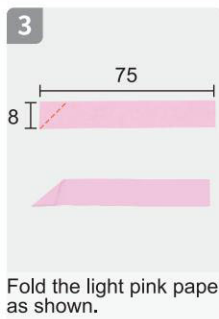
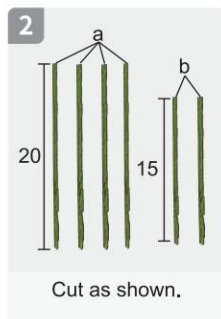
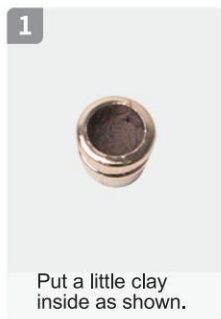
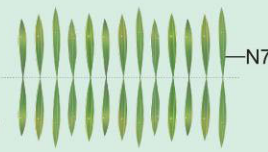

Plant B

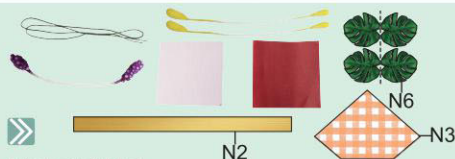

- | | |
|-----------------------------------|-------------------|
| ① Stem L90mm (as shown) | 1 pc (Bag No. 2) |
| ② Yellow stamen (as shown) | 2 pcs (Bag No. 1) |
| ③ Purple stamen (as shown) | 1 pc (Bag No. 1) |
| ④ Light pink paper (as shown) | 1 pc (Bag No. 1) |
| ⑤ Red paper (as shown) | 1 pc (Bag No. 1) |
| ⑥ Paper-cut N2, N3, N6 (as shown) | |

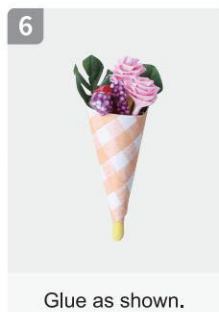

Plant C



- | | |
|---------------------------|------------------|
| ① Drop pot (as shown) | 1 pc (Bag No.1) |
| ② Stem L430mm (as shown) | 2 pcs (Bag No.2) |
| ③ Paper-cut N9 (as shown) | |

1

Cut.

2

Fold to cut the leaves (*12).
Fold the single leaf as shown.
(Make the red side outwards).

3

Make the kink mark.

4

Glue.

5

Completed as shown.

6

Drop pot
Glue as shown.

G014/Babylon Carving Bed

Material List (Take parts from Bag No. G014)

- ① Wood pieces A1-A4, B1, B2 (as shown)
- ② Silk cotton (as shown)
- ③ White fabric (as shown)
- ④ Sponge pieces (as shown)
- ⑤ White jacquard weave (as shown)
- ⑥ Red-strip fabric (as shown)
- ⑦ Pigment (as shown)
- ⑧ Golden cardstock (as shown)

some (Bag No. 2)

- 1 pc
- 2pcs
- 2pcs
- 2pcs
- 1 pc
- 1 pc (Bag No. DGF02-1)

1

Remove the wood pieces with the utility knife.

2

Paint dark blue as shown.

3

Glue as shown.

4

Paint golden as shown.

5

Cut the golden cardstock as shown.

6

Glue as shown.

7

Cut as shown.

8

Wrap the sponge pieces and glue as shown.

9

Mattress

The front side as shown.

10

Cut the fabric as shown.

11

Fold the four sides as shown.

12

Fold as shown and glue.

13

Insert some silk cotton as shown.

14

Seal and glue as shown.

15

Cut the fabric as shown, Fold in half and glue.

16

Pillow
Glue along the four sides as shown, completed.

17

Cut the white jacquard weave as shown.

18

Fold the four sides as shown.

19

Glue as shown.

20

Fold the four corners as shown and glue.

21

Insert some silk cotton as shown.



Seal and glue as shown.



Fold and glue as shown.

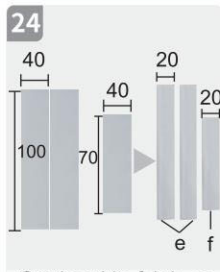

Cut the white fabric as shown. Fold in half and glue.



Fold and glue as shown.

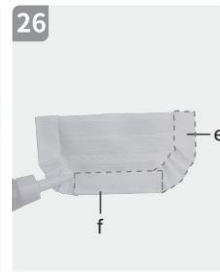

Glue as shown.



The front side as shown.

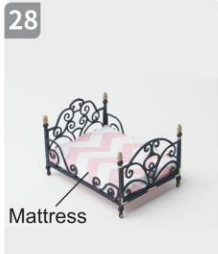

Set out as shown and glue as shown.

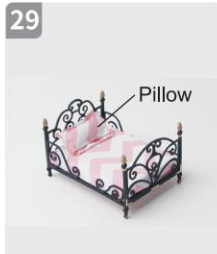

Glue as shown.

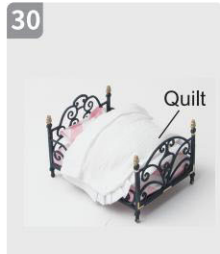

Completed as shown.

G066/Champs Elysees Wooden Chair

Material List (Take parts from Bag No. G066)

- 1 Wood pieces A1-A7 (as shown)
- 2 Square cushion (as shown) 1 pc
- 3 Golden cardstock (as shown) 1 pc (Bag No. DGF02-1)
- 4 Pigment (as shown) 1 pc

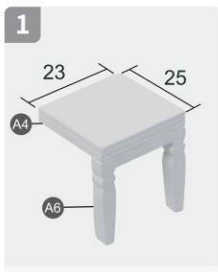

Glue as shown.



Glue as shown.



Glue as shown.

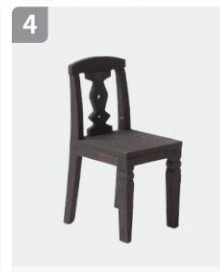

Paint brown as shown.

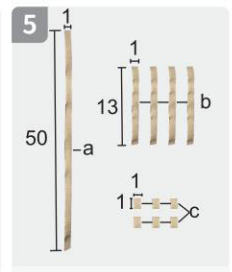

Cut as shown.



Glue as shown.



Glue as shown and completed.

G097/Elizabeth Secretaire

Material List (Take parts from Bag No. G097)

- 1 Wood pieces A1-A12 (as shown)
- 2 Champagne golden wire (as shown) 1 pc
- 3 Golden round receptacle (as shown) 4 pcs
- 4 Small golden bead (as shown) 4 pcs
- 5 Golden cardstock (as shown) 1 pc (Bag No. DGF02-1)
- 6 Pigment (as shown) 1 pc

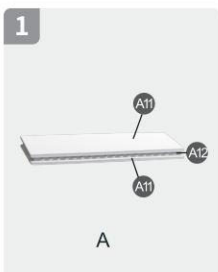

Glue as shown.

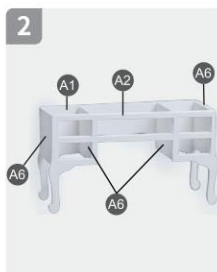

Glue as shown.



Glue as shown.

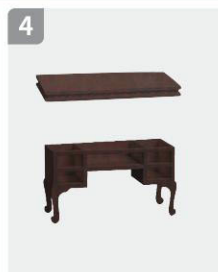

Paint brown as shown. Then paint the remaining hood pieces brown as well.

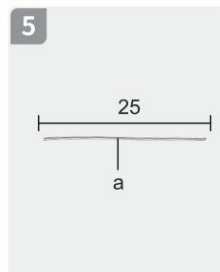

Cut the wire as shown.

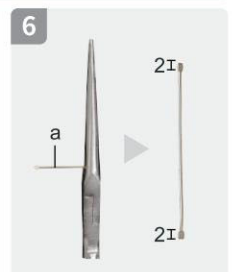

Press the two ends flat.

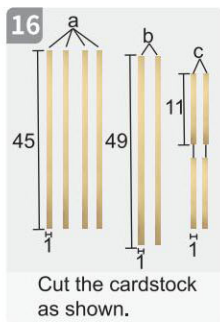
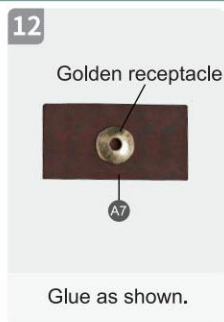
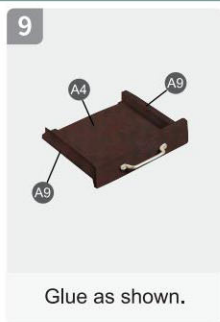

GZ002/Painting Frame

Material List (Take parts from Bag No. GZ002)

- ① Wood pieces A1-A11 (as shown)
- ② Pigment (as shown)
- ③ Paper-cut K1-K5 (as shown)

1 pc
GZ002 paper-cut

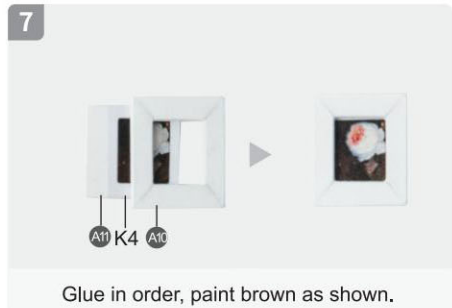
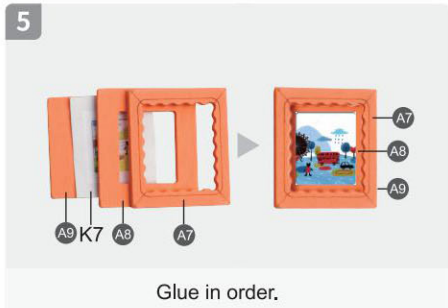
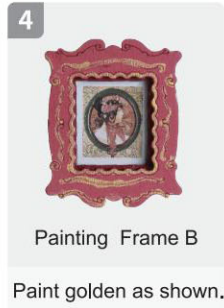
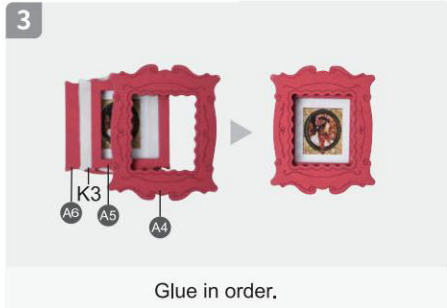
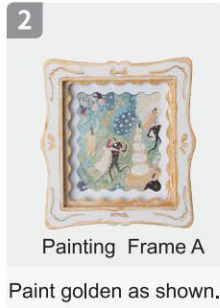
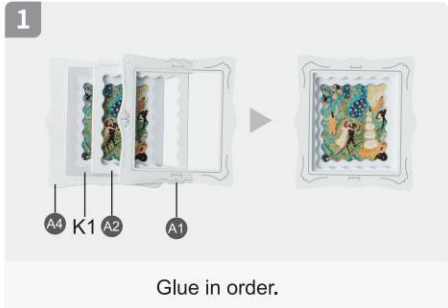

8



Painting Frame D

9



Painting Frame E

Glue in order.

10



Completcd.

Carton 1

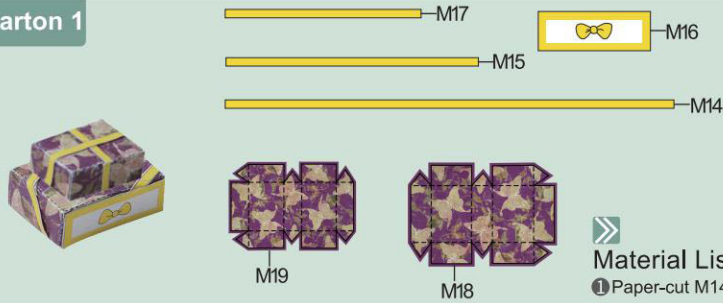

Material List

① Paper-cut M14-M19 (as shown)

1



Glue as shown.

2



Glue as shown.

3

Glue as shown,
completed.

Carton 2

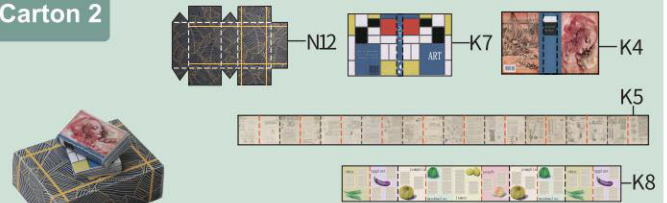

Material List

① Paper-cut K4,K5,K7,K8,N12(as shown)

1

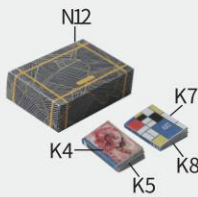

Glue as shown.

2

Glue as shown,
completed.

Suitcase

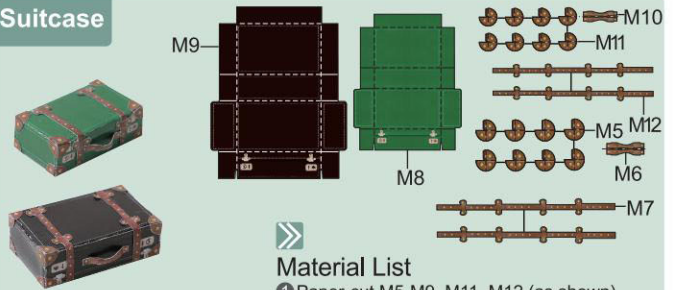

Material List

① Paper-cut M5-M9, M11, M12 (as shown)

1

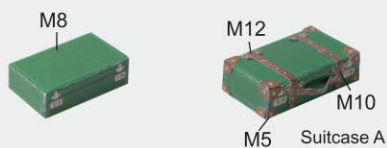

Glue as shown, completed.

2



Glue as shown.

3

Glue as shown,
completed.

Paper bag



Material List

① Paper-cut N8 (as shown)

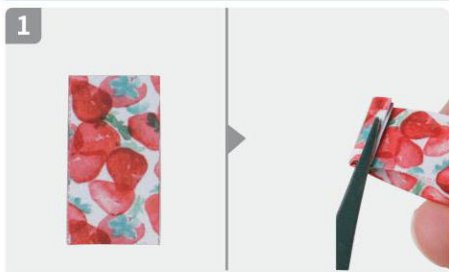

Glue as shown.

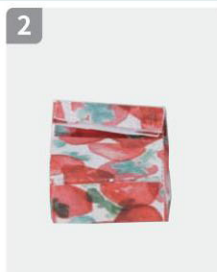

Glue as shown, completed.

Notebook

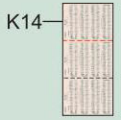
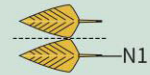

Material List

1 Paper-cut N1, K14 (as shown)

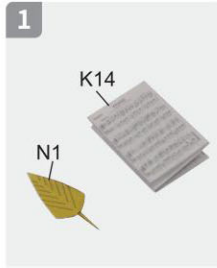

Fold and glue.



Glue as shown, completed.

Slipper

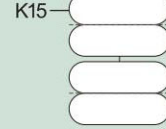
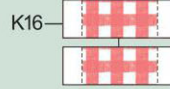

Material List

1 Paper-cut K15, K16 (as shown)

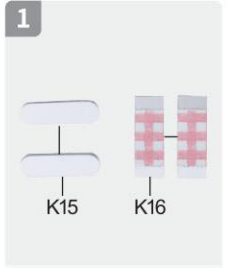

Glue as shown.



Glue as shown, completed.

Calendar

Material List (Take parts from Bag No. DGF02)

- 1 Small golden bead (as shown) 1 pc (Bag No. 2)
- 2 Aluminum tape (as shown) 1 pc (Bag No. 1)
- 3 Paper-cut N4, N5 (as shown)

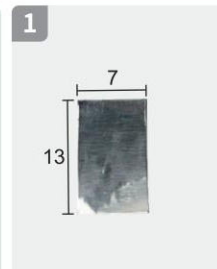

Cut as shown.



Glue as shown, completed.

Handrail

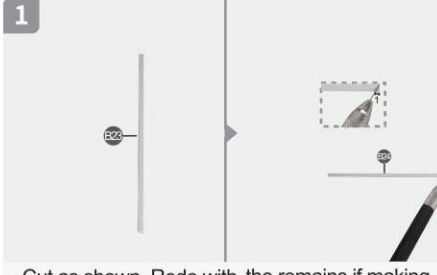
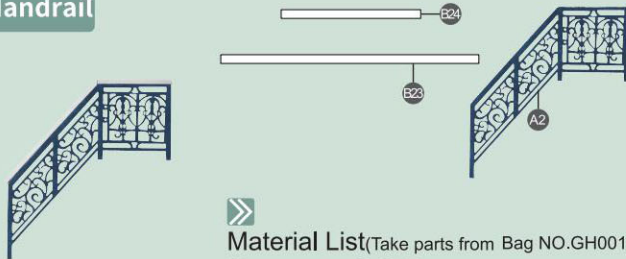

Stairs

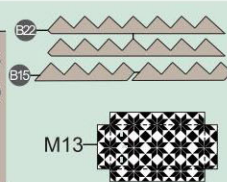
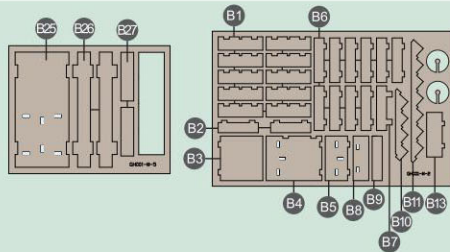

Material List

(Take parts from Bag No. GH001)

- 1 Wood pieces B1-B11, B13, B15, E22, E25-E27 (as shown) 1pc
- 2 Pigment (as shown)
- 3 Paper-cut K2, K3, M3, M13 (as shown)

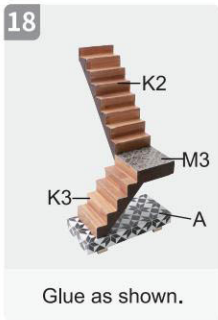
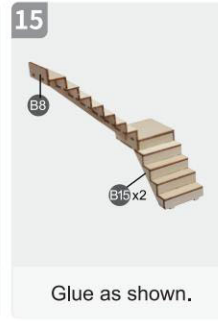
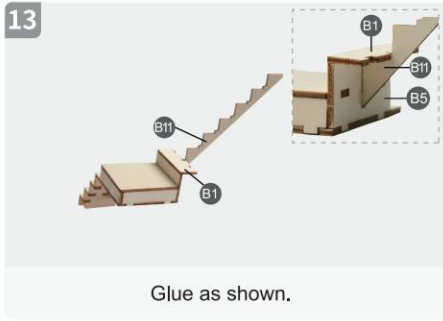
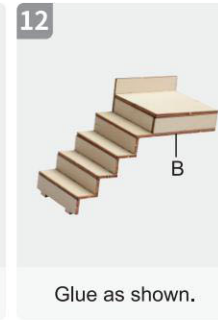
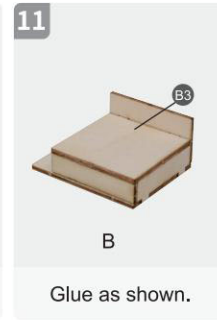
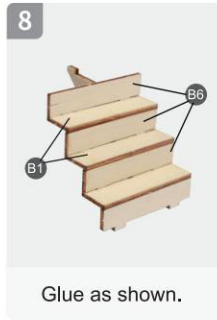
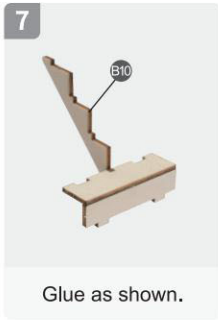

Pillar

Material List (Take parts from Bag No. GH001)

- ① Wood pieces A1, B16-B21, B22, D1-D3, D7-D8 (as shown)
- ② Pigment (as shown) 1 pc
- ③ Golden Cardstock (as shown) 1 pc (Bag No. DGF02-1)

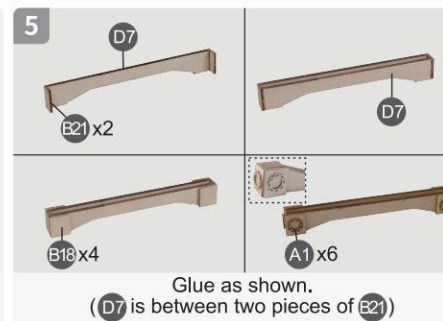
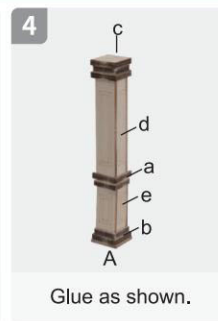
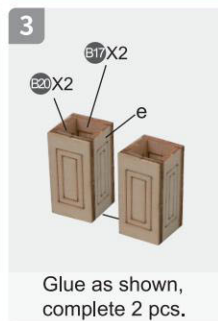
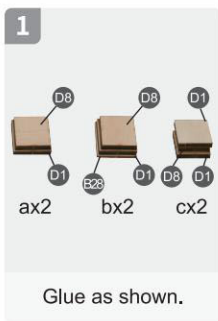

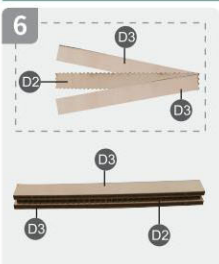

Glue as shown.



Glue as shown.

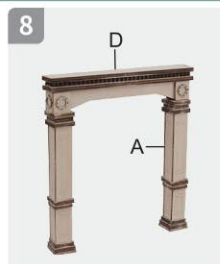

Glue as shown.

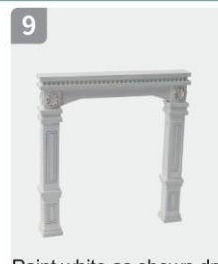

Paint white as shown, dry for preparation. (Painting again after dry will be better.)

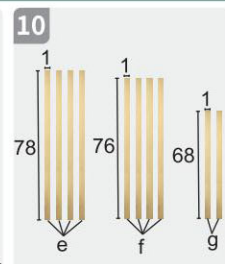

Cut as shown.



Glue and complete as shown.

Wall 1

Material List (Take parts from Bag No. GH001)

- 1 Wood pieces C1, C2, E2, D5, D12, B14 (as shown)
- 2 Pigment in three colors (as shown)
- 3 Transparent sheet (as shown) 1 pc
- 4 Paper-cut M1 (as shown)



Cut as shown.

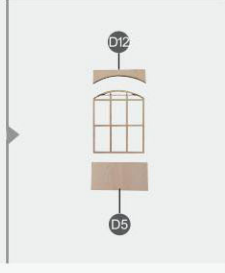

Paint, Cut and glue the transparent sheet after dry.

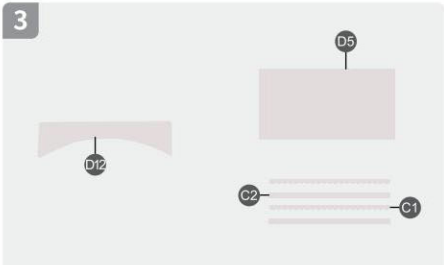

Paint white as shown, dry for preparation. (Painting again after dry will be better)

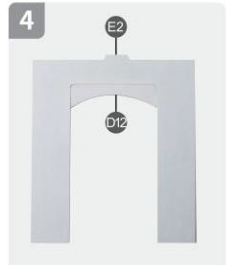

Glue as shown.



Glue as shown.



Glue as shown.



Glue as shown.

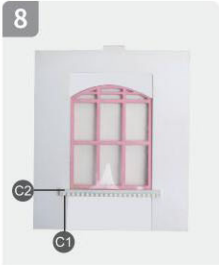

Glue onto the back sides as shown.



Glue as shown, completed.

Wall 2

Material List (Take parts from Bag No. GH001)

- 1 Wood pieces E1, D10, D12, B14 (as shown)
- 2 Pigment in three colors (as shown)
- 3 Transparent sheet (as shown) 1 pc
- 4 Paper-cut M2 (as shown) 1 pc

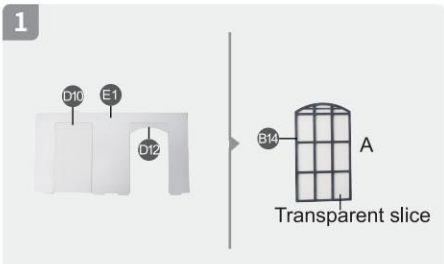

Paint dark blue. Cut and glue the transparent sheet after dry.



Glue as shown.



Glue as shown.

Floor

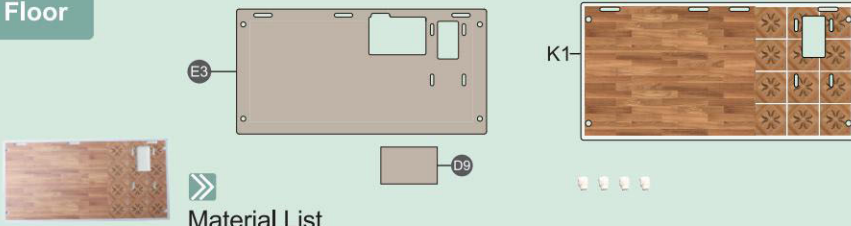

Material List

- ① Wood pieces (E3, D9) (as shown) 2 pcs
- ② White round wood bead (as shown) 4 pcs
- ③ Paper-cut K1 (as shown)

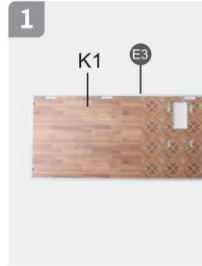

Glue as shown.



White round wood bead *4.

Glue and completed as shown.

Small Components

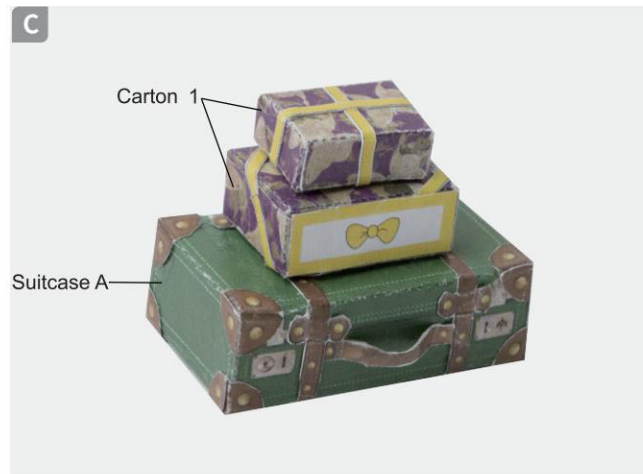

Sequence of Assembly

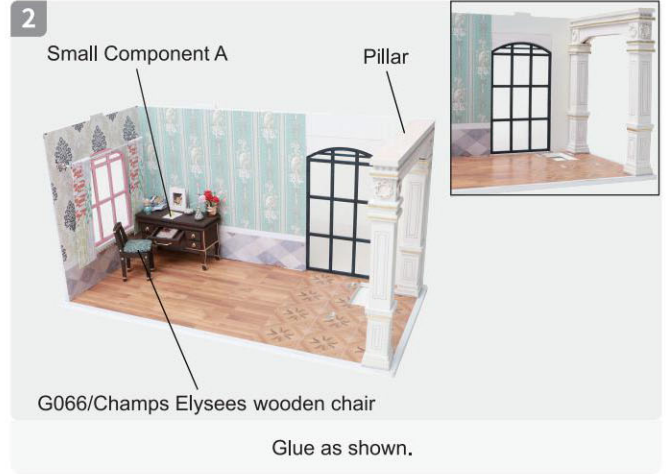
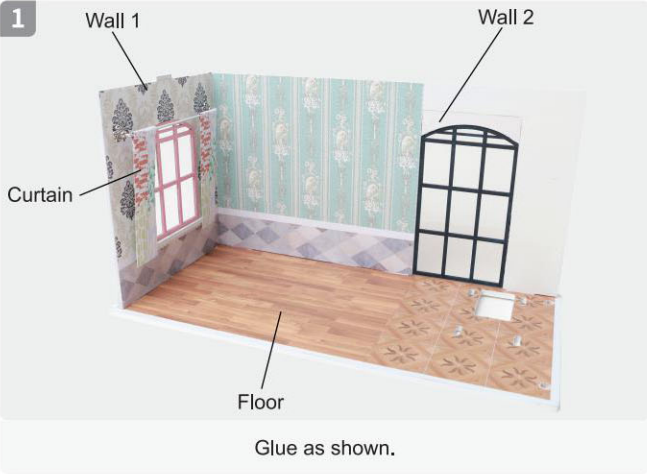

4

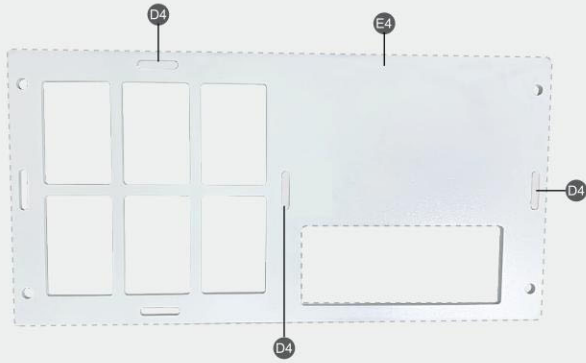

Insert D4 into E4 as shown.

5

Painting frame C
 Painting frame D
 Painting frame B
 Painting frame A
 Stairs



Glue as shown.

6

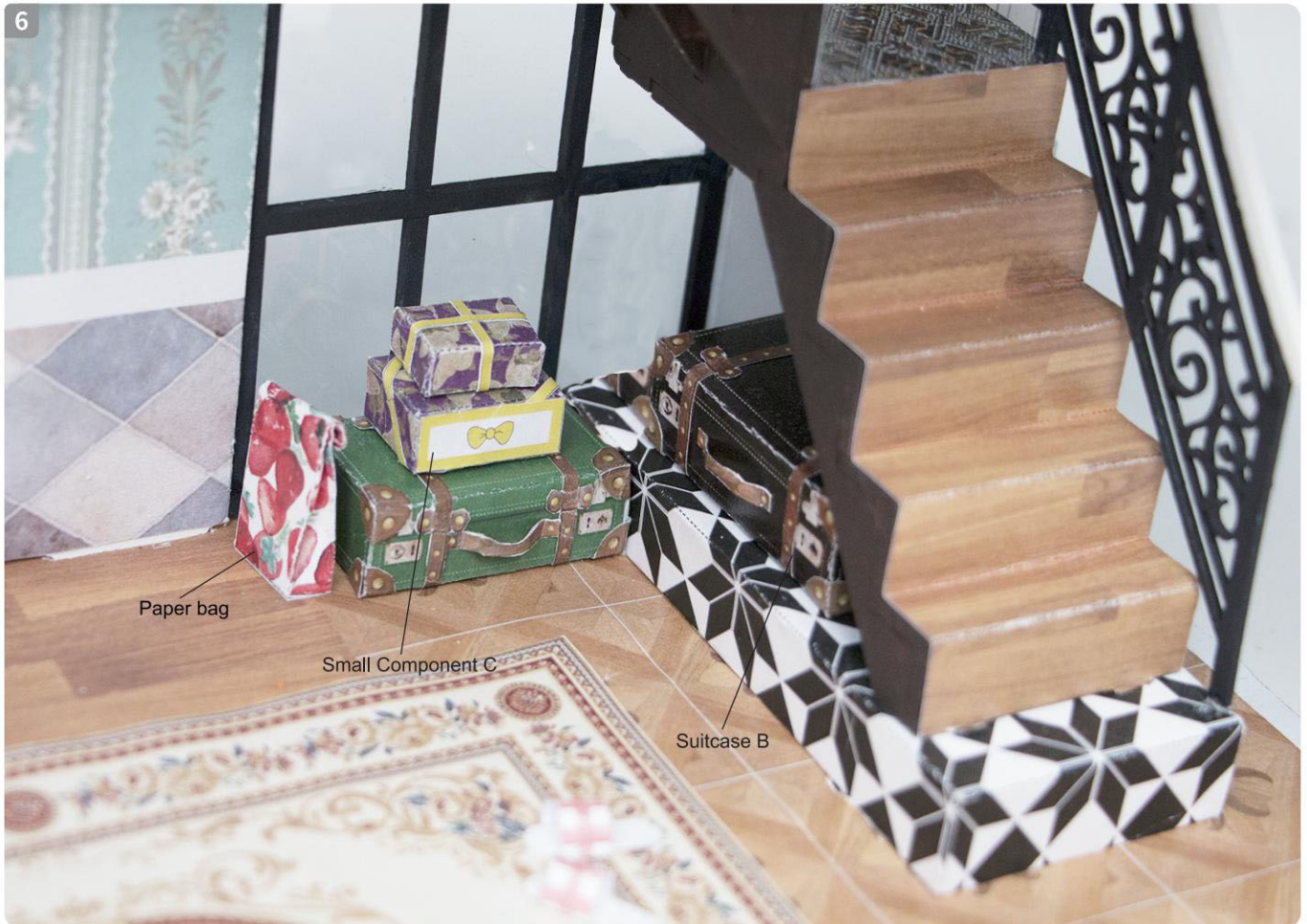

Paper bag

Small Component C

Suitcase B

Put as shown.

7

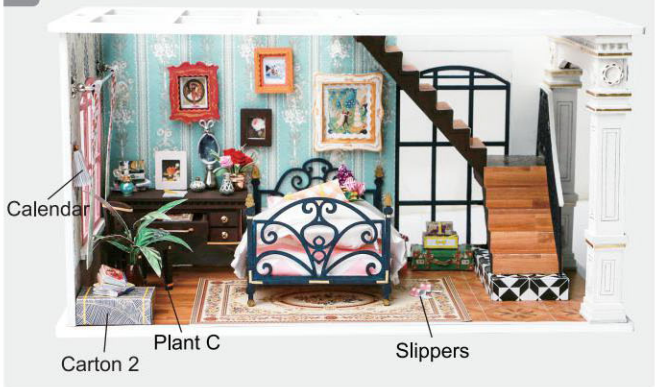

Put as shown.

8



Completed.



As shown, expand your house with other products of the same series freely.



Rolife Official Facebook Page

Trends, Events, Interactivity, Group.

[Discover more iFree collection](#)

Have more fun here.



Rolife Official Website

News, Discover, Fun, Store.

[Discover more iFree collection](#)

Find more products here.