

44.1DGF01.342.B



SMALL PARTS. NOT FOR CHILDREN UNDER 3 YEARS.
WARNING: CHOKING HAZARD



FREELY EXPAND YOUR HOUSE AS YOUR WISH.
More than meet your eyes.

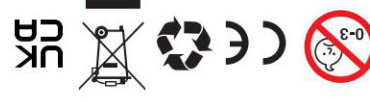

Designed by Rolife
www.rolife.com
MADE IN CHINA
FOR AU / NZ IMPORTED FOR KAMART STORES IN AUSTRALIA AND NEW ZEALAND.

Manufacturer: Robotime C&C (Jiangsu) Co., Ltd.
Address: No. 18 Changxing Road, Shuyang, Suqian City, Jiangsu Province, China.



Scan the QR code to become a member of us and discover more iFree collection here.

Rolife Official Website



Scan the QR code to join our 'VIP' Fans Group for more news. Share your ideas with us and have more fun here.

Rolife VIP Fans Group

Maintenance: Keep the product away from sources of ignition and water in case of damage.

Recommended age: 14+
Main material: Wood, Fabric, Paper

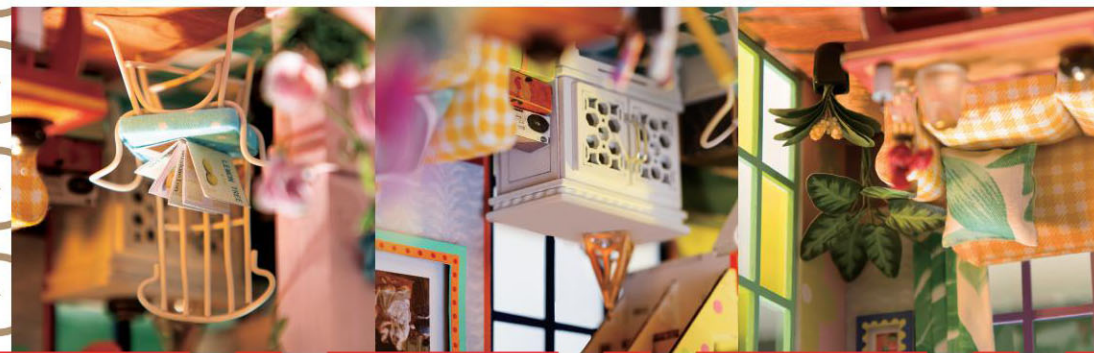

iFree

SWEET PATIO
DGF01

Rolife

DIY (DGF01) HOUSE SWEET PATIO



WARNING:
CHOKING HAZARD-SMALL PARTS.
NOT FOR CHILDREN UNDER 3 YEARS.

DIY
14+

300 X 195 X 165mm

iFree
SWEET PATIO
DGF01



221,5

65,5

221,5

65,5

Rolife

iFree

DGF01-Sweet Patio



The picture is for reference only

Brief Introduction

Tips of glue (The picture is only for reference.)

1. Liquid glue is used to glue large wood parts and other materials.
2. Do not use too much glue in case it's hard to dry. It may also affect the appearance of the completed products.



Liquid Glue

Tips of assembling

1. Small parts are included, children must assemble under the guidance of adults in case of eating by mistake.
2. Put the remains back to original bags after taking enough dosage in each step till completed. (In case of missing materials.)
3. All the dimension in the instruction is shown in millimeter. According to the [Part number explanation] at the end of this page, find the real part based on the part illustration paper and check the size carefully. Start to assemble after verification. (Only for wooden parts.)
4. Note which bags the parts kept in based on the material list when assembling and taking them out to use.

Tips of light bead

1. Take the picture on the right: Note the anode and cathode of the light bead. Connect the yellow wire to the anode and the white wire to the cathode.
2. The red wire in the cell box is anode and the black wire is cathode.
3. Test if the light works again after assembling the lampshade and the cell box.



Tools included



Tools excluded



Explanation of green crumpled paper (Units: mm)

Green crumpled paper:

1. Please cut the green paper strictly based on the suggestive size.

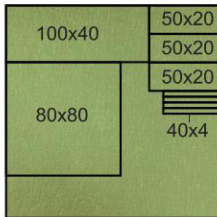

Make a proper use of part number graph



1. Find the part illustration paper which is placed separately in the box.
2. Compare the part with the illustration paper to help to find the part number.

Make a proper remove of the wood part

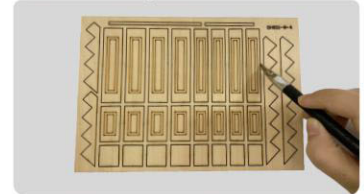

Remove the wood part with the utility knife. (Cutting the both sides of the wood piece will make it easier to get the part.)

Paint the part



Paint **E23**, **E24**, **D4**, **E4**, the side of **E3**, the back and side of **E1**, **E2** white in advance and dry for preparation (Painting again after dry will be better).

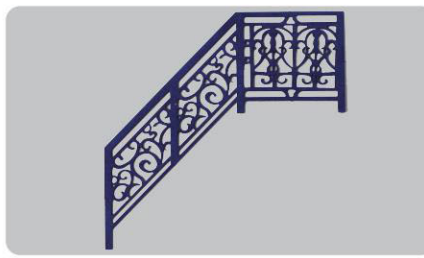

Paint **A2** dark blue in advance.

! Part number explanation

A1 is in Bag No. GH001, the number of the part is **A1**. (Only note the part number in the steps.) Some spare parts are included, subject to parts needed in practical steps.

G110/Pineapple Two-seater Sofa

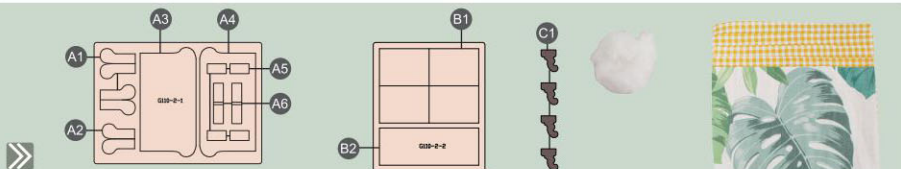

Material List (Take the parts from Bag No. G110)

Wood pieces A1-A6, B1-B2, C1 (as shown)
 Fabric (as shown) 5 pcs
 Silk cotton (as shown) some
 Emery paper (as shown) 1 pc
 Paper-cut K1, K2 (as shown) G110 paper-cut

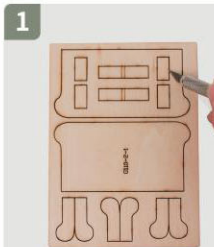

Remove the parts with utility knife.

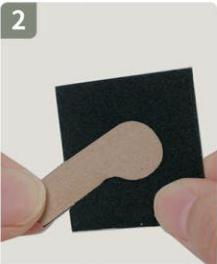

Polish the edge of the parts with emery paper.



Cut based on the fabric and wrap as shown.

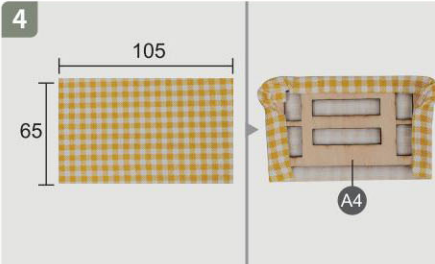

Cut based on the fabric and wrap as shown. (Leave one side unsealed.)



Fill the cotton inside.

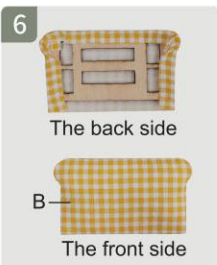

The back side

The front side

Fill the cotton inside.

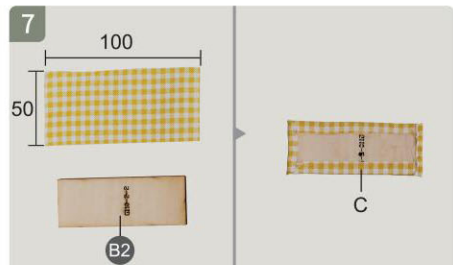

Cut based on the fabric and wrap as shown.

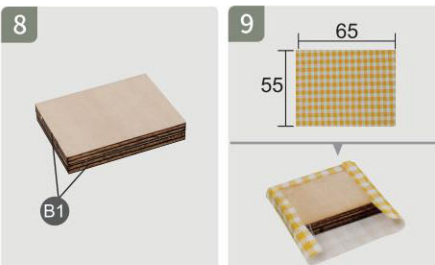

Glue as shown.



Cut based on the fabric and wrap as shown. (Leave one side unsealed.)

Fill the cotton inside and seal.



Completed.

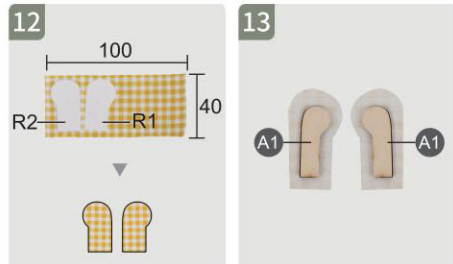

Cut the fabric based on the paper-cut K1, K2.

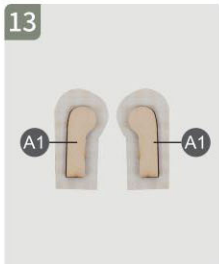

Cut the fabric based on the paper-cut K1, K2.

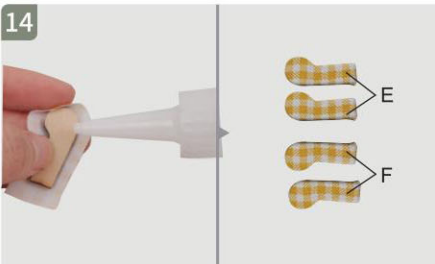

Wrap the wood pieces as shown, complete 4 pcs (Note the front and back sides).

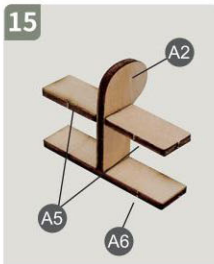

Glue as shown.

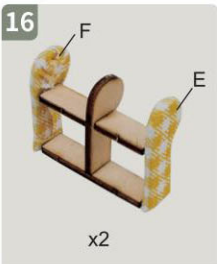

Glue as shown, complete 2 pcs in total.

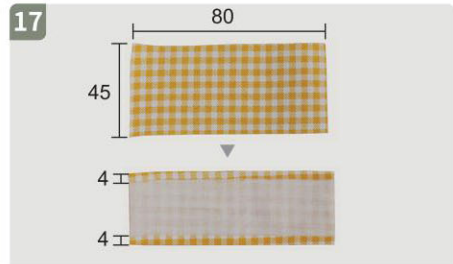

Fold and glue as shown.



Glue as shown, complete 2 pcs.

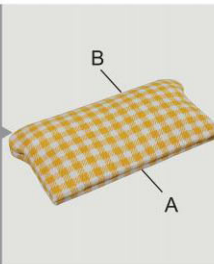

Glue the back side of 'A', 'B' together.

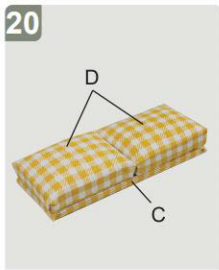

Glue the back side of 'C', 'D' together.



Glue as shown.



Glue as shown.



Bottom

Glue as shown.



Glue as shown.

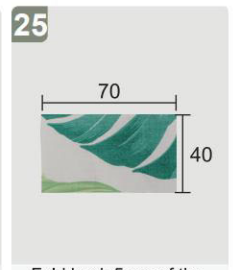

Fold back 5mm of the four sides separately after cutting.



Fold back 5mm of the four sides separately after cutting.



Fold in half and glue. Leave one side without the glue.



Fill the silk cotton in.



Glue and seal. Complete 2 pcs in total.



Completed.

G105/Rafi Tea Table



Material List
(Take the parts from Bag No. G105)

1 Wood pieces A1-A10 (as shown)	5 Golden eyelet (as shown)	2 pcs	11 Brush (as shown)	1 pc
2 Pigment (as shown)	6 Golden receptacle (as shown)	1 pc	12 Needle (as shown)	1 pc
3 Golden cardstock (as shown) 3 pcs	7 Transparent cord fastener (as shown)	1 pc	13 Green stem (as shown)	1 pc
4 Brown wooden bead (as shown) 1 pc	8 Transparent diamond bead (as shown)	1 pc	14 Champagne wire (as shown)	1 pc
	9 Red paper (as shown)	1 pc	15 Golden wire (as shown)	1 pc
	10 Emery paper (as shown)	1 pc	16 Paper-cut K1, K2, K3 (as shown) (G105)	



Remove the parts with the utility knife.

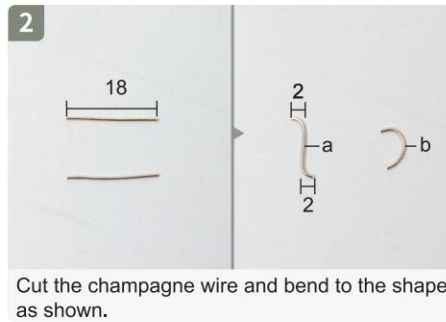

Cut the champagne wire and bend to the shape as shown.

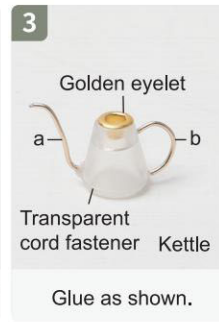

Glue as shown.

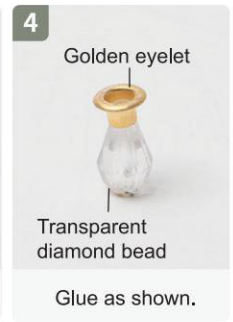

Glue as shown.

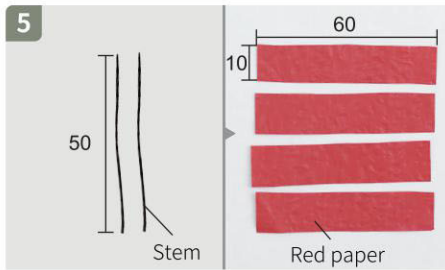

Cut as shown.

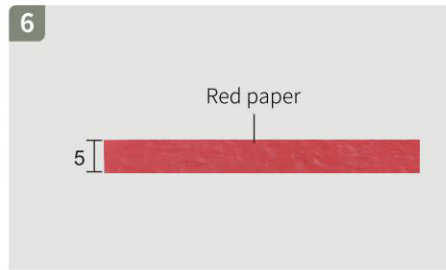

Fold in half as shown.

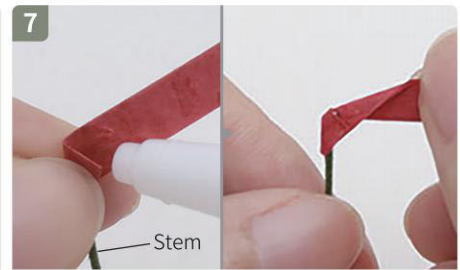

Glue the top of the stem to fix and fold.



Fold.

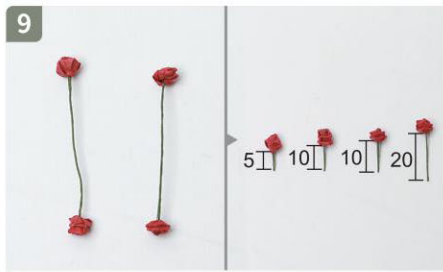

Complete 4 pcs at the two ends of stem as shown in total and cut.



Vase

Insert and glue.

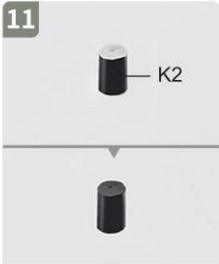

Wrap and roll K2 and paint the side face black.



Make K1 wrap K2 and glue, completed.

Candle

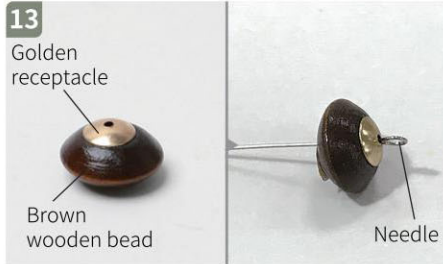

Golden receptacle

Brown wooden bead

Needle

Glue and insert the needle as shown.



Decoration

Cut the spare part of the needle and completed.

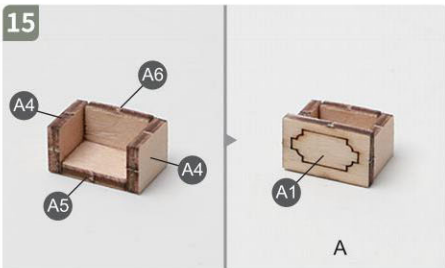

Glue as shown (Glue onto the middle of A1).

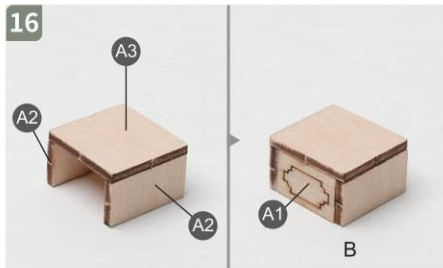

Glue as shown.

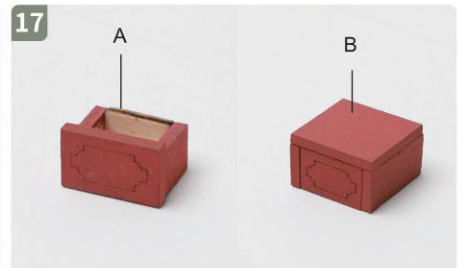

Paint brick red as shown.

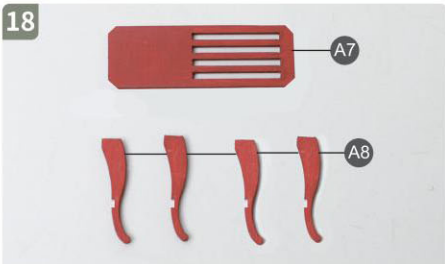

Paint the front side, the back side and the side face as shown. (Painting again after dry will be better.)

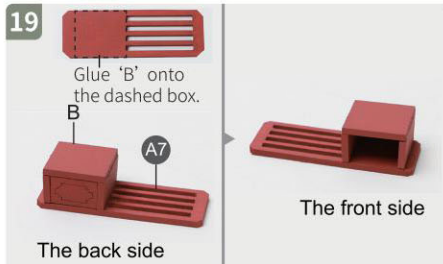

The back side

The front side

Glue as shown.

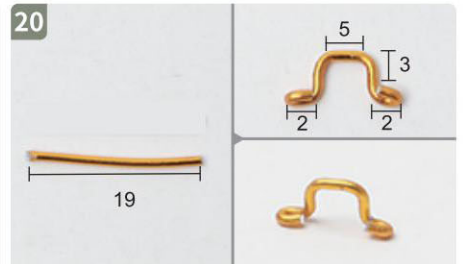

Cut the golden wire and bend to the shape as shown.

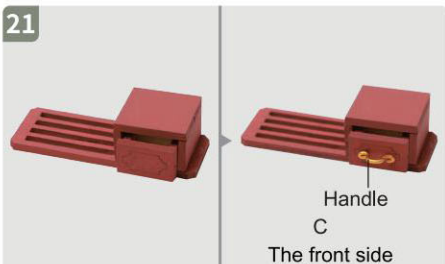

Handle
C
The front side

Insert the drawer and glue as shown.

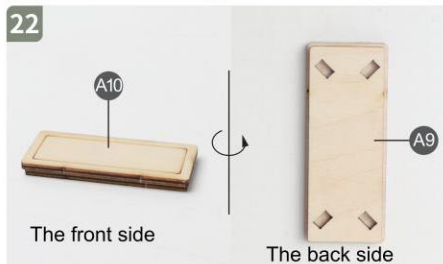

The front side

The back side

Glue as shown.

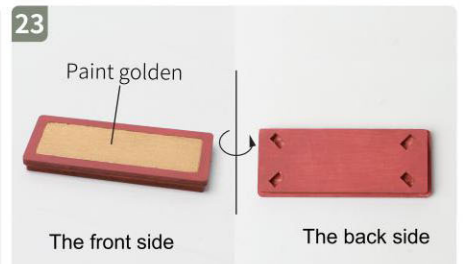

Paint golden

The front side

The back side

Paint as shown. (Painting again after dry will be better.)

24

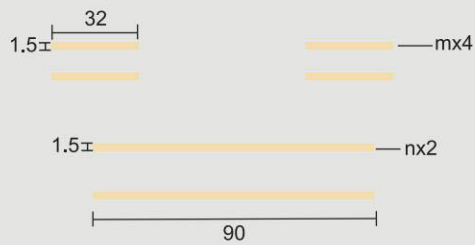

Cut the golden cardstock.

25



Glue as shown.

26



Glue as shown and paint golden as shown.

27

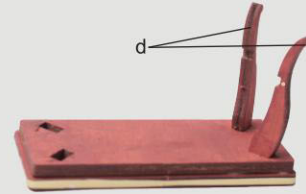

Glue as shown.

28



The back side



The front side

Glue as shown and paint the small part of the drawer in golden as shown.

29

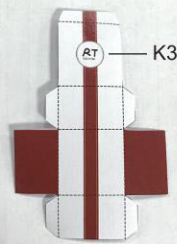

Carton

Fold K3 along the fold line and glue to complete the carton as shown.

30

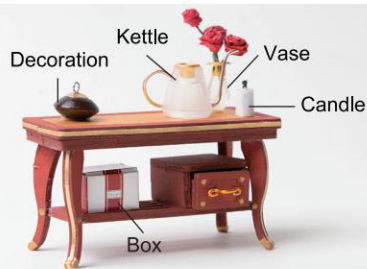

Set out and glue. Completed.

G053/Elizabeth Shoe Cabinet

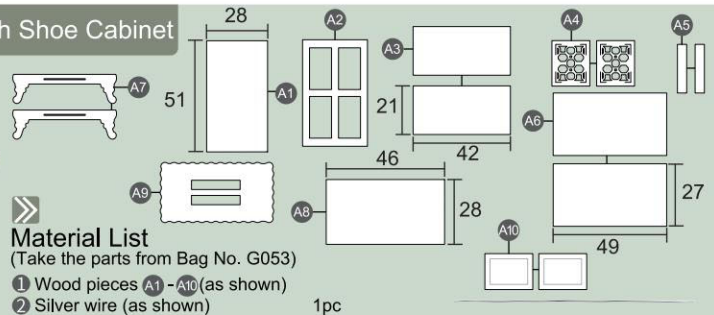

1

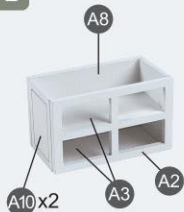

Glue as shown.

2

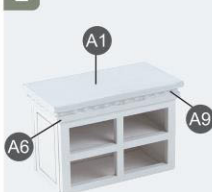

Put the part in the middle and glue as shown.

3



Glue as shown.

4



Glue as shown.

5

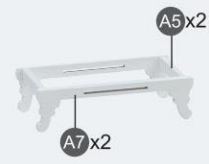

Glue as shown.

6



Put the part in the middle and glue as shown.

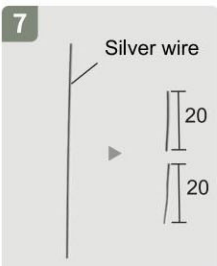

Cut as shown.



Bend as shown and clamp the two ends flat.

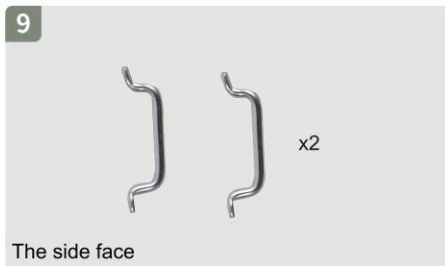

The side face

Complete 2 pcs as shown.



Glue as shown, completed.

G093/Walden Arm Chair

Material List
(Take the parts from Bag No. G093)

- ① Wood pieces A1 (as shown)
- ② Blue fabric with small white dot (as shown) 1pc
- ③ White electric wire (as shown) 1 pc



Overlap and glue the wood pieces.

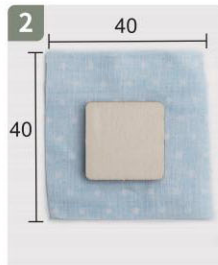

Cut the fabric as shown, put the wood piece in the middle of the back side of the fabric.



Glue the side face of the wood piece and wrap by the fabric.



The front side.



The back side.

Trim as shown.



Cut the fabric as shown to wrap the other side.



Trim as shown.

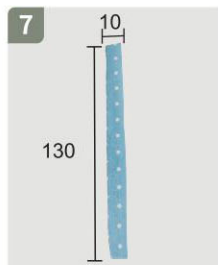

Trim the shape as shown.



Press to make a mark. (Scratch softly with your nail.)



Press to the shape as shown and glue.



Wrap and glue the side faces. (Start gluing from the middle of one of the side faces.)



Glue.



Trim the extra part.

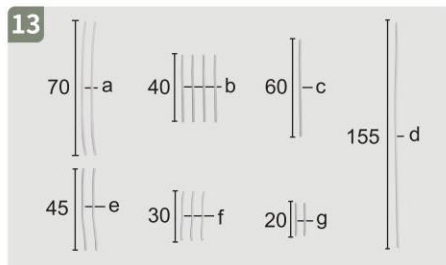

Cut the electric wire.

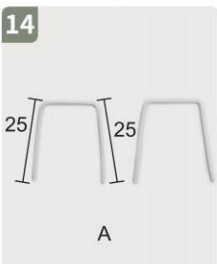

Bend 'a' as shown.

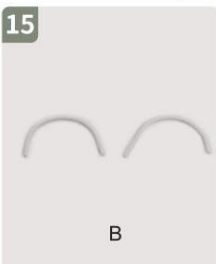

Bend 'b'.

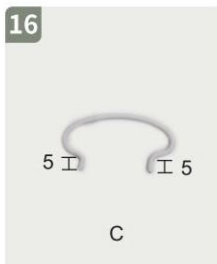

Bend 'c' as shown.



Bend 'd', then glue it head-to-tail.

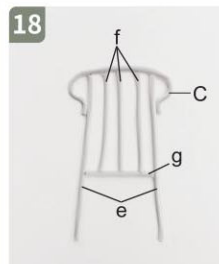

Glue. (Make it easier to glue with the tweezers.)

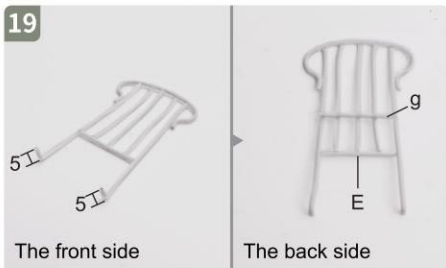

The front side

The back side

Bend and glue as shown .

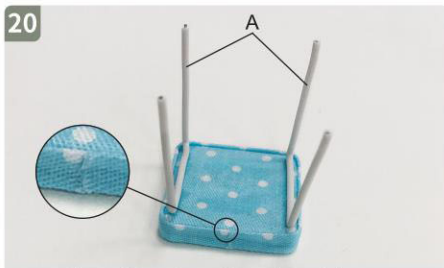

Glue. (Note the orientation of the seam of the cushion.)



The back side

Adjust the shape of 'D' and glue centrally .



The front side

Adjust the shape.



Adjust the shape.



Adjust the shape of the four legs.

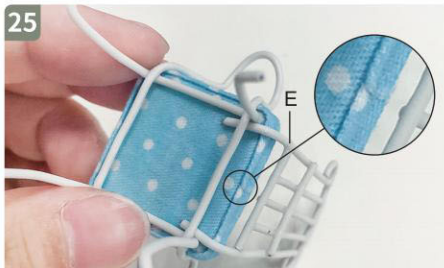

Glue 'E'. (Note the orientation of the seam of the cushion.)

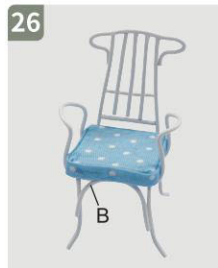

Glue 'B', the front side is shown.

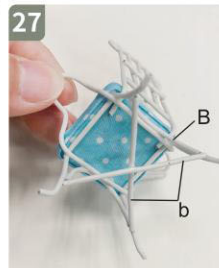

Glue.



Completed as shown.

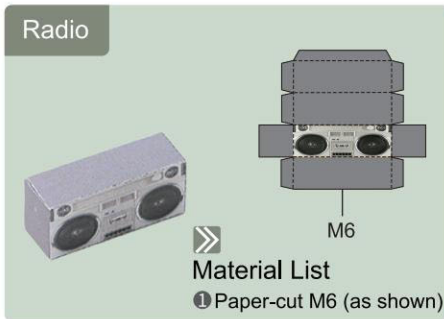

Radio



Material List

① Paper-cut M6 (as shown)



1

Glue as shown.

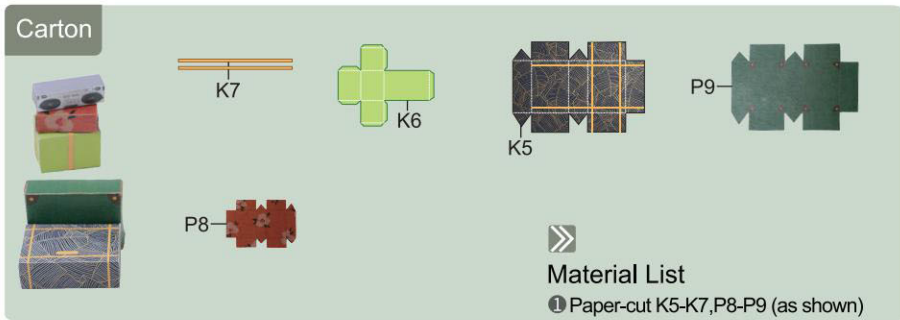

Carton



Material List

① Paper-cut K5-K7,P8-P9 (as shown)

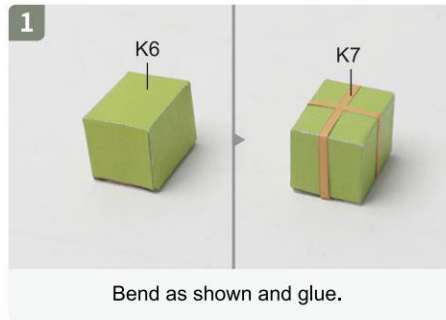

1

Bend as shown and glue.

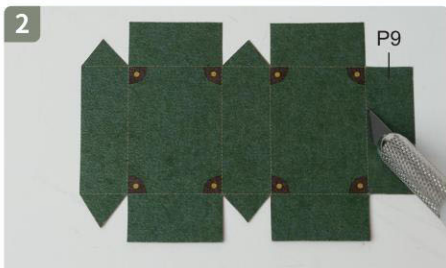

Scratching along the dash line will make it easier to fold .

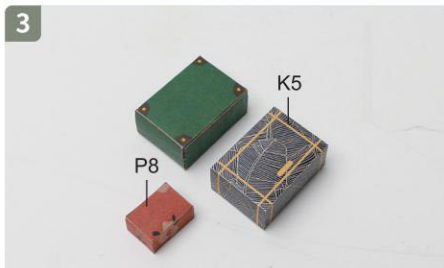

3

Glue.

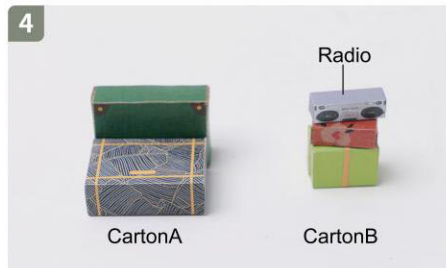

4

CartonA

CartonB

Completed.

Book



M8



Material List

- 1 Paper-cut M7, M8 (as shown)

1

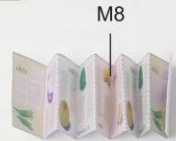

Fold as shown.

2



Glue the back side, as shown.

3



Wrap with M7 and glue.

4



Completed.

Paper Container



P10 P11



Material List (Take the parts from Bag No. DGF01)

- 1 Black electric wire L164mm (as shown) 1 pc (Bag No. 2)
- 2 Paper-cut P10-P12, M15-M19 (as shown)

1

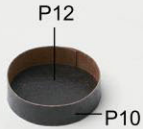

Bend and glue as shown.

2



Fold P11 in half and glue. Glue as shown.

3



x2

Cut 82mm of the black wire and complete the shape as shown. 2 pcs in total.

4



Glue at the reference line as shown.

5

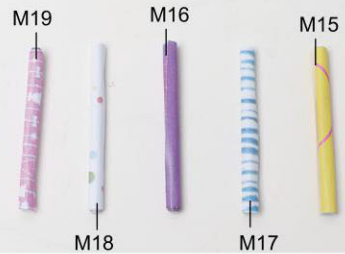

Roll as shown.

6



Completed.

Photo

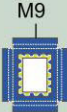
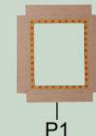
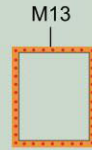
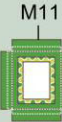

Material List

- 1 Paper-cut P1-P4, M9-M14 (as shown)
- 2 Pigment (as shown) 3 pcs

1

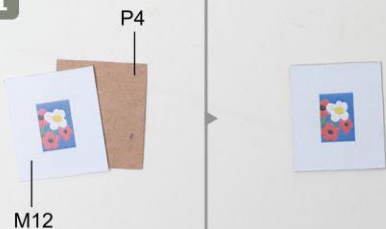

Overlap and glue.

2

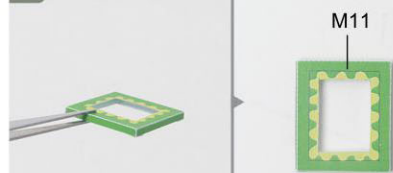

Fold and glue.

3



Overlap and glue.

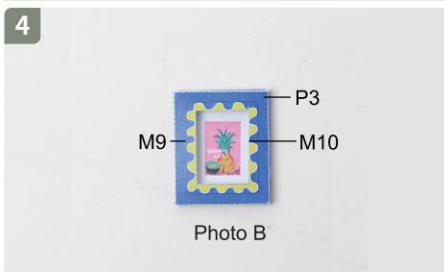

Complete in the same way.



Overlap and glue.

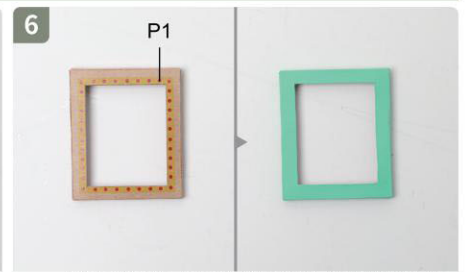

Fold and glue. Then paint to dry. (Painting again after dry will be better. Lightly press the board in case it deforms after painted.)



Glue as shown.

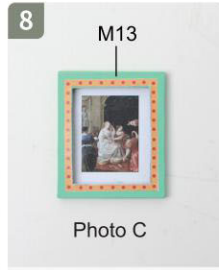

Glue and completed.

Flowerpot

Material List (Take the parts from Bag No. DGF01)

- ① Paper string L340mm (as shown) 1 pc (Bag No. 2)
- ② Paper-cut P5-P7, P13-P16, K2, N4, N8 (as shown)



Scratch the dash line with the utility knife to make it easier to bend.

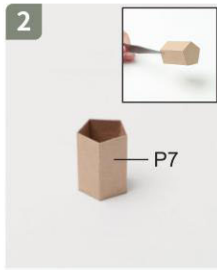

Glue as shown.

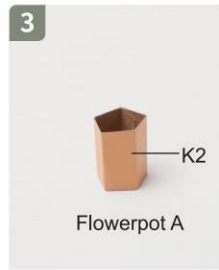

Wrap and glue.

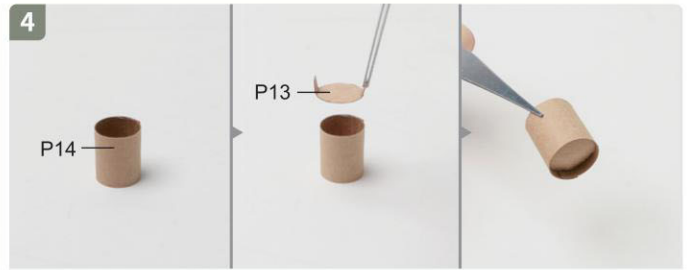

Glue as shown.



Flowerpot B

Wrap and glue.

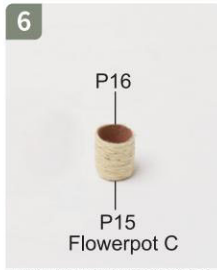

Flowerpot C

Glue P15 and P16 together in the same way. Then divide the paper string into 2pcs. Twine and glue.



Glue as shown.

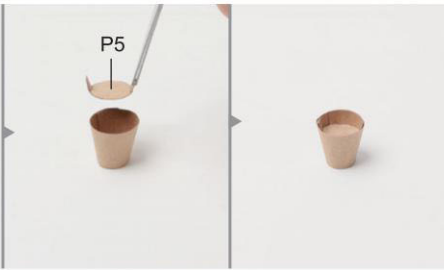

Flowerpot D

Glue as shown.

Plant 1

Material List (Take the parts from Bag No. DGF01)

- ① Green stem L600mm (as shown) 1 pc (Bag No. 2)
- ② Yellow stamen (as shown) 2set (Bag No. 2)
- ③ Brown clay (as shown) several pcs (Bag No. 2)
- ④ Paper N1, N7 (as shown)

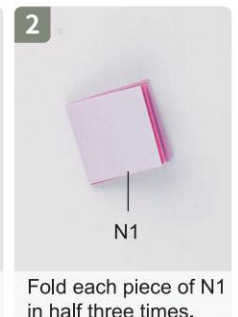
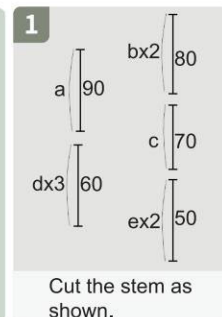

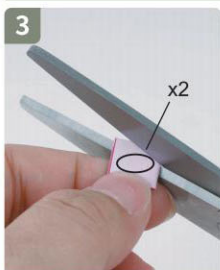

Shape the paper-cut as oval and get 8 pcs of petals as shown. Do the same as last steps and get 16 pcs.



Shape as shown.



Glue onto the stem.

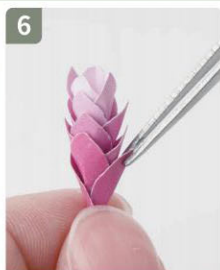

Glue 16 pcs of petals as shown. Note the sequence of color.

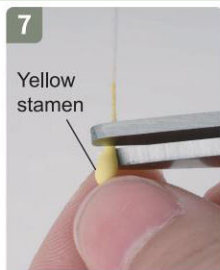

Yellow stamen

Cut off the thin thread.

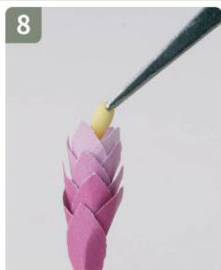

Glue it onto the middle of the petal.



Complete 3 pcs in total.



Twine together.

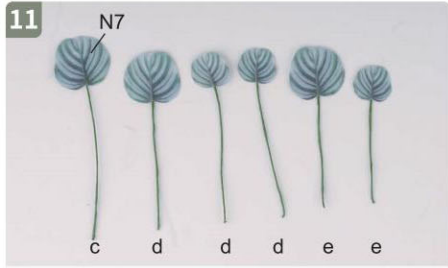

Put the stem in the middle of the leaves and glue, then cut.



Twine together.



Adjust.



Flowerpot A
Insert little brown clay into the flowerpot and fix.

Plant 2

Material List
(Take the parts from Bag No. DGF01)

① Brown clay (as shown)	some (Bag No. 2)
② Green stem L520mm (as shown)	1pc (Bag No. 2)
③ Paper string L150mm (as shown)	1pc (Bag No. 2)
④ White flowerpot (as shown)	1pc (Bag No. 2)
⑤ Paper-cut N12 (as shown)	

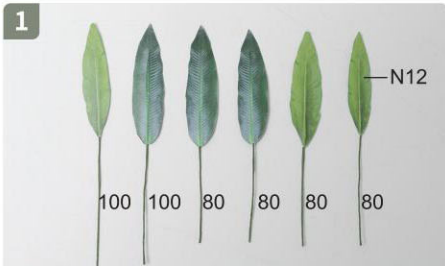

Cut the stem as shown, and glue the stem in the middle of paper-cut.

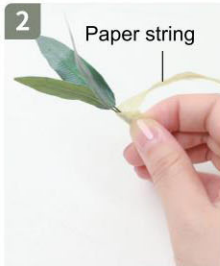

Cut 150mm of the paper string, and divide into 2 pcs. Then wrap and glue to two branches as shown.



White flowerpot

Insert little clay.



Glue and fix as shown. Adjust and completed.

Plant 3

Material List
(Take the parts from Bag No. DGF01)

① Green stem L465mm (as shown)	1 pc (Gag No. 2)
② Paper-cut N6 (as shown)	some (Bag No. 2)
③ Brown clay (as shown)	some (Bag No. 2)

1

Cut.

2

Glue.



3
Twine the end of the plants together.



4
Bend the leaves.



5
Flowerpot C
Insert some clay and fix as shown .Completed.

Plant 4

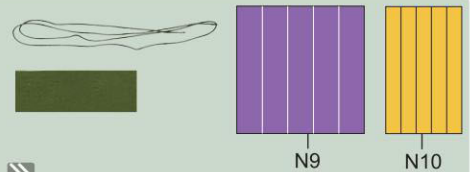

Material List

(Take the parts from Bag No. DGF01)

- ① Paper-cut N9, N10 (as shown)
- ② Green stem L215 mm (as shown) 1 pc (Bag No. 2)
- ③ Green paper 100*40 mm (as shown) 1 pc (Bag No. 1)

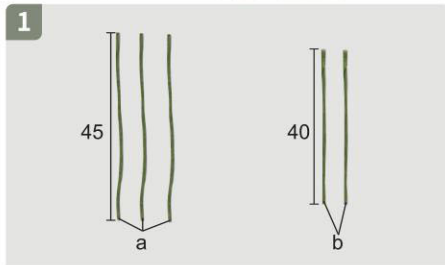

1
Cut the stem.

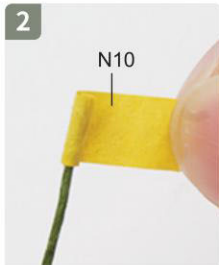

2
Roll the yellow paper and glue.



3
Complete the stamen as shown, 5 pcs in total.

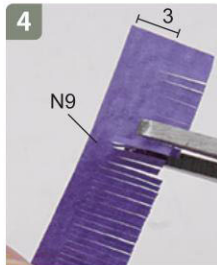

4
Cut as shown.



5
Roll the purple paper and glue onto the stamen.



6
Glue and complete 5 pcs.



7
Fold and cut the green paper as shown (cut the long side), and roll to glue.



8
Flowerpot B
Glue and insert the plants. Completed.

Plant 5

N3

Material List

- ① Paper-cut N3 (as shown)
- ② Brown clay (as shown) some (Bag No.2)



1
Flowerpot D
Fill proper amount of clay.

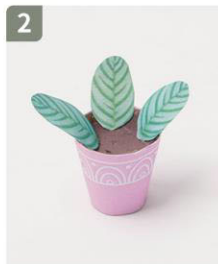

2
Glue.



3
Completed.

Plant 6

N5

Material List

(Take the parts from Bag No. DGF01)

- ① Green paper 80*50mm (as shown) 1pc (Bag No. 2)
- ② Green stem L260mm (as shown) 1pc (Bag No. 2)
- ③ White cylindrical flowerpot (as shown) 1pc (Bag No. 2)
- ④ Paper-cut N5 (as shown)

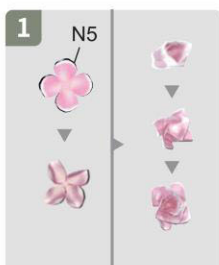

1
Bend the petals and glue as shown. Three petals in one flower.

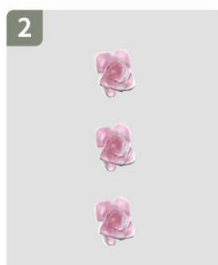

2
Complete 3 pcs.

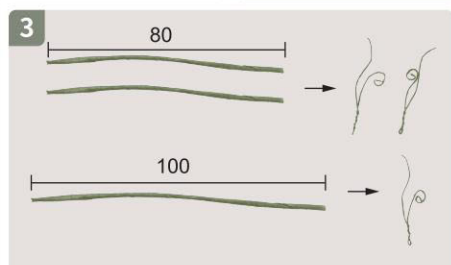

3
Cut as shown and roll it.

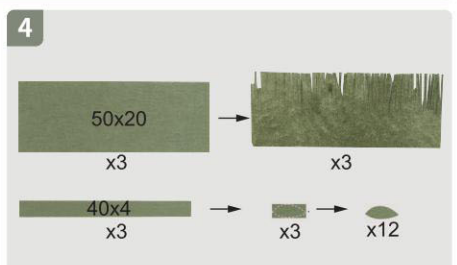

4
Cut and trim as shown.

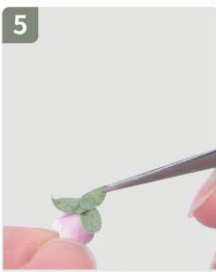

5
Glue three leaves onto one flower and bend with tweezers.



6
Glue as shown.



7
Glue as shown.



8
Bend the leaves and roll to glue.



9
Complete 3 pcs in total.



10
White cylindrical flowerpot
Glue and insert the 3 pcs of plants as shown, completed.

Plant 7



N13



Material List

(Take the parts from Bag No. DGF01)

- 1 Black square flowerpot (as shown) 1 pc (Bag No. 2)
- 2 Yellow stamen (as shown) 2 pcs (Bag No. 2)
- 3 Green paper 80*80mm (as shown) 1 pc (Bag No. 1)
- 4 Paper-cut N13 (as shown)



1
Fold the paper in half and glue.



2
Fold 'a' in half as shown.



3
Mark based on N13 as shown.



4
Cut as shown.



5
Glue as shown.



6
Glue as shown.



7
Trim and glue. Then fix as shown.



8
Completed.

Blue Rose

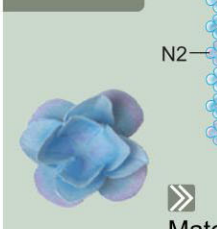

N2

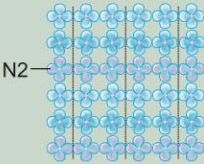

N11

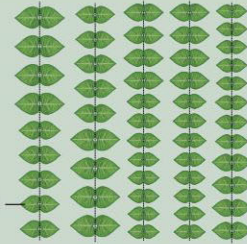

Material List

- 1 Paper-cut N2, N11 (as shown)

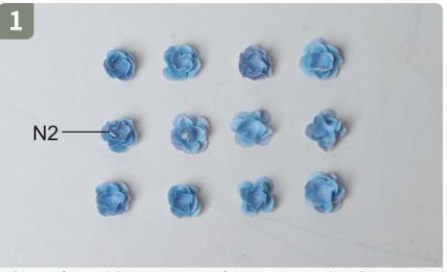

1
Complete 12 pcs in total based on the first step of plant 6.

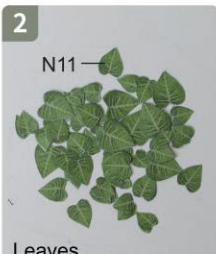

2
Leaves
Bend the leaves after cutting for preparation.

Curtain



Material List

(Take the parts from Bag No. DGF01)

- 1 Fabric (as shown) 1 pc (Bag No. 1)
- 2 Champagne wire (as shown) 1 pc (Bag No. 2)
- 3 Golden eyelet (as shown) 2 pcs (Bag No. 2)



1
Divide the fabric into 2 pcs.

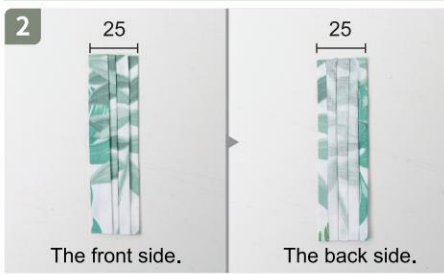

The front side.

The back side.

Fold and glue as shown.

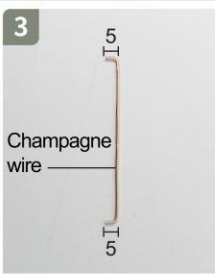

Champagne wire

Bend as shown.



Golden eyelet

Glue as shown, completed.

Handrail

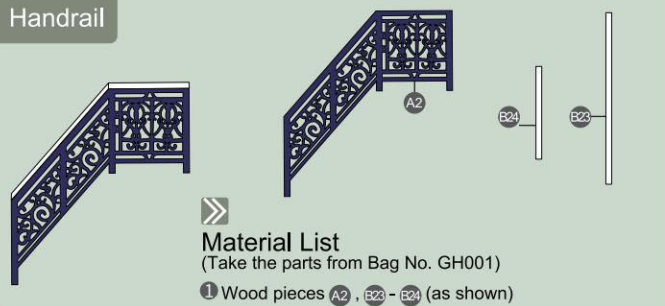

Material List

(Take the parts from Bag No. GH001)

- 1 Wood pieces A2, B23 - B24 (as shown)

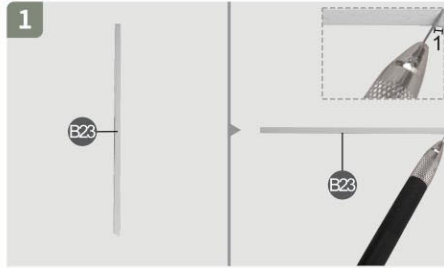

Cut as shown. Use the remains if by mistakes.

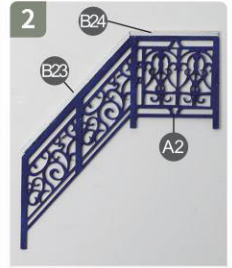

Glue as shown.

Stairs

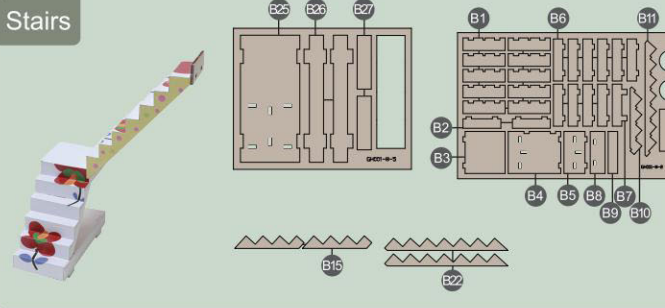

Material List

(Take the parts from Bag No. GH001)

- 1 Wood pieces B1 - B11, B13, B15, B22, B25 - B27 (as shown)
- 2 Paper-cut M2, M4-M5 (as shown)



Glue as shown.



Glue as shown.



Glue as shown.



Glue as shown.

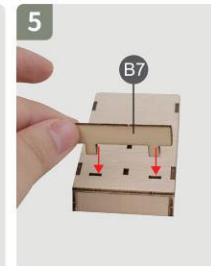

Glue as shown.



Glue as shown.

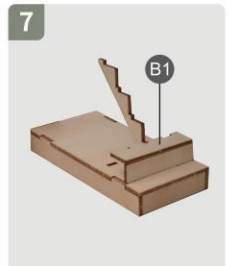

Glue as shown.

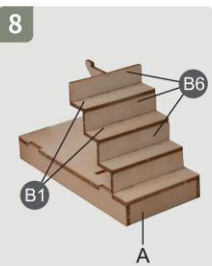

Glue as shown.



Glue as shown.



Glue as shown.



Glue as shown.

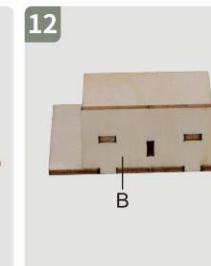

Completed.

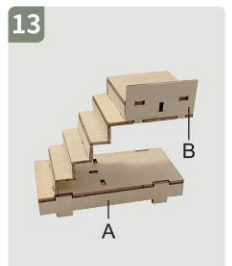

Glue as shown.

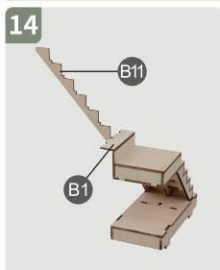

Glue as shown.

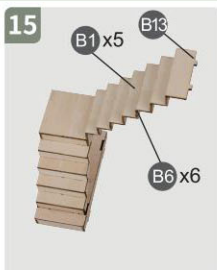

Glue as shown.



Glue as shown.



Paint white as shown and dry for preparation. (Painting again after dry will be better.)

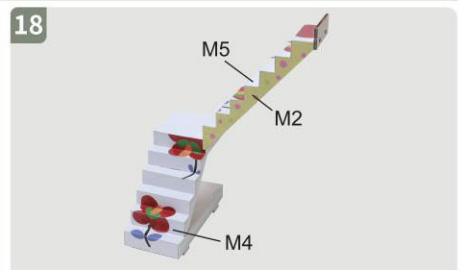

Completed.

Pillar

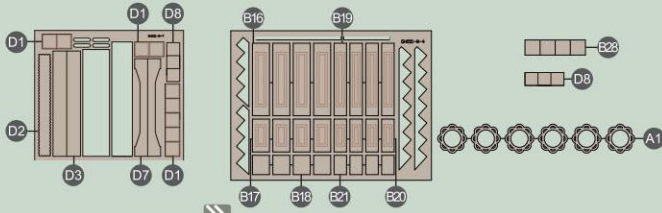

Material List

(Take the parts from Bag No. GH001)

1 Wood pieces A1, B16-B21, B23, D1-D3, D7-D8 (as shown)

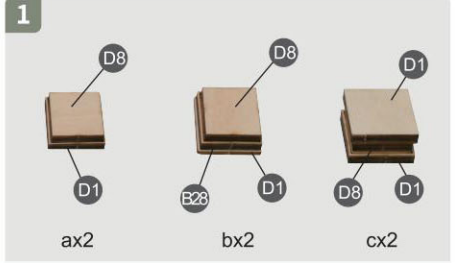

Glue as shown.

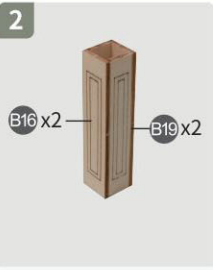

Glue as shown.



Glue as shown, complete 2 pcs.



Glue as shown, complete 2 pcs.

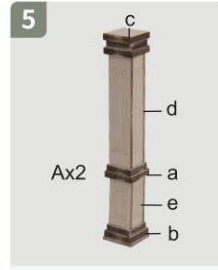

Glue as shown.

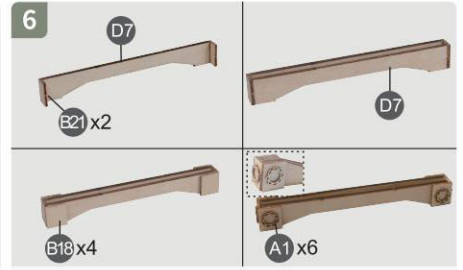

Glue as shown. (D7 is between two pieces of B21.)

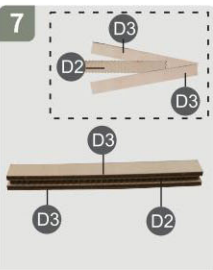

Glue as shown.

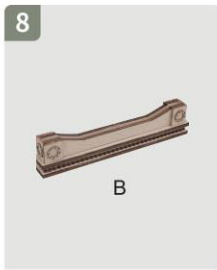

Glue as shown.

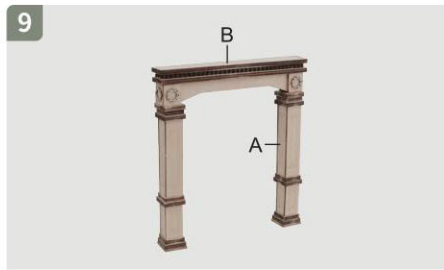

Glue as shown.



Mix the white and pink pigment in the same proportion and paint as shown, dry for preparation. (Painting again after dry will be better.)

Balcony

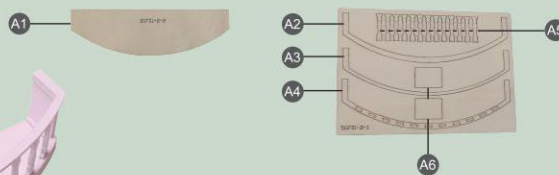

Material List

(Take the parts from Bag No. DGF01)

1 Wood pieces A1 - A6 (as shown)

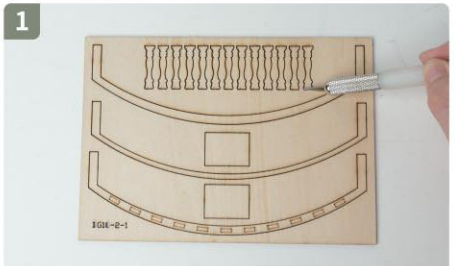

Remove the parts with utility knife.

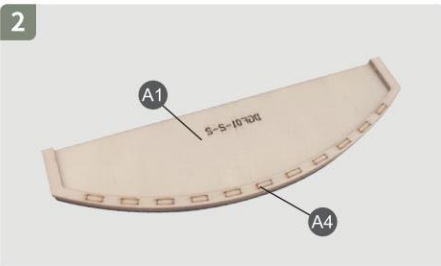

Glue.

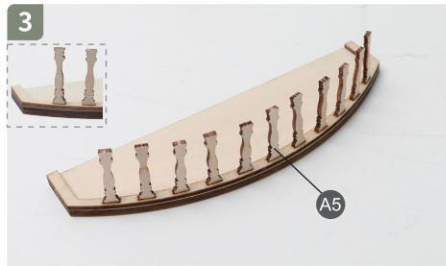

Glue.

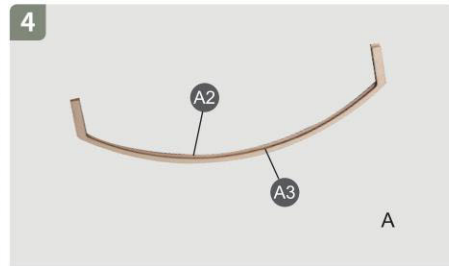

Glue.

A

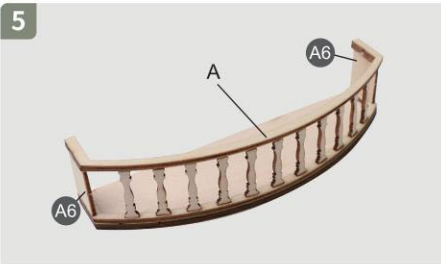

Glue.



Mix the white and pink pigment in the same proportion and paint as shown, dry for preparation. (Painting again after dry will be better.)

Window

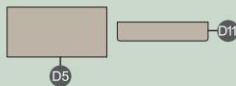
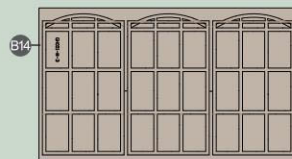
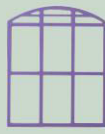
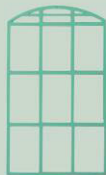
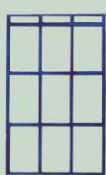

Material List

(Take the parts from Bag No. GH001)

- ① Wood pieces B14, D5, D11, D12 (as shown)
- ② Transparent sheet (as shown) 2 pcs
- ③ Yellow transparent sheet (as shown) 1 pc (Bag No. DGF01-1)

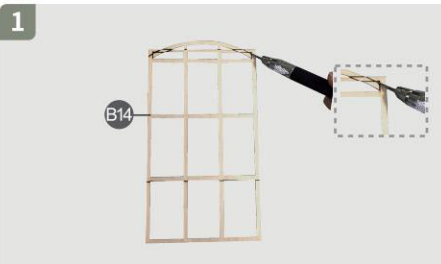

Cute as shown.

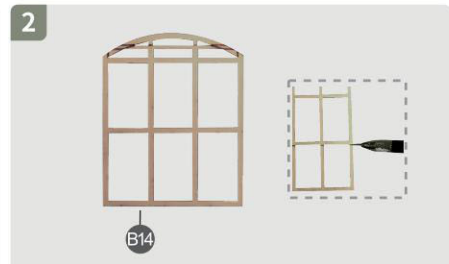
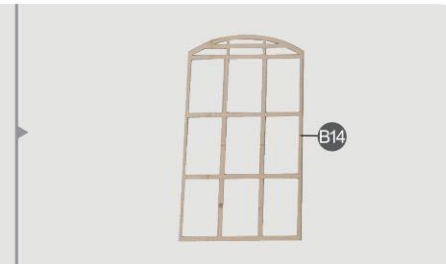

Cut as shown.

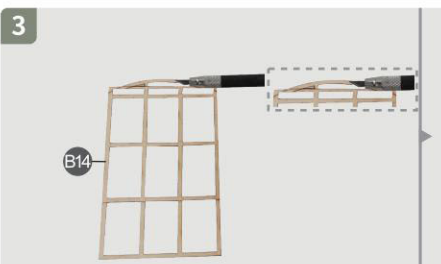

Cut as shown.

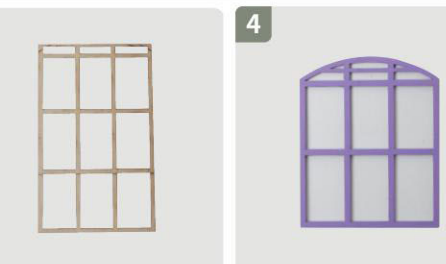

Paint as shown. (Painting again after dry will be better.)

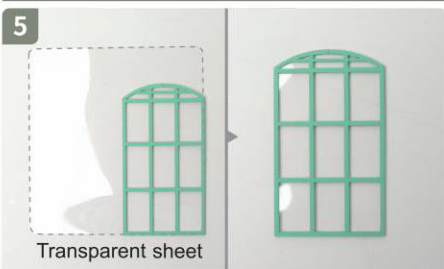

Transparent sheet

Cut as shown and glue the transparent sheet.

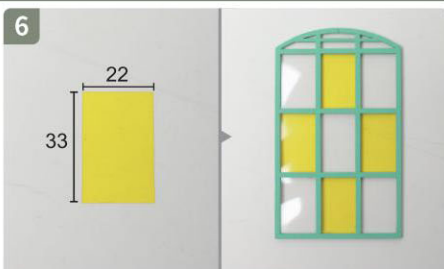

Cut the yellow transparent sheet and glue to the transparent sheet.

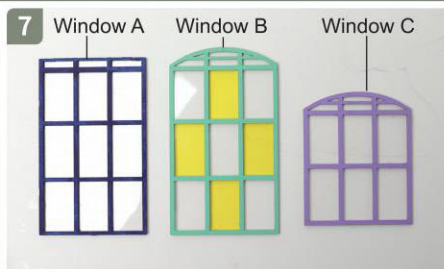

Glue the transparent sheet and completed.

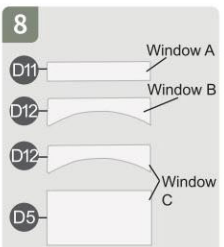

Paint white as shown and dry for preparation. (Painting again after dry will be better.)

Frame

Material List

(Take the parts from Bag No. GH001)

- 1 Wood pieces C1-C2, D9, E1-E4 (as shown)
- 2 Round white wooden bead (as shown)
- 3 Paper-cut K1, K3, K4, M1, M3, M8 (as shown)

4 pcs M3 K8



Put E3 on the table and glue white bead as shown. Insert D9 and glue.



Glue.

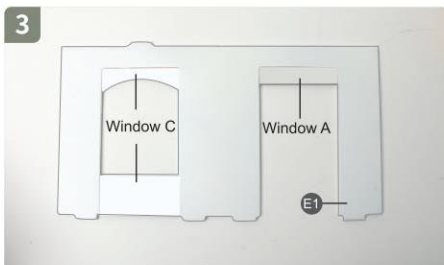

Glue.

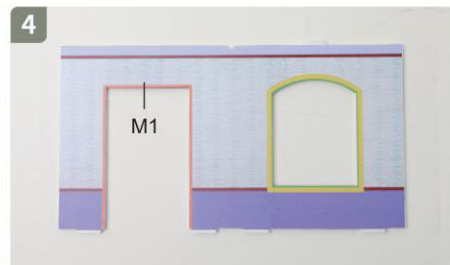

Glue.



Glue.

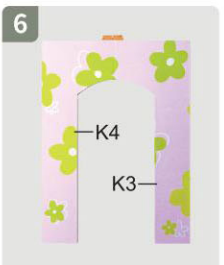

Glue.



Glue.

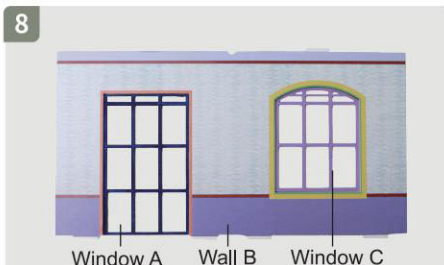

Glue.

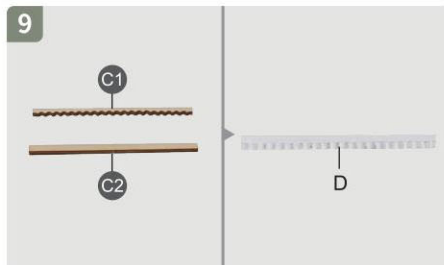

Glue C2 above C1. Painting white as shown and dry for preparation. (Painting again after dry will be better.)



Glue.



Glue.

Sequence of Assembly

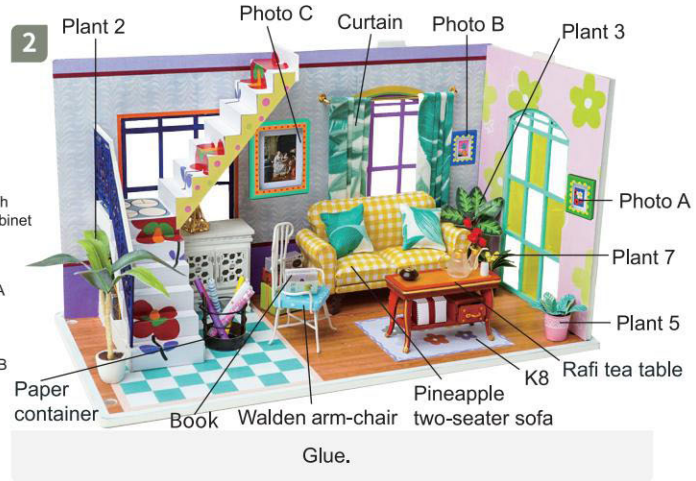

Insert **D4** into the roof as shown.

Sequence of Assembly

4



Glue.

5



Twine the stem and glue.

6



Glue.

7



Completed.



As shown, expand your house with other products of the same series freely.



Rolife Official Facebook Page

Trends, Events, Interactivity, Group.

[Discover more iFree collection](#)

Have more fun here.



Rolife Official Website

News, Discover, Fun, Store

[Discover more iFree collection](#)

Find more products here.