

Using the speaker

Set up the speakers.

Turn the [Power] dial on the front of the main speaker to the right until it clicks to power ON.
The LED indicator will turn BLUE, and the speaker lights will turn on.
When powered on, turn the [Power] dial to adjust volume.

Turn the [Power] dial to the left until it clicks to power OFF.

Audio playback will be controlled by your connected device.

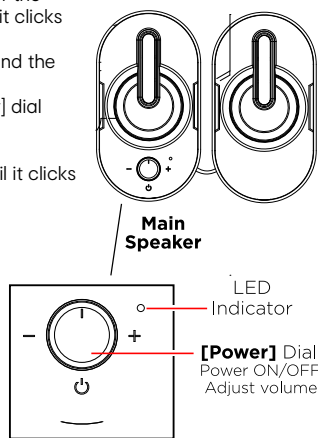

Setting up the speaker

Setting

Choose a location for the speakers near your computer or near a USB (Type-A) power source.

To power the speakers, plug their attached USB connector into a USB (Type-A) port on a computer or a compatible 5V USB adaptor (not included) and plug into a wall socket.

To play audio on the speakers, plug the speakers' attached 3.5mm connector into a 3.5mm audio output port on your computer or audio device.

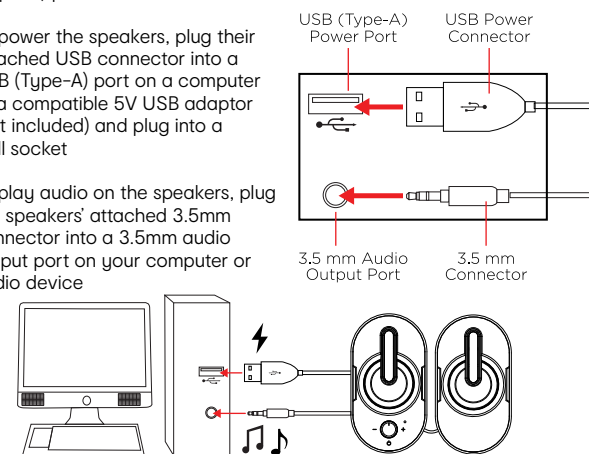

Caution

To ensure safe and proper use, please read all information in safety before using the devices.

Use only with batteries, chargers, accessories and supplies approved by the manufacturer.

THIS DEVICE IS NOT A TOY, DO NOT allow children or pets use or play with these devices.

Do not disassemble, modify or repair the devices.

Do not immerse in water.

Do not expose the units to extreme temperatures (hot or cold), wet open flames or humid conditions.

Do not allow the USB ports, power connector, or other device entrances are exposed to dust or water, or enter in contact with conductive materials such as liquids, metal powders, etc.

anko

KC#43031634



**GAMING 4 IN 1
COMBO PACK WITH LED LIGHTS**

Using the keyboard and mouse

Setting

Plug the USB connectors connected to the keyboard and mouse into any of the USB ports (Type A) on the front or back of your computer.

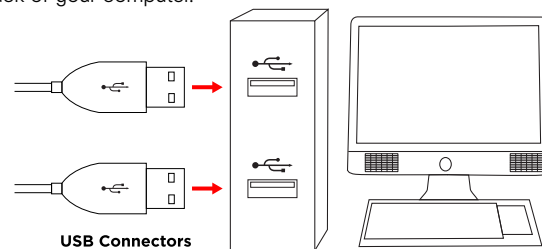

The keyboard and mouse do not require any special installation or software. Your computer should detect and install them automatically, and your lights should turn on automatically.

If your computer does not automatically connect to the keyboard or mouse, try restarting your computer or checking the device settings in your computer's Settings or System Preferences panel.

Setup the LED light strip

For best adhesion, the LED light strip is best mounted using only one attempt. For this reason, it's best to plan out the setup before attempting to apply.

Take the following into consideration when choosing a location:
△ The LED light strip must be able to reach a USB power source, such as the USB port on a computer or a 1.5A USB wall adapter (not included).

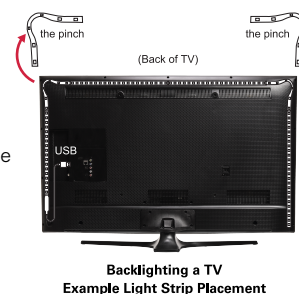

Shorten with scissors if necessary, as shown below:

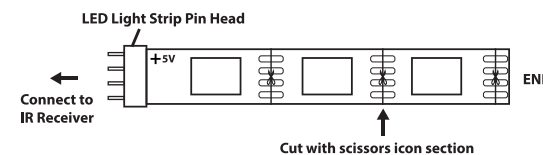

Using the LED light strip

Connect the USB connector to a USB power source.
Clean the surface where you will mount the LED light strip.
Remove the adhesive backing as you go, and mount the light strip to the surface.

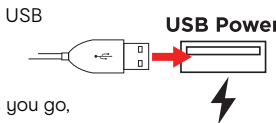

Remove the tab from the battery compartment of the remote control to activate.

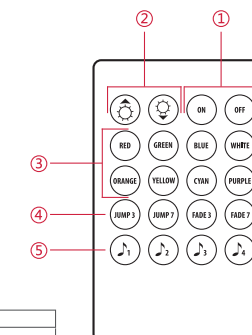

① ON/OFF	Turn the product on and off
② BRIGHTNESS UP/DOWN	Dim and brighten LEDs
③ COLOR SELECTORS	Choose between 8 color modes
④ FLASH SELECTORS	Select from flashing modes
⑤ SOUND ACTIVATED MODE	Choose between 4 sound activated modes

In the box:

Wired Gaming Keyboard x1
Wired mouse x1
Wired Speaker x1
Led lights band X1
User Manual x1