

# Rattan Dresser With Change Top Instruction Manual

**0-12**  
months

**11**  
KG

MAXIMUM  
WEIGHT  
LOAD OF  
CHANGE TOP

**10**  
KG

MAXIMUM  
WEIGHT  
LOAD OF  
EACH DRAWER



The photos and illustrations shown in this instruction manual are generic.  
The manufacturer reserves the right to change any specification or feature without prior notice.

**IMPORTANT. KEEP FOR FUTURE REFERENCE. READ CAREFULLY.**

# **WARNING!**

- The dresser is intended for use of 1 child at a time. Adult supervision is required at all times. Never leave child unattended.
- In order to prevent toppling, this product must be used with the wall attachment device provided.
- Inspect the products before assembly and periodically during use. Never use this product if there are any loose or missing fasteners, joints or broken parts.
- Regularly check that all fittings remain tight. Tighten if required.
- Be aware of risk of open fires and other sources of strong heat, such as electric bar fires, gas fires, etc. in the near vicinity of the product.
- Do not use near stairs, steps and on uneven surfaces.
- Do not allow children to climb on the dresser.
- Never pivot or drag the dresser on its feet. The dresser must always be lifted by at least two people when moved.
- Do not disassemble the change top after assembled.
- Maximum load weight of change top is 11kgs and the maximum load weight of each drawer is 10kgs.
- Do not use replacement parts that are not recommended or supplied by the manufacturer or distributor.
- A change mat is not supplied with this product. To be used with a change mat of size 9.5cm(H) x 48cm(W) x 73.5cm(L). Place the change mat on the change top surface, within the retaining rails.

## **CARE AND MAINTENANCE:**

- All assembly fittings are to be properly tightened; Inspect regularly and re-tighten as necessary.
- To clean your dresser, wipe with a damp cloth and dry immediately with a soft clean cloth.
- Do not use abrasive pads, bleach or strong household cleaners. Damage may result.

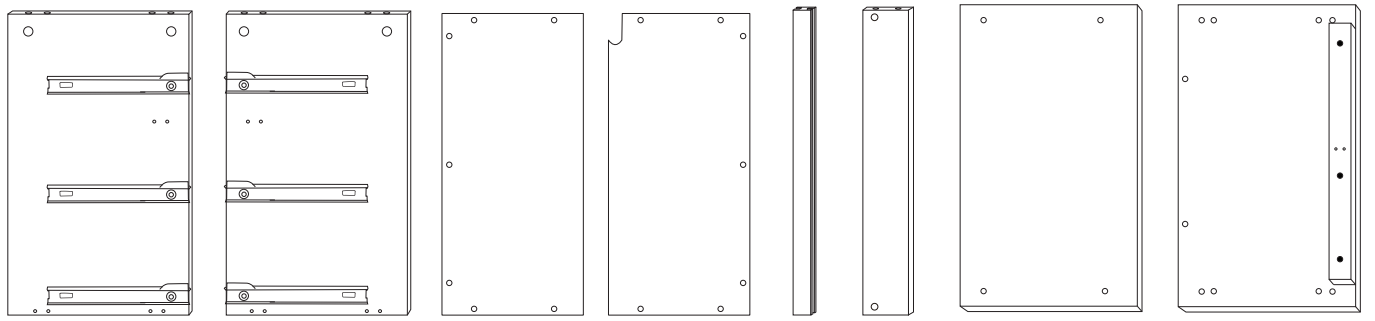

A.x1

B.x1

C.x1

D.x1

E.x1

F.x1

G.x1

H.x1

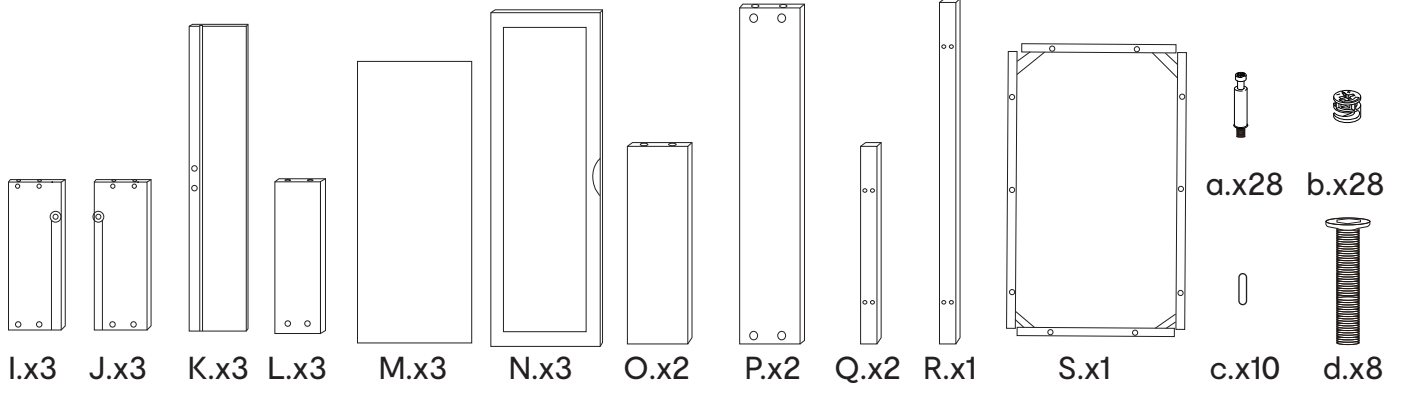

I.x3

J.x3

K.x3

L.x3

M.x3

N.x3

O.x2

P.x2

Q.x2

R.x1

S.x1

a.x28

b.x28

c.x10

d.x8

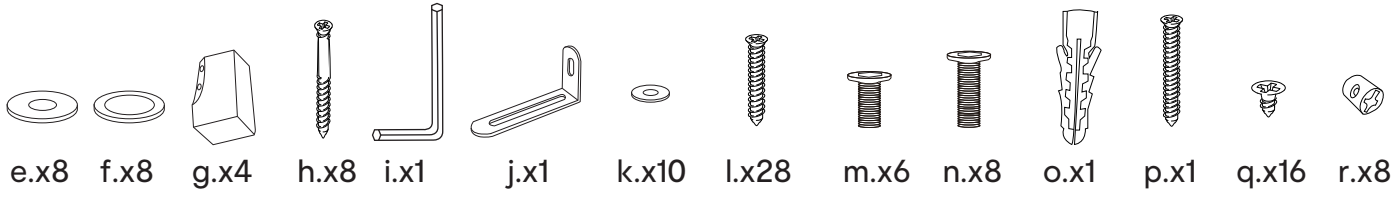

e.x8

f.x8

g.x4

h.x8

i.x1

j.x1

k.x10

l.x28

m.x6

n.x8

o.x1

p.x1

q.x16

r.x8

STEP 1

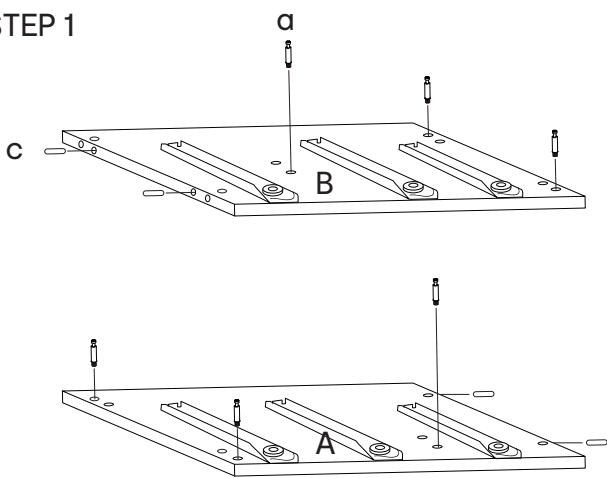

STEP 2

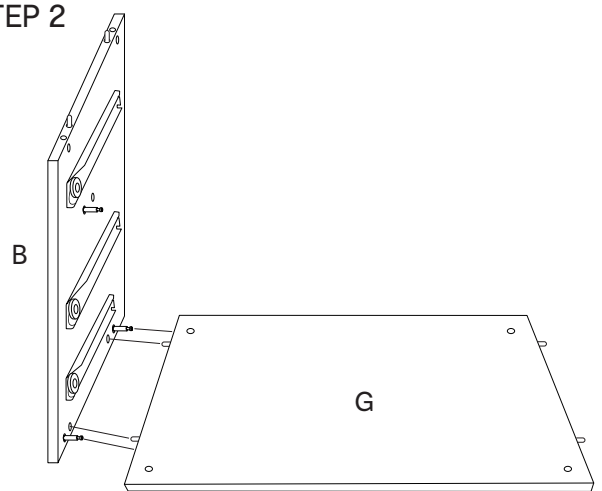

STEP 3

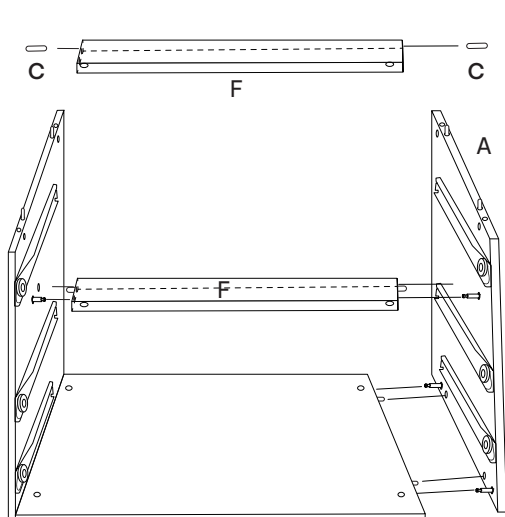

STEP 4

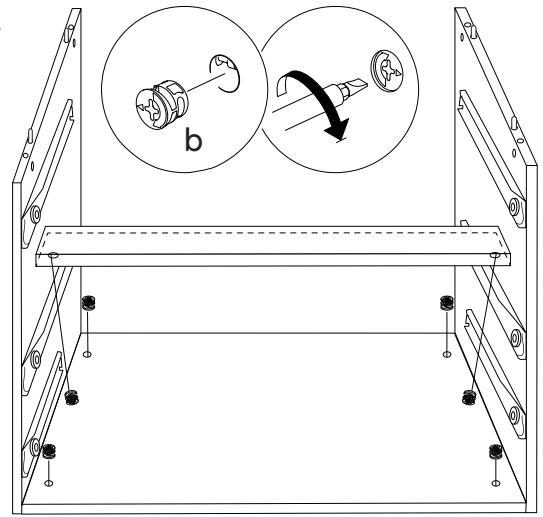

b

b

STEP 5

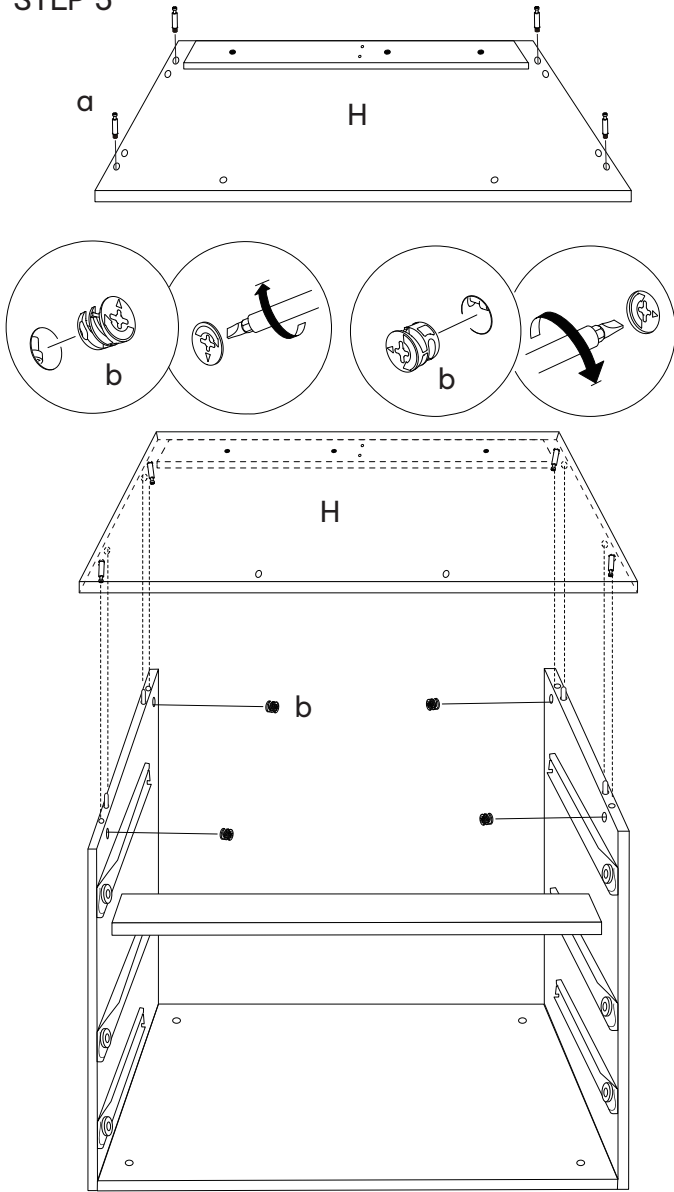

STEP 7

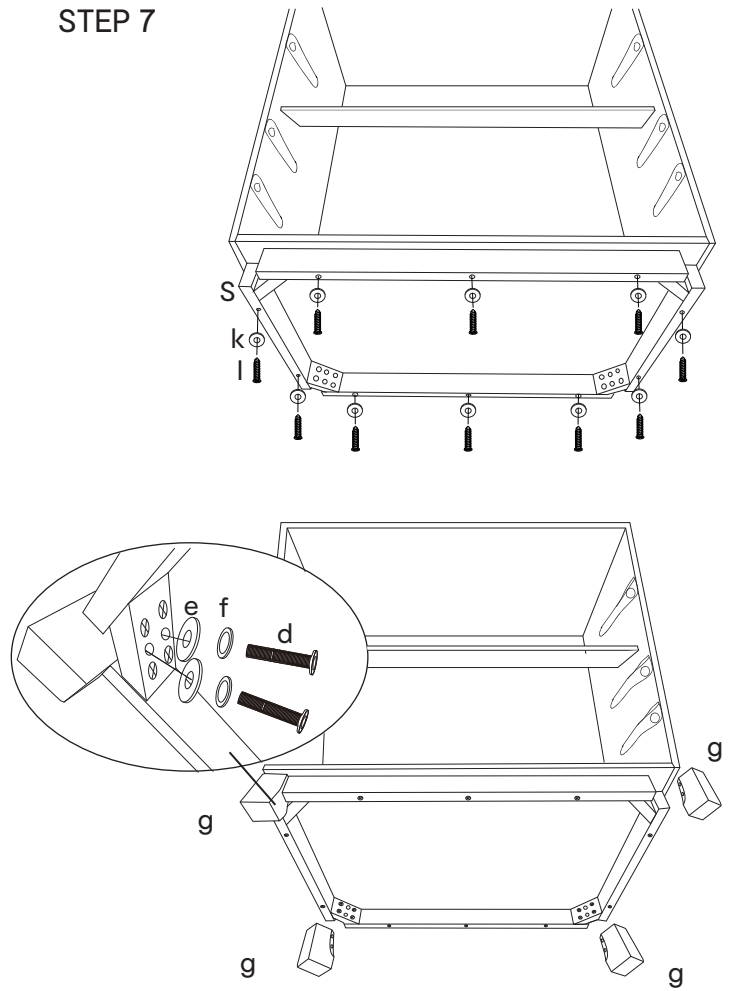

STEP 6

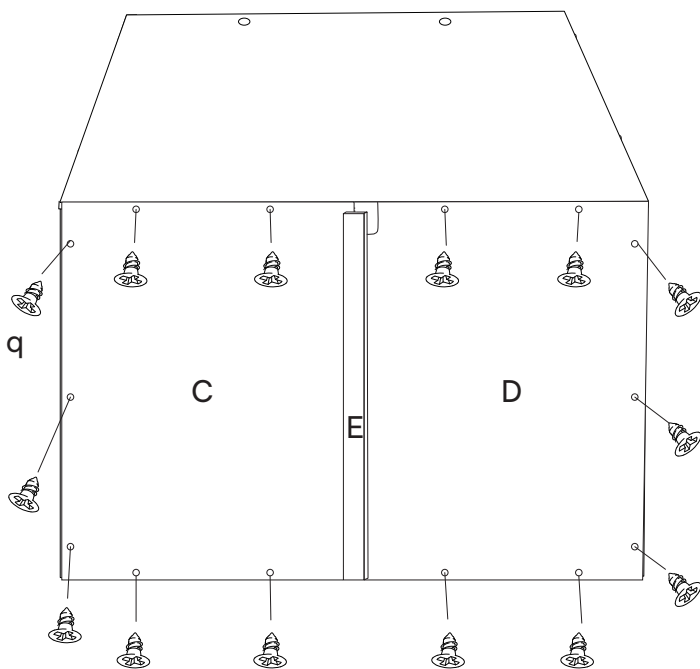

STEP 8

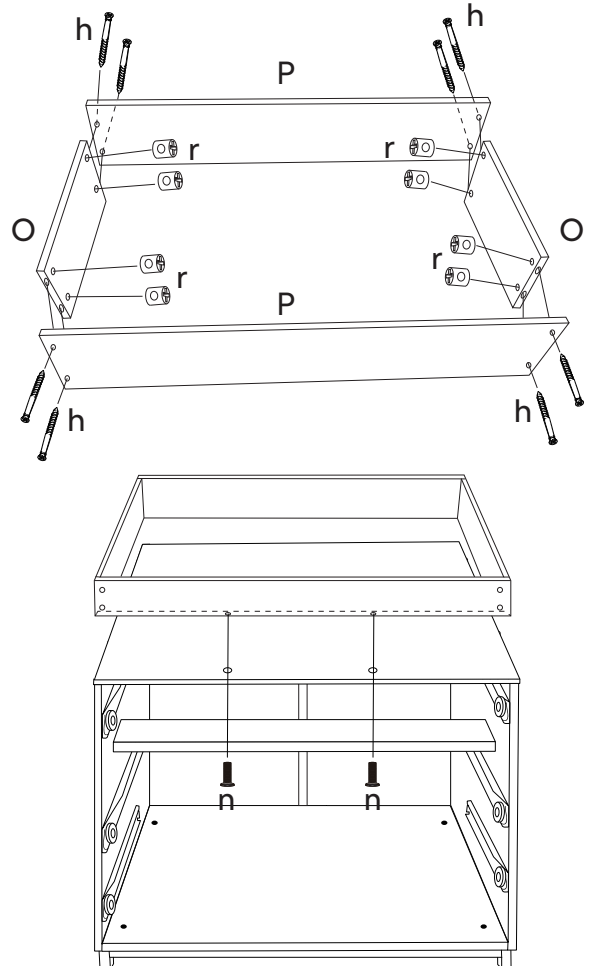

Do not fully tighten before all the screws are in position.

STEP 9

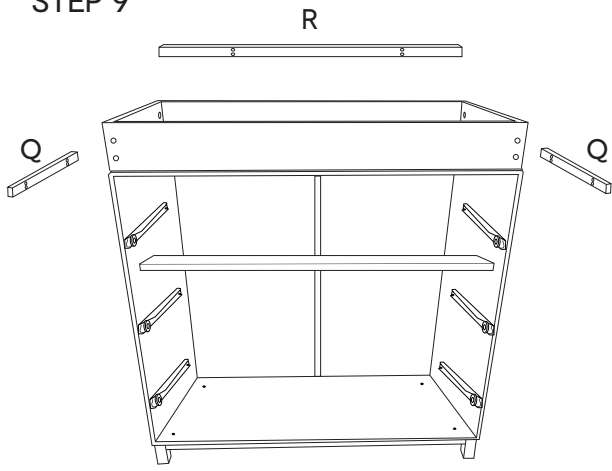

STEP 10

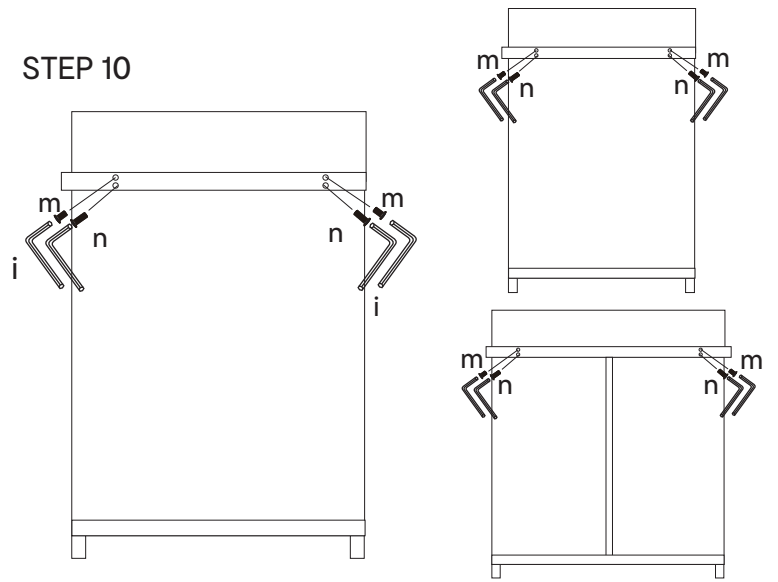

STEP 11

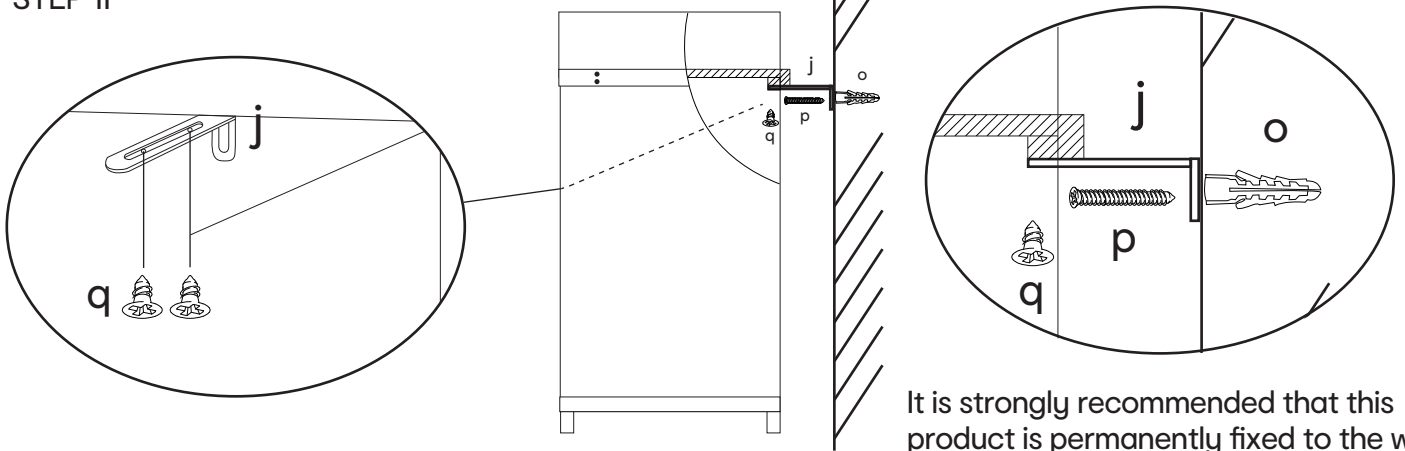

It is strongly recommended that this product is permanently fixed to the wall.



**WARNING:** PLEASE SECURE YOUR FURNITURE WITH THE SUPPLIED WALL FIXING. SCAN THE CODE FOR MORE INFORMATION.



User instructions for wall fixing: It is strongly recommended that this product is permanently fixed to the wall. Please seek professional advice if you are in doubt of what fixing device to use. Regularly check that the wall fixing is securely maintained. Stability of tall items may be affected by thick pile carpet or uneven floors. Do not place unanchored televisions on furniture. Caution: for your safety, when attaching the wall fixing, please note the following: Check any electrical wires or plumbing inside the wall before drilling any holes. If you are unsure, please seek professional advice from a qualified tradesperson.

STEP 12

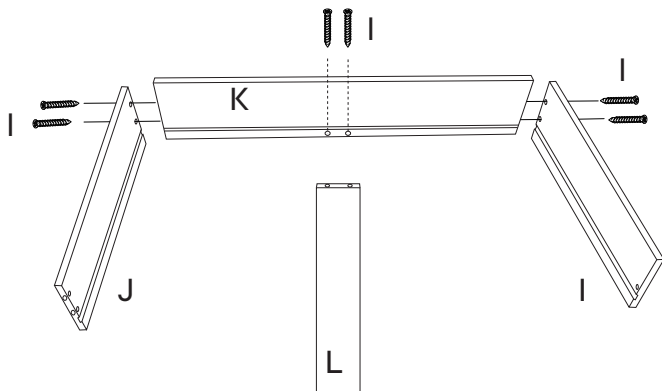

STEP 13

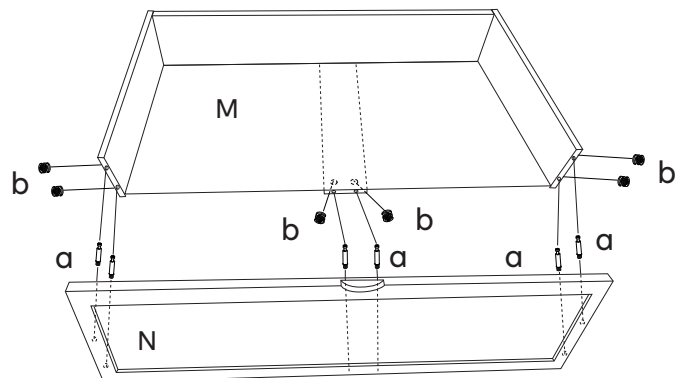

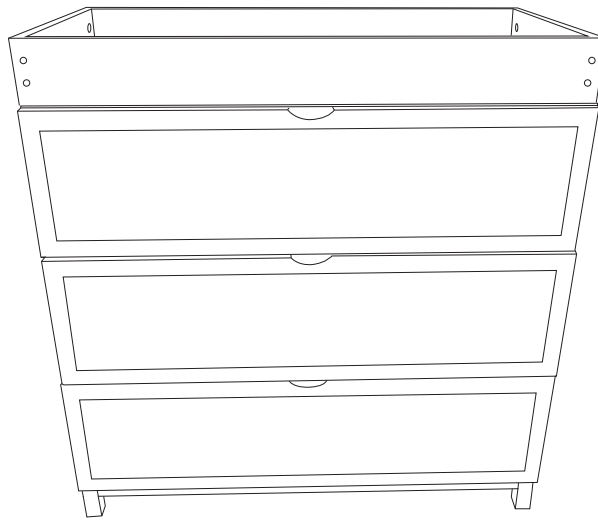

Keycode: 43-039-555

MADE IN CHINA

FOR AU / NZ: IMPORTED BY KMART FOR  
STORES IN AUSTRALIA AND NEW ZEALAND.

KMART AUSTRALIA - 690 SPRINGVALE ROAD, MULGRAVE, VIC 3170  
AUSTRALIA.

KMART NEW ZEALAND - REGIONAL OFFICE C/O KMART PAPATOETOE  
STORE, HUNTERS PLAZA, GREAT SOUTH ROAD, PAPATOETOE,  
AUCKLAND, NEW ZEALAND.