

anko



Bluetooth® Party Speaker

Keycode:43056118

operation instruction



Avoids to use battery in following conditions:

- High or low extreme temperature during use, storage or transportation.
- Replacement of a battery with an incorrect type that can defeat a safeguard.
- Disposal of a battery into fire or a hot oven, or mechanically crushing or cutting of a battery, that can result in an explosion.
- Leaving a battery in an extremely high temperature surrounding environment that can result in an explosion or the leakage of flammable liquid or gas.
- Extremely high temperature and/or extremely low air pressure that can result in an explosion or the leakage of flammable liquid or gas.

Product feature :

- 4 lighting modes Romantic colorful light.
- Bluetooth® version 5.0 , compatible with all audio devices with Bluetooth® function, as MP3/4, mobile, computer, ipad...
- Built-in rechargeable lithium battery.

Button and interface :

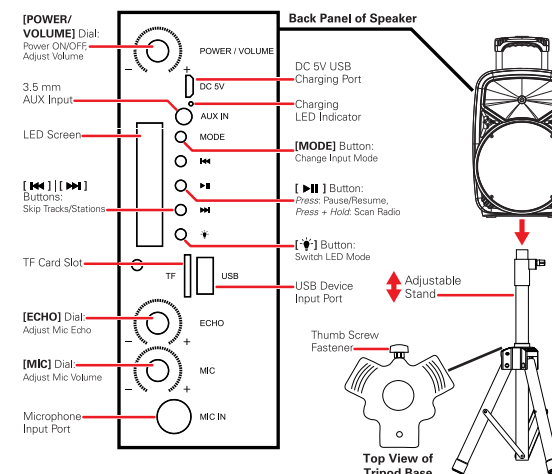

Unfolding the Tripod

1. Turn the thumb screw handle on the tripod base **counterclockwise** until the tripod is able to open.
2. Holding the center column firmly in one hand, grip and carefully pull one of the legs outward until the tripod begins to unfold, and the center column slides up.
3. Push the center column up until the tripod is fully opened and the center column cannot be pushed up any more.
4. Turn the thumb screw handle clockwise until tight.

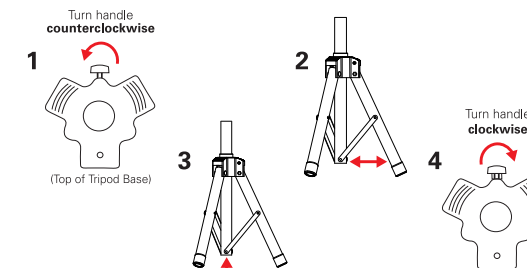

Adjusting the Tripod's Height

1. Turn the thumb screw handle on the upper part of the tripod's center column **counterclockwise** until loose.
2. Raise or lower the adjustable rod to the desired height.
3. Turn the thumb screw handle **clockwise** until tight to secure.

Mounting the Speaker

Unfold the tripod and adjust to the desired height. Mount the hole on the bottom of the speaker onto the rod of the tripod.

Turn the thumb screw handle on the speaker clockwise until tight to secure the speaker.

NOTE: The maximum diameter of the speaker's mounting hole is 1.45 inches.

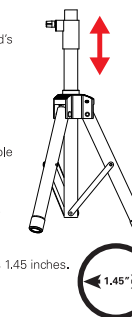

Powering ON/OFF

Make sure that the speaker has been charged.

- Turn the [POWER/VOLUME] dial clockwise until it clicks to power ON. A tone will be heard and the speaker will enter Bluetooth pairing mode. The speaker may automatically re-pair to any nearby, previously-paired device.
- Turn the [POWER/VOLUME] dial counterclockwise until it clicks to power OFF.



Changing Input Modes

Press the [MODE] button on the back panel of the speaker to switch between input modes. The LED screen on the back of the speaker will indicate the mode, and a voice will be heard indicating the mode.

You must have a micro TF card or USB device inserted or AUX cable connected to switch to these modes.

Adjusting Volume & Playback

- Adjust volume with the [POWER/VOLUME] dial or the controls on a connected device.
- Press the [SKIP] and [SKIP] buttons on the speaker to skip tracks or stations in Bluetooth mode, FM Radio mode, USB mode and TF card mode.
- Press the [PAUSE] button to pause and resume playback.

Connecting with Bluetooth

1. Power the speaker ON. A tone will be heard and the LED screen will display the word "BLUE."
2. Set your mobile device to search for Bluetooth devices. When it appears, select **BSSK1082BK** from the list of found devices.
3. After a successful pairing, a tone will be heard and you will be able to play music.

In Bluetooth mode, playback and volume can be controlled by your paired device or the controls on the back of the speaker.

Using the Speaker Lights

The LED lights will automatically turn on when the speaker is powered on.

- Press the [LED] button on the back of the speaker to change LED light modes, and turn the lights off.

Using the FM Radio

Power the speaker ON and switch to FM mode. A voice will be heard, and the LED screen will display the current FM frequency.

If it is your first time using the FM radio, it's recommended to do a full scan of nearby stations. Press and hold the [SCAN] button to start scanning and saving available stations. The LED screen will show scanning progress.

Radio functions can be controlled with the buttons on the speaker.

- Press and hold the [SCAN] button to start or stop scanning.
- Press the [SKIP] and [SKIP] buttons to flip through saved stations.

Connecting to an AUX Device

Insert one connector of a 3.5 mm auxiliary cable (*not included*) into the 3.5 mm auxiliary input jack on the back of the speaker. Insert the other connector into the headphone jack or audio output jack of your media-playing device. The LED screen will display the word "AUX"

In AUX mode, all playback will be controlled by your connected device.

Packing accessories:

- Wireless Speaker
- Tripod
- Wired Microphone
- Micro-USB Charging Cable
- Instruction Manual

Warning

- **DANGER:** To reduce the risk of fire, do not immerse this product into water or under raining.
- **WARNING:** Please refer to the electrical compliance label before charging or operating the unit.
- **WARNING:** Product shall not be exposed to excessive heat such as direct sunshine, fire or under the wind shield.
- Do not place or store this product where it can fall or be pulled into a water source like a sink, tub, or pool while charging.
- If the product falls into water, unplug it immediately.
- Do not expose battery to extreme temperatures.
- Do not tamper or puncture battery.
- Do not use if the battery or any cords are damaged.
- Unplug your charger when not in use.
- Never try to repair this product yourself.
- When the unit is not in use, make sure it is correctly turned off and stored in a cool, dry place.

12 Month Warranty

Thank you for your purchase from Kmart.

Kmart Australia Ltd warrants your new product to be free from defects in materials and workmanship for the period stated above, from the date of purchase, provided that the product is used in accordance with accompanying recommendations or instructions where provided. This warranty is in addition to your rights under the Australian Consumer Law.

Kmart will provide you with your choice of a refund, repair or exchange (where possible) for this product if it becomes defective within the warranty period. Kmart will bear the reasonable expense of claiming the warranty. This warranty will no longer apply where the defect is a result of alteration, accident, misuse, abuse or neglect.

Please retain your receipt as proof of purchase and contact our Customer Service Centre on 1800 124 125 (Australia) or 0800 945 995 (New Zealand) or alternatively, via Customer Help at Kmart.com.au for any difficulties with your product. Warranty claims and claims for expense incurred in returning this product can be addressed to our Customer Service Centre at 690 Springvale Rd, Mulgrave Vic 3170.

Our goods come with guarantees that cannot be excluded under the Australian Consumer Law. You are entitled to a replacement or refund for a major failure and compensation for any other reasonably foreseeable loss or damage. You are also entitled to have the goods repaired or replaced if the goods fail to be of acceptable quality and the failure does not amount to a major failure.

For New Zealand customers, this warranty is in addition to statutory rights observed under New Zealand legislation.