

# POP UP PRIVACY TENT INSTRUCTIONS

Keycode: 43089260

Please read completely before setting  
up your POP-UP PRIVACY TENT

## Warning!

1. Never set up or continue to use in any rain, wind or stormy conditions, especially lightning storms.
2. Avoid bending the frame or pinching your fingers or hands while opening or closing the frame.
3. Avoid setting up your tent on steep inclines.
4. Keep the Tent away from heat and flames at all times.
5. Never leave your tent unattended.
6. Never fold or store your tent when it is wet or damp. Let it dry completely to avoid mildew.
7. Never use the tent if it is damaged.

**WARNING: KEEP ALL FLAME AND HEAT SOURCES AWAY FROM THIS TENT FABRIC.**

**ATTENTION: To avoid any damage, remove the tent during bad weather, e.g., during high winds or heavy rains.**

## Assembly Instructions

Follow these instructions carefully to avoid pinching your hands or fingers in any of the moving parts as the frame opens and closes.

Unfold:

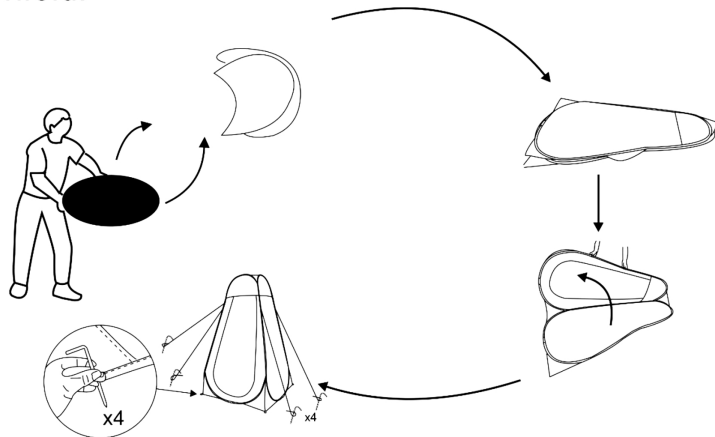

**CAUTION: BE CAREFUL NOT TO PINCH FINGERS. DO NOT PUSH HARD.**

## Disassembly Instructions

Attempting to erect this tent in windy conditions may be hazardous and could result in injury and or damage to the product.

Fold:

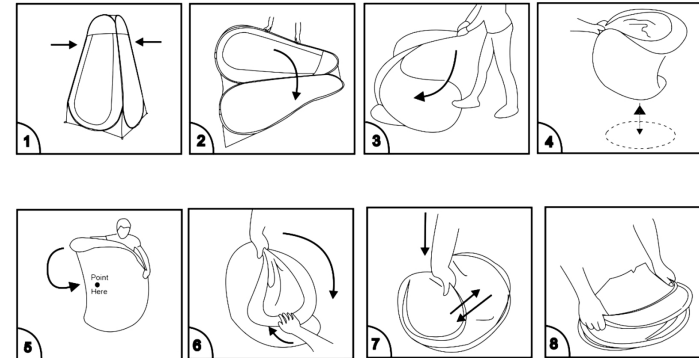

**CAUTION: BE CAREFUL NOT TO PINCH FINGERS. DO NOT PUSH HARD.**

Final having made sure the tent material is completely dry return your fold up tent to its storage bag.