

Customer Name: Kmart Australia		Box Size: W14.85 x H21cm	
Brand Name: ANKO		Box Type: IM	
Country:	Version: 2021	Color: <b>K</b>	
Item No: 864		Pantone:	
Date: 16Sep21		Designer: Jackson	

anko

# Paint Your Own Fairy Stepping Stone

8+ years

## Instructions



1 Clean the fairy stepping stone with a cloth. Once clean, paint on it with the provided brush and paint.

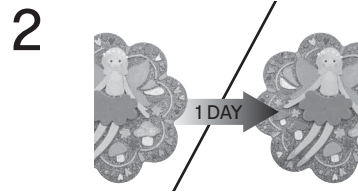

2 After you have finished painting, please allow the fairy stepping stone to dry for 24 hours.



3 Place the fairy stepping stone in an oven (normal gas or electrical), but NOT a microwave.

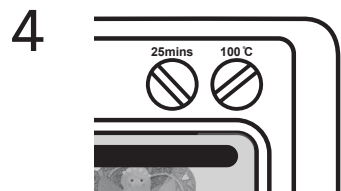

4 Heat the fairy stepping stone in the oven with the temperature of 100°C / 212°F for around 25 minutes. Do not take it out immediately.

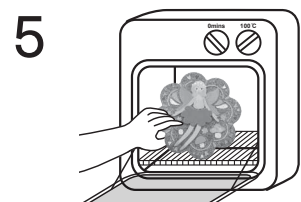

5 After cooling off, take the fairy stepping stone out of your oven using oven gloves.



6 Your fairy stepping stone is now complete!

## PREPARATION:

1. Wear a protective apron or art smock at all times.
2. Refer to the packaging box as inspiration when painting, or create your own design.
3. Always use newspaper or a protective cover on your work area before you start painting.
4. Ensure the paint lids are closed after use.
5. Thoroughly wash the paint brush with water after each use and before dipping it into another paint tub.

## CAUTION:

1. Before you place the stepping stone in the oven, ensure it has dried for 24 hours after you have finished painting. Paint colours will be dull if it is not completely dry.
2. Ensure to let your stepping stone cool down before removing it from the oven as it is very hot.
3. Only use a normal gas or electrical oven, NOT a microwave.

## TIPS:

1. Add a few drops of water to the paint pots if they look too dry or lumpy.
2. Mix different paints together to create new colours.
3. If you make a mistake when you are painting, just wipe the paint off with a moist tissue or paper towel. Please note: The paint cannot be washed or wiped off easily once it has dried.
4. Allow the stepping stone to dry completely (min 24 hours) before use.

## NOTE:

Mixing Blue and Yellow will make a close shade to Green  
 Mixing Red and Blue will make a close shade to Purple

ATTENTION: ALL ART MATERIALS LIKE PAINT, MAY CAUSE STAINS. ALWAYS PROTECT CLOTHES, CARPET, WORK SURFACE, FURNITURE AND OTHER OBJECTS. ALWAYS USE A PROTECTIVE COVER TO PREVENT STAINS.  
 CAUTION: RINSE EYES IMMEDIATELY IF THE PAINT COMES INTO CONTACT WITH THEM. IF IRRITATION PERSISTS, SEEK MEDICAL ATTENTION.  
 CAUTION: ADULT SUPERVISION IS REQUIRED.  
 PRODUCT MAY VARY FROM IMAGE SHOWN.  
 PLEASE KEEP THE PACKAGING FOR FUTURE REFERENCE.

**WARNING:**  
**CHOKING HAZARD - Small parts.**  
 Not for Children under 3 years.

FRONT

BACK