

# **RGB ROCKER GAMING CHAIR**

## **User Manual**

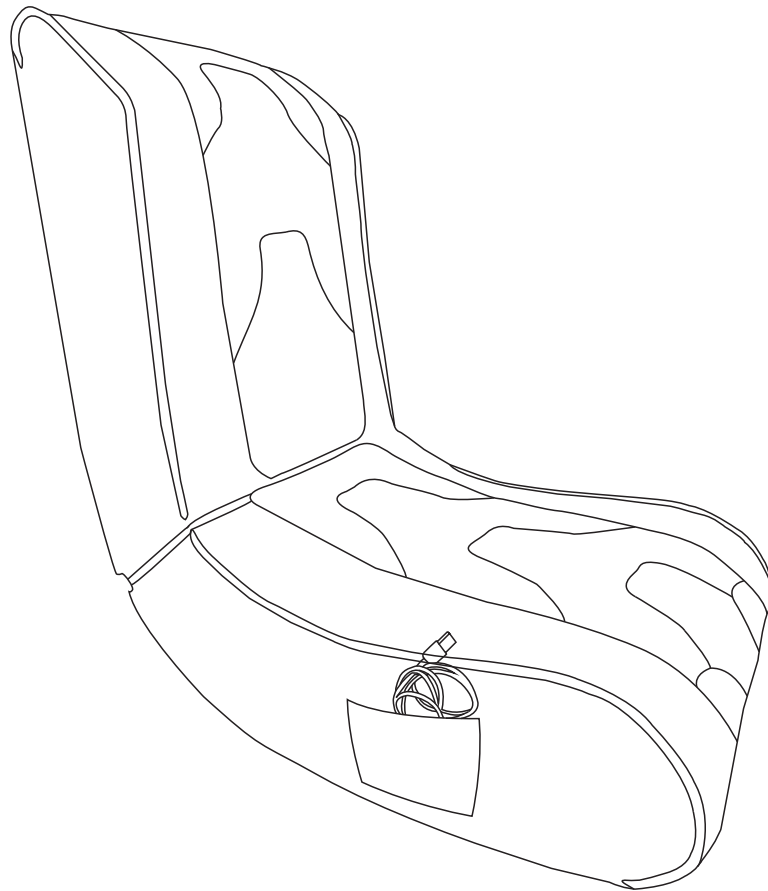

**Model No.: RC-01**

# How To Use

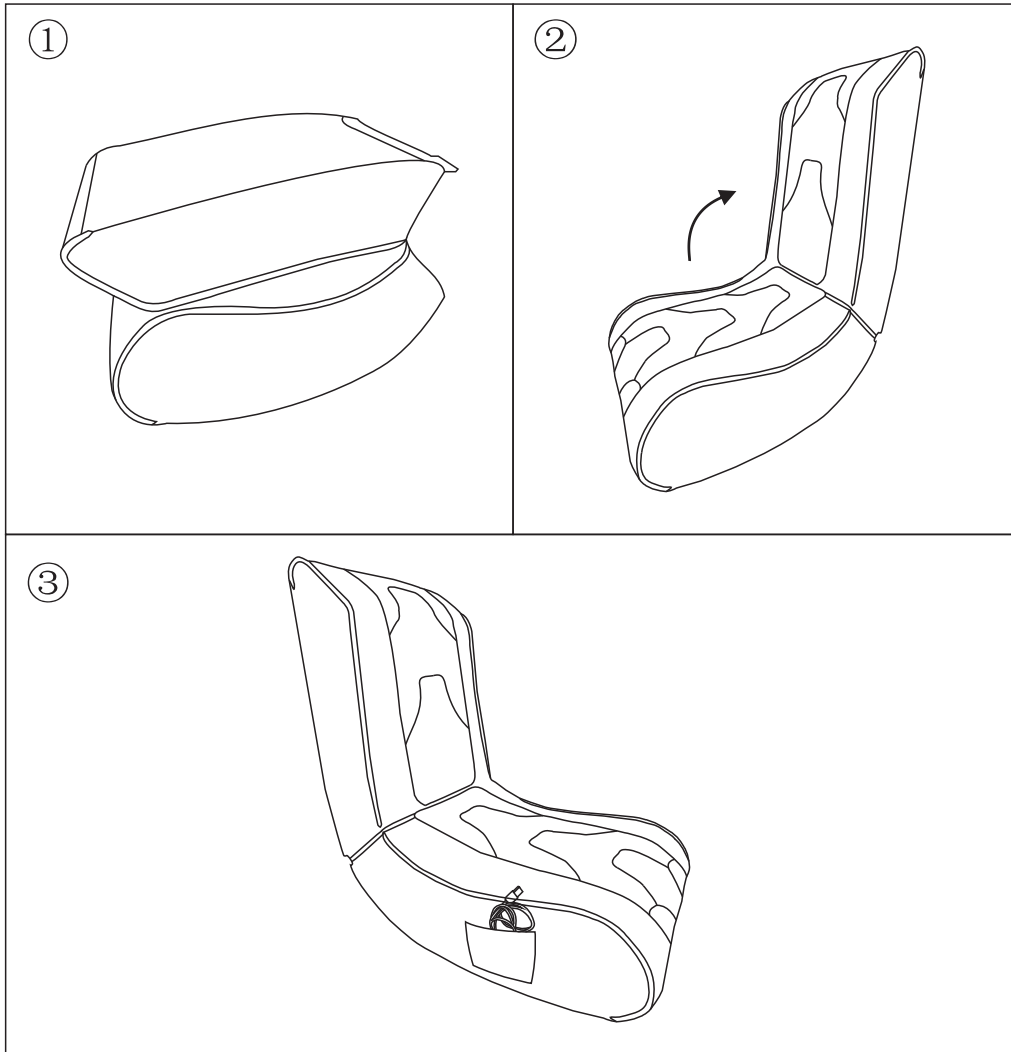

- Remove RGB Gaming Rocker Chair from the box.
- Unfold the chair and attach the Velcro strip to the rear of the chair, where back rest meets the base.
- Place RGB Gaming Rocker Chair on a smooth and horizontal surface, located near a USB power source.
- The USB power cable is in a pocket right side base of the RGB Gaming Rocker Chair. Insert the USB cable into a power source (such as a USB power adapter or power bank).
- The RGB light sequencing will start automatically.

# WARNING!

- DO NOT STAND ON THE CHAIR.
- USE FOR ONE PERSON ONLY.
- DO NOT USE THE CHAIR AS A STEP LADDER.
- TAKE CARE NOT TO GET FINGERS CAUGHT WHEN FOLDING/UNFOLDING THE CHAIR.
- FEET SHOULD REMAIN FIRMLY ON THE GROUND DURING USE.

**FAILURE TO FOLLOW THESE WARNINGS COULD RESULT IN SERIOUS INJURY.**

## Max safe load: 100kg

### Important Information

1. The USB cable of this chair cannot be replaced; the lighting function will not work if the cord is damaged.
2. The LED globes are not replaceable. When the globes reach their end of life the LED lighting will not work.
3. This product works with a DC 5V/2A USB port.
4. This product is for indoor use only.

### Care Instructions

- Wipe clean with a damp cloth.
- Do not use abrasive materials and solvents.
- Keep out of direct sunlight.
- Store in a dry place