

# anko

203 Litre Top Mount  
Refrigerator  
(Refrigerator / Freezer)

**Quick Start Guide**



Model no: ATM203W/ATM203S

Rev: 03

# A simple guide to start using your 203L Top Mount Refrigerator

## › Installation Tips

**Two person installation:** Use two or more people to move and install the appliance. Failure to do so can result in back or other injury.

**Freestanding design:** This appliance is designed to be freestanding only, and should not be recessed or built-in.

**Floor surface:** This appliance must be properly positioned on a dry, sturdy, level surface that is strong enough to support it when it is fully loaded.

**Ambient temperature:** The ambient temperatures must correspond to the climate class (T) indicated on the rating plate of the appliance: 16°C – 38°C.

**Clearances:** Ensure that air can circulate freely around the back of the cabinet, which is necessary to cool the compressor and condenser. Allow at least 10cm clear space at the back, 10cm at the sides of the unit and 30cm between the top and any surface above. If you are installing your refrigerator next to a fixed wall, leave sufficient space on the hinge side to allow for the door to swing open.

Note: For further installation instructions please refer to the user manual.

## › Temperature Control

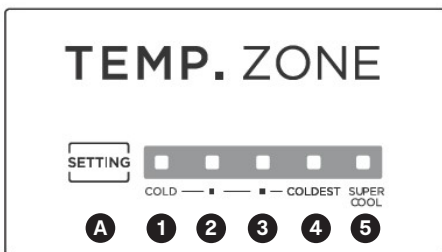

The temperature controls are located on the inside of the fridge. Use the SETTING button (A) to cycle through the temperature settings from COLD (1) to SUPER COOL (5).

- › 1: The warmest temperature setting
- › 2-3: Normal operation (adequate for most situations)
- › 4: The coldest setting for daily operation
- › 5: Super Cool is used to get to a colder temperature in a quicker timeframe

## › First Use

When starting up for the first time, keep the refrigerator still for 2 hours before connecting it to power supply.

Before putting any fresh or frozen foods in the fridge, ensure the fridge has run for 2-3 hours, or for at least 4 hours in summer when the ambient temperature is high.

## › Product Specifications

Capacity	203L
Dimensions (w,d,h)	545 x 610 x 1372mm
Net Weight	43kg
MEPS	3 Stars

## › Need Help?

For all questions or customer support please contact us using the details below.

Phone 1800 124 125 (Australia)

Online [www.kmart.com.au](http://www.kmart.com.au)

# anko

## 203 Litre Top Mount Refrigerator (Refrigerator / Freezer) Instruction Manual



Model no: ATM203W/ATM203S

Rev: 03

# Purchase Details



For future reference, please record the following information which can be found on the rating plate and the date of purchase which can be found on your sales invoice.

The rating plate is located on the rear of the appliance. Therefore please fit the duplicate data plates or label on the outside of the cupboard to sure that the label can be easily seen during operation.

---

## STORE DETAILS

---

STORE NAME |

ADDRESS |

TELEPHONE |

PURCHASE DATE |

---

## PRODUCT DETAILS

---

MODEL NO. |

SERIAL NO.\* |

<b>Contents</b>	<b>2</b>	<b>Purchase Details</b>
	<b>4</b>	<b>General Safety Instructions</b>
	<b>7</b>	<b>Your Top Mount Fridge</b>
	<b>8</b>	<b>Installation Instructions</b>
	<b>10</b>	<b>Using Your Fridge</b>
	<b>11</b>	<b>Usage Tips</b>
	<b>11</b>	<b>Energy Saving Tips</b>
	<b>12</b>	<b>Maintenance and Cleaning</b>
	<b>17</b>	<b>FAQ'S and Troubleshooting</b>
	<b>18</b>	<b>Product Specifications</b>
	<b>19</b>	<b>Warranty</b>

---

To ensure proper operation of this device, please read this instruction manual carefully before using the device and keep it for future reference.

# General Safety Instructions

## IMPORTANT SAFETY INSTRUCTIONS READ CAREFULLY AND KEEP FOR FUTURE REFERENCE

Read this manual thoroughly before first use, even if you are familiar with this type of product. The safety precautions enclosed herein reduce the risk of fire, electric shock and injury when correctly adhered to.

Make sure you understand all instructions and warnings.

Keep the manual in a safe place for future reference, along with the completed warranty card and purchase receipt. If you sell or transfer ownership of this product, pass on these instructions to the new owner.

Always follow basic safety precautions and accident prevention measures when using an electrical appliance, including the following:

**IMPORTANT:** Pay particular attention to messages that contain the words **DANGER**, **WARNING** or **CAUTION**. These words are used to alert you to a potential hazard that can seriously injure you and others. The instructions will tell you how to reduce the chance of injury and let you know what can happen if the instructions are not followed.



**CAUTION  
RISK OF FIRE**

This symbol alerts you to take care as this appliance contains a flammable refrigerant (isobutane) and insulation blowing gas (cyclopentane). Do not expose it to high heat, sparks and open flames.

The refrigerant isobutane (R600a) is contained within the refrigerant circuit of the appliance, a gas with a high level of environmental compatibility, which is nevertheless flammable. During transportation and installation of the appliance, ensure that none of the components of the refrigerant circuit become damaged.

**WARNING:** Do not damage the refrigerant circuit! Never use an appliance with a damaged refrigerant circuit! If the refrigerant circuit becomes damaged, avoid proximity to open fires and all types of heat and ignition sources. Thoroughly ventilate the room in which the appliance is located.

**DANGER:** It is hazardous for anyone other than an authorised service person to service this appliance. In Queensland, the authorised service person MUST hold a Gas Work Authorisation for hydrocarbon refrigerants to carry out servicing or repairs which involve the removal of covers. The room for installing the appliance must be at least 1m<sup>3</sup> per 8g of refrigerant. The amount and type of refrigerant in the appliance can be found in the Technical Specifications on page 17 and on the rating plate, found on the appliance.

### Usage Conditions and Restrictions

- › **Domestic use only:** This appliance is intended for indoor household use only. It is not intended for commercial, industrial or outdoor use. It is not intended for use in a recreational vehicle.
- › **Purpose:** Do not use this appliance for anything other than its intended purpose. Other uses are not recommended and may cause fire, electric shock or personal injury.
- › **Attachments:** The use of attachments is not recommended by the appliance manufacturer and distributor as they may be hazardous.
- › **Improper use:** Damage due to improper use, or repairs made by unqualified personnel will void your warranty. We assume no liability for any eventual damages caused by misuse of the product or noncompliance with these instructions.

**Never use this appliance with a damaged refrigerant circuit!** If the coolant circuit becomes damaged, avoid proximity to open fires and all types of heat sources. The room in which the appliance is located should be ventilated for a few minutes.

# General Safety Instructions

## General Safety Instructions Cont.

- › **WARNING:** Do not use mechanical devices or other means to accelerate the defrosting process, other than those recommended by the manufacturer.
- › **Usage restriction:** This appliance is not intended for use by persons (including children) with reduced physical, sensory or mental capabilities, or lack of experience and knowledge, unless they have been given supervision or instructions concerning use of the appliance by a person responsible for their safety.
- › **Children:** Supervise young children to ensure they do not play with the appliance. Never allow children to operate, play with or crawl inside the appliance.
- › **WARNING:** Do not use electrical appliances inside the appliance, unless they are of the type recommended by the manufacturer.
- › **Explosive or flammable substances:** Do not store explosive substances such as aerosol cans with a flammable propellant in this appliance. Do not store or use petrol or any other flammable vapours and liquids in the vicinity of this or any other appliance. Do not use such substances for cleaning the appliance. The fumes can create a fire hazard or an explosion.
- › **Damage:** Do not use the appliance if the power cord, plug or the appliance itself is damaged. If the cord is damaged, contact the after sales support line and have the cord replaced by qualified personnel in order to avoid a hazard.
- › **WARNING:** Do not damage the refrigerant circuit.
- › **Do not modify:** Do not attempt to alter or modify this appliance in any way.
- › **Repair:** Do not attempt to repair or replace any part of this appliance unless it is specifically recommended in this manual. All other servicing should be referred to a qualified technician. Contact the after sales support line for advice.
- › **WARNING:** Do not locate multiple portable socket-outlets or portable power supplies at the rear of the appliance

## Electrical Safety

- › **Voltage:** Before connecting and turning on the appliance, ensure the electrical voltage and circuit frequency correspond to that indicated on the appliance rating label.
- › **Earthing:** This appliance should be properly earthed for your safety. The power cord of this appliance is equipped with a three-prong plug for use in standard wall outlets to minimise the possibility of electrical shock. Do not modify the cord and/or plug provided with the appliance. Improper use of the earthed plug can result in the risk of electric shock.
- › **Connection:** This appliance requires a standard 220-240 V AC 50Hz electrical outlet. Do not overload the electrical circuit.
- › **Power cord:** Do not kink or damage the power cord; do not leave it exposed or dangling. Secure it at the back of the appliance so no one steps on or places anything on the cord or against it. Keep the cord out of reach of children. When moving the appliance, make sure not to damage the power cord.
- › **WARNING:** When positioning the appliance, ensure the supply cord is not trapped or damaged.
- › **Auxiliary Items:** Do not use an inverter, adaptor or extension cord with this appliance. If the cord is too short, have a qualified electrician install an outlet near the appliance. Use of an extension cord and an inverter can negatively affect the performance of the unit.
- › **Protect from moisture:** To protect against the risk of electric shock, do not immerse the unit, cord or plug in water or spray it with any other liquid. Do not connect or disconnect the electric plug when your hands are wet. Turn the power switch off before removing the plug from the socket.
- › **WARNING: Disconnect!** To reduce the risk of fire, electric shock or personal injury, always unplug the appliance from the socket when not in use, when moving and before cleaning or servicing. Never unplug the unit by pulling the power cord. Always grip the plug firmly and pull straight out from the power point.
- › **Electrical work:** Any electrical work required for the installation of this appliance should be carried out by a qualified electrician.

# General Safety Instructions

## General Safety Instructions Cont.

### Installation

**Heavy:** This appliance is heavy, take care when moving it. To avoid back or other injury, consider a two person lift or mechanical aid when installing it. Failure to do so can result in back or other injury.

**Damage:** When unpacking, check the appliance carefully for damage. If it is damaged, do not install the appliance. Contact our after sales support centre on 1300 43 57 for advice on examination or return of the damaged appliance.

**Protect from moisture:** Install the appliance in an indoor area protected from wind, rain, water spray or drips.

**Protect from heat:** Do not install the appliance next to an oven, grill or other source of high heat, or where it will be exposed to direct sunlight for prolonged periods of time.

**WARNING: Ventilation:** To ensure proper ventilation, keep any ventilation openings, in the appliance enclosure or in the built-in structure, clear of obstructions. Ensure adequate air circulation around the appliance to prevent overheating.

**Level:** Install the appliance level in order to ensure proper operation.

### Cleaning and Maintenance

**Disconnect:** Unplug the appliance before cleaning or servicing. Failure to do so can result in electric shock, injury or death. Do not connect or disconnect the plug when your hands are wet.

**Flames:** Do not let open flames or ignition sources enter the appliance.

**Flammable/explosive substances:** Never clean this appliance with flammable fluids. Do not store or use volatile, flammable or explosive propellants or liquids in or close to this or any other appliance. The fumes can create a fire hazard or explosion.

**Solvents:** Do not use solvent based cleaning agents or abrasives on the interior as these may damage or discolour the surfaces of the appliances.

**WARNING!** Do not use mechanical devices or other means to accelerate the defrosting process.

Never use a sharp or metal instrument to remove frost or clean the appliance. Use a plastic scraper, if necessary.

**Service:** Do not attempt to repair, modify or replace any part of the appliance unless specifically recommended in this manual. Refer all other servicing to a qualified technician, or contact the after sales support line for advice on examination or repair of the appliance.

### Responsible disposal

**Note:** At the end of its working life, do not throw this appliance out with your household rubbish.

Electrical and electronic products contain substances that can have a detrimental effect on the environment and human health if disposed of inappropriately. Observe any local regulations regarding the disposal of electrical consumer goods and dispose of it appropriately for recycling and recovery of the refrigerant and blowing agent. Contact your municipal authorities for advice on recycling facilities in your area.

**WARNING!** This refrigeration appliance contains flammable refrigerants and insulation blowing gases, which must be removed before disposal. Contact your municipal authorities for any codes or regulations concerning the disposal of such materials.



# Your Top Mount Fridge

## Your Top Mount Fridge

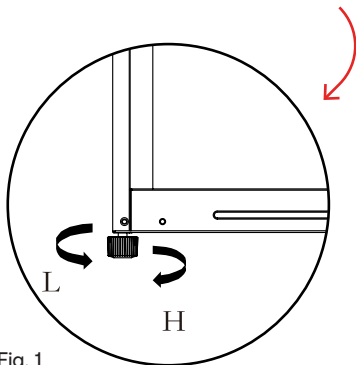
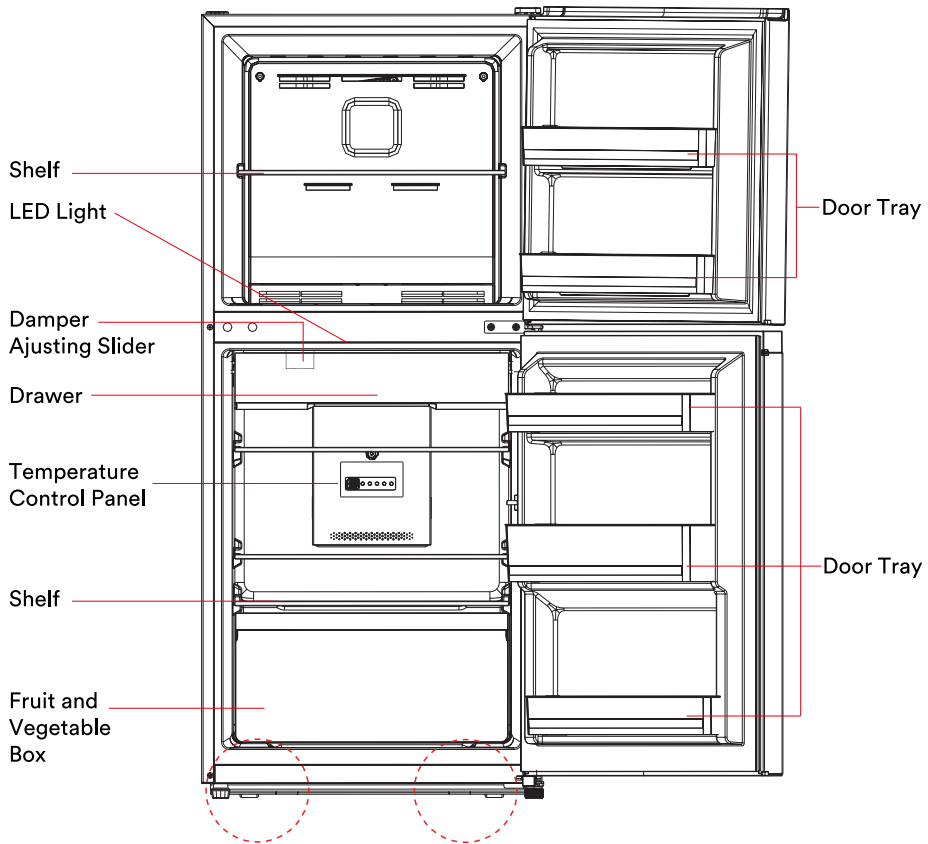

Fig. 1

Adjusting procedures:  
a. Turn the feet clockwise to raise the refrigerator;  
b. Turn the feet counterclockwise to lower the refrigerator;  
c. Adjust the right and left feet based on the procedures above to a horizontal level.

# Installation Instructions

## Unpacking

- › **Packaging materials:** This appliance has been packaged to protect it against transportation damage. Remove all packaging materials from around and inside the appliance and keep the original packaging carton and materials in a safe place. It will help prevent any damage if the product needs to be transported in the future, and you can use it to store the appliance when it is not in use. In the event the carton is to be disposed of, please recycle all packaging materials where possible.
- › **Suffocation:** Plastic wrapping can be a suffocation hazard for babies and young children, so ensure all packaging materials are out of their reach and disposed of safely.
- › **Power cord:** Unwind the power cord to its full length and inspect it for damage. Do not use the appliance if it or its cord have been damaged or are not working properly. In case of damage, contact our after sales support line for advice on examination, repair or return of the damaged product.
- › **Read the manual:** Read this manual to familiarise yourself with the appliance. Pay particular attention to the safety instructions on the previous pages.
- › **Clean:** To remove any dust from transit and storage, clean the interior and exterior surfaces of the appliance with lukewarm water and a soft cloth. Dry thoroughly. **Important:** do not use harsh or abrasive detergents or powders as these will damage the finish.
  
- › **Two person installation:** Use two or more people to move and install the appliance. Failure to do so can result in back or other injury.
- › **Freestanding design:** This appliance is designed to be freestanding only, and should not be recessed or built-in.
- › **Floor surface:** This appliance must be properly positioned on a dry, sturdy, level surface that is strong enough to support it when it is fully loaded.
- › **Ambient temperature:** The ambient temperatures must correspond to the climate class (T) indicated on the rating plate of the appliance: 16°C – 38°C
- › **Clearances:** Ensure that air can circulate freely around the back of the cabinet, which is necessary to cool the compressor and condenser. Allow at least 10cm clear space at the back, 10cm at the sides of the unit and 20cm between the top and any surface above (i.e. a bench top). If you are installing your refrigerator next to a fixed wall, leave sufficient space on the hinge side to allow for the door to swing open.

**Do NOT** install/use the appliance in the following locations/situations:

- › In moist areas or areas of high humidity.
- › In a recreational vehicle, or for use with an inverter.
- › In direct sunlight, near heat sources, next to an open flame, cooking or heating appliance, or near any other source of high heat.
- › Direct sunlight may affect the acrylic coating and heat sources may increase the unit's power consumption. For best energy efficiency install the appliance in the coolest area of the room.
- › In an area with extreme cold ambient temperatures.
- › In an area with excessive moisture and high humidity. Make sure it is protected from elements such as wind, rain, water spray or drips.
- › In an area where petrol or other explosive and/or flammable liquids or fumes are used or stored. The fumes can create a fire hazard or explosion.

## Levelling the Fridge (see Fig. 1)

- a. Turn the feet clockwise to raise the refrigerator;
- b. Turn the feet counterclockwise to lower the refrigerator;
- c. Adjust both feet so the refrigerator is level.

# Installation Instructions

## Installation Cont.

### Electrical connection

- › **WARNING!** It must be possible to disconnect the appliance from the mains power supply; the plug must therefore be easily accessible after installation.
- › Before plugging in your new fridge, let it stand upright for at least 2 hours. This will allow the refrigerant gases to settle into the compressor and reduce the possibility of a malfunction in the cooling system.
- › The appliance must be earthed. The plug of the power supply cord is equipped with a contact for this purpose. Do not under any circumstances cut or remove the third (earth) prong from the power cord. If the plug does not fit your outlet, consult a licensed electrician for advice to have the outlet changed.
- › Plug the unit into a dedicated, properly earthed wall outlet. Ensure that your outlet voltage and circuit frequency correspond to the voltage stated on the rating label.
- › Secure the fridge's supply cord behind the unit. Do not leave it exposed or dangling to prevent injury and accidental disconnection from the power supply.
- › Adjust the temperature control as described below.
- › When first starting up, and after a period out of use, allow the unit to cool down for at least 2-3 hours (4 hours if starting up during warm weather in summer) before placing food in the fridge.

# Using Your Fridge

The temperature controls are located on the inside of the refrigerator.

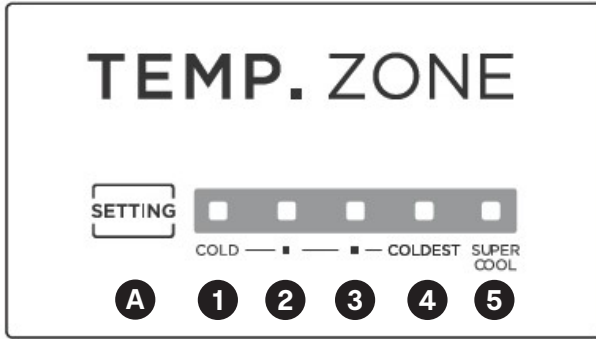

## The Thermostat Controls

A) Setting: Use this button to cycle through the temperature settings from COLD - SUPER COOL

- › 1: The warmest temperature setting
- › 2-3: Normal operation (adequate for most situations)
- › 4: The coldest setting for daily operation
- › 5: Super Cool is used to get to a colder temperature in a quicker timeframe

Note: During high ambient temperatures (i.e. on hot summer days) it may be necessary to set the thermostat to the coolest setting (position 5). This may cause the compressor to run continuously in order to maintain a low temperature.

## Damper Adjusting Slider

The initial position of the damper adjusting slider is on the far right side.

For better user experience, it is recommended to push the slider to the right position and turn the SETTING KEY to MID position. If it is not enough cool inside the refrigerator compartment, please check whether the slider is in left position, turn the slider to the right side.

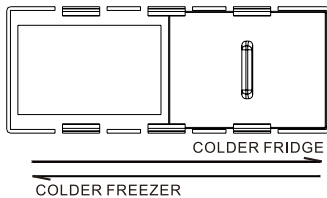

## Using for the First Time

When you install your appliance, set the thermostat to setting 3. Give your refrigerator time to cool down completely before adding food. It is the best to wait 24 hours before adding food.

**IMPORTANT:** Once the unit has started, continuous operation is recommended. Please try and avoid turning the unit off and on as this may affect the service life.

## Usage Tips

- › Do not store food uncovered in the fridge. Always use good quality, fridge-proof packaging to maintain food quality. Remove air from packages of solid food and seal bags tightly before freezing.
- › Keep portions small to ensure they are frozen (and subsequently defrosted) rapidly.
- › Make sure that fresh, unfrozen food packages do not touch food that is already frozen, thus avoiding a temperature rise in the frozen food.
- › When freezing food, do not push food together too much, leave some space for air to circulate around each item. Do not place packages directly against the back wall.
- › When buying frozen food, only buy quantities that you can store straight away; use an insulated container for your shopping and when you get home, place the food in the chilling compartment immediately.
- › When storing pre-packed, commercially frozen food, follow the food manufacturer's instructions for storing the food in a home fridge or freezer. Do not exceed any storage times listed on the packaging.
- › Once you have opened a packet of frozen food, re-wrap it airtight to prevent surface evaporation which causes drying or freezer burn.
- › Do not place carbonated liquids such as bottles of fizzy drink in the chilling compartment as the container could explode under pressure and damage the chiller.
- › Do not refreeze food once it has been defrosted.
- › Frozen food which has thawed accidentally should either be used immediately or thrown away. Alternatively, if the food is uncooked and has not been completely defrosted, it may be cooked and then refrozen.
- › **CAUTION!** Do not remove items from the chilling compartment if your hands are damp or wet as this could cause skin abrasions.

## Energy Saving Tips

- › The appliance should be placed in the coolest area of the room, away from heat producing appliances or heating ducts. Please avoid placement in direct sunlight.
- › Let hot foods cool to room temperature before placing them in the appliance.
- › Do not overload the appliance with unfrozen food as this may cause it to freeze slowly and risk food spoilage.
- › Be sure to wrap foods properly and wipe containers dry before placing them in the appliance. This cuts down on frost building up inside in the unit.
- › Please do not wrap items in aluminium foil, wax paper or paper towel. This materials interfere with cold air circulation, making the appliance less efficient.
- › Organise and label food to reduce door openings and extended searches. Remove as many items as needed at one time, ensuring the unit is opened as few times as possible.

# Maintenance and Cleaning

## Defrosting

The refrigerator has an automatic defrosting function. Frost formed due to change of season or temperature may also be manually removed by disconnecting the appliance from power supply. Alternatively, wipe the surface with a dry towel.

## Cleaning

### WARNING

Before cleaning the appliance, make sure it is switched off and disconnected from the power supply. Failure to do so can result in electric shock or injury.

- › Wash the inside surfaces and the interior accessories with a damp, warm cloth moistened in a water and baking soda solution. The solution should be about 2 tablespoons of baking soda to 1 litre of water. Rinse and wipe dry with a soft cloth.
- › Clean the outside of the unit with a damp, well wrung out cloth, keeping the area of the controls dry. Keep the lid gasket (seal) clean.
- › **Never use boiling water to accelerate defrosting as it may damage the plastic components.**
- › Regularly check the appliance for defrost water. If necessary, clean the drain. If the drain is blocked, water will collect in the base of the appliance.
- › After cleaning/defrosting, push the drain plug in.
- › After everything is dry, place appliance back into service.
- › Allow approximately 1-2 hours for the cabinet to cool down again (depending on the length of time the appliance was disconnected from the power).

### WARNING

Never clean the unit with an abrasive, acid, oil or solvent based cleaning agent. Never use flammable fluids or sprays for cleaning as the fumes from these substances can create a fire hazard or Explosion.

# Maintenance and Cleaning

## Maintenance and Cleaning Cont.

### Service, repair and spare parts

Do not attempt to alter or modify this appliance in any way, or to repair or replace any part unless it is specifically recommended in this manual. All other servicing should be referred to a qualified technician. Contact our after sales support on 1300 11 43 57 for advice.

Our after sales support centre stocks a selection of spare parts for the Esatto 129L Fridge. To enquire about purchasing a part, call us on 1300 11 43 57 or email [support@residentiagroup.com.au](mailto:support@residentiagroup.com.au)

### Power Failure

Most power failures are corrected within a few hours and should not affect the temperature of your appliance if you minimise the number of times the door is opened. If the power is going to be off for a longer period of time, take proper steps to protect the contents.

### Reversing the Door

Please power off this appliance before reversing the door. Remove all food from door shelves.

1. Remove hole cover and the upper hinge cover.
2. Next, remove the screws of the upper hinge and then the upper hinge.
3. You can now lift the freezer door until it is separated from cabinet completely.

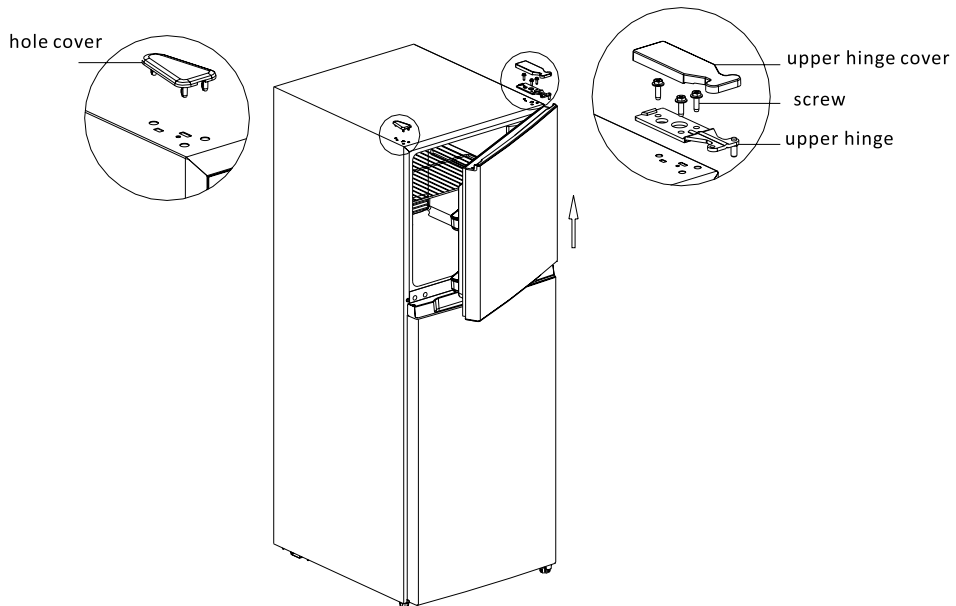

# Maintenance and Cleaning

## Maintenance and Cleaning: Reversing the Door Cont.

4. Unscrew the middle hinge screws to remove the middle hinge.
5. Next, remove the two hole plugs.
6. Remove the screw cap to remove the screw on the middle beam.
7. Now remove the refrigerator door.

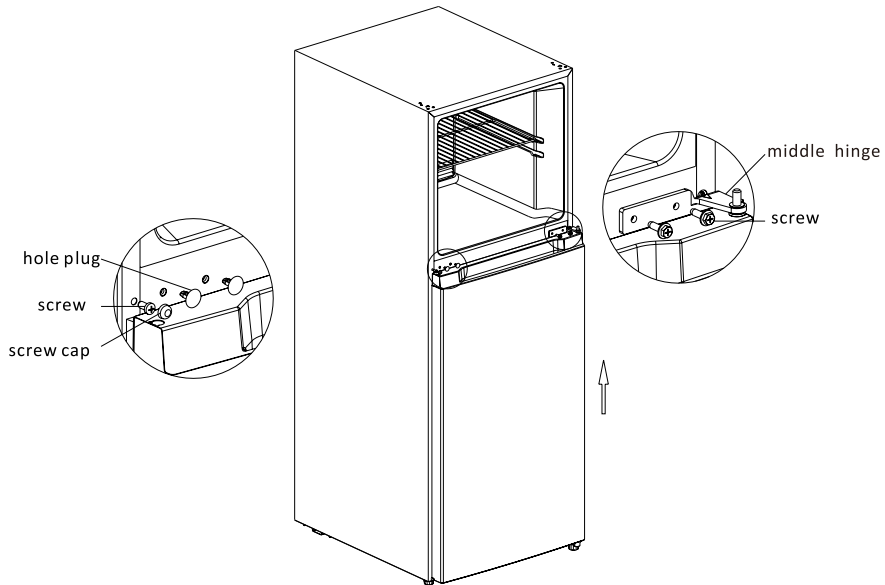

8. Remove the adjusting feet, lower hinge screw and lower hinge assembly.
9. Now install the lower hinge assembly on the opposite side of the unit and reinstall install the adjusting feet.

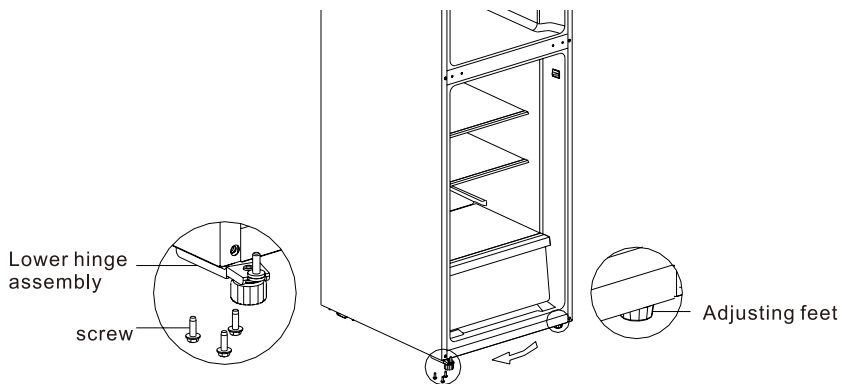



# Maintenance and Cleaning

## Maintenance and Cleaning: Reversing the Door Cont.

10. Dismantle the limit blocks and screws on the lower cover of both refrigerator door and freezer door.
11. Install the limit blocks on the other side of both doors
12. Then install the sleeve pipe on the upper cover of the refrigerator door on the other side.

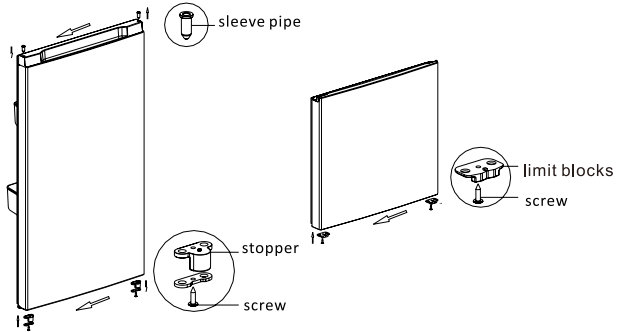

13. Install the compartment door on the lower hinge and then install Refrigerator the middle hinge and hole caps.

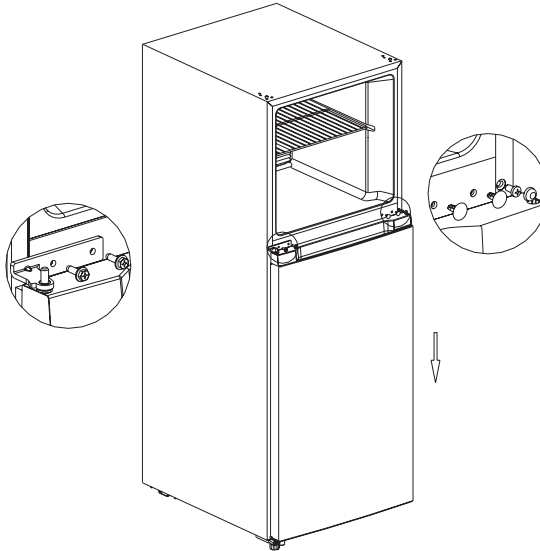

# Maintenance and Cleaning

## Maintenance and Cleaning: Reversing the Door Cont.

14. Finally, install the freezer door on the middle hinge and install the upper hinge, hinge cover and hole cover to finish.

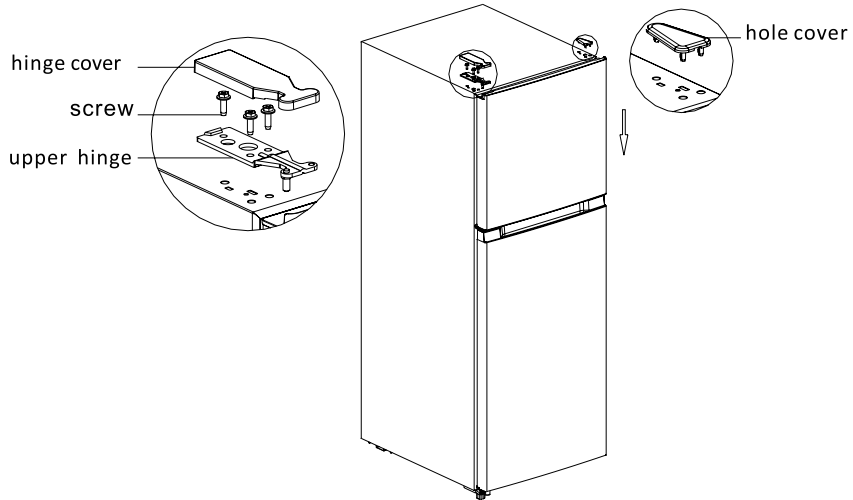

# FAQ'S and Troubleshooting

Problem	Possible Cause	Possible Solution
The appliance does not operate.	<ul style="list-style-type: none"> <li>› The appliance is not plugged in.</li> <li>› The appliance is turned off.</li> <li>› The circuit breaker tripped or a blown fuse.</li> </ul>	<ul style="list-style-type: none"> <li>› Plug in the appliance.</li> <li>› Turn on power point.</li> <li>› Reset circuit breaker/replace fuse.</li> </ul>
The appliance is not cold enough.	<ul style="list-style-type: none"> <li>› Check the temperature control setting.</li> <li>› The door is opened too often, or is kept open for too long; the door is not closed completely; hot food has been placed inside.</li> <li>› The appliance has recently been disconnected for a period of time.</li> </ul>	<ul style="list-style-type: none"> <li>› Reduce the temperature.</li> <li>› Do not open door for 2+ hours; Check that the door is closed properly and for any obstructions preventing the door closing properly; Remove hot food and let it cool first before replacing it.</li> <li>› Plug in the appliance.</li> </ul>
The appliance has an odd odour.	<ul style="list-style-type: none"> <li>› Food may not be wrapped properly.</li> <li>› Food may be rotten.</li> <li>› The interior may not be clean.</li> </ul>	<ul style="list-style-type: none"> <li>› Check that the food is wrapped tightly.</li> <li>› Check for rotten food and remove.</li> <li>› Clean the interior of the appliance.</li> </ul>
The internal light does not illuminate.	<ul style="list-style-type: none"> <li>› The appliance is not plugged in.</li> <li>› The appliance is turned off.</li> <li>› The circuit breaker tripped or a blown fuse.</li> <li>› The light is damaged.</li> </ul>	<ul style="list-style-type: none"> <li>› Plug in the appliance.</li> <li>› Turn on power point.</li> <li>› Reset circuit breaker/replace fuse.</li> <li>› Please contact after sales support.</li> </ul>
The door will not close properly.	<ul style="list-style-type: none"> <li>› The appliance is not level.</li> <li>› The gasket is dirty.</li> <li>› Food is stacked too high.</li> </ul>	<ul style="list-style-type: none"> <li>› Level the appliance.</li> <li>› Clean gasket with warm water and a soft cloth.</li> <li>› Re-position food so it does not obstruct.</li> </ul>
The door is difficult to open.	<ul style="list-style-type: none"> <li>› A difference in pressure between the air inside and outside of the unit.</li> </ul>	<ul style="list-style-type: none"> <li>› This is a normal phenomenon and cannot be avoided.</li> </ul>
Moisture forms on the inside appliance walls.	<ul style="list-style-type: none"> <li>› Hot and humid weather increases the internal rate of frost build-up.</li> <li>› The lid is slightly open.</li> <li>› The lid is kept open too long, or is opened too frequently.</li> </ul>	<ul style="list-style-type: none"> <li>› This is normal.</li> <li>› Close the door.</li> <li>› Open the door less often</li> </ul>
Moisture forms on the outside of the appliance.	<ul style="list-style-type: none"> <li>› The door is slightly open, causing cold air from inside the appliance to meet warm, moist air from the outside.</li> </ul>	<ul style="list-style-type: none"> <li>› Close the door or check for obstructions.</li> </ul>
There are vibrations.	<ul style="list-style-type: none"> <li>› The appliance is not level.</li> <li>› The floor is uneven or weak.</li> <li>› The appliance is touching the wall.</li> </ul>	<ul style="list-style-type: none"> <li>› Level the appliance.</li> <li>› Be sure your floor can adequately support the appliance.</li> <li>› Move the appliance away from the wall and check it is level.</li> </ul>

# Product Specifications

---

<b>Model:</b>	ATM203W / ATM203S
<b>Product Dimensions:</b>	W: 545mm, D: 610mm, H: 1372mm
<b>Weight:</b>	43kg
<b>Net Capacity:</b>	203L
<b>Energy Rating:</b>	3 Stars MEPS

---

## Standards

This product complies with AS/NZS 60335.1 and AS/NZS 60335.2.24 electrical safety, and with EN 55014-1:2006+A1:2009 A2:2011 for electromagnetic compatibility.

# Warranty

## 24 Month Warranty

Thank you for your purchase from Kmart.

Kmart Australia Ltd warrants your new product to be free from defects in materials and workmanship for the period stated above, from the date of purchase, provided that the product is used in accordance with accompanying recommendations or instructions where provided. This warranty is in addition to your rights under the Australian Consumer Law.

Kmart will provide you with your choice of a refund, repair or exchange (where possible) for this product if it becomes defective within the warranty period. Kmart will bear the reasonable expense of claiming the warranty. This warranty will no longer apply where the defect is a result of alteration, accident, misuse, abuse or neglect.

Please retain your receipt as proof of purchase and contact our Customer Service Centre on 1800 124 125 (Australia) or alternatively, via Customer Help at [Kmart.com.au](http://Kmart.com.au) for any difficulties with your product. Warranty claims and claims for expense incurred in returning this product can be addressed to our Customer Service Centre at 690 Springvale Rd, Mulgrave Vic 3170.

Our goods come with guarantees that cannot be excluded under the Australian Consumer Law. You are entitled to a replacement or refund for a major failure and compensation for any other reasonably foreseeable loss or damage.

You are also entitled to have the goods repaired or replaced if the goods fail to be of acceptable quality and the failure does not amount to a major failure.

Model no: ATM203W/ATM203S