

**Tiny
Terrace**

DIY

14+
years



PINK HOUSE



 **WARNING:**
CHOKING HAZARD - SMALL PARTS.
NOT FOR CHILDREN UNDER 3 YEARS.

43160907

Contents

Name	Material package	Page
Table	B bag+C bag+Printing Paper	Page 4
Chair	B bag	Page 4
Cabinet	B bag+C bag	Page 4
Refrigerator	B bag +Printing Paper	Page 5
Two-seat sofa	B bag+C bag+Printing Paper	Page 5
Table	B bag +Printing Paper	Page 5-6
Rocking-chair	B bag+C bag+Printing Paper	Page 6
Piano	B bag+C bag+Printing Paper	Page 6
Bed	B bag+C bag+Printing Paper	Page 6
Shelving	B bag +Printing Paper	Page 6-7
Hanging basket chair	B bag+C bag	Page 7
Hand-rinse basin	B bag +Printing Paper	Page 7
Potted plant	C Bag	Page 7
Potted plant	C bag +Printing Paper	Page 7-8
Potted plant	C Bag	Page 8
Potted plant	C bag +Printing Paper	Page 8
Potted plant	C bag +Printing Paper	Page 8
Watering Can	Printing Paper	Page 8
Slipper	Printing Paper	Page 8
Laptop	Printing Paper	Page 8
Stairs	B bag	Page 8
Outer frame	A bag +B bag+C bag+Printing Paper	Page 9

ASSEMBLY INSTRUCTIONS Pink House 43160907

Tips for Assembly

1. Pictures shown on the package may be slightly different from the actual product.
 2. Place remaining materials back into the original bag until the installation is complete.
(Avoids materials getting lost during installation)
 3. Not too much glue should be applied. If so, the drying time will be extended
 4. Children must assemble under the guidance of adults in case of swallowing
 5. All dimensions within the instruction are shown in millimeters (mm)
 6. Find the part you need according to material list and the 1: 1 part illustration paper (for wooden parts). Check its number and size carefully before assembling. See Part Number Explanation.
 7. Note which bags the parts are kept in based on the Material List when assembling and taking them out to use.
-

Glue



Liquid Glue

PVA Glue

(Both glue types can be used on all steps. Liquid glue can dry faster. Liquid glue is used to glue large wooden parts and other materials. PVA glue is to be used on lighter materials.)

Tools excluded

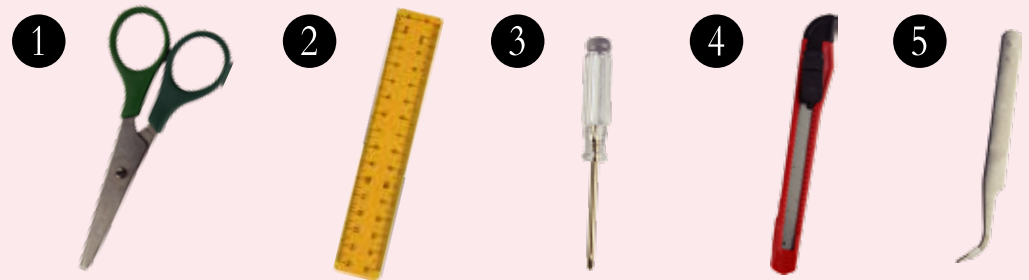

Scissors

Ruler

Screw Driver

Stanley Knife

Tweezers

Thumbnail of material list(reference only)



Symbol description used

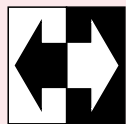

Install parts
in the opposite
direction



Install the same
parts on both
sides

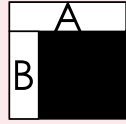

Pay attention to the direction
of installation material B
stick to material A

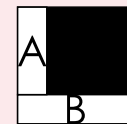
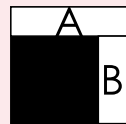

Pay attention to the direction
of installation material A
stick to material B

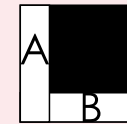
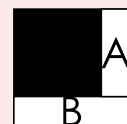

Pay attention to the direction
of installation material B
stick to material A

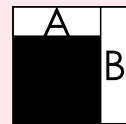
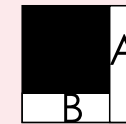

Pay attention to the direction
of installation material A
stick to material B

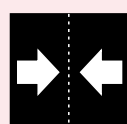
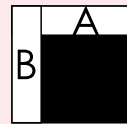

fold double edge
to center dotted
line

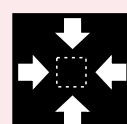

Fold four sides
to the middle

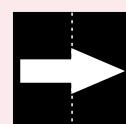

Fold in half
according
to dotted line



combination part
according 1 2 3 and so on.

Table

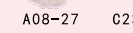
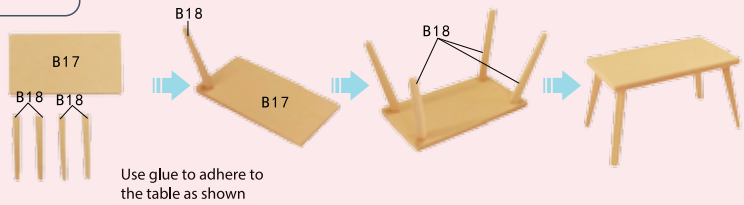

Stick beads to paper plate

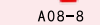

Fold the Milk box as per die line construction

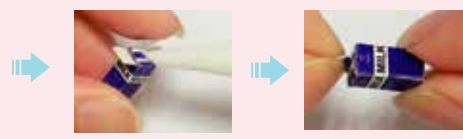

Chair

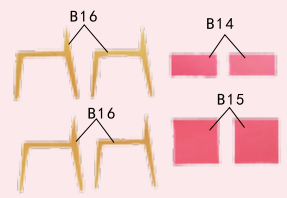

Construct wooden chair



Cabinet

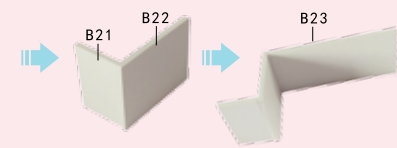
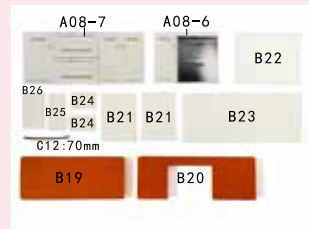

Use glue to adhere cabinet base

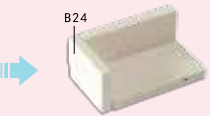
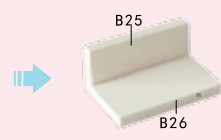

Use glue to adhere the cover of cabinet

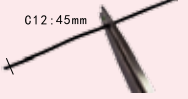

Use pliers to twist the metal wire

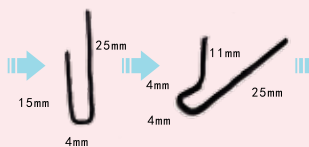

Construct the metal wire to the shape of water tap - shape in terms of an "s"

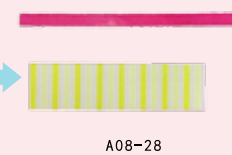
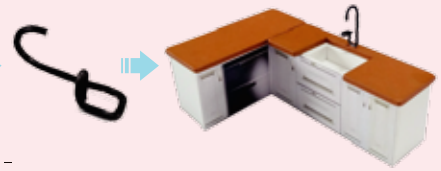

A08-28



Roll the paper and sticker as shown

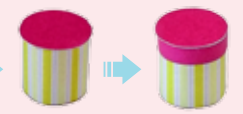

A08-47



Roll the paper and sticker as shown



A08-12



Fold the card and adhere the box



A08-48



Fold as per die line

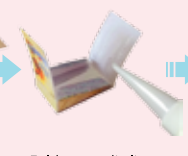

A08-18

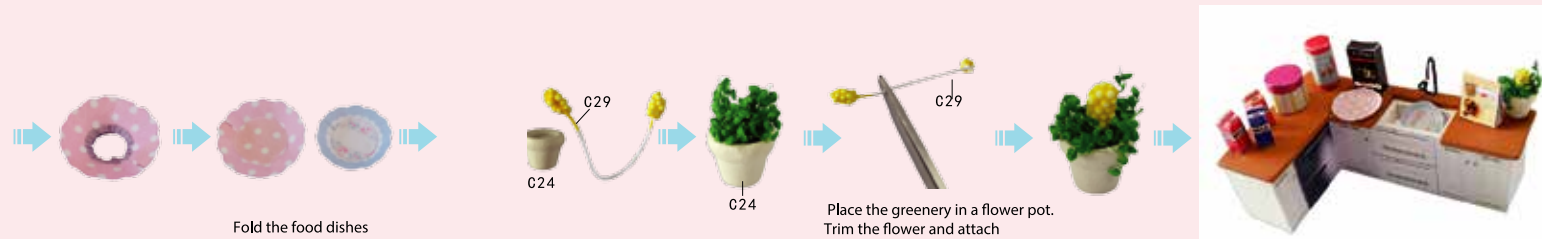

Fold the food dishes

Place the greenery in a flower pot.
Trim the flower and attach



Refrigerator

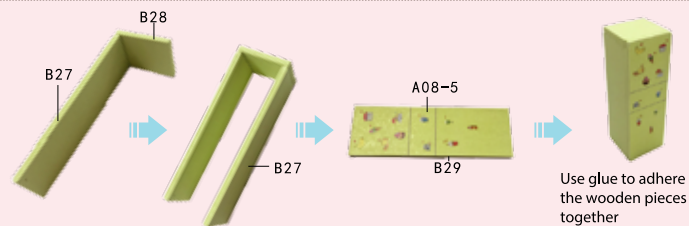

Use glue to adhere the wooden pieces together

Two-seat sofa

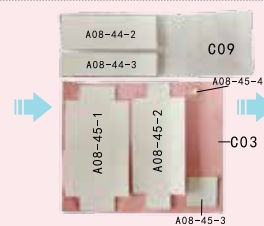
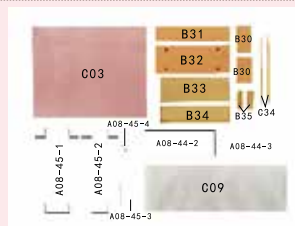

Overlay C03 with A08-45-2 and cut out according to the template

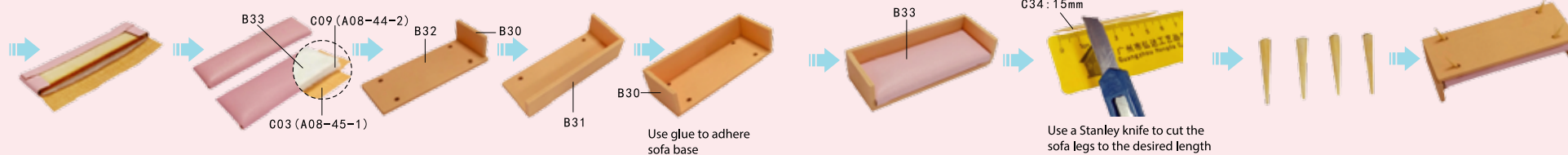

Use glue to adhere sofa base

Use a Stanley knife to cut the sofa legs to the desired length

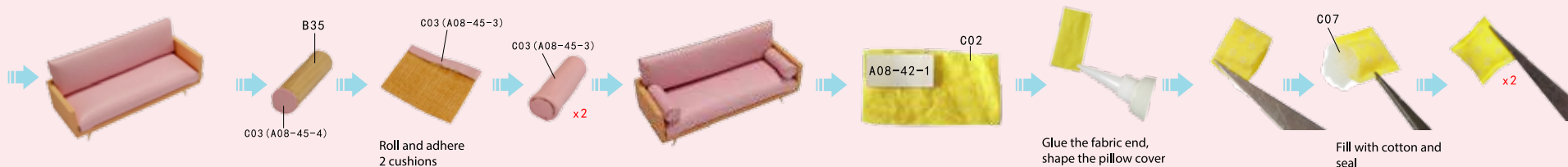

Roll and adhere 2 cushions

Glue the fabric end, shape the pillow cover

Fill with cotton and seal



Table

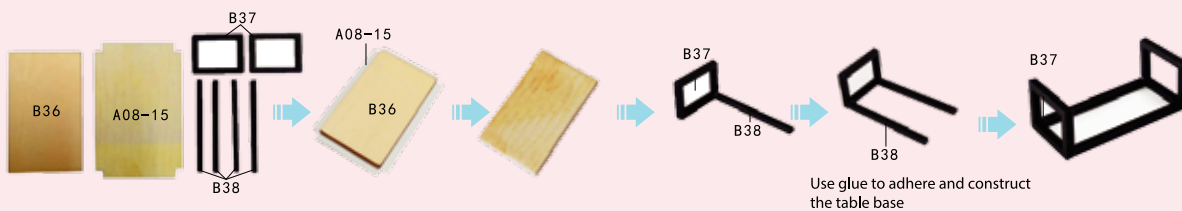

Use glue to adhere and construct the table base

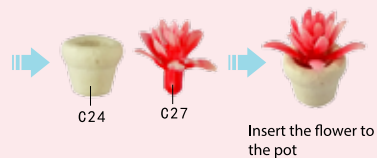

Insert the flower to the pot



Fold the book according to the die line



Rocking-chair

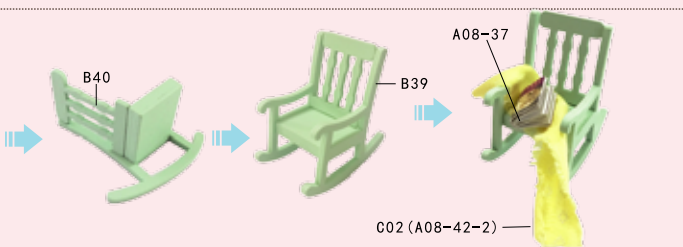
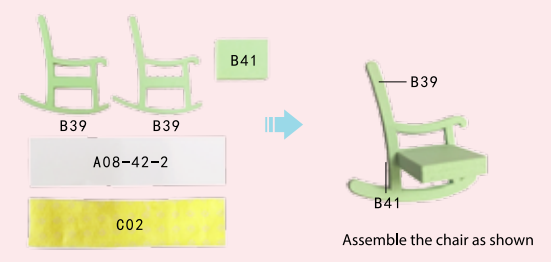

Piano

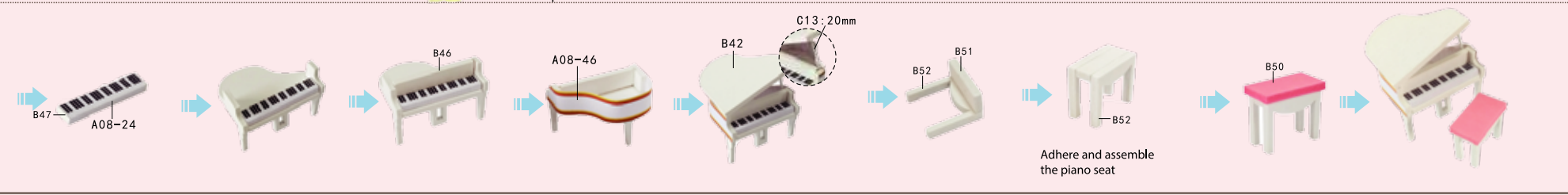
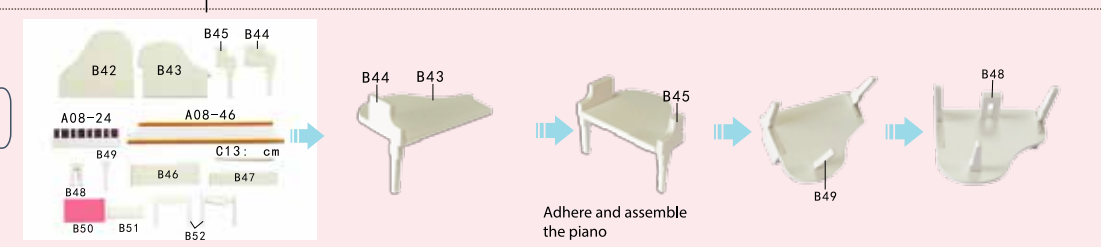

Bed

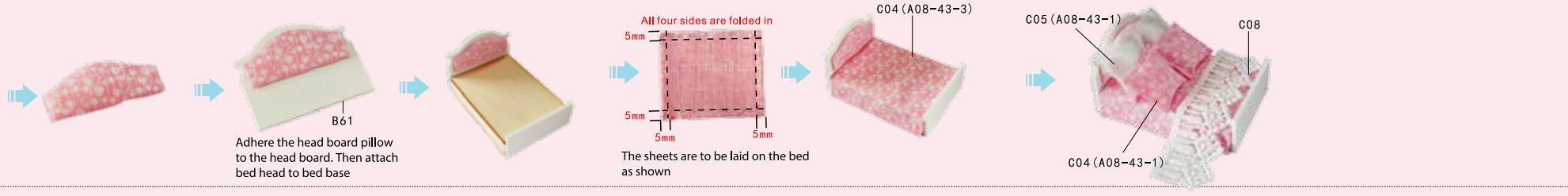
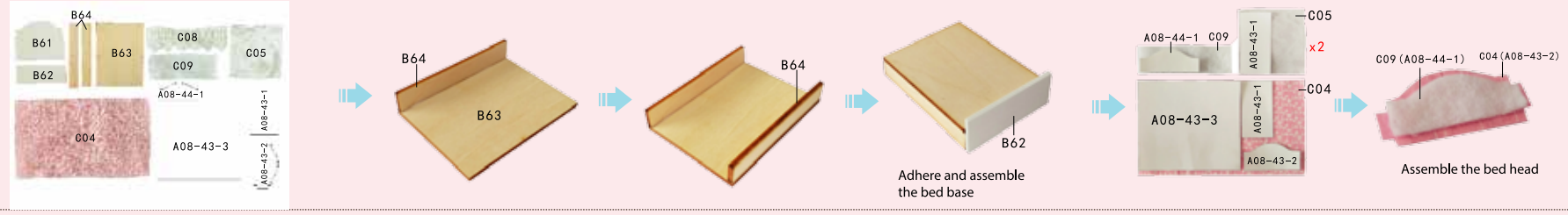

Shelving

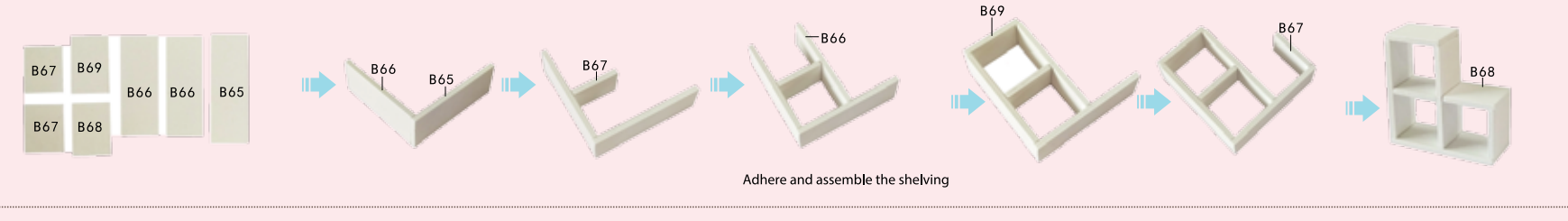

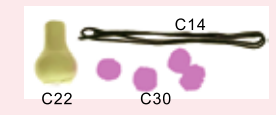
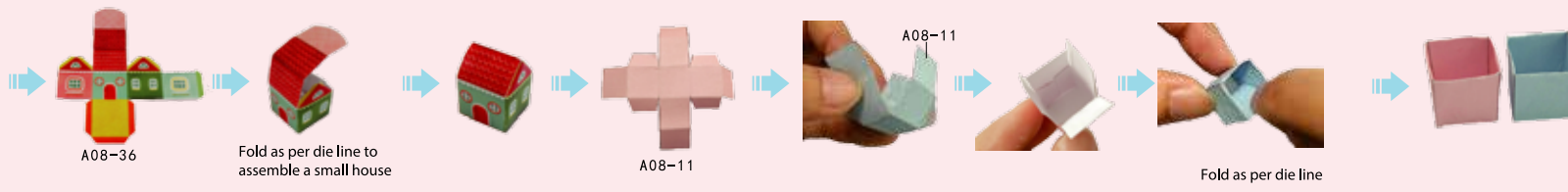

Hanging basket chair

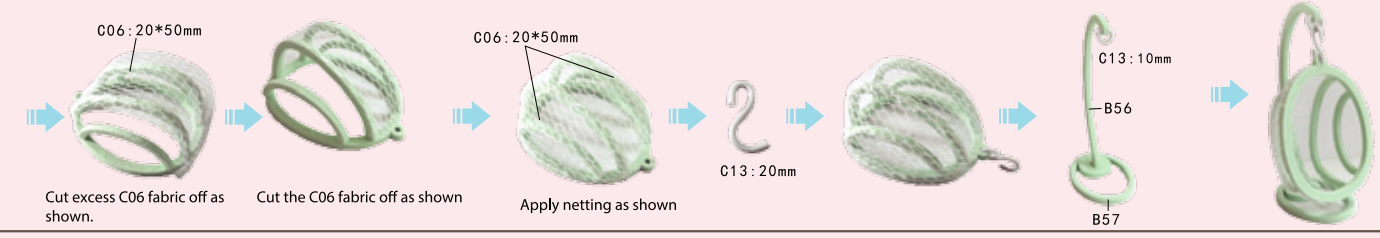
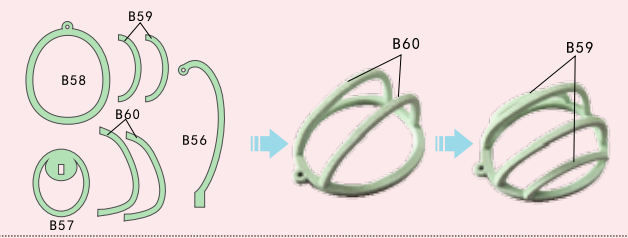

Assemble the basket to the chair

Hand-rinse basin

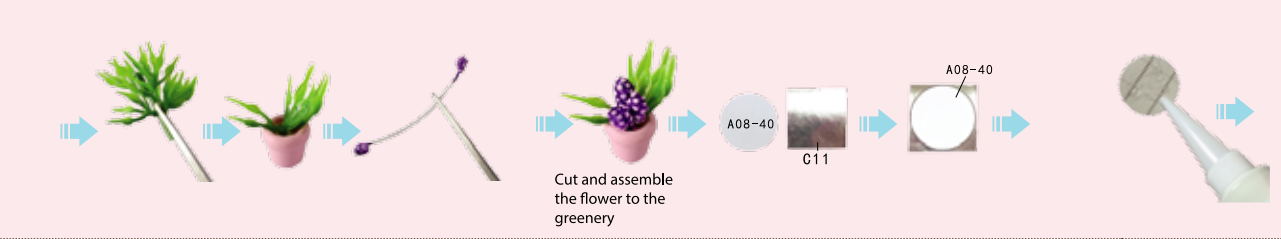
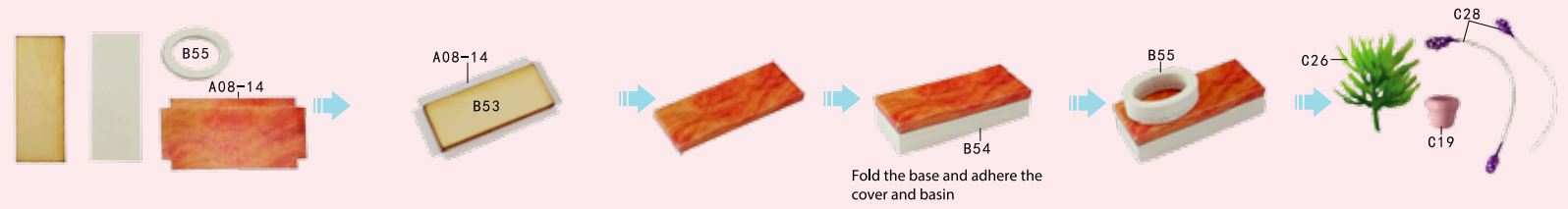

Potted plant

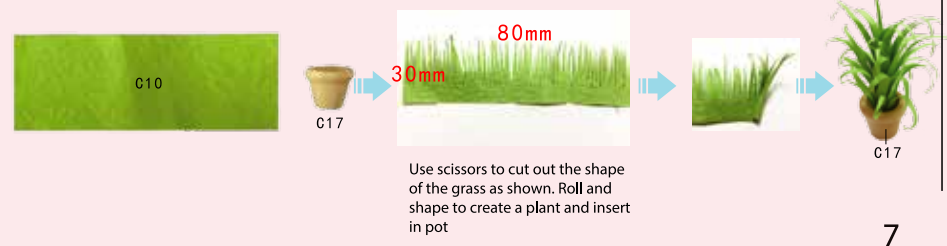

Potted plant

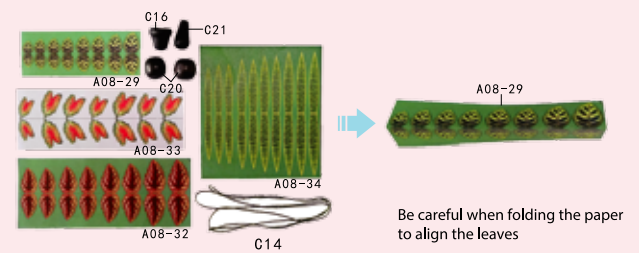

The 2 corners are folded and glued together as shown

Be careful when folding the paper to align the leaves

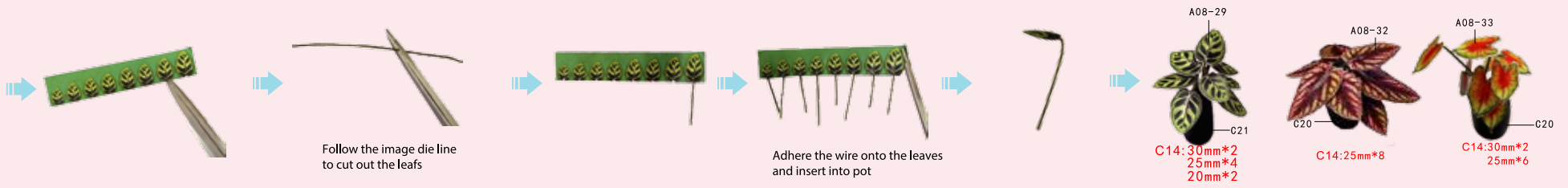

Potted plant

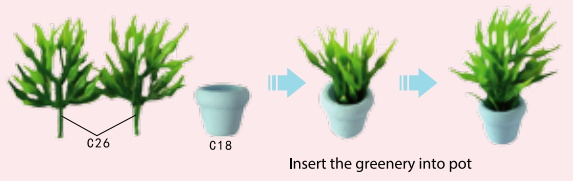

Potted plant

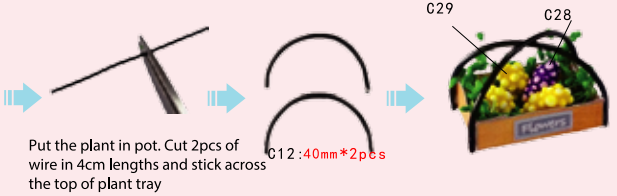
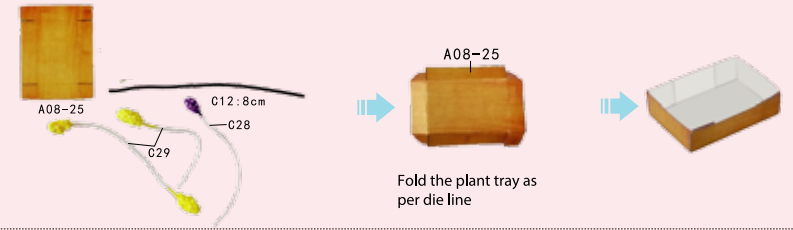

Potted plant



Watering can



Slipper

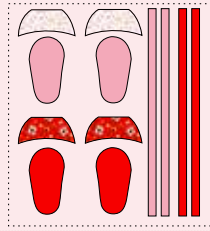

A08-20



Laptop



Stairs

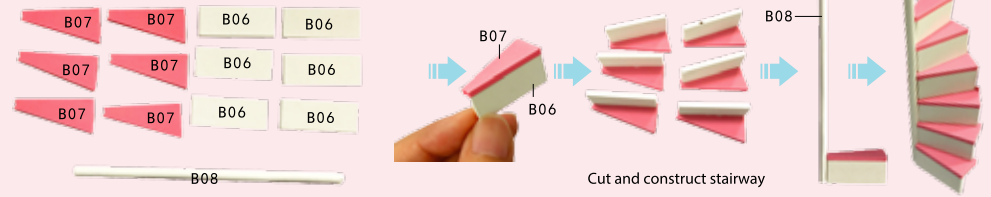

Outer frame

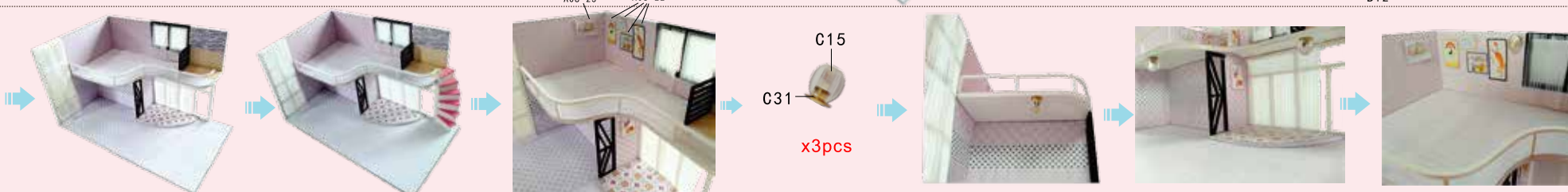
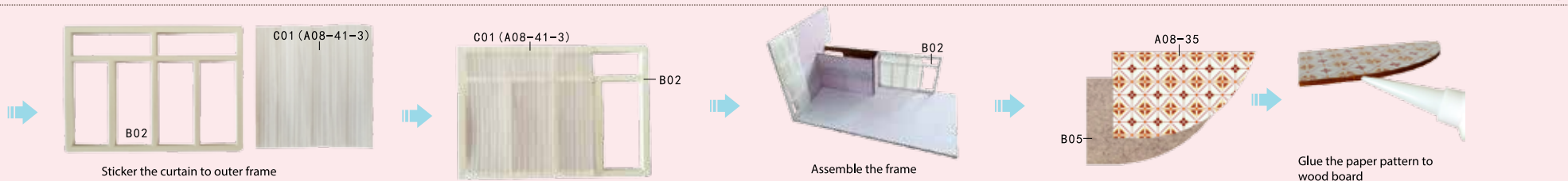
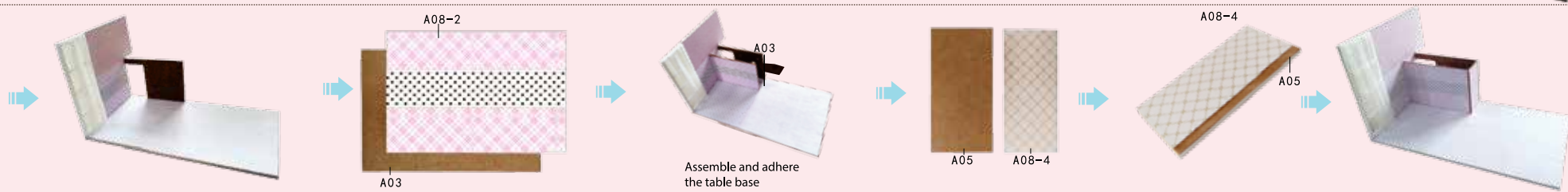
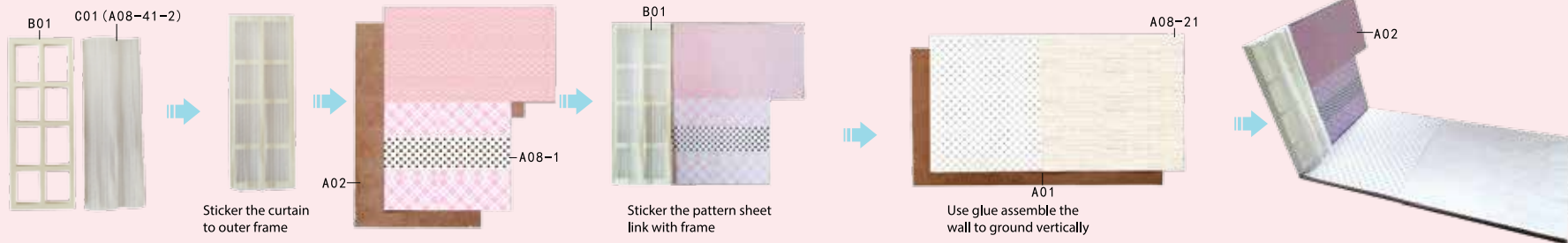

Photo Gallery



Attention: Please keep these instructions and refer to them after assembly.

**Tiny
Terrace**

Pink House Materials List 43160907

Material Bag A(Ratio 1:4)

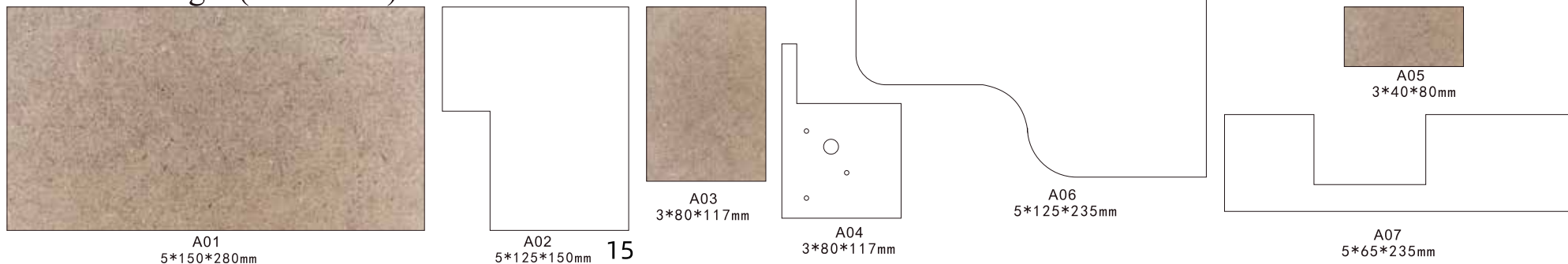

Material Bag B(Ratio 1:2)

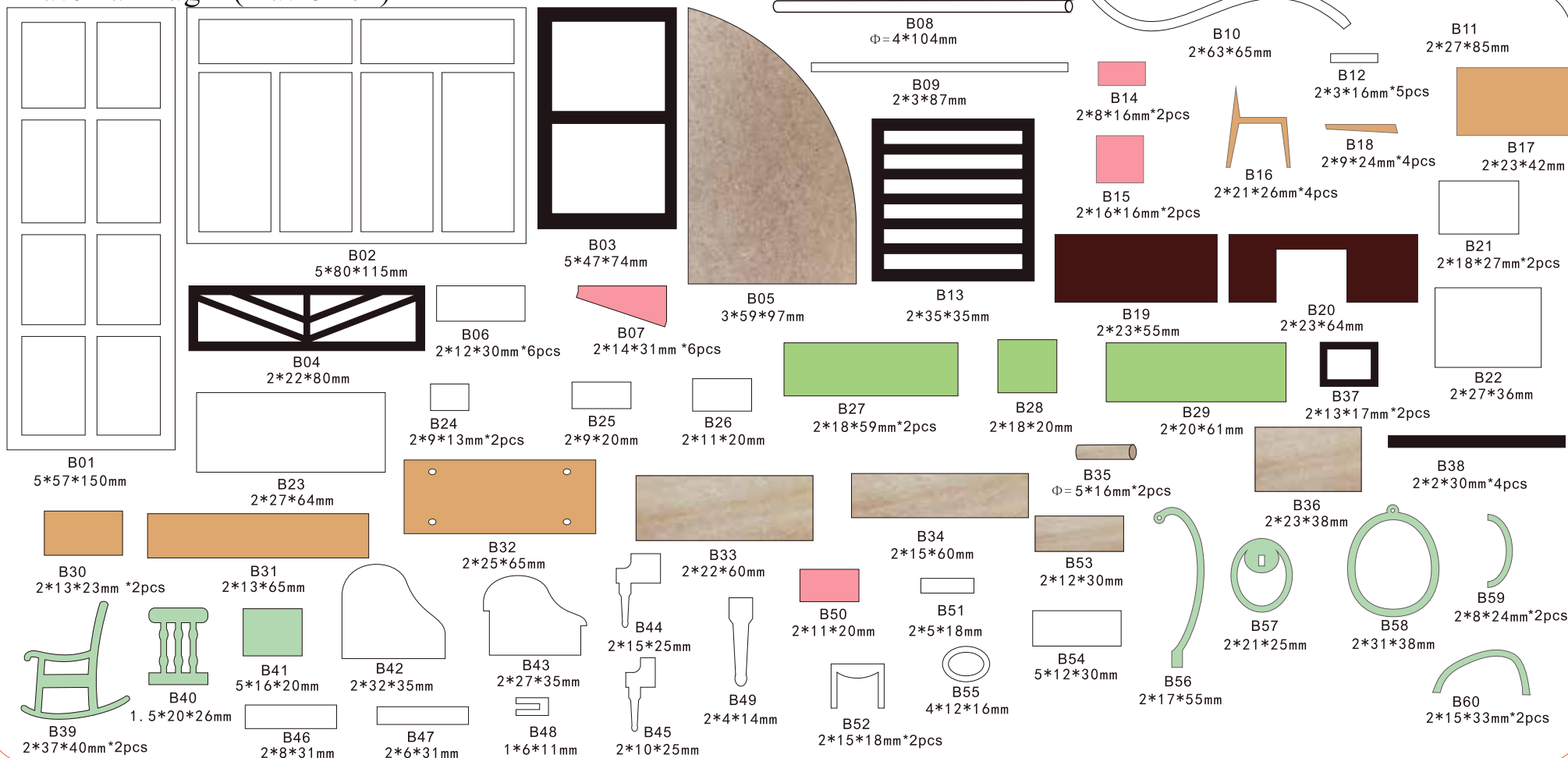

Pink House Materials List 43160907

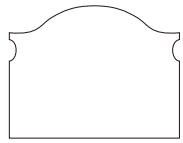

B61
2*35*45mm



B62
2*17*45mm



B63
2*45*60mm



B64
2*9*60mm*2pcs



B65
2*15*44mm



B66
2*15*40mm*2pcs



B67
2*15*19mm*2pcs



B68
2*15*21mm



B69
2*15*23mm

Material Bag C



C01
130*150mm



C02
40*80mm



C03
80*100mm



C04
70*130mm



C05
50*50mm



C06
60*60mm



C07
(some)



C08
24*77mm



C09
45*120mm

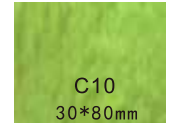

C10
30*80mm



C11
21*21mm



C12
*130mm



C13
*55mm



C14
*700mm



C15
*3pcs



C16



C17



C18



C19



C20
*2pcs



C21



C22



C23



C24
*2pcs



C26



C27



C28
*2pcs



C29
*2pcs



C30
*4pcs



C31
*3pcs



C32



C33



C34
*2pcs