

VOYAGER



SCOOTER BEATS

User Manual

ITEM NUMBER: SCOT4040SB

KEYCODE NUMBER: 43192908

WARNING

PARENTAL AND ADULT RESPONSIBILITY AND SUPERVISION IS NECESSARY TO ASSURE USE BY MATURE RIDERS: Because products, like Scooter Beats, can and do present potential hazards plainly associated with their use, it is well recognized **THE NEED FOR EXERCISE OF PARENTAL RESPONSIBILITY IN SELECTING RIDING PRODUCTS APPROPRIATE TO THE AGE OF A CHILD, OR PARENTAL SUPERVISION IN SITUATIONS IN WHICH CHILDREN OF VARIOUS AGES MAY HAVE ACCESS TO THE SAME RIDING PRODUCTS, IS IMPORTANT.** Not every product is appropriate for every age or size of child, and different age recommendations are found within this category of product which are intended to reflect the nature of the hazards and the expected mental or physical ability, or both, of a child to cope with the hazards.

Scooter Beats is not intended for use by persons (including children) with reduced physical, sensory or mental capabilities, or lack of experience and knowledge, unless they have been given supervision or instruction concerning use by a person responsible for their safety.

Children should be supervised to ensure that they do not play with the Scooter Beats.

WARNING: For the purposes of recharging the battery, only use the detachable supply unit provided with this Scooter Beats.

BATTERY WARNING

--The Scooter Beats battery is non-replaceable by the end user. When the battery is at the end of life, the Scooter Beats and the internal battery should be properly disposed of.

--Do not attempt to service the Scooter Beats battery yourself. This scooter contains batteries that are only replaceable by skilled technician.

--If a battery leak develops, avoid contact with the leaking substance and place the damaged battery in a plastic bag. Refer to the disposal instructions on page 11 of the user manual. If any substance leaking from the battery comes into contact with skin or eyes, flush with cool water for at least 15 minutes and contact a physician."

Safety Precautions

When using your Voyager Scooter Beats Scooter, the following basic safety precautions should always be adhered to:

BEFORE RIDING

1. READ ALL INSTRUCTIONS BEFORE USING YOUR SCOOTER.
2. Your scooter is designed to be used by riders age 5 and older.
3. Do not ride scooter in temperatures below 0°C.
4. Do not let children use your scooter without adult supervision.
5. Never immerse the scooter in water.
6. Do not leave the scooter in high temperatures.
7. Safety equipment such as helmet, knee pads, wrist pads should be worn at all times.
8. Do not ride your scooter with any loose clothing that can get caught in the wheels.
9. Do not expose your scooter's battery to liquid or moisture. Similarly, do not expose your scooter or its battery to excessive heat or fire.
10. When charging the battery, only use the supplied charging cable included with your scooter.
11. Connect all wires properly, making sure they are not entangled. Check to see that the steering system is correctly adjusted.
12. Do not ride your scooter if you notice any defects or irregularities. Contact the manufacturer or a certified technician immediately for support.
13. Some assembly is required. Make sure that all assembly is completed by a capable adult.
14. Users should always wear shoes that are fully enclosed with flat soles.
15. Adults must assist children in assembling this scooter.
16. Replace worn or broken parts immediately.

WHILE RIDING

1. Always obey local traffic laws and regulations.
2. Do not ride your scooter while under the influence of any alcohol, medication or other substance which can cause impairment.
3. Do not attempt to do any tricks while riding your scooter.
4. Always ride on smooth and paved surfaces away from motor vehicles.
5. Never ride on surfaces where there is water, sand, gravel, dirt, leaves or other debris as these could cause the scooter to pitch or have its wheels entrapped. Use of a scooter in rain or wet conditions can impact traction, braking and visibility.
6. Scooter may encounter pitching motion/wheel entrapment or suddenly stop if it comes into contact with sharp bumps, rocks/sticks, sudden surface changes or drains.
7. Ride carefully. Avoid applying the breaks abruptly.
8. Practice riding in spacious areas at low speeds until you become more experienced and comfortable with higher speeds.
9. Do not allow your scooter to be dragged by cars or bikes. Do not use your scooter on escalators or in crowded areas.
10. Never ride at night. Do not use you scooter in areas of low visibility.
11. Always power off your scooter when it is not in use.
12. Never allow more than one person on the scooter at a time.
13. Do not ride your scooter near stairs or bodies of water.
14. Avoid excessive speeds associated with downhill rides.
15. Respect pedestrians when riding on footpaths.

Introduction

Thank you for purchasing your new Voyager Scooter Beats Electric Scooter and welcome to the Voyager family. We hope that you'll do plenty of exploring on your new scooter. Please enjoy your new scooter responsibly and be sure to read the entire instruction manual before your first use. Have a blast, be safe and Get Moving!

Specifications

- **Battery Type:** Rechargeable 2Ah18650 Lithium Battery
- **Motor Power:** 50W
- **Max Mileage Per Charge:** Up to 6.5km
- **Max Speed:** 10km/h
- **Charger:** HGDS210040, 110-240V; 50-60Hz
- **Charge Time:** ~5 Hours
- **Net Weight:** 6.65kg
- **Max Rider Capacity:** 54kg
- **Minimum Rider Weight:** 20kg
- **Recommended For Ages:** 5+
- **Wheels:** 11.4cm (front) 8.9cm (rear)
- **Dimensions (l/w/h):** 74/35.5/83.5 cm *unfolded*
74/35.5/30.5 cm *folded*

In The Box

- Voyager Scooter Beats Electric Scooter
- Charging Adapter
- Locking tool (wrench)
- User's Manual with Warranty Information

Your Scooter

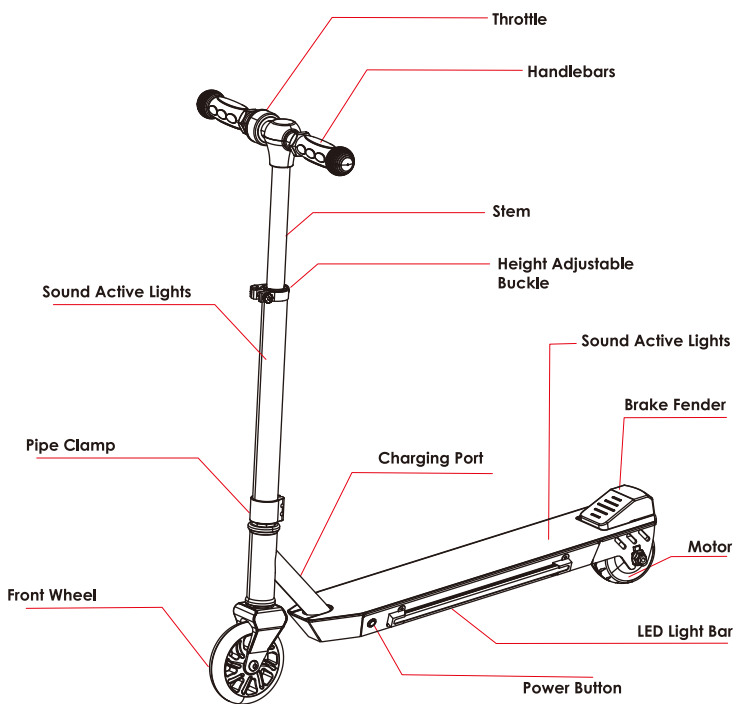

Assembly

Make sure that your scooter is securely assembled before riding.

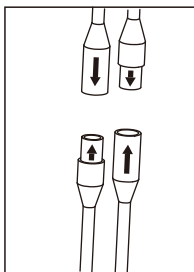
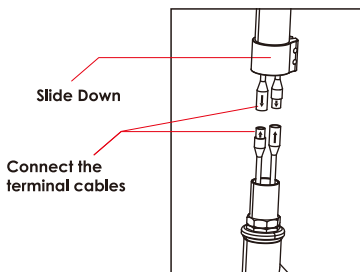

IMPORTANT NOTE

When connecting terminal cables make sure to connect cables of the same color and to carefully align the arrows before connecting to ensure that the pins do not get damaged.

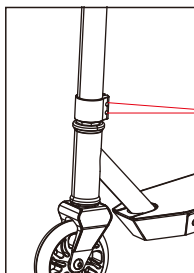

Tighten Bolts Securely

Ensure that the front wheel is aligned before tightening bolts.

Use the provided tool (wrench) to tighten securely, alternating between each bolt until they both can no longer be turned.

Charging

Before riding your scooter, please make sure that the battery is fully charged. In order to charge your scooter's battery, follow the steps below:

Step 1.

Make sure that your scooter is powered off before charging.

Step 2.

Make sure that your scooter is completely dry.

Step 3.

Connect one end of the include charging adapter into the charging port on your scooter. Plug the other end into a suitable power outlet in your home.

Step 4.

While your scooter's battery is charging, the LED light on the charging adapter will turn red. Once fully charged, the LED light will turn green.

Step 5.

Unplug the charging adapter once charging is complete.

NOTES:

--Charging takes approximately 5 hours to complete. To extend the lifespan of the scooter's battery, make sure to charge it at least once every 20-30 days.

--Chargers have built-in overcharge protection to prevent the battery from being overcharged. However, you should unplug the charger from the wall outlet when not in use.

--Always unplug the E-Scooter from the charger before powering on. If the E-Scooter is powered on while connected to the charger, make sure to power off and then back on after unplugging from the charger to restore normal functionality.

Charging Temperature Range	Operating Temperature Range	Storage Temperature Range
0°C-40°C (32°F-104°F)	0°C-40°C (32°F-104°F)	-20°C-25°C (-4 °F-77°F)



Use **ONLY** with the recommended charger. Batteries are only to be charged under adult supervision. The charger is not a toy.

Always disconnect the charger before wiping down and/or cleaning the scooter with a damp cloth.

FAILURE TO USE COMMON SENSE AND HEED THE ABOVE WARNINGS FURTHER INCREASES RISK OF SERIOUS INJURY. USE AT YOUR OWN RISK AND WITH APPROPRIATE AND SERIOUS ATTENTION TO SAFE OPERATION. USE CAUTION.

Charging Cutoff Voltage: 29.4V Discharge Cutoff Voltage: 21V

Bluetooth Speaker

In order to use your scooter's built in Bluetooth speaker, follow the steps below:

1. Power on the scooter by pressing the power button.

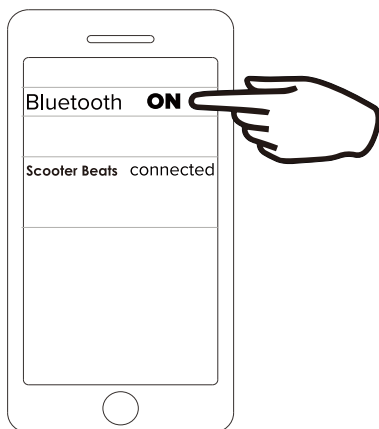

2. Go to the Bluetooth settings menu on your phone. Make sure that Bluetooth is turned on. Connect to the device listed as "Scooter Beats."

3. When asked to enter a PIN Code, enter "4040."

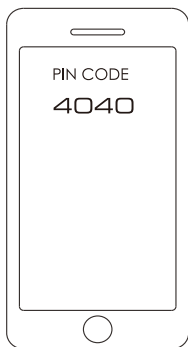

4. Once connected, your E-Scooter will emit a "Paired" tone.

Using The Controls

1. Power ON/OFF

Press the power button and the LED lights on your scooter illuminate, indicating that it is powered on. Hold the power button for 3 seconds to power it off.

2. Accelerating

Kick off with one foot while holding the thumb throttle down.

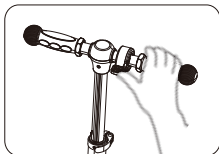

IMPORTANT NOTE

Your scooter will **NOT** accelerate by pressing the thumb throttle down alone.

You must kick push the scooter so it starts to move forward and build speed and **THEN** press the thumb throttle down for your scooter to accelerate.

3. Braking

Press the brake fender with your back foot to slow down.

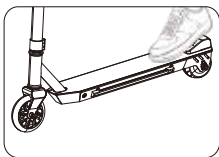

4. Height Adjustment

Loosen the height adjustment buckle and then lower or raise the stem to a desired height. Make sure the buckle is tightened once complete.

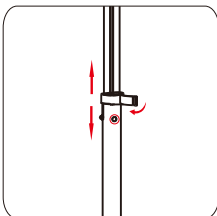

Safety

1. Avoid leaning forward while accelerating or decelerating and do not keep your body weight on the handlebars.
2. While riding, keep one foot in front of the other, so that your body is stable and you can easily step on the rear brake.
3. Keep your body and handlebars parallel when turning. Be sure that the road is in smooth condition, especially while turning.
4. Ride thoughtfully. Plan your route before traveling. Be aware of any uneven surfaces. Avoid applying the brakes abruptly.

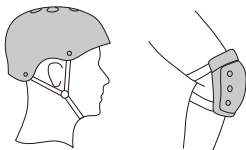

5. Safety equipment such as helmet, knee pads, wrist pads should be worn at all times.
6. Brake will get hot from continuous use. Do not touch after braking.

Strictly abide by local laws and regulations and traffic laws.
Do not ride this scooter under conditions with low visibility.
Do not carry passengers.

Service and Maintenance

Wheel Bearings: Avoid going through water, oil or sand as this can damage wheel bearings. To look after the wheel bearings, systematically check that the front wheel turns properly by turning the scooter upside-down and using your hand to spin the wheel. If the wheel does not spin it must then be removed to check their condition. First unscrew the wheel axle, remove the axle and detach the wheel, then carefully push the wheel bearing out of the housing. If the bearing is chipped or dented, new ones should be bought. If there is no visible damage, the bearing must then be oiled. To do this, remove all traces of grease, mud or dust with a kitchen towel or cloth, and re-oil the bearing with a grease spray or by leaving it to soak overnight in oil [turn it several times in the oil first]. Remove and reassemble the wheel bearing and axle, followed by the wheel, onto the scooter.

Wheels: The wheels may wear down with time and can be pierced if over used on rough surfaces. In the interest of safety, both wheels should be checked regularly and changed if necessary only by a certified technician.

Nuts and Axles: These should also be checked regularly. They can become loose after a while in which case they should be tightened. They can become worn and not tightened properly, in which case they should be replaced.

Battery Care & Disposal

--Do not store in freezing or below freezing temperatures. To properly maintain your battery and ensure maximum battery life, carefully read the "Charging" section on page 6 of this User Manual.

--Battery pack should not be disassembled, crushed, punctured, opened or otherwise mutilated.



DISPOSAL: Your Scooter Beats contains a lithium-ion battery pack which must be recycled or disposed of in an environmentally safe manner. Do not dispose of a battery pack in a fire. The battery pack may explode. Do not dispose of a battery pack in your regular household trash. The incineration, land filling or mixing of batteries with household trash is prohibited by law in most areas. Return exhausted batteries to an approved lithium-ion battery recycler.

FCC Compliance

Changes or modifications not expressly approved by the party responsible for compliance could void the user's authority to operate the equipment.

This device complies with Part 15 of the FCC Rules. Operation is subject to the following two conditions: (1) this device may not cause harmful interference, and (2) this device must accept any interference received, including interference that may cause undesired operation.

This equipment has been tested and found to comply with the limits for a Class B digital device, pursuant to Part 15 of the FCC Rules. These limits are designed to provide reasonable protection against harmful interference in a residential installation. This equipment generates, uses and can radiate radio frequency energy and, if not installed and used in accordance with the instructions may cause harmful interference to radio communications. However, there is no guarantee that interference will not occur in a particular installation.

If this equipment does cause harmful interference to radio or television reception, which can be determined by turning the equipment off and on, the user is encouraged to try to correct the interference by one or more of the following measures:

- Reorient or relocate the receiving antenna.
- Increase the separation between the equipment and receiver.
- Connect the equipment into an outlet on a circuit different from that to which the receiver is connected.
- Consult the dealer or an experienced radio/TV technician for help.

Warranty

This warranty covers the original consumer purchaser only and is not transferable.

This warranty covers products that fail to function properly UNDER NORMAL USAGE, due to defects in material or workmanship. Your product will be repaired or replaced at no charge for parts or labor for a period of one year.

What Is Not Covered by Warranty

Damages or malfunctions not resulting from defects in material or workmanship and damages or malfunctions from other than normal use, including but limited to, repair by unauthorized parties, tampering, modification or accident.

To Obtain Warranty Service and Troubleshooting Information:

Call (877)-444-0345 in the U.S. or visit our website at www.ridevoyager.com.

To receive Warranty service along with the name and address of an authorized product service center, the original consumer purchaser must contact us for problem determination and service procedures. Proof of purchase in the form of a bill of sale or receipted invoice, evidencing that the product is within the applicable Warranty period(s), MUST be presented in order to obtain the requested service. It is your responsibility to properly package and send any defective products along with a dated copy of proof of purchase, a written explanation of the problem, and a valid return address to the authorized service center at your expense. Do not include any other items or accessories with the defective product. Any products received by the authorized service center that are not covered by warranty will be returned unrepai

LOCAL LAWS

Prior to purchasing any motorized vehicle, we highly recommend that you research your local regulations and country-specific laws. Ultimately, you are responsible for complying with all applicable laws and regulations. Voyager waives all liability relating to your use of Voyager products.

FOR CONSUMERS IN AUSTRALIA ONLY

Faulty product should be returned to point of sale, requiring proof of purchase for a refund or exchange.

Our goods come with guarantees that cannot be excluded under the Australian Consumer Law. You are entitled to a replacement or refund for a major failure and for compensation for any other reasonably foreseeable loss or damage. You are also entitled to have the goods repaired or replaced if the goods fail to be of acceptable quality and the failure does not amount to a major failure.

For all Technical Support in Australia please dial 1-800-006-614

©2022 Sakar International
195 Carter Drive
Edison, NJ 08817

 VOYAGER

成品尺寸：100mm*180mm

材质：封面封底250克銅板外内覆亞膜，
封面封底彩色印刷4C，封面背面和封底背
面是黑色。内頁128克銅板黑白印刷。

骑马钉裝訂成册：封面+封面背面(空白黑
色)+内页+1张空白页（2P）+封底背面(空
白黑色)+封底