

anko

Vacuum Cleaner

For Household Use Only

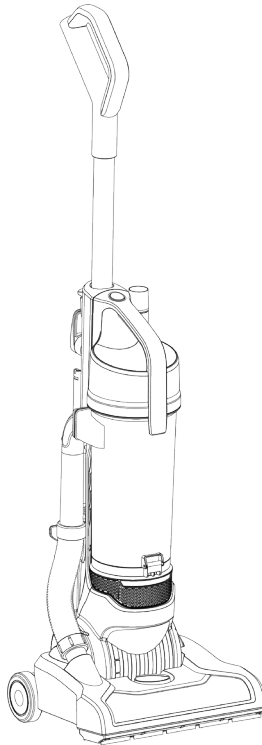

Model No.: VC-9790

Rev 1

Note: This appliance's specifications and/or components are subject to change without prior notice.

If any Accessories should fail during use, please call 1300 105 888 (Australia) or 09 8870 447 (New Zealand) for an immediate replacement. This will save you from returning the product to the store.

If we can assist you in any other way, please feel free to contact us

1	Warnings	3
2	Safety Direction	3
3	Transporting your Vacuum	6
4	Components	6
5	Assembly Method	7
5.1	Fitting / Removing the Handle	7
5.2	Crevice / Brush Tool Holder	8
6	Power Cord Storage	8
7	Floor Head Height Adjustment	9
8	Safety Devices Operation	9
9	Power On / Off Switch	10
10	Floor Head Release	11
11	Crevice / Brush Tool	12
12	Flexible Hoses	12
13	Emptying the Dust Canister	15
14	User Maintenance	16
14.1	Cleaning Filters	16
14.1.1	Main Filter	16
14.1.2	Pre-Motor Filter	19
14.1.3	Dust Canister	20
14.2	Cleaning the Vacuum Cleaner Body and Tools	20
14.3	Cleaning the Rotary Brush Bar	21
15	Troubleshooting	22
16	Warranty Against Defect	23

1 Warnings

Before using this appliance, read and follow all warnings and instructions in this manual, even if you are familiar with this product.

This appliance is not intended for use by persons (including children) with reduced physical, sensory or mental capabilities, or lack of experience and knowledge unless they have been given supervision or instruction concerning the use of the appliance by a person responsible for their safety.

Children should be supervised to ensure that they do not play with the appliance.

2 Safety Direction



Please read this instruction manual carefully before first use. It is advisable to keep this instruction manual for future reference.

DO NOT vacuum water, wet objects, liquids, ashes, hot coals, cigarette butts, matches or any hot, smoking or burning objects, etc.

DO NOT pick up flammable or combustible materials (i.e., lighter fluid, petrol, kerosene, etc.) or use in the presence of explosive liquids or vapour.

DO NOT pick up toxic material (i.e., chlorine bleach, ammonia, drain cleaner, etc.)

DO NOT vacuum Toner (for laser printers, copy machines etc.) as there is a risk of fire and explosion.

DO NOT vacuum plaster, cement etc. as the filter can become blocked.

DO NOT use the vacuum without all the filters fitted.

DO NOT store or use the appliance near high-temperature areas.

DO NOT run over the power cord with the vacuum cleaner.

DO NOT use the vacuum cleaner if it is blocked. Switch off and clear all blockages before continuing.

DO NOT use the vacuum cleaner with blocked filters. Clean filters before continuing. (refer to User Maintenance section).

DO NOT use the vacuum cleaner if the appliance malfunctions, has abnormal noise, smells, smoke, is dropped or damaged in any manner or if any breakage is found during the operation.

Return the appliance to the nearest authorised service agent or similarly qualified person for a thorough examination, repair, electrical or mechanical adjustment.

DO NOT misuse the cord. Never pull the appliance by the cord or pull to disconnect it from the outlet. Instead, grasp the plug and pull to disconnect.

DO NOT use the vacuum cleaner to pick up large objects, hard or sharp objects such as glass, nails, screws, coins, etc. that are likely to cause damage.

DO NOT use with damaged cord or plug.

DO NOT use the vacuum cleaner if it has been dropped, damaged, left outdoors, or dropped into liquid (water etc.)

DO NOT close door on the cord or pull the cord around sharp edges or corners.

Cord Rewind - **DO NOT** allow the cord and plug to whip back at full speed. Guide the cord and plug in gently.

DO NOT handle the plug or vacuum cleaner with wet hands.

DO NOT put any objects into openings.

DO NOT use with any openings blocked and do not restrict airflow.

DO NOT operate the appliance with a damaged cord or plug.

If the supply cord is damaged, it must be replaced by the manufacturer, its service agent or similarly qualified persons in order to avoid a hazard.

DO NOT use without filters in place.

DO NOT attempt to modify this product in any way.

DO empty the Dust Canister regularly for optimal operation of the vacuum.

DO keep hair, loose clothing, fingers, feet and body parts away from openings or moving parts.

DO disconnect the appliance from the mains supply before connecting the flexible suction hose.

DO switch off controls before you connect or disconnect the appliance to or from the mains supply.

DO disconnect the appliance from the power supply when not in use, before changing the dust filter, cleaning the filters or connecting / disconnecting the accessories.

DO use only on dry, indoor surfaces.

DO use only as described in this manual. Use only the manufacturer's recommended attachments.

DO Keep cord away from heated surfaces.

DO Keep all openings free of dust, lint, hair and anything that may reduce airflow.

DO use extra care when vacuuming on stairs.

DO keep your work area well-lit.

DO store your appliance indoors in a cool, dry area.

DO ensure children and babies cannot play with plastic bags or any packaging materials.

DO operate the appliance from a power source of the same voltage, frequency and rating as indicated on the product identification plate

If this appliance is used by a third party, **DO** supply the instruction manual with it.

No liability can be accepted for any damage caused by non-compliance with these instructions or any other improper use or mishandling of the appliance.

This product has not been designed for any uses other than those specified in this manual.

ONLY for domestic use. Industrial or commercial use invalidates the warranty.

Read and Save These Instructions

3 Transporting your Vacuum

To move your vacuum cleaner from room to room, unplug the appliance and either push the appliance or carry using the handle.

Never pull or carry the vacuum cleaner by its cord.

Never carry or pull the vacuum cleaner by the flexible hose.

4 Components

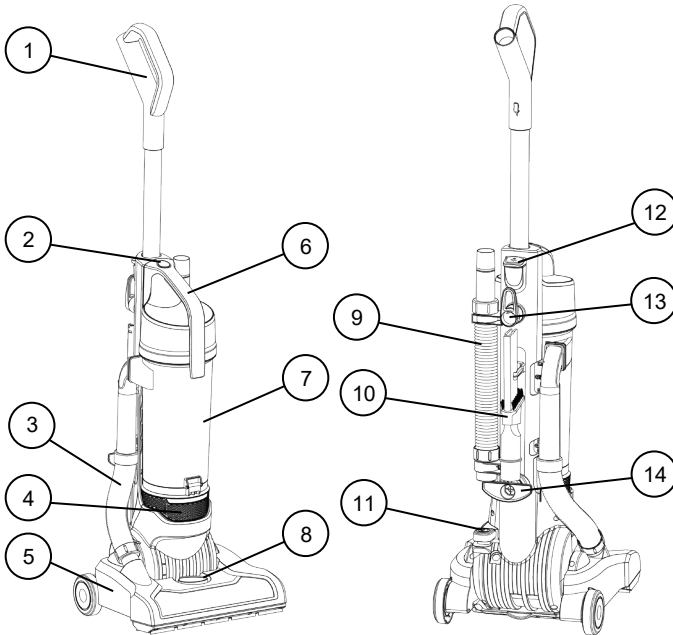

1	Handle / Hose Handle	8	Head Height Adjustment Knob
2	Dust Canister Release Button	9	Additional Extension Flexible Hose
3	Flexible Hose	10	Crevice / Brush Tool
4	Air Exhaust	11	On / Off Foot Switch
5	Floor Head	12	Handle Release Lever
6	Carry Handle	13	Top Power Cord Hook
7	Dust Canister	14	Lower Power Cord Hook

5 Assembly Method

Please Note: Always switch off and remove the plug from the power point before fitting or removing accessories, including the dust canister.

Ensure all Filters are fitted and fitted correctly before using.

5.1 Fitting / Removing the Handle

To fit the handle, place the end of the tube into the hole in the top of the vacuum cleaner.

The Handle Release Lever may need to be pushed down to let the tube in.

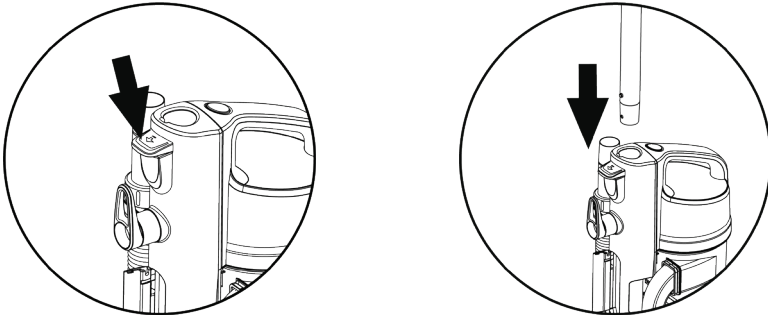

Once the tube is in the hole, release the lever then push down hard until the tube locks in place.

To remove the handle, press the Handle Release Lever down and whilst holding it down, grasp the handle and pull it straight up and out.

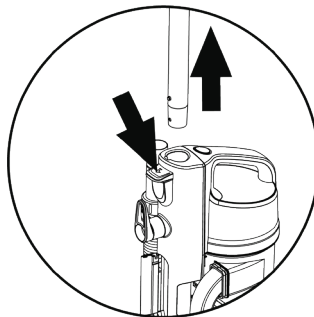

5.2 Crevice / Brush Tool Holder

Take the Crevice / Brush tool and stow it on the back of the vacuum cleaner as shown.



6 Power Cord Storage

There is provision for storing the power cord when not in use.

There are two hooks on the back of the vacuum cleaner for winding the cord.

The top hook can be rotated for easy removal of the cord when getting ready to use the appliance. Simply rotate the top hook 180° so that the cord slips off.

When storing the cable back onto the hooks, make sure the top hook is pointing up. (i.e., rotate back to the original position).

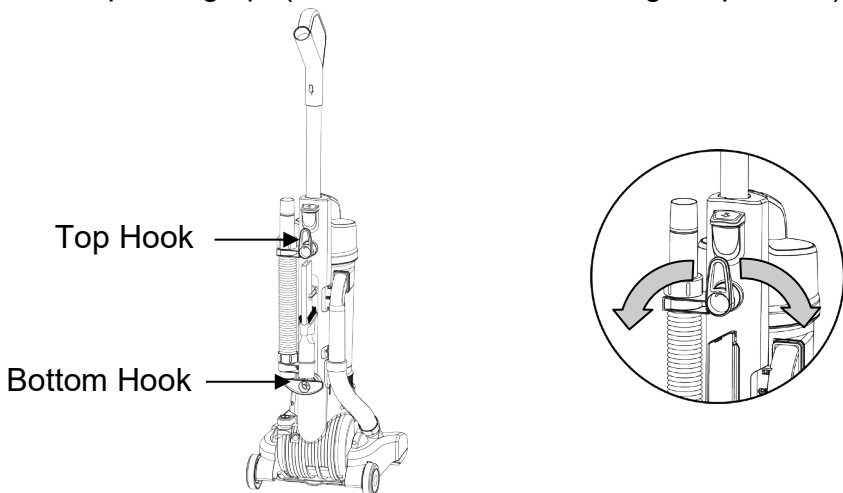

7 Floor Head Height Adjustment

The floor head is adjustable in height to suit low to high-pile carpets and for hard floors.

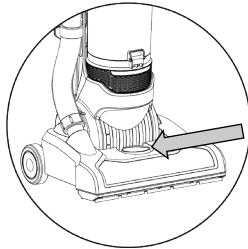

- Turn to position “0” for Low pile carpet.
- Turn to position “1” for Hard floors.
- Turn to position “2 or 3” for carpet between Low Pile and Medium pile carpet.
- Turn to position “4” for High Pile Carpet.

Note: you can fine-tune the height in-between these Major settings to suit your carpet.

8 Safety Devices Operation

NOTE: The motor has an overheating protection device built in.

It will automatically switch off the power to the motor if it overheats. e.g., from blocked nozzles, a full dust canister or uncleaned blocked filters.

If this happens, switch off the vacuum and unplug it from the power point, clean blockage and / or filters and allow it to rest for at least 60 minutes which should be enough time for the motor to cool down.

Important: If the over-temperature device activates and turns the motor off, and you do not switch off and unplug the appliance from the power point, the motor will restart automatically after it has cooled down enough to reset the safety device.

This could cause damage to your floor surface as the brush bar will start spinning in the one spot.

NOTE: NEVER BLOCK ANY VENTS OR OPENINGS AND KEEP FILTERS CLEAN.

9 Power On / Off Switch

The Motor On / Off switch is located in the floor head.

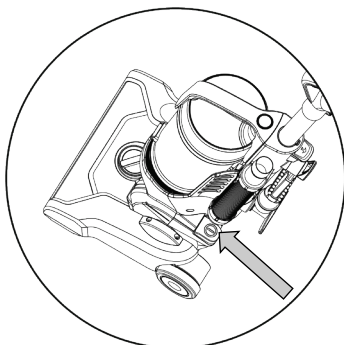

To turn the motor on, using your foot, press and release the On / Off Switch.

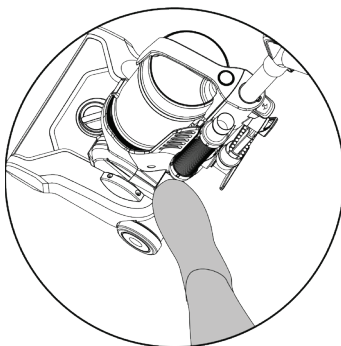

Press the On / Off switch again to turn it off.

10 Floor Head Release

To Lower the Handle, place your foot on the top of the floor head, to hold it firmly on the floor, and then pull the vacuum cleaner handle back.

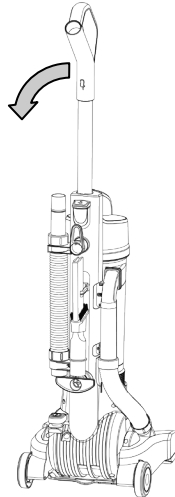
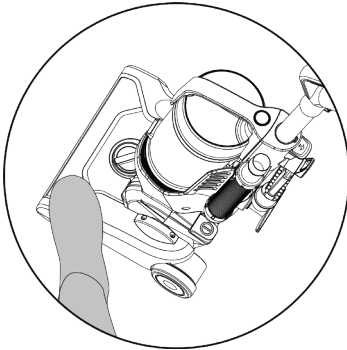

The floor head latching mechanism will release and you are now ready to start vacuuming the floor.

Note: when the latching mechanism releases, it will make a “click” noise. This is no reason for alarm as it is just the latching mechanism operating.

NOTE: When the handle is lifted back up to the park position, the Floor Head Rotary Brush will still continue to rotate.

The floor head will lift up slightly, however, it is strongly recommended that you do not allow the Vacuum Cleaner to sit on one spot while the Brush Bar is rotating as this may cause damage to the flooring surface.

11 Crevice / Brush Tool

The Crevice / Brush tool is for cleaning furniture and into corners etc.

To use the Brush tool, press the release button to unlatch and slide the brush up until it locks in place.

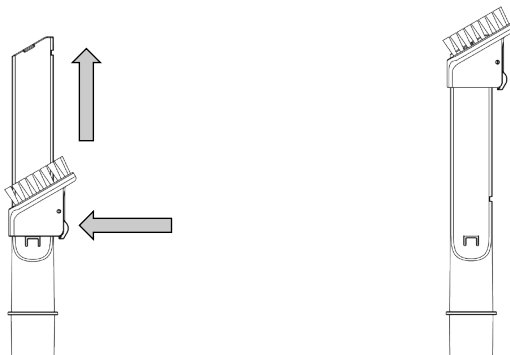

To use the Crevice tool, press the release button to unlatch and slide the brush down until it locks in place.

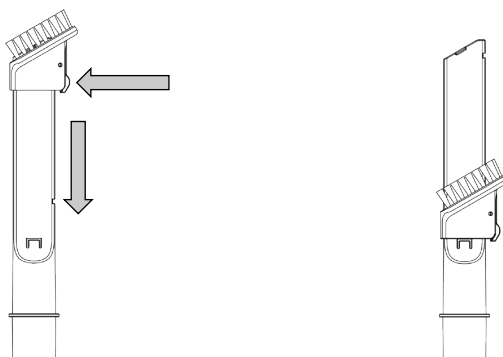

12 Flexible Hoses

The vacuum Cleaner comes with a Flexible Hose plus an extra separate Extension Hose which is used with the vacuum cleaner handle when using the Accessory Tool for extra reach and for cleaning stairs etc.

To use the hose with the crevice / brush tool, first pull out the removable end from the Floor Head by pulling straight out as shown.

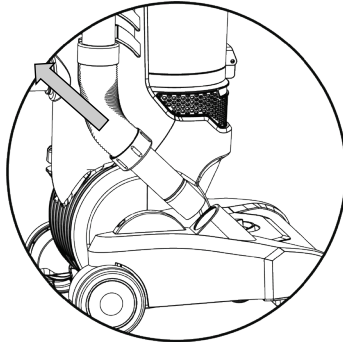

Take the crevice / brush tool and slide it onto the end of the hose connector.

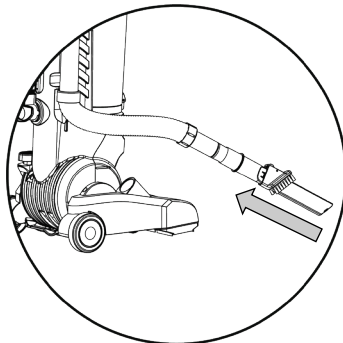

You are now ready to use the crevice / brush tool.

To use the Extension Hose and Hose handle for the extra reach, first unclip the Extension Hose from the Hose clamps.

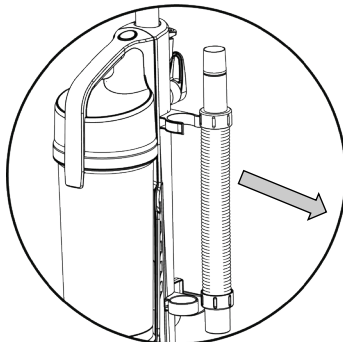

Remove the Handle from the top of the vacuum cleaner by pressing down the Release Lever and then pull the Handle straight up and out as shown.

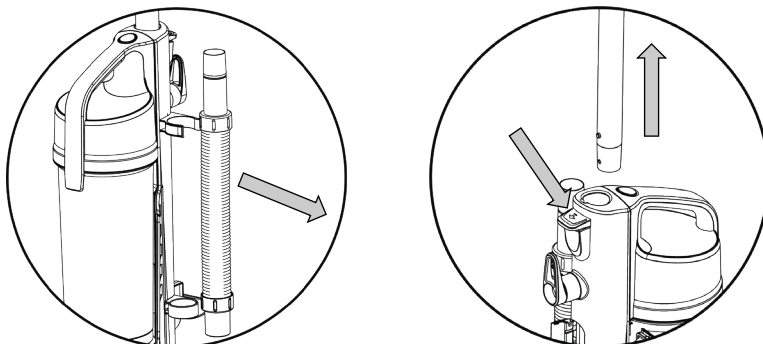

Next, connect the end of the hose to the top end of the Handle and clip on as shown.

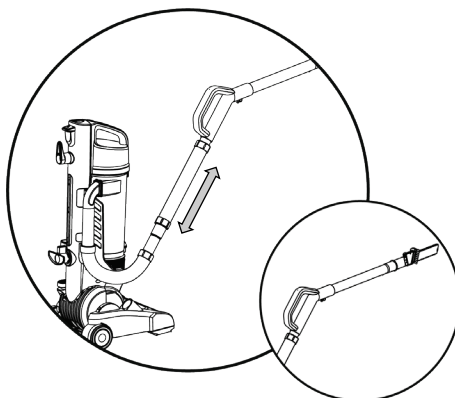

CAUTION

DO use extra care when vacuuming on stairs. Take care not to trip on the power cable or flexible hose and **DO** keep your work area well-lit.

When finished vacuuming, the vacuum cleaner can be reassembled for use as an upright vacuum cleaner.

13 Emptying the Dust Canister

Empty the Dust Canister and clean the filters as frequently as possible or when the suction power is reduced.

- To remove the Dust Canister, switch off the power and unplug from the power point.
- Grip the handle on the Dust Canister, press the Dust Canister Release Button and pull the Dust Canister forward and out of the housing.

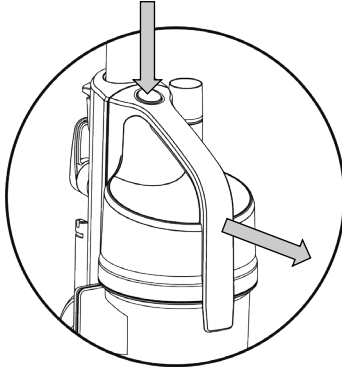

- Take the dust Canister to a dustbin.
- Unclip the side latch and swing the trap door down emptying the contents into the bin.

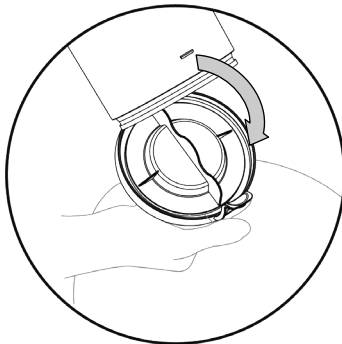

To close the trap door, close it manually until it clips shut.

- Brush the inside of the dust canister with a small brush or wash. Refer to section “Cleaning Filters”.
- To refit the Dust Canister into the vacuum cleaner, simply align the dust canister into its position and push in until it locks in place.

14 User Maintenance

WARNING: The vacuum cleaner **MUST** be switched off and unplugged from the power point before any maintenance or replacement of parts. Failure to do so may result in injury or damage to your surroundings and vacuum cleaner.

NOTE: To maximise the performance of your vacuum cleaner, you should clean your filters regularly.

If the filters are broken or worn, replace them before continuing to use the vacuum.

Filters can be purchased from our Customer Service. You can call our customer service number: 1300 105 888 or via email info@hegroup.com.au

14.1 Cleaning Filters

Important Note – the Filters must be cleaned regularly for best suction performance and to prevent overheating and damage to your vacuum cleaner.

Cleaning is best done at the same time when emptying the dust Canister after you have finished vacuuming for the day.

NOTE: Never use the vacuum cleaner with wet or damp filters or without **ALL** filters fitted.

Using wet or damp filters will damage the filters, may cause serious damage to the vacuum cleaner and will void your warranty.

14.1.1 Main Filter

Remove the Dust Canister as described previously.

The main filter is located underneath the top lid of the dust canister.

To access this filter for cleaning (or replacement) first open the lid of the dust canister by unclipping the side latch and swing the lid open.

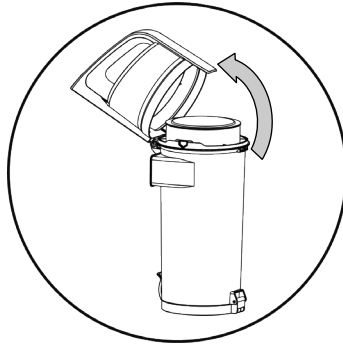

With the lid opened fully, grasp the dust separator, which has the filter located in the top, and pull straight up and out.

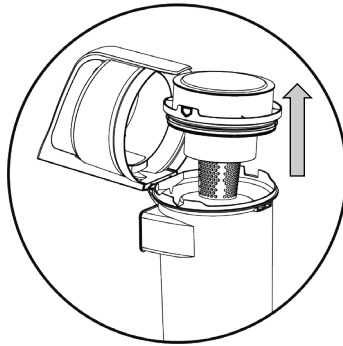

Remove the filter from the dust separator. The filter is a firm fit in the top of the dust separator so as to seal properly, so may require a little force to remove it.

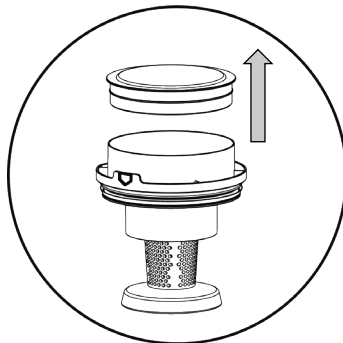

Note: Only wash the filter if it is very dirty, otherwise just tap the edge of the filter on a hard surface to dislodge any dust and remove any large debris.

If washing, wash the filter in warm mild soapy water, rinse in clean fresh cold water and let it completely dry.

DO NOT scrub the filter or place in a dishwasher.

DO NOT use a hair drier to dry the filter.

NOTE: Never use the vacuum cleaner with wet or damp filters. Using wet or damp filters will damage the filters, may cause serious damage to the vacuum cleaner and will void your warranty.

At the same time the filter has been removed for cleaning (or replacing), the dust separator can also be cleaned using warm mild soapy water, rinse in clean fresh cold water and let completely dry

To refit the filter, place the filter into the top of the dust separator and push it down firmly.

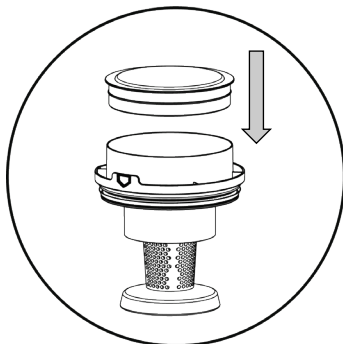

Refit the Dust Separator back into the Dust Canister ensuring the Locating Lug on the side of the Dust Separator is aligned with the mating notch in the Dust Canister as shown, and then push in all the way.

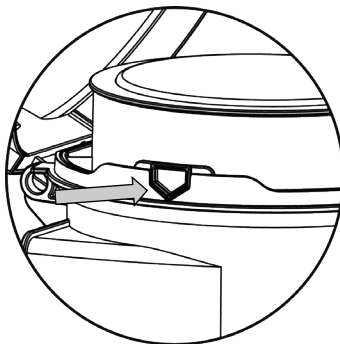
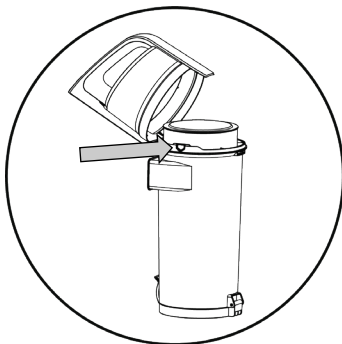

Close the Dust Canister lid ensuring it clips shut, then refit the dust canister to the vacuum cleaner.

It is recommended to replace the filter every 3 – 6 months, or sooner if required.

14.1.2 Pre-Motor Filter

The pre-motor filter is located in the bottom section of the vacuum cleaner where the dust canister locates.

Rotate the cover anticlockwise and lift straight off exposing the filter. Refer to the text moulded into the cover.

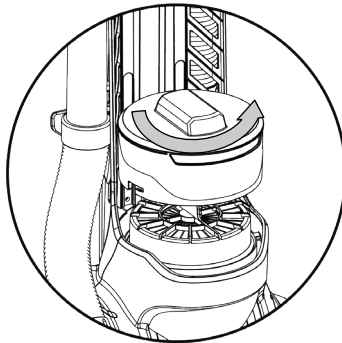

Grasp the Filter tightly and whilst rotating it, pull it straight up and out.

The filter is a tight fit so as to create a proper seal, so may require a little force to remove it.

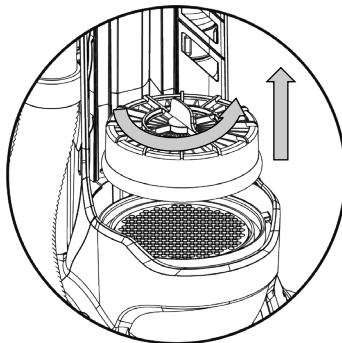

Note: Only wash the filter if it is very dirty, otherwise just tap the edge of the filter on a hard surface to dislodge any dust and remove any large debris.

If washing, wash the filter in warm mild soapy water, rinse in clean fresh cold water and let completely dry.

DO NOT scrub the filter or place in a dishwasher.

DO NOT use a hair drier to dry the filter.

NOTE: Never use the vacuum cleaner with wet or damp filters. Using wet or damp filters will damage the filters, may cause serious damage to the vacuum cleaner and will void your warranty.

Refit the Filter (or replace with a new one) by placing back into the holder and pushing down firmly to ensure it is seated properly.

It is recommended to clean this filter every week or sooner if required.

Refit the cover and rotate clockwise to lock in place. Refer to the Text moulded into the cover.

Refit the Dust canister to the vacuum cleaner and now you are ready to use.

14.1.3 Dust Canister

Any time the main filter is removed, you may also wash the dust canister.

Wash in warm mild soapy water, rinse in clean fresh cold water and let completely dry.

DO NOT scrub or place in a dishwasher.

DO NOT use a hair drier to dry the filter.

NOTE: Never use the vacuum cleaner with wet or damp components. Using wet or damp components may cause serious damage to the vacuum cleaner and will void your warranty.

Reassemble the dust canister with the filter then refit the Dust canister to the vacuum cleaner and now you are ready to use.

14.2 Cleaning the Vacuum Cleaner Body and Tools

Switch Off and Unplug the Vacuum Cleaner before any cleaning

Do not clean the vacuum cleaner, components or accessories using petrol or any other flammable liquid or solvents, etc.

Clean only the outside of the vacuum cleaner.

Use only a moist cloth and mild detergent for cleaning the vacuum cleaner, components and accessories.

After cleaning, wipe off the moisture on the vacuum cleaner, components and accessories with a dry cloth.

Do Not place accessories, tools or components in a dishwasher.

14.3 Cleaning the Rotary Brush Bar

WARNING: The vacuum cleaner **MUST** be switched off and unplugged from the power point before attempting to clean the rotary brush bar. Failure to do so may result in injury or damage to your surroundings and vacuum cleaner.

During use of the vacuum cleaner, the brush bar may become entangled with hair or thread etc. which needs to be removed to prevent damage to the brush bar and also for it to perform properly.

Ensuring the vacuum cleaner is switched off and unplugged from the power point, lay the vacuum cleaner on the floor so that you have access to the underneath of the floor head.

With a pair of sharp scissors or sharp utility knife, very carefully cut the hair or thread etc. away from the rotary brush and bristles. Take care not to cut the bristles.

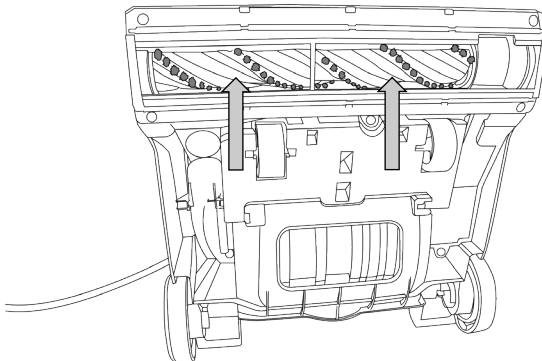

Once you have cleared the brush bar, stand the vacuum cleaner back up and then you are ready to use.

15 Troubleshooting

<p>Vacuum Cleaner will not turn on</p>	<p>Ensure the plug is properly plugged into the power point and switched on at the power point.</p> <p>Check that there is power at the power point. Use a table lamp or other appliance to check.</p> <p>Press the On/Off switch on the Vacuum cleaner</p> <p>Motor thermostat has tripped – Refer to “Overheating / Stopping” in the table below.</p>
<p>Noisy operation</p>	<p>Clean the Filters and empty the Dust Canister</p> <p>Check for partial blockages and unblock them.</p>
<p>Suction Not Strong</p>	<p>Clean or replace the Filters and empty the Dust Canister.</p> <p>Check for blockages and unblock them.</p> <p>Ensure the flexible hose has been reconnected properly to the floor head.</p> <p>Ensure the dust canister is fitted correctly.</p>
<p>Over-heating / Stopping</p>	<p>Clean or replace the Filters, empty the Dust Canister, check for blockages and unblock then allow it to cool for up to an hour before trying to restart.</p>
<p>Dust escaping from Dust Canister</p>	<p>Empty dust canister.</p> <p>Ensure the dust canister is fitted correctly.</p> <p>Ensure the Hoses are connected properly.</p> <p>Ensure Filters are connected properly.</p> <p>Ensure Filters are clean and not blocked.</p>
<p>Static Shock</p>	<p>In some rare instances, one or two users may feel an electric discharge when touching or using the vacuum cleaner during or after use. This is a well-known phenomenon of Static Electricity discharge that happens mostly when the user vacuums a synthetic fibre carpet or other synthetic surfaces. It can also be more prevalent in dry and cool environments. Although the feeling of Static Electricity can be unpleasant for the user, it is not dangerous and is not a fault of the vacuum cleaner. If this static discharge is a problem for the user, the user could try wearing insulating footwear during vacuuming (i.e., rubber or leather soles), or increase the humidity / heat level in the surrounding environment or both.</p>

16 Warranty Against Defect

12 Month Warranty

Thank you for your purchase from Kmart.

Kmart Australia Ltd warrants your new product to be free from defects in materials and workmanship for the period stated above, from the date of purchase, provided that the product is used in accordance with accompanying recommendations or instructions where provided. This warranty is in addition to your rights under the Australian Consumer Law.

Kmart will provide you with your choice of a refund, repair or exchange (where possible) for this product if it becomes defective within the warranty period. Kmart will bear the reasonable expense of claiming the warranty. This warranty will no longer apply where the defect is a result of alteration, accident, misuse, abuse or neglect.

Please retain your receipt as proof of purchase and contact our Customer Service Centre 1800 124 125 (Australia) or 0800 945 995 (New Zealand) or alternatively, via Customer Help at Kmart.com.au for any difficulties with your product. Warranty claims and claims for expenses incurred in returning this product can be addressed to our Customer Service Centre at 690 Springvale Rd, Mulgrave Vic 3170.

Our goods come with guarantees that cannot be excluded under the Australian Consumer Law. You are entitled to a replacement or refund for a major failure and compensation for any other reasonably foreseeable loss or damage. You are also entitled to have the goods repaired or replaced if the goods fail to be of acceptable quality and the failure does not amount to a major failure.

For New Zealand customers, this warranty is in addition to statutory rights observed under New Zealand legislation.

IMPORTANT!

For all technical queries or difficulties in operating the product and for spare parts, contact H.E. Group customer service 1300 105 888 (Australia) and 09 8870 447 (New Zealand).