

# anko

DEHUMIDIFIER

Model: DS00-22096

**User Manual**



PLEASE READ AND SAVE THESE  
INSTRUCTIONS FOR FUTURE REFERENCE

Model No: DS00-22096  
Rev 01

## 1. IMPORTANT SAFETY INSTRUCTIONS:

When using electrical appliance. Basic safety precautions should always be followed including the following:

### READ ALL INSTRUCTIONS BEFORE USE

- Read all instructions before using the appliance.
- Always operate the appliance from a power source of the same voltage, frequency and rating as indicated on the product identification plate.
- Position the power supply lead properly so that they will not be walked on or pinched by items placed on or against them.
- DO NOT install near any heat sources such as stoves, radiators, or other apparatus that produce heat.
- DO NOT operate appliance underneath or near flammable or combustible materials (e.g. curtains). Keep at least 10cm clearance around sides, back, front and top.
- This appliance is not intended for use in bathrooms or laundry rooms, or any other areas where the appliance may get wet or splashed with water liquids.
- DO NOT block any ventilation openings.
- DO NOT insert or allow foreign objects to enter the vent openings as this may cause damage to the appliance and/or injury to the user.
- DO NOT use appliance if it has been dropped or any part of appliance (including cord or adaptor) has been damaged. Take appliance to your nearest authorised service centre or qualified dealer for inspection or repair.
- Use appliance only for its intended use. Appliance is intended for household use only and not for commercial or industrial use.
- Use accessories supplied with the product only. The use of accessories not intended for use with this appliance may cause injuries to the user or damage to the appliance.
- DO NOT use outdoors.
- Always place dehumidifier on a firm, flat, level surface. A waterproof mat or pad is recommended for under the dehumidifier. NEVER place it on a surface that may become damaged by exposure to water and moisture (i.e. finished floor).
- Unplug the appliance before filing or cleaning.
- Turn off and unplug the unit before moving. Move the unit slowly and carefully.
- DO NOT attempt to remove the water tank within 15 minutes after the dehumidifier is turned off and unplugged.
- This dehumidifier requires regular maintenance to operate appropriately. Refer to Care and Cleaning section.
- NEVER use detergents, petrol, glass cleaner, furniture polish, paint thinner, or other household solvents to clean any part of the dehumidifier.
- Any repairs to the product must be carried out by qualified electrical person only or the product must be disposed of. There are no user serviceable parts in this appliance.
- If the supply cord is damaged, it must be replaced by the manufacturer, its service agent or similarly qualified persons in order to avoid a hazard.
- This appliance is not intended for use by persons (including children) with reduced physical, sensory or mental capabilities, or lack of experience and knowledge, unless they have been given supervision or instruction concerning use of the appliance by a person responsible for their safety.
- Children should be supervised to ensure that they do not play with the appliance.

**FOR HOUSEHOLD USE ONLY  
READ AND SAVE THESE INSTRUCTIONS**

## CAUTION

- In order to avoid a hazard due to inadvertent resetting of the thermal cutout, this appliance must not be supplied through an external switching device, such as a timer, or connected to a circuit that is regularly switched on and off by the utility.
- ONLY use the Power Supply which was supplied with this appliance. Model No.: IVP-1200-2500S

## 2. COMPONENTS

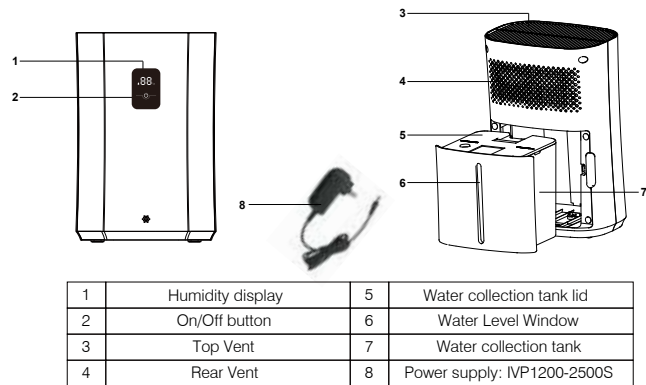

## 3. BEFORE FIRST USE

**IMPORTANT!** Always place dehumidifier on a firm, flat, level surface. A waterproof mat or pad is recommended for under the dehumidifier. NEVER place it on a surface that may become damaged by exposure to water and moisture (i.e. wood floor, wood table etc.,).

- Before using the Dehumidifier, please set up as follow:
- Fully unravel the power lead from adaptor.
- Plug the DC plug of power supply into the dehumidifier.
- Fit the lid to the Water Collection Tank and slide into the back of the unit.

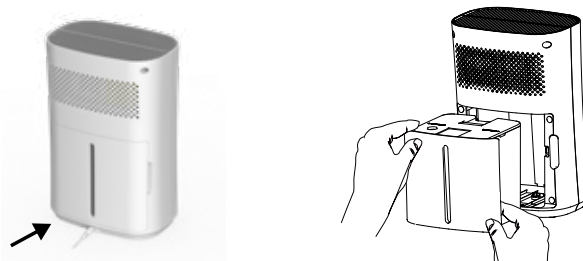

- Note: Unless the water collection tank is fitted correctly to the unit, the appliance will not turn on.

#### 4. Operation

Important: Refer to the Section "BEFORE FIRST USE" prior to Operation.

- Plug the Power Supply into a suitable electrical outlet and switch on power socket outlet.
- All indicators will flash once then remain dark screen, the unit is now in standby mode.



##### 4.1 ON / OFF

- Press the ON/Off button to turn on the unit. The ambient humidity level will display.



- To turn off the unit, press the On/Off button again.

##### 4.2 Water Collection Tank Full

- When the water tank is full, the water full alarm will illuminate RED and the appliance will no longer function until the tank is emptied.



- To empty the Water Collection Tank, first unplug the power supply from the power point.
- Grasp the Water collection tank at two sides and slide straight out, taking care not to spill the water.
- Take to your sink and pour out, then refit the tank.

#### 5. Care and Cleaning

Turn OFF and unplug the unit from mains power prior to cleaning.

##### 5.1 Water Collection Tank

- Remove the Water Collection Tank and lid, wash in clean lukewarm soapy water and rinse thoroughly.

- Allow to fully dry prior to reusing.
- Do Not place in a Dishwasher.

##### 5.2 Main Unit

IMPORTANT: Never spray with liquids or submerge the unit in water or any other liquid.

Do Not use flammable liquids, chemicals, abrasive creams, steel wool or scouring pads for cleaning.

- Wipe the unit over with a damp (not wet) cloth with fresh clean lukewarm water and mild detergent.
- Wipe over again to remove any detergent residue and thoroughly dry prior to reusing.
- Do not let water or any liquid enter any of the vents. Important: Do Not poke any objects into the vent holes.

#### 6. Storage

- Switch off and unplug the unit from mains power.
- Ensure all water is removed from the water tank and is perfectly dry.
- Coil the power cord loosely and place the power supply next to the unit.
- Store in a dry well-ventilated area.

#### 7. SPECIFICATION

<b>MODEL NO.</b>	DS00-22096
<b>POWER SUPPLY</b>	IVP 1200-2500S I/P: 100-240V~ 50/60Hz O/P: 12V 2.5A
<b>DEHUMIDIFYING RATE</b>	380 ml/day ± 10% @30°C, 80%RH
<b>TANK CAPACITY</b>	2.5L

#### 8. Warranty Against Defect

##### 12 Month Warranty

Thank you for your purchase.

Your new product is warranted to be free from defects in materials and workmanship for the period stated above, from the date of purchase, provided that the product is used in accordance with accompanying recommendations or instructions where provided. This warranty is in

addition to your rights under the Australian Consumer Law.  
For New Zealand customers, this warranty is in addition to statutory rights observed under New Zealand legislation.

We will provide you with your choice of a refund, repair (where possible) or exchange (availability dependent) for this product if it becomes defective within the warranty period. The business will bear the reasonable expense of claiming the warranty.  
This warranty will no longer apply where the defect is a result of alteration, accident, misuse, abuse or neglect.

Please retain your receipt as proof of purchase and contact our Customer Service Centre as listed below, for the entity you purchased this product from, for any difficulties with your product. Warranty claims and claims for expense incurred in returning this product can be addressed to the respective Customer Serviced Centre.

Our goods come with guarantees that cannot be excluded under the Australian Consumer Law. You are entitled to a replacement or refund for a major failure and compensation for any other reasonably foreseeable loss or damage.  
You are also entitled to have the goods repaired or replaced if the goods fail to be of acceptable quality and the failure does not amount to a major failure.

<b>Contact for Kmart purchases</b>	<b>Contact for Target purchases</b>
Kmart Australia Ltd. C/- Customer Service Centre 690 Springvale Road, Mulgrave Vic 3170 Customer Service: 1800 124 125 (Australia) or 0800 945 995 (New Zealand) or via Customer Help at <a href="http://kmart.com.au">kmart.com.au</a>	Target Australia Pty Ltd C/- Customer Service Centre 2 Kendall Street, Williams Landing, Vic, 3027 Customer Service: 1300 753 567 or via Customer Help at <a href="http://target.com.au/help/contact-us">target.com.au/help/contact-us</a>