

anko

Body Groomer Instruction Manual



Model No.: RFC-1570
Save these instructions for future reference.

SAFETY GUIDE - PLEASE READ CAREFULLY BEFORE USING THIS APPLIANCE

Please follow all the precautions listed below for safety and to reduce the risk of injury or electric shock.



WARNING: READ ALL INSTRUCTIONS; FAILURE TO FOLLOW ALL INSTRUCTIONS LISTED BELOW MAY RESULT IN ELECTRIC SHOCK, OR SERIOUS PERSONAL INJURY.

SAVE THE INSTRUCTION MANUAL FOR FUTURE REFERENCE

1. Only use the appliance as described in this manual.
2. This appliance contains batteries that are non-replaceable.
3. To protect against the risk of electric shock, DO NOT immerse the appliance, USB cable in water or other liquid.
4. DO NOT use or store the product near sinks, bath or showers containing water or near running water.
5. Always check the appliance for damage prior to use. If any damage is observed, do not use the appliance.
6. The appliance is intended for indoor use only.
7. Always switch the appliance OFF after use.
8. This appliance has no user serviceable parts. Do not attempt to access the internal components in the appliance.
9. This appliance is for personal use only, not designed for commercial use.
10. Do not use it outdoors.
11. **Do not use** the appliance if it is not working properly, if it has been dropped or if it has been immersed in any liquid.
12. Before using the appliance, ensure that the trimmer head is securely fitted and not damaged.
13. Do not use the appliance on children.
14. The appliance is not to be used by persons (including children) with reduced physical, sensory or mental capabilities, or lack of experience and knowledge, unless they have been given supervision or instructions concerning use of the appliance by a person responsible for their safety.
15. Children should be supervised to ensure that they do not play with the appliance.
16. Only Charge the Appliance with the USB cable that was supplied with the appliance.
17. Only Charge the Appliance from an Extra Low Voltage Battery Charger (not supplied) with an output rating 5Vd.c. 1A, same as indicated on the appliance's rating label.
18. When charging the appliance, the appliance must be turn off.
19. Use only attachments provided.
20. This product contains sharp blades, please take utmost care during handling and use.
21. Do not replace the batteries with non-rechargeable batteries.
22. To avoid personal injury, do not use the appliance if has a damaged trimmer head or blade.
23. The appliance must be used only with provided attachments.



WARNING: Do not recharge non-rechargeable batteries.



WARNING: Before charging the product, please make sure your hands are dry.



WARNING: Only use the USB cable supplied with the appliance. Use of other cable may cause electrical failure and/or fire.

PERSONAL SAFETY

- Never use the appliance on any part of the body other than trimming the hair and beard.
- **IMPORTANT! Do not use the appliance if the trimmer head is split or broken.**
- Never leave the appliance unattended while switched on.
- Do not touch the blades as they are very sharp.
- Always ensure that the hands are dry before operating or when switching it ON or OFF.

PARTS

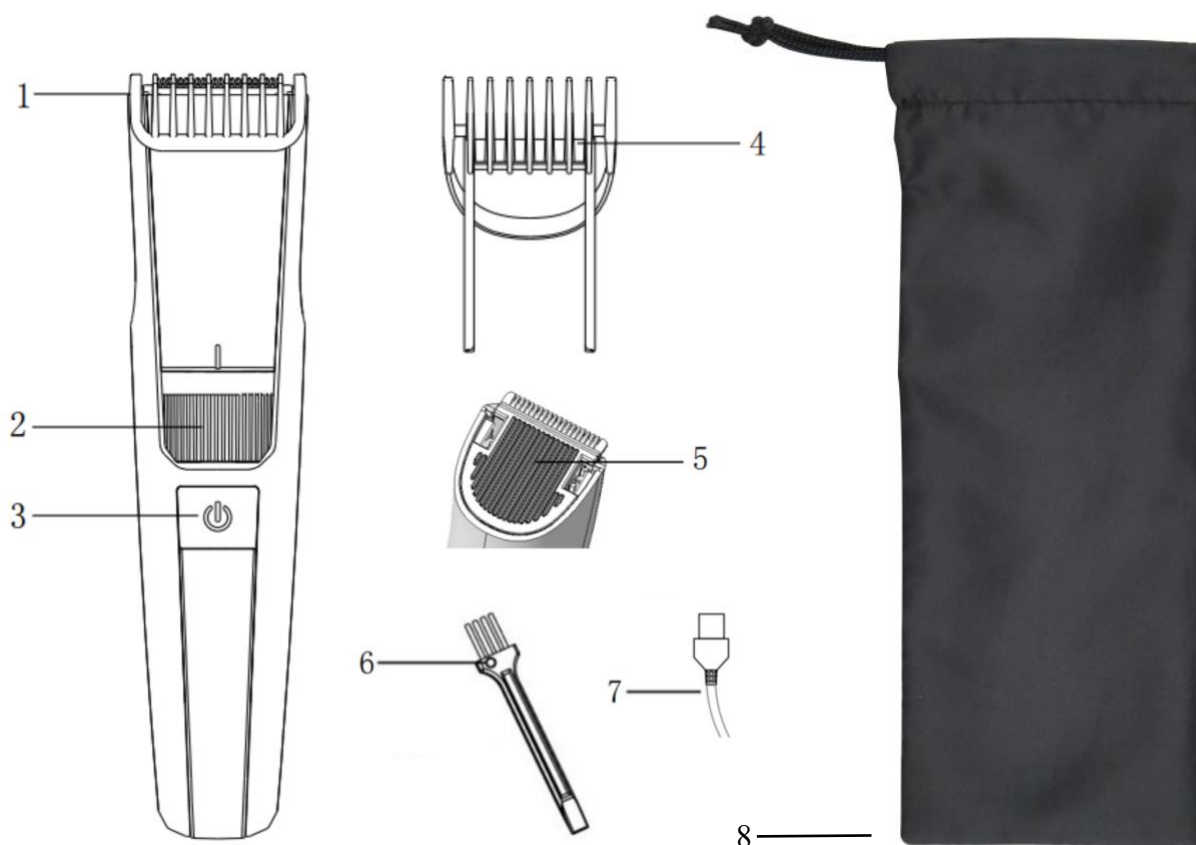

1	Comb attachment 1 (1-10mm)	5	Trimmer blade
2	Cut length dial	6	Cleaning brush
3	On/Off switch	7	USB cable
4	Comb attachment 2 (11-20mm)	8	Pouch

CHARGING

- Please make sure the shaver is switched OFF before charging.
 - Fully charge the appliance for approx. 1.5 hours before first use.
- NOTE: Normal charging time of the appliance is approx. 1.5 hours. Do not charge for more than 1.5 hours.
- When fully charged, the number on the display will show 99, and the shaver can be used continuously work for approx. 90 minutes.

IMPORTANT! Use only with the USB cable provided.

BATTERY CARE

To ensure maximum life of the rechargeable battery in your Trimmer, follow these guidelines:

- Do not recharge the appliance between sessions. Wait until the battery is exhausted before recharging.
- Discharge the battery completely at least twice a year (switch on and run until the appliance stops).
- If the appliance has not been used for a long period of time, discharge the battery completely, then fully charge it for approx. 1.5 hours before use.
- Never charge the appliance for more than 1.5 hours.
- Do not charge the appliance when the temperature is below 0°C or above 40°C.
- Avoid recharging the appliance in direct sunlight or near a radiating heat source.

OPERATING INSTRUCTIONS



WARNING:

Switch OFF the device before replacing or changing attachments.

1. Press On/Off switch once and ensure no display, this means the trimmer is OFF now.
2. Mount the comb attachment and adjust the length setting to give the desired trimming length.
3. Press On/Off switch to turn ON the trimmer.
4. Trim against hair growth by guiding the flat comb part over the skin.
5. Avoid clogging the comb with hair, remove and clean it periodically.

INSTALLING THE COMB ATTACHMENTS

- Make sure the trimmer is turned OFF before installing the comb.
- To cut the hair very short or a beard or contours, use the product without comb attachments.
- To install the comb attachment, align the arms of the comb into the slots of main body. Gently push the comb until it clicks in place.
- The blade height can be finely adjusted by rotating the Cut Length dial from 0.5mm to 10mm with Comb Attachment 1, and 10.5 to 20mm with Comb Attachment 2.
- To take off the comb attachment, just pull it off from the trimmer.



BLADE REMOVAL

CAUTION!

Risk of injury! Handling the hair trimmer improperly may result in injury.

The Blade assembly can be removed for deep cleaning or for replacing a worn blade.

To remove the blade assembly, hold the appliance and press the blade assembly forward. The blade assembly will pop out.

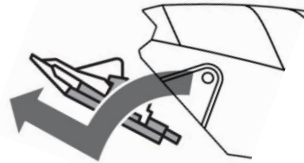

To install the blade assembly, align the back of the blade assembly with main unit, swing closed and push towards the main unit until it locks in place.



TRAVEL LOCK

- The Trimmer has switch lock function to prevent the unit from turning on accidentally.
- To set the lock, press and hold the On/Off switch for 3 seconds, the display flashes then goes off, the trimmer is now locked.
- To exit lock mode, press and hold the On/Off switch for 3 seconds until digits shown on display and the trimmer starts.
- If start charging in a lock mode, the unit will exit lock mode automatically.

CLEANING AND MAINTENANCE

- Make sure to switch OFF the appliance and it is disconnected from USB cable before cleaning.
- Remove the comb attachment and blade assembly.
- Brush off any hair trimmings around the blade and main body.
- Rinse off any hair trims that are sticking to the blades with running water.
- Gently shake the cutting blade then wipe off the water.
- The cutting blades should be lightly oiled with the sewing machine oil every few months of use directly to the trimming blade.
- The body of trimmer is not washable. DO NOT submerge in water or other liquid.

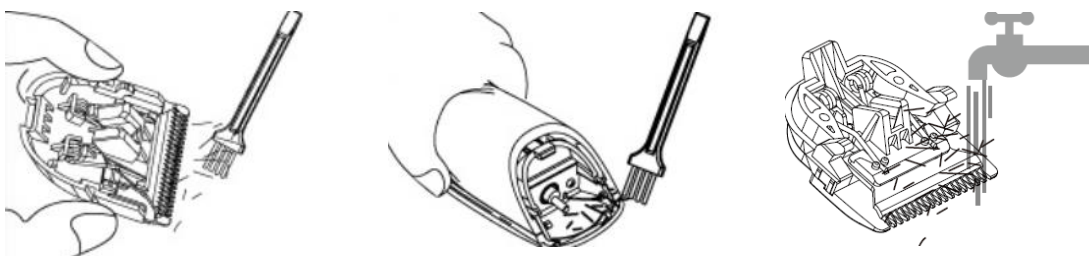

STORAGE

1. Switch OFF the appliance and clean all components.
2. Make sure that all parts are completely dry.
3. Store the appliance and accessories in a cool, dry location.
4. Make sure that the trimmer and the accessories are out of the reach of children and pets.

BATTERY DISPOSAL

If the appliance is to be disposed the batteries should be removed from the appliance before it is scrapped. The appliance must be disconnected from power supply when removing the battery. The battery should be disposed safely. Used batteries should be taken to a recycling facility and not disposed of with household waste.

IMPORTANT: Always fully discharge the battery before removal and ensure the charger is unplugged.

TECHNICAL SPECIFICATIONS

Model no.	RFC-1570
Working time	Approx. 90 minutes
Charging time	Approx. 1.5 hours
Battery type	Li-ion, 800mAh, 3.7V x1 cell
Water resistant	IPX7

12 Month Warranty

Thank you for your purchase from Kmart.

Kmart Australia Ltd warrants your new product to be free from defects in materials and workmanship for the period stated above, from the date of purchase, provided that the product is used in accordance with accompanying recommendations or instructions where provided. This warranty is in addition to your rights under the Australian Consumer Law.

Kmart will provide you with your choice of a refund, repair or exchange (where possible) for this product if it becomes defective within the warranty period. Kmart will bear the reasonable expense of claiming the warranty. This warranty will no longer apply where the defect is a result of alteration, accident, misuse, abuse or neglect.

Please retain your receipt as proof of purchase and contact our Customer Service Centre on 1800 124 125 (Australia) or 0800 945 995 (New Zealand) or alternatively, via Customer Help at Kmart.com.au for any difficulties with your product. Warranty claims and claims for expense incurred in returning this product can be addressed to our Customer Service Centre at 690 Springvale Rd, Mulgrave Vic 3170.

Our goods come with guarantees that cannot be excluded under the Australian Consumer Law. You are entitled to a replacement or refund for a major failure and compensation for any other reasonably foreseeable loss or damage. You are also entitled to have the goods repaired or replaced if the goods fail to be of acceptable quality and the failure does not amount to a major failure.

For New Zealand customers, this warranty is in addition to statutory rights observed under New Zealand legislation.