

5+ YEARS



PIE SURPRISE



CONTENTS

- 1 pie thrower •1 throwing arm •2 handles •1 chin rest
- 1 splash card mask •1 spinner •1 sponge

SET-UP

1. Insert the mask on the thrower, between the chin rest slot and retaining clips at the front.
2. Push the chin rest into the slot on the thrower, allowing it to further secure the mask in place. Be careful not to bend the mask.
3. Gently push the handles into place on both sides of the thrower. Make sure the slots correspond accordingly.
4. Push the throwing arm into the slot on the triggering mechanism without turning the handles.

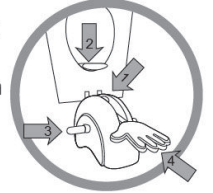

NOTE:

To avoid injury, use only the included sponge with clean water or instead use your own whipped cream. Do not use other materials or objects. Thoroughly wipe clean the product before and after each use.

HOW TO PLAY

Player take turns spinning the spinner to decide how many times the handles must be turned. Place your chin on the chin rest through the mask and turn the handles forward the required number of clicks. The first player to score 25 points is the winner!

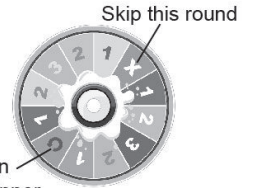

HOW TO SCORE

Full turn: If you complete your turn without getting hit with whipped cream, you will score double the number of points you spun. (Example: If you spin a two, turn the handles twice and don't get hit with whipped cream, you score four points.)

If you do get hit with the whipped cream, you will score no points.

Partial turn: You can elect to turn the handles fewer times than the number you've spun. You must announce how many times you'll turn them instead before turning the handles. If you don't get hit with whipped cream, you will score one point for each time you turned the handles. (Example: If you spin a three, decide to turn the handles only twice and don't get hit with whipped cream, you score two points.) If you do get hit with the whipped cream, you will score no points.

Note: You score doubles only if you take your full turn.

WARNING: FOR SAFETY REASONS, REMOVE ALL TAGS, LABELS, AND PLASTIC FASTENERS BEFORE GIVING THIS TOY TO YOUR CHILD.

WARNING: CHOKING HAZARD
SMALL PARTS. NOT FOR CHILDREN UNDER 3 YEARS



2-4 Players Keycode:43264377

ADULT ASSEMBLY REQUIRED.
PLEASE KEEP THE PACKAGING FOR FUTURE REFERENCE.
PRODUCT MAY VARY SLIGHTLY FROM THE IMAGE SHOWN.