

# Rainbow Sprinkler Slide

Key Code: 43266715

## Set up Instructions

Step 1. Spread the product on a flat and free of sharp points/edges object area. Open the water inlet valve which located at the bottom of two sides, and fill with water through the four vales separately, make sure to close the water inlet valves securely after filled till the water overflow from the inlet valve.

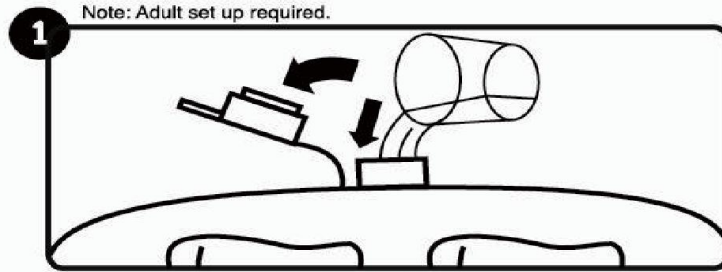

Step 2. Open the air valves, inflate the product by the following sequence:

- 1). The air valve located at the bottom of side base nearby water inlet valve.
- 2). The two air valves located at the bottom of two baffle plate nearby water connector.
- 3). The air vales at the end of slide.

Make sure to close the air valves firmly and press to let it to be inserted inside. Please refer below images.

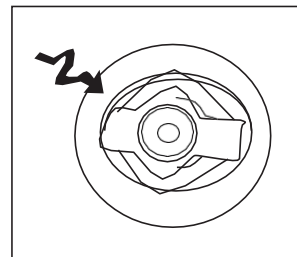
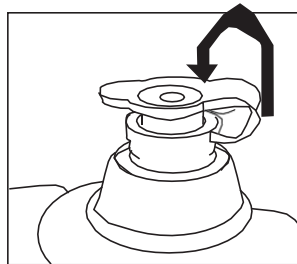
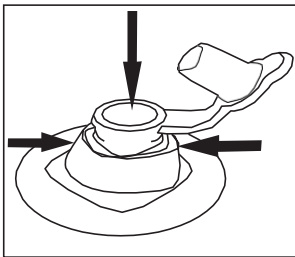

Step 3. Attach a garden hose on each of the two water connectors which located at the back bottom.

Adjust the water pressure according to your request if needed. You can fun now.

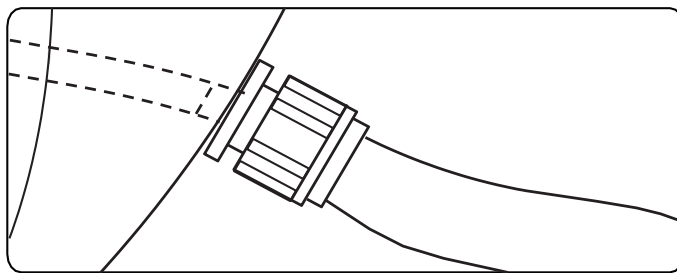

## Repair Instructions

If the product is damaged, please use the provided repair patch.

1. Completely deflate and drain the product.
2. Clean and dry the damaged area.
3. Carefully peel patch. Press patch over the area to be repaired.
4. Wait 20 minutes before inflation.

## Safety Information and Maintenance

- This product is intended to be used as a toy and not as a floating device.
- Water left inside the garden hose or product for an extended period may become very hot. Allow water to run a short time before each use.
- Before each use, remove any accumulated debris and carefully check if there are any leaks or damaged parts to avoid any potential injury when in use.
- Drain product, wipe clean with damp cloth before storage. Don't use abrasive material or solvents.
- Store in a cool, dry place and out of children's reach when not in use.
- Do not place on stones, sticks or any sharp objects that may puncture the product.
- Improper installation may reduce its function, and could reasonably result in the creation of the potential hazards.
- Maximum user weight limit: 45kg.
- Suitable for age 5 years and above.
- Place this product on level ground and at least 1.8m away from a fence, building, overhead branches, laundry line or electrical wires.
- This product should be installed on a flat impact absorbing surface such as sand, wood-bark chips, rubber and foam. Don't installed over concrete, asphalt or any other hard surface.
- It is recommended that the product be placed under the shade of the sun. The surface may become hot enough under direct sunlight and cause burning injuries to health.

## Warning

- 1). Inflate the item with either a foot pump, hand pump or low pressure electric pump. Don't use a high pressure compressor.
- 2). This toy is not safe if the anchorage system is not used as it may be lifted by light winds. Do not use in high winds.
- 3). Use of this product may cause friction burns to exposed skin. Ensure that clothing fully covers arms and legs, as well as the torso.
- 4) . Keep instruction manual for further reference.

 **WARNING: CHOKING HAZARD**  
SMALL PARTS. NOT FOR CHILDREN UNDER 3 YEARS.

**CAUTION:** THE BASE NEEDS TO BE FILLED WITH WATER BEFORE INFLATION. THE WATER FILLING NOZZLES ARE ON THE BOTH SIDE OF THE BASE.

**WARNING:** FOR SAFETY REASONS REMOVE ALL TAGS LABELS AND PLASTIC FASTENERS BEFORE GIVING THIS TOY TO YOUR CHILD.

**WARNING:** ADULT ASSEMBLY REQUIRED. USE ONLY UNDER ADULT SUPERVISION. KEEP AWAY FROM FLAME AND HEAT SOURCE. AVOID EXCESSIVE HEAT. DO NOT PRESS THE TOY AGAINST SHARP OBJECTS, USE ON A FLAT AND EVEN SURFACE.

**WARNING:** THE TOY IS FOR DOMESTIC USE ONLY. THE TOY IS INTENDED FOR OUTDOOR USE. ONLY FOR ONE CHILD USE.

**FOR AU/NZ: IMPORTED FOR KMART STORES IN AUSTRALIA AND NEW ZEALAND.**

Made in China