

CAMP CARAVAN CLOTHESLINE INSTRUCTIONS

Keycode: 43268429

Please read completely before setting
up your CAMP CARAVAN CLOTHESLINE

Warning!

1. Never set up or continue to use in any rain, wind or stormy conditions, especially lightning storms.
2. Avoid bending the frame or pinching your fingers or hands while opening or closing the frame.
3. Avoid setting up your clothesline on steep inclines.
4. Keep the clothesline away from heat and flames at all times.
5. 3 steel pegs must be used to keep stable.
6. Please keep the weight evenly hung on all four sides when drying clothes.
7. Do not place any items on three support legs.
8. Never fold or store your clothesline when it is wet or damp. Let it dry completely to avoid mildew.
9. Never use the clothesline if it is damaged.

WARNING:
3 STEEL PEGS MUST BE USED.
KEEP THE WEIGHT EVENLY HUNG ON ALL FOUR SIDES WHEN DRYING CLOTHES.
DO NOT PLACE ANY ITEMS ON THREE SUPPORT LEGS.

ATTENTION: To avoid any damage, remove the clothesline during bad weather, e.g., during high winds or heavy rains.

Assembly Instructions

Follow these instructions carefully to avoid pinching your hands or fingers in any of the moving parts as the frame opens and closes.

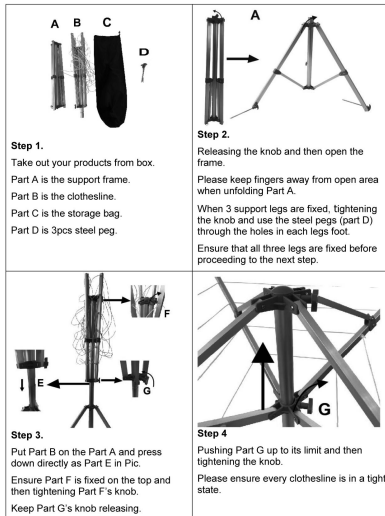

CAUTION: BE CAREFUL TO KEEP THE WEIGHT EVENLY HUNG ON ALL FOUR SIDES WHEN DRYING CLOTHES.

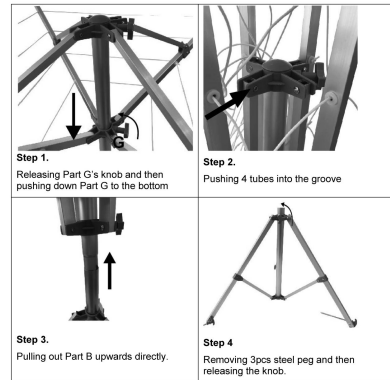
Disassembly Instructions

CAUTION: BE CAREFUL NOT TO PINCH FINGERS. DO NOT PUSH HARD.
Final having made sure the clothesline material is completely dry return your fold up clothesline to its storage bag.

MADE IN CHINA