

anko

230 Litre Upright Refrigerator **Quick Start Guide**

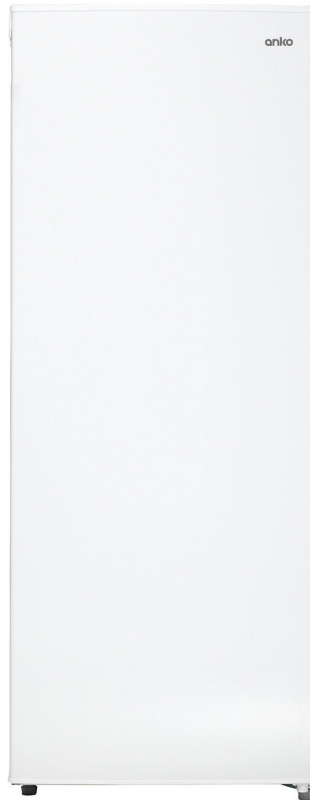

Model no: AUL237W

Rev: 01

A simple guide to start using your 230 Litre Upright Refrigerator

› Installation Tips

Two person installation: Use two or more people to move and install the appliance. Failure to do so can result in back or other injury.

Freestanding design: This appliance is designed to be freestanding only, and should not be recessed or built-in.

Floor surface: This appliance must be properly positioned on a dry, sturdy, level surface that is strong enough to support it when it is fully loaded.

Ambient temperature: The ambient temperatures must correspond to the climate class (T) indicated on the rating plate of the appliance: 16°C – 38°C.

Clearances: Ensure that air can circulate freely around the back of the cabinet, which is necessary to cool the compressor and condenser. Allow at least 10cm clear space at the back, 10cm at the sides of the unit and 30cm between the top and any surface above. If you are installing your refrigerator next to a fixed wall, leave sufficient space on the hinge side to allow for the door to swing open.

Note: For further installation instructions please refer to the user manual.

Temperature Control

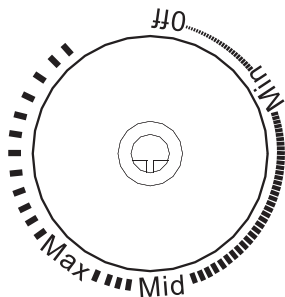

Your fridge has one control for regulating the temperature. The temperature controls are located on the inside inside wall of the refrigerator, visible only when the door is open.

- 'Min' provides a cool temperature.
- 'Mid' is suitable for normal operation.
- 'Max' provides the coolest temperature.

› First Use

When starting up for the first time, keep the refrigerator upright for a minimum of 2 hours before connecting to the power supply. Before putting any fresh or frozen foods in the fridge, ensure the fridge has run for 2–3 hours, or for at least 4 hours in summer when the ambient temperature is high.

› Product Specifications

Capacity	230L
Dimensions (h,w,d)	1420 x 550 x 550mm
Net Weight	36.5kg
MEPS	2 Stars

› Need Help?

For all questions or customer support please contact us using the details below.

Phone 1800 124 125 (Australia)
Online www.kmart.com.au

anko

230L Upright Refrigerator Instruction Manual

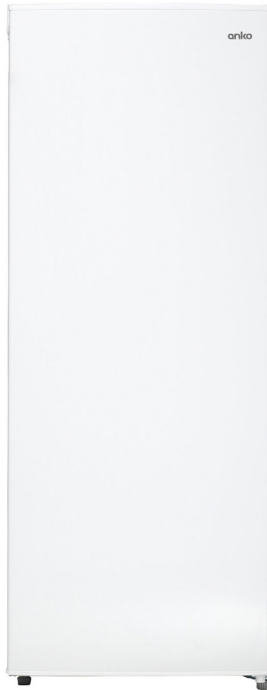

Model no: AUL237W

Rev: 01

Purchase Details



For future reference, please record the following information which can be found on the rating plate and the date of purchase which can be found on your sales invoice.

The rating plate is located on the rear of the appliance. Therefore please fit the duplicate data plates or label on the outside of the cupboard to sure that the label can be easily seen during operation.

STORE DETAILS

STORE NAME | _____

ADDRESS | _____

TELEPHONE | _____

PURCHASE DATE | _____

PRODUCT DETAILS

MODEL NO. | _____

SERIAL NO.* | _____

Contents	2	Purchase Details
	4	General Safety Instructions
	8	Getting Started
	9	Installation Instructions
	12	Your Upright Refrigerator
	13	Using Your Upright Refrigerator
	14	Usage Tips
	14	Energy Saving Tips
	15	Maintenance and Cleaning
	16	FAQ'S and Troubleshooting
	18	Product Specifications
	19	Warranty

To ensure proper operation of this device, please read this instruction manual carefully before using the device and keep it for future reference.

General Safety Instructions

IMPORTANT SAFETY INSTRUCTIONS READ CAREFULLY AND KEEP FOR FUTURE REFERENCE

Read this manual thoroughly before first use, even if you are familiar with this type of product. The safety precautions enclosed herein reduce the risk of fire, electric shock and injury when correctly adhered to. Make sure you understand all instructions and warnings.

Keep the manual in a safe place for future reference, along with the completed warranty card and purchase receipt. If you sell or transfer ownership of this product, pass on these instructions to the new owner.

Always follow basic safety precautions and accident prevention measures when using an electrical appliance, including the following:

IMPORTANT: Pay particular attention to messages that contain the words **DANGER**, **WARNING** or **CAUTION**. These words are used to alert you to a potential hazard that can seriously injure you and others. The instructions will tell you how to reduce the chance of injury and let you know what can happen if the instructions are not followed.



**CAUTION
RISK OF FIRE**

This symbol alerts you to take care as this appliance contains a flammable refrigerant (isobutane) and insulation blowing gas (cyclopentane). Do not expose it to high heat, sparks and open flames.

The refrigerant isobutane (R600a) is contained within the refrigerant circuit of the appliance, a gas with a high level of environmental compatibility, which is nevertheless flammable. During transportation and installation of the appliance, ensure that none of the components of the refrigerant circuit become damaged.

WARNING: Do not damage the refrigerant circuit! Never use an appliance with a damaged refrigerant circuit! If the refrigerant circuit becomes damaged, avoid proximity to open fires and all types of heat and ignition sources. Thoroughly ventilate the room in which the appliance is located.

DANGER: It is hazardous for anyone other than an authorised service person to service this appliance. In Queensland, the authorised service person **MUST** hold a Gas Work Authorisation for hydrocarbon refrigerants to carry out servicing or repairs which involve the removal of covers. The room for installing the appliance must be at least 1m³ per 8g of refrigerant. The amount and type of refrigerant in the appliance can be found in the Product Specifications on page 18 and on the rating plate, found on the appliance.

General Safety Instructions

General Safety Instructions Cont.

Usage Conditions and Restrictions

- › **Domestic use only:** This appliance is intended for indoor household use only. It is not intended for commercial, industrial or outdoor use. It is not intended for use in a recreational vehicle.
- › **Purpose:** Do not use this appliance for anything other than its intended purpose. Other uses are not recommended and may cause fire, electric shock or personal injury.
- › **Attachments:** The use of attachments is not recommended by the appliance manufacturer and distributor as they may be hazardous.
- › **Improper use:** Damage due to improper use, or repairs made by unqualified personnel will void your warranty. We assume no liability for any eventual damages caused by misuse of the product or non-compliance with these instructions.

Never use this appliance with a damaged refrigerant circuit! If the coolant circuit becomes damaged, avoid proximity to open fires and all types of heat sources. The room in which the appliance is located should be ventilated for a few minutes.

- › **WARNING:** Do not use mechanical devices or other means to accelerate the defrosting process, other than those recommended by the manufacturer.
- › **Usage restriction:** This appliance is not intended for use by persons (including children) with reduced physical, sensory or mental capabilities, or lack of experience and knowledge, unless they have been given supervision or instructions concerning use of the appliance by a person responsible for their safety.
- › **Children:** Supervise young children to ensure they do not play with the appliance. Never allow children to operate, play with or crawl inside the appliance.
- › **WARNING:** Do not use electrical appliances inside the appliance, unless they are of the type recommended by the manufacturer.
- › **Explosive or flammable substances:** Do not store explosive substances such as aerosol cans with a flammable propellant in this appliance. Do not store or use petrol or any other flammable vapours and liquids in the vicinity of this or any other appliance. Do not use such substances for cleaning the appliance. The fumes can create a fire hazard or an explosion.
- › **Damage:** Do not use the appliance if the power cord, plug or the appliance itself is damaged. If the cord is damaged, contact the after sales support line and have the cord replaced by qualified personnel in order to avoid a hazard.
- › **WARNING:** Do not damage the refrigerant circuit.
- › **Do not modify:** Do not attempt to alter or modify this appliance in any way.
- › **Repair:** Do not attempt to repair or replace any part of this appliance unless it is specifically recommended in this manual. All other servicing should be referred to a qualified technician. Contact the after sales support line for advice.
- › **Using:** The gaps between refrigerator doors and between doors and refrigerator body are small. Do not put your hand in these areas. Please be gentle when closing the refrigerator door to avoid falling articles.
Do not pick up frozen items with wet hands in the freezing chamber when the refrigerator is running, especially metal containers in order to avoid frostbite.
- › **Storage:** This product is a household freezer and shall be only suitable for the storage of foods. According to national standards, household freezer shall not be used for other purposes, such as storage of blood, drugs or biological products.
- › **WARNING:** Do not locate multiple portable socket-outlets or portable power supplies at the rear of appliance.

General Safety Instructions

General Safety Instructions Cont.

Electrical Safety

- › **Voltage:** Before connecting and turning on the appliance, ensure the electrical voltage and circuit frequency correspond to that indicated on the appliance rating label.
- › **Earthing:** This appliance should be properly earthed for your safety. The power cord of this appliance is equipped with a three-prong plug for use in standard wall outlets to minimise the possibility of electrical shock. Do not modify the cord and/or plug provided with the appliance. Improper use of the earthed plug can result in the risk of electric shock.
- › **Connection:** This appliance requires a standard 220-240 V AC 50Hz electrical outlet. Do not overload the electrical circuit.
Power socket: Please use a dedicated power socket and do not share the power socket with any other electrical appliances. The power plug should be firmly connected to the socket or else fires might be caused.
- › **Power cord:** Do not kink or damage the power cord; do not leave it exposed or dangling. Secure it at the back of the appliance so no one steps on or places anything on the cord or against it. Keep the cord out of reach of children. When moving the appliance, make sure not to damage the power cord.
- › **WARNING:** When positioning the appliance, ensure the supply cord is not trapped or damaged.
- › **Auxiliary Items:** Do not use an inverter, adaptor or extension cord with this appliance. If the cord is too short, have a qualified electrician install an outlet near the appliance. Use of an extension cord and an inverter can negatively affect the performance of the unit.
- › **Protect from moisture:** To protect against the risk of electric shock, do not immerse the unit, cord or plug in water or spray it with any other liquid. Do not connect or disconnect the electric plug when your hands are wet. Turn the power switch off before removing the plug from the socket.
- › **WARNING: Disconnect!** To reduce the risk of fire, electric shock or personal injury, always unplug the appliance from the socket when not in use, when moving and before cleaning or servicing. Never unplug the unit by pulling the power cord. Always grip the plug firmly and pull straight out from the power point.
- › **Electrical work:** Any electrical work required for the installation of this appliance should be carried out by a qualified electrician.

WARNING: Never use this appliance with a damaged refrigerant circuit!

If the coolant circuit becomes damaged, avoid proximity to open fires and all types of heat sources. The room in which the appliance is located should be ventilated for a few minutes.

Installation

Heavy: This appliance is heavy, take care when moving it. To avoid back or other injury, consider a two person lift or mechanical aid when installing it. Failure to do so can result in back or other injury.

Damage: When unpacking, check the appliance carefully for damage. If it is damaged, do not install the appliance. Contact our after sales support centre on 1300 43 57 for advice on examination or return of the damaged appliance.

Protect from moisture: Install the appliance in an indoor area protected from wind, rain, water spray or drips.

Protect from heat: Do not install the appliance next to an oven, grill or other source of high heat, or where it will be exposed to direct sunlight for prolonged periods of time.

WARNING: Ventilation: To ensure proper ventilation, keep any ventilation openings, in the appliance enclosure or in the built-in structure, clear of obstructions. Ensure adequate air circulation around the appliance to prevent overheating.

Level: Install the appliance level in order to ensure proper operation.

General Safety Instructions

General Safety Instructions Cont.

Cleaning and Maintenance

Disconnect: Unplug the appliance before cleaning or servicing. Failure to do so can result in electric shock, injury or death. Do not connect or disconnect the plug when your hands are wet.

Flames: Do not let open flames or ignition sources enter the appliance.

Flammable/explosive substances: Never clean this appliance with flammable fluids.

Do not store or use volatile, flammable or explosive propellants or liquids in or close to this or any other appliance. The fumes can create a fire hazard or explosion.

Solvents: Do not use solvent based cleaning agents or abrasives on the interior as these may damage or discolour the surfaces of the appliances.

WARNING! Do not use mechanical devices or other means to accelerate the defrosting process.

Never use a sharp or metal instrument to remove frost or clean the appliance. Use a plastic scraper, if necessary.

Service: Do not attempt to repair, modify or replace any part of the appliance unless specifically recommended in this manual. Refer all other servicing to a qualified technician, or contact the after sales support line for advice on examination or repair of the appliance.

Responsible disposal

Note: At the end of its working life, do not throw this appliance out with your household rubbish.

Electrical and electronic products contain substances that can have a detrimental effect on the environment and human health if disposed of inappropriately. Observe any local regulations regarding the disposal of electrical consumer goods and dispose of it appropriately for recycling and recovery of the refrigerant and blowing agent. Contact your municipal authorities for advice on recycling facilities in your area.

WARNING! This refrigeration appliance contains flammable refrigerants and insulation blowing gases, which must be removed before disposal. Contact your municipal authorities for any codes or regulations concerning the disposal of such materials.

Getting Started

Unpacking

- › **Packaging materials:** This appliance has been packaged to protect it against transportation damage. Remove all packaging materials from around and inside the appliance and keep the original packaging carton and materials in a safe place. It will help prevent any damage if the product needs to be transported in the future, and you can use it to store the appliance when it is not in use. In the event the carton is to be disposed of, please recycle all packaging materials where possible.
- › **Suffocation:** Plastic wrapping can be a suffocation hazard for babies and young children, so ensure all packaging materials are out of their reach and disposed of safely.
- › **Power cord:** Unwind the power cord to its full length and inspect it for damage. Do not use the appliance if it or its cord have been damaged or are not working properly. In case of damage, contact our after sales support line for advice on examination, repair or return of the damaged product.
- › **Read the manual:** Read this manual to familiarise yourself with the appliance. Pay particular attention to the safety instructions on the previous pages.
- › **Clean:** To remove any dust from transit and storage, clean the interior and exterior surfaces of the appliance with lukewarm water and a soft cloth. Dry thoroughly. **Important:** do not use harsh or abrasive detergents or powders as these will damage the finish.

Installation Instructions

Installation

- › **Two person installation:** Use two or more people to move and install the appliance. Failure to do so can result in back or other injury.
- › **Freestanding design:** This appliance is designed to be freestanding only, and should not be recessed or built-in.
- › **Placement:** This appliance must be properly positioned on a dry, sturdy, level surface that is strong enough to support it when it is fully loaded. It should be placed in an indoor area that is well ventilated and away from direct sunlight.
- › **Ambient temperature:** The ambient temperatures must correspond to the climate class (T) indicated on the rating plate of the appliance: 16°C – 38°C
- › **Clearances:** Ensure that air can circulate freely around the back of the cabinet, which is necessary to cool the compressor and condenser. Allow at least 10cm clear space at the back, 10cm at the sides of the unit and 30cm between the top and any surface above. If you are installing your refrigerator next to a fixed wall, leave sufficient space on the hinge side to allow for the door to swing open.

Do NOT install/use the appliance in the following locations/situations:

- › In moist areas or areas of high humidity.
- › In a recreational vehicle, or for use with an inverter.
- › In direct sunlight, near heat sources, next to an open flame, cooking or heating appliance, or near any other source of high heat.
- › Direct sunlight may affect the acrylic coating and heat sources may increase the unit's power consumption. For best energy efficiency install the appliance in the coolest area of the room.
- › In an area with extreme cold ambient temperatures.
- › In an area with excessive moisture and high humidity. Make sure it is protected from elements such as wind, rain, water spray or drips.
- › In an area where petrol or other explosive and/or flammable liquids or fumes are used or stored. The fumes can create a fire hazard or explosion.

Installation Instructions

Installation Cont.

Electrical connection

- › **WARNING!** It must be possible to disconnect the appliance from the mains power supply; the plug must therefore be easily accessible after installation.
- › Before plugging in your new appliance, let it stand upright for at least 2 hours. This will allow the refrigerant gases to settle into the compressor and reduce the possibility of a malfunction in the cooling system.
- › › The appliance must be earthed.
 - The plug of the power supply cord is equipped with a contact for this purpose.
 - Do not under any circumstances cut or remove the third (earth) prong from the power cord.
 - If the plug does not fit your outlet, consult a licensed electrician for advice to have the outlet changed.
- › Plug the unit into a dedicated, properly earthed wall outlet. Ensure that your outlet voltage and circuit frequency correspond to the voltage stated on the rating label.
- › Secure the appliance's supply cord behind the unit. Do not leave it exposed or dangling to prevent injury and accidental disconnection from the power supply.
- › Adjust the temperature control as described below.
- › When first starting up, and after a period out of use, allow the unit to cool down for at least 2–3 hours (4 hours if starting up during warm weather in summer) before placing food in the appliance.

Levelling the Fridge (see Fig. 1)

- a. Turn the feet clockwise to raise the refrigerator;
- b. Turn the feet counterclockwise to lower the refrigerator;
- c. Adjust both feet so the refrigerator is level.

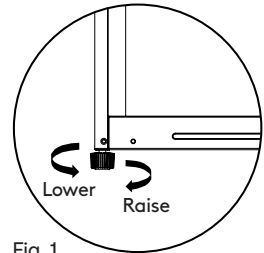

Fig. 1

Installation Instructions

Installation Cont.

Reversing the door

- › Tools Required: Cross head screwdriver, flat blade screwdriver, masking tape, and a 5/16" socket & ratchet.
- › Before beginning, ensure that the upright refrigerator is unplugged and empty.
- › To remove the door it is necessary to tilt the upright refrigerator backwards. Rest the refrigerator against something solid to prevent it from slipping whilst removing the door.
- › Do no recline the refrigerator more than 45°.
- › DO NOT lay the upright refrigerator on its back or sides as this may damage the coolant system.

1. Remove the top hinge cover, screws and upper hinge. Then remove the plastic screw hole cap from the opposite side.
2. Disassemble the door and the bottom hinge assembly the adjustable foot. Then assemble the bottom hinge assembly foot on the opposite side.
3. Place the door onto the bottom hinge. Then assemble the shaft of the top hinge as per the image.
4. Then assemble the upper hinge, upper hinge cover and plastic screw hole caps.

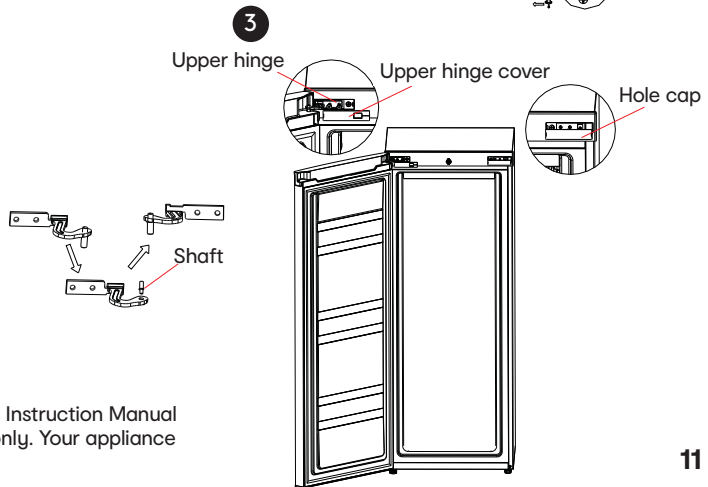
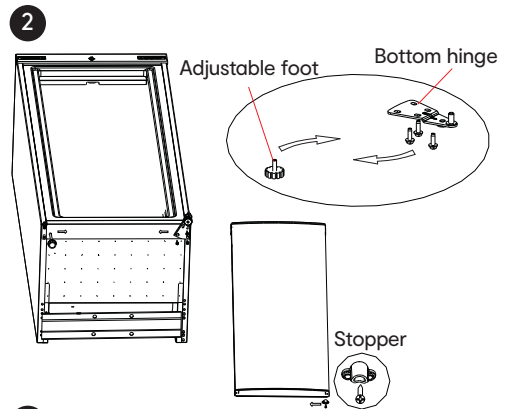

NOTE: The images within this Instruction Manual is for explanatory purposes only. Your appliance may appear differently.

Your Upright Refrigerator

Your Upright Refrigerator

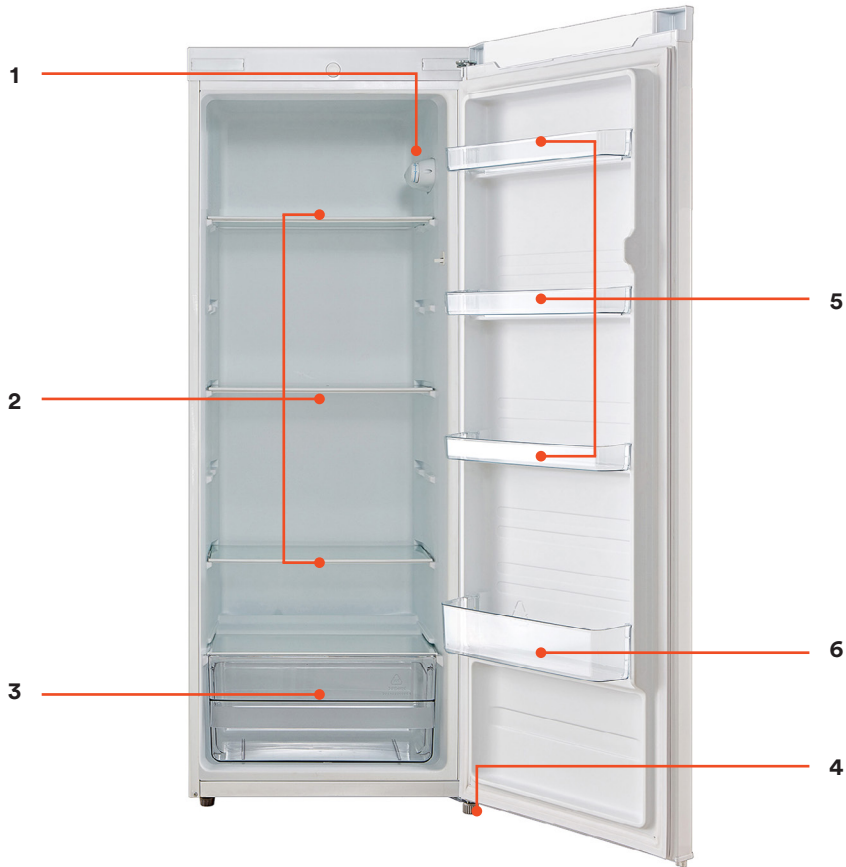

Key:

1. Thermostat
2. 3 × Glass Shelves
3. Vegetable Crisper Drawer
4. Adjustable Feet
5. 3 × Small Door Trays
6. 1 × Large Door Tray

Thermostat Control Knob

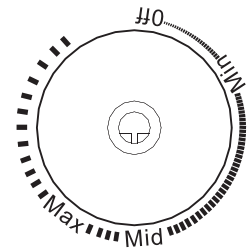

NOTE: The images within this Instruction Manual is for explanatory purposes only. Your appliance may appear differently.

Using Your Upright Refrigerator

Installation Cont.

- › Your fridge has one control for regulating the temperature. The temperature control is located on the inside wall of the refrigerator, visible only when the door is open.
- › Depending on your room's ambient temperature, you may need to adjust the temperature setting to achieve your desired temperature.
- › The temperature options are as follows:
 - Dial position "Min" provides a cool temperature.
 - Dial position "Mid" is suitable for normal operation, suitable for most situations.
 - Dial position "Max" provides the coolest temperature.

› **Important:** If the unit is unplugged, lost power, or turned off, you must wait 3 to 5 minutes before restarting the unit.

If you choose to change the thermostat setting, adjust the thermostat control by one numerical increment at a time. Allow several hours for temperature to stabilize between adjustments.

Using for the First Time

When you install your appliance, set the thermostat knob to position 6 for the first 24–48 hours, after which you can set it to the level that best suits your needs. It is the best to wait 24 hours before adding any food.

Important: Once the unit has started, continuous operation is recommended. Please try and avoid turning the unit off and on as this may affect the service life.

Noise From Your Upright Refrigerator

- › You may notice that your upright fridge makes some unusual noises from time to time. Most of these are perfectly normal, but you should be aware of them!
- › These noises are caused by the circulation of the refrigerant liquid in the cooling system. This is not a fault and will not affect the performance of your unit and is common with all modern fridges.

Usage Tips

- › Cooked meats/fish should always be stored on a shelf above raw meats/fish to avoid bacterial transfer. Keep raw meats/fish in a container which is large enough to collect juices and cover it properly. Place the container on the lowest shelf.
- › Leave space around your food, to allow air to circulate inside the unit.
Ensure all parts of the unit are kept cool.
- › To prevent transfer of flavours and drying out, pack or cover the food separately.
Fruit and vegetables do not need to be wrapped.
- › Always let pre-cooked food cool down before you put in the unit. This will help to maintain the internal temperature of the unit.
- › To prevent cold air escaping from the unit, try to limit the number of times you open the door.
We recommend that you only open the door when you need to put food in or take food out.
- › When storing pre-packed, commercially refrigerated food, follow the food manufacturer's instructions for storing the food in a home fridge or freezer. Do not exceed any storage times listed on the packaging.
- › According to national standards, household refrigerators shall not be used for other purposes, such as storage of blood, drugs or biological products.

Interior Accessories

- › Various glass or plastic storage shelves are included with your appliance — different models have different combinations.
- › You should always slide one of the full size glass storage shelves into the lowest set of guides, above the fruit and vegetable containers, and keep it in this position. To do this, pull the storage shelf forward until it can be swivelled upwards or downwards and removed.
- › Please do the same in reverse to insert the shelf at a different height.
- › In order to make the most of the volume of the fresh food storage compartment or frozen-food storage compartment, the user can remove one or more shelves, drawers out of the appliance, according to your daily use.

Energy Saving Tips

- › The appliance should be placed in the coolest area of the room, away from heat producing appliances or heating ducts. Please avoid placement in direct sunlight.
- › Let hot foods cool to room temperature before placing them in the appliance.
- › Do not overload the appliance with unfrozen food as this may cause it to freeze slowly and risk food spoilage.
- › Be sure to wrap foods properly and wipe containers dry before placing them in the appliance.
This cuts down on frost building up inside in the unit.
- › Please do not wrap items in aluminium foil, wax paper or paper towel.
These materials interfere with cold air circulation, making the appliance less efficient.
- › Organise and label food to reduce door openings and extended searches.
Remove as many items as needed at one time, ensuring the unit is opened as few times as possible.

Maintenance and Cleaning

Defrosting

The Upright Refrigerator can only be manually defrosted.

- › For the most efficient operation and minimum energy consumption, defrost the freezer when the frost on the freezer walls is excessive or >5mm thick. To minimize disruption, choose a time when the stock of frozen food is low.
- › Unplug the appliance and open the door, remove foods and shelving basket before defrosting
- › Open the outflow hole and drainage hole (place water container at the drainage hole); the interior frost will naturally melt. Wipe the defrost water with a dry, soft cloth. When the frost softens, an ice scraper might be used to the accelerate defrosting process.
- › Please remove the food and put in a cool place when defrosting before removing accessories.

WARNING

Other mechanical devices or other means shall not be used to accelerate except those recommended by the manufacturer. Do not damage the refrigerant circuit.

IMPORTANT: Do not use boiling water because it may damage the plastic parts. In addition, never use a sharp or metallic instrument to remove frost as it may damage the cooling coils and will void the warranty. We recommend using a plastic scraper.

Cleaning

WARNING

Before cleaning the appliance, make sure it is switched off and disconnected from the power supply. Failure to do so can result in electric shock or injury.

- › Wash the inside surfaces and the interior accessories with a damp, warm cloth moistened in a water and baking soda solution. The solution should be about 2 tablespoons of baking soda to 1 litre of water. Rinse and wipe dry with a soft cloth.
- › Clean the outside of the unit with a damp, well wrung out cloth, keeping the area of the controls dry. Keep the lid gasket (seal) clean.
- › **Never use boiling water to accelerate defrosting as it may damage the plastic components.**
- › Regularly check the appliance for defrost water. If necessary, clean the drain. If the drain is blocked, water will collect in the base of the appliance.
- › After cleaning/defrosting, push the drain plug in.
- › After everything is dry, place appliance back into service.
- › Allow approximately 1-2 hours for the cabinet to cool down again (depending on the length of time the appliance was disconnected from the power).

WARNING

Never clean the unit with an abrasive, acid, oil or solvent based cleaning agent. Never use flammable fluids or sprays for cleaning as the fumes from these substances can create a fire hazard or Explosion.

NOTE: The appliance is designed to run continuously once it is started. Generally, the operation of the appliance shall not be interrupted; otherwise the service life may be impaired.

Changing the Light

Any replacement or maintenance of the LED lamps is intended to be completed by the manufacturer, its service agent or similar qualified person.

Cleaning the Glass Shelves

- › Lift up the front of glass shelf, and then slide it out to remove the glass shelf for cleaning.
- › Wipe down with a damp, warm cloth as per the instructions above.
- › Slide the glass shelf back into position once clean.

FAQ'S and Troubleshooting

Service, repair and spare parts

Do not attempt to alter or modify this appliance in any way, or to repair or replace any part unless it is specifically recommended in this manual. All other servicing should be referred to a qualified technician. Contact our after sales support on 1300 11 43 57 for advice.

Our after sales support centre stocks a selection of spare parts for your appliance.

To enquire about purchasing a part, call us on 1300 11 43 57 or email support@residentiagroup.com.au

Power Failure

Most power failures are corrected within a few hours and should not affect the temperature of your appliance if you minimise the number of times the door is opened. If the power is going to be off for a longer period of time, take proper steps to protect the contents.

Out of Operation

- › › **Power failure:** In case of power failure, even if it is in summer, foods inside the appliance can be kept for several hours; during the power failure, the times of door opening shall be reduced, and no more fresh food shall be put into the appliance.
- › › **Long-time nonuse:** The appliance shall be unplugged and then cleaned; then the doors are left open to prevent odour.
- › › **Moving:** Before the refrigerator is moved, take all objects inside out, fix the glass partitions, vegetable holder, freezing chamber drawers and etc. with tape, and tighten the leveling feet; close the doors and fix them with tape. During moving, the appliance shall not be laid upside down or horizontally, or be vibrated; the inclination during movement shall be no more than 45°.

FAQ'S and Troubleshooting

Problem	Possible Cause	Possible Solution
The appliance does not operate.	<ul style="list-style-type: none"> › The appliance is not plugged in. › The appliance is turned off. › The circuit breaker tripped or a blown fuse. 	<ul style="list-style-type: none"> › Plug in the appliance. › Turn on power point. › Reset circuit breaker/replace fuse.
The appliance is not cold enough.	<ul style="list-style-type: none"> › Check the temperature control setting. › The door is opened too often, or is kept open for too long; the door is not closed completely; hot food has been placed inside. › The appliance has recently been disconnected for a period of time. 	<ul style="list-style-type: none"> › Reduce the temperature. › Do not open door for 2+ hours; Check that the door is closed properly and for any obstructions preventing the door closing properly; Remove hot food and let it cool first before replacing it. › Plug in the appliance.
The appliance has an odd odour.	<ul style="list-style-type: none"> › Food may not be wrapped properly. › Food may be rotten. › The interior may not be clean. 	<ul style="list-style-type: none"> › Check that the food is wrapped tightly. › Check for rotten food and remove. › Clean the interior of the appliance.
The internal light does not illuminate.	<ul style="list-style-type: none"> › The appliance is not plugged in. › The appliance is turned off. › The circuit breaker tripped or a blown fuse. › The light is damaged. 	<ul style="list-style-type: none"> › Plug in the appliance. › Turn on power point. › Reset circuit breaker/replace fuse. › Please contact after sales support.
The door will not close properly.	<ul style="list-style-type: none"> › The appliance is not level. › The gasket is dirty. › Food is stacked too high. 	<ul style="list-style-type: none"> › Level the appliance. › Clean gasket with warm water and a soft cloth. › Re-position food so it does not obstruct the door.
The door is difficult to open.	<ul style="list-style-type: none"> › A difference in pressure between the air inside and outside of the unit. 	<ul style="list-style-type: none"> › This is a normal phenomenon and cannot be avoided.
Moisture forms on the inside appliance walls.	<ul style="list-style-type: none"> › Hot and humid weather increases the internal rate of frost build-up. › The lid is slightly open. › The lid is kept open too long, or is opened too frequently. 	<ul style="list-style-type: none"> › This is normal. › Close the door. › Open the door less often
Moisture forms on the outside of the appliance.	<ul style="list-style-type: none"> › The door is slightly open, causing cold air from inside the appliance to meet warm, moist air from the outside. 	<ul style="list-style-type: none"> › Close the door or check for obstructions.
There are vibrations.	<ul style="list-style-type: none"> › The appliance is not level. › The floor is uneven or weak. › The appliance is touching the wall. 	<ul style="list-style-type: none"> › Level the appliance. › Be sure your floor can adequately support the appliance. › Move the appliance away from the wall and check it is level.

Product Specifications

Model:	AUL237W
Product Dimensions:	W: 550mm, D: 550mm, H: 1420mm
Weight:	36.5kg
Net Capacity:	230L
Energy Rating:	2 Stars MEPS
Refrigerant/Amount:	R600a/30g

Standards

This product complies with AS/NZS 60335.1 and AS/NZS 60335.2.24 electrical safety, and with AS CISPR 14.1:2018 for electromagnetic compatibility.

Warranty

24 Month Warranty

Thank you for your purchase from Kmart.

Kmart Australia Ltd warrants your new product to be free from defects in materials and workmanship for the period stated above, from the date of purchase, provided that the product is used in accordance with accompanying recommendations or instructions where provided. This warranty is in addition to your rights under the Australian Consumer Law.

Kmart will provide you with your choice of a refund, repair or exchange (where possible) for this product if it becomes defective within the warranty period. Kmart will bear the reasonable expense of claiming the warranty. This warranty will no longer apply where the defect is a result of alteration, accident, misuse, abuse or neglect.

Please retain your receipt as proof of purchase and contact our Customer Service Centre on 1800 124 125 (Australia) or alternatively, via Customer Help at Kmart.com.au for any difficulties with your product. Warranty claims and claims for expense incurred in returning this product can be addressed to our Customer Service Centre at 690 Springvale Rd, Mulgrave Vic 3170.

Our goods come with guarantees that cannot be excluded under the Australian Consumer Law. You are entitled to a replacement or refund for a major failure and compensation for any other reasonably foreseeable loss or damage.

You are also entitled to have the goods repaired or replaced if the goods fail to be of acceptable quality and the failure does not amount to a major failure.

This page is intentionally left blank

This page is intentionally left blank

Model no: AUL237W